



## COYOTE® DTC8

The **COYOTE DTC8 (Drop Termination Closure)** is the largest member of the DTC family. The DTC8 provides the ultimate level of application flexibility for fiber drop distribution applications. The closure can be configured with a range of fiber organizer systems to support splice, distributed splitter and drop applications using traditional cable, blown fiber cable, pushable drop cable technology or micro tube cable. Organizers to support pre-connectorized drop applications as an alternative to more costly proprietary hardened drop cable systems are also available.

### FEATURES AND BENEFITS

- Dimensions: 12" x 8.8" x 3.5" (305 x 224 x 89 mm)
- Max Splice Capacity: 48 Single Fusion
- Max Adapter Quantity: 4 Duplex SC or 4 Quad LC
- Grommet Quantity: 8 (Multi-Hole Grommets Available)
- Grommet Cable Diameter Range: Large Grommets = 0.093" – 0.550" (2.4 - 14.0 mm) and Flat Drop Cable  
Small Grommets = 0.093" – 0.420" (2.4 - 10.7 mm) and Flat Drop Cable
- Applications: Direct Bury, Below Grade, Pole/Wall Mount, Aerial, or Pedestal
- Designed and tested in accordance with Telcordia® GR-771-CORE Buried, Underground, IP-68 Rated Requirements
- Constructed out of rugged UV-stabilized, flame retardant material (UL94-5VA Rated)
- Hinged collar system and integrated over-molded cover provides quick re-entry and re-use, no special tools required



## COYOTE® DTC8

The COYOTE DTC8 has hinged collar system and integrated over-molded cover that creates an IP-68 seal and provides quick re-entry into the closure. The removable end plate works in conjunction with silicone grommets to cover a range of flat or round cable profiles.

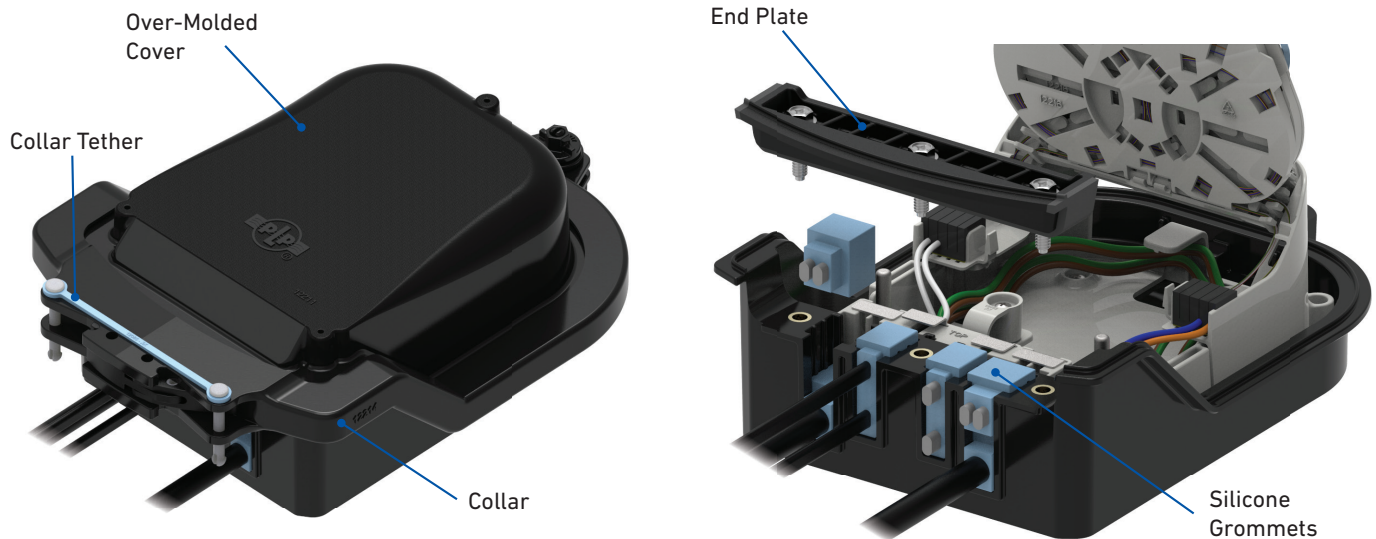

The DTC8 can be configured with a range of fiber organizer systems to support splice and drop applications. The hinged splice tray (12 CT.) can be secured in the upright position using the tray tether. Most of the DTC8 organizers can accept 4 splice trays to reach a maximum splice capacity of 48 CT. The tray tether is also used to secure the splice tray once the splicing has been completed. If a splitter tray is required, it will reduce the maximum splice capacity to 24 CT.

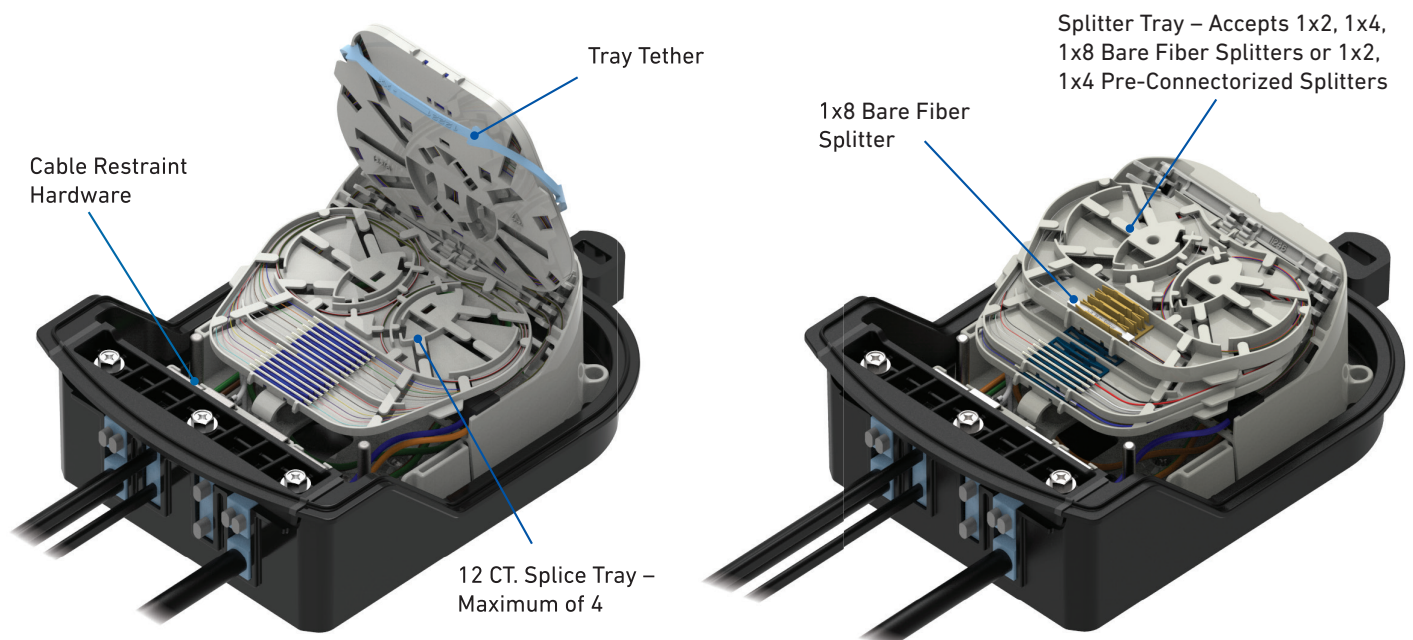

## COYOTE® DTC8 SPLICE ONLY – PROTECTED STORAGE

The splice only – protected storage organizer protects expressed tubes from being tampered with. The integrated cable restraint hardware makes installation of the cables to the organizer outside of the DTC8 base. The bare fiber storage is ideal for dark fibers, as well as routing drop fibers as they are added.

Integrated Cable  
Restraint Hardware

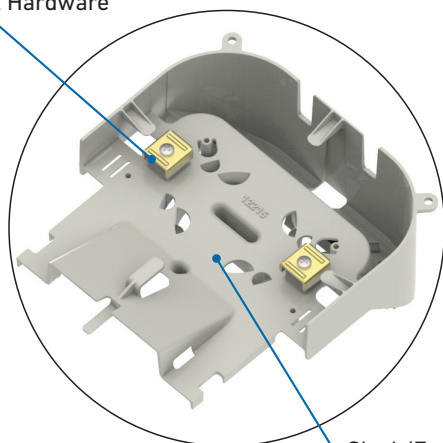

Slack/Express  
Storage on Underside  
of Organizer

Express Buffer Tube Storage Located  
on Underside of Organizer

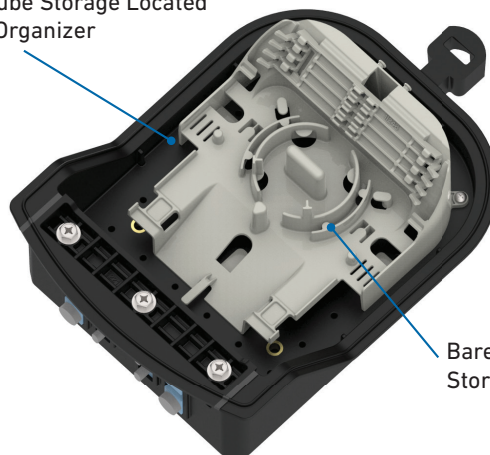

Bare Fiber Slack  
Storage

## COYOTE DTC8 SPLICE AND ADAPTERS

The splice and adapters organizer is used for cross-connect applications. The adapter bulkhead can accept (4) Dual SC or (4) Quad LC Adapters and the slack storage area allows for pigtails to be stored neatly. The slack storage area can express up to a 96 CT. buffer tube cable. The splice trays can accommodate up to four 900  $\mu$ m pigtails per tray or up to 12 bare fiber splices. For cables with central strength members, the strength members are secured in a terminal and installed onto posts in the base of the closure. This prevents the strength members from pistoning into the closure.

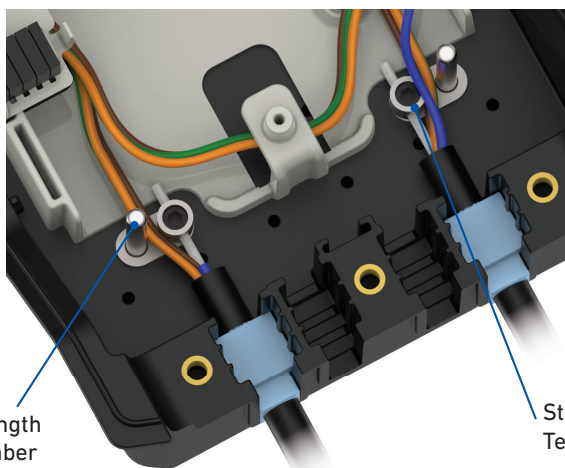

Strength  
Member  
Posts

Strength Member  
Terminals

Adapter Bulkhead – Accepts  
(4) Dual SC or (4) Quad LC

Slack/Express  
Storage

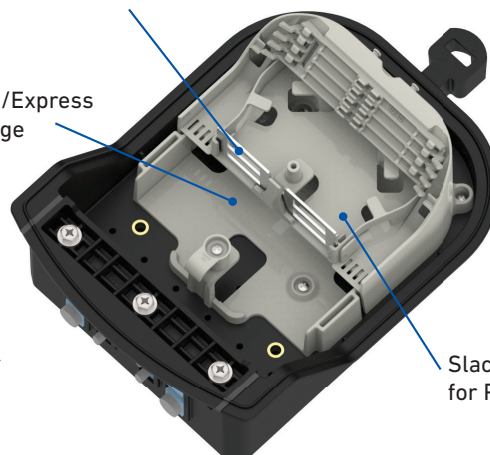

Slack Storage  
for Pigtails





## COYOTE® DTC8 SPLICE ONLY – OPEN STORAGE

The splice only – open storage organizer allows quick access to expressed tubes. This organizer accepts a maximum of 4 splice trays which can accommodate up to 12 single fusion splices each. Up to 8 flat drop cables can be secured in the DTC8 by using the retention brackets and clips. The flat drops are first installed into the bracket and the clip is pushed onto the cable sheath.

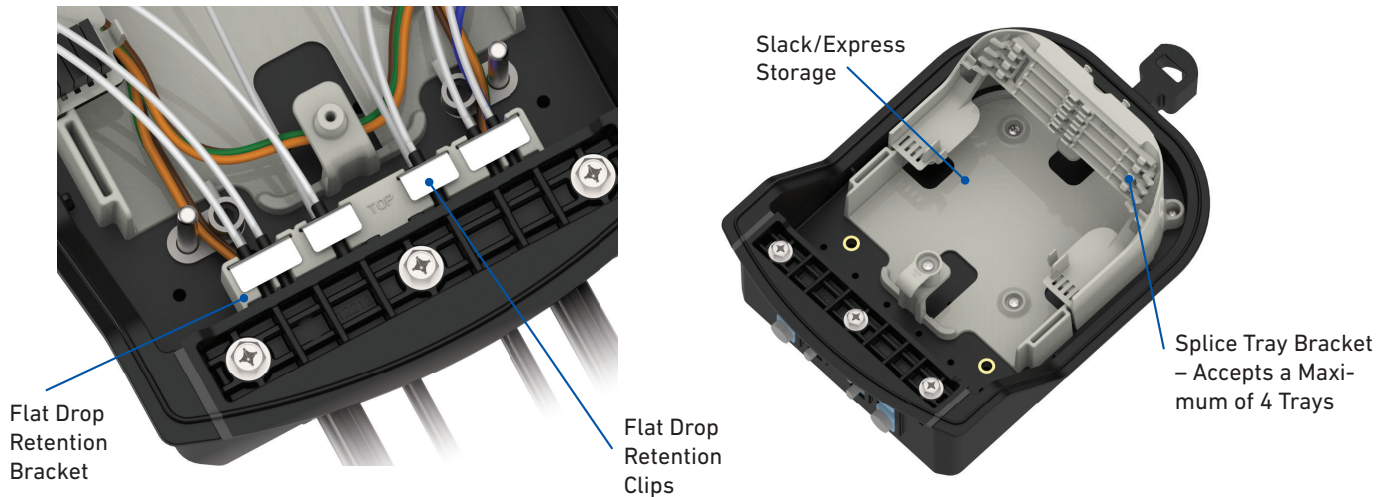

## COYOTE DTC8 ADAPTERS ONLY

The adapter only organizer is ideal for pre-connectorized applications. A fan-out kit or breakout cable can be brought into the closure and pre-connectorized or pushable drop cables can be installed as subscribers are added. The slack storage area can accommodate field installable connectors as well. The adapter bulkhead can accept (8) Dual SC or (8) Quad LC Adapters. A ground stud can be installed into the DTC8 base to easily ground armored cables.

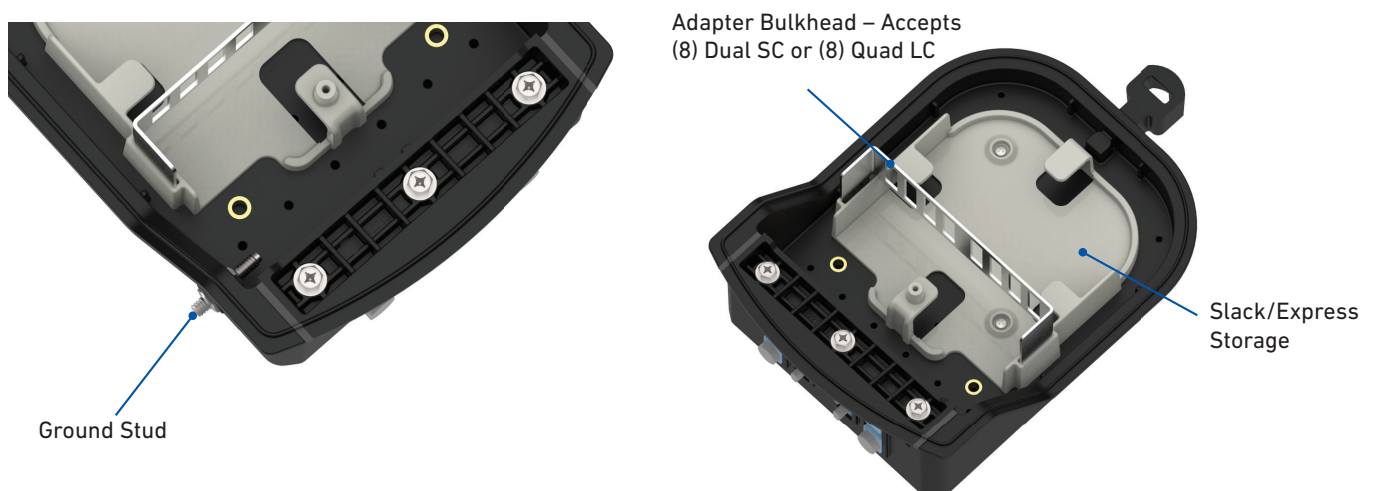

## COYOTE® DTC8 SPLICE AND ADAPTERS – OPEN STORAGE

The splice and adapters – open storage organizer is ideal for applications where a pre-connectorized splitter is needed alongside single fusion splices. The splice tray accepts either 24 single fusion splices or a PLC splitter, 1x2, 1x4, or 1x8 pre-connectorized splitter and 12 single fusion splices. Dark fibers can be stored in the bare fiber storage area until they are required.

Splice Tray – 24 CT. Single Fusion or 12 CT. Single Fusion and a PLC Splitter, 1x2, 1x4, or 1x8 Pre-Connectorized Splitter

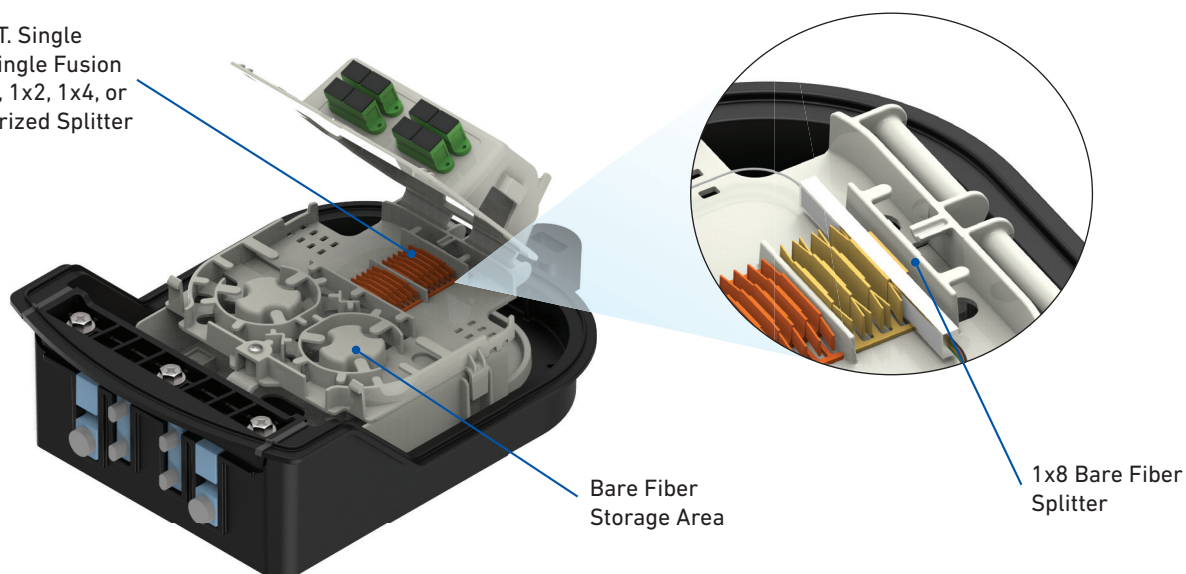

The hinged adapter bulkhead accepts (4) Dual SC or (4) Quad LC adapters and has a retention slot for a fiber pick. The slack storage area has been optimized to accommodate up to 72 CT buffer tube cables. The slack storage tray has integrated cable restraint hardware which allows cables to be installed with ease.

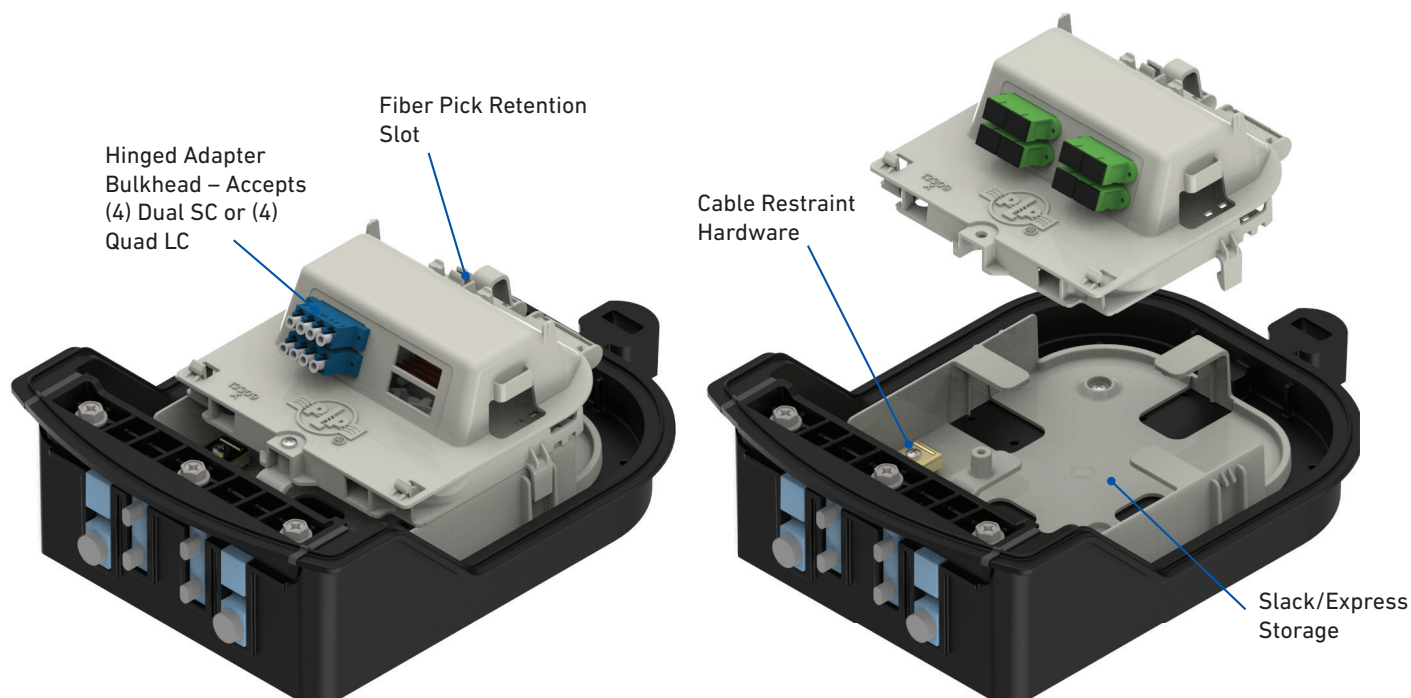



## COYOTE® DTC8 MOUNTING OPTIONS

The COYOTE® DTC8 compact size allows the closure to be installed in a wide range of environments. The closure's small footprint, 12" x 8.8" x 3.5", and UV-stabilized flame retardant material make it durable enough to be mounted on strand, poles, or even in pedestals.

Pedestal Mounting Bracket  
**Catalog Number: 8004108**

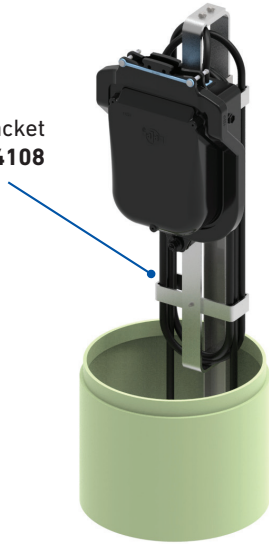

Aerial Mounting Bracket – ADSS Applications  
**Catalog Number: 8004112**

## COYOTE DTC8 STORAGE OPTIONS

The DTC8 is commonly paired with a cable storage bracket to provide ample drop cable storage before entering the closure. In applications where both feed and drop cables need to have excess slack, the DTC8 can be equipped with a mounting bracket that couples with the FIBERLIGN® ADSS Cable Storage Bracket. The closure can be mounted either horizontally or vertically depending on the existing slack. The FIBERLIGN ADSS Cable Storage Bracket allows 150 feet of storage for cables up to 0.75" in diameter. The DTC8 can only accept cables up to 0.55" in diameter.

COYOTE DTC8 Cable Storage Bracket  
**Catalog Number: 8004105**



COYOTE DTC4/6/8 Mounting  
Bracket Kit for ADSS Cable  
Storage Bracket  
**Catalog Number: 8004172**

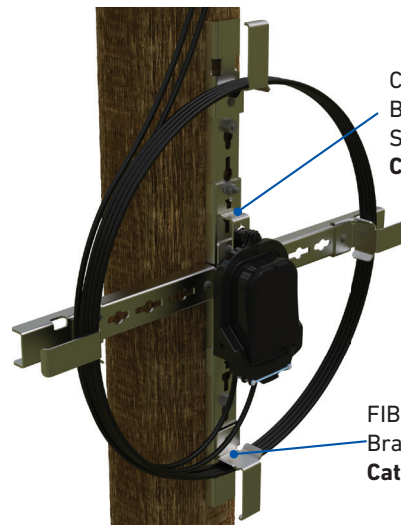

FIBERLIGN® ADSS Cable Storage  
Bracket  
**Catalog Number: 8004072E**

## ORDERING INFORMATION

### COYOTE® DTC8 Catalog Number

**DTC8-** XXXX - XXXX - X - X - X - X - X

(Section 1) (Section 2) (Section 3) (Section 4) (Section 5) (Section 6) (Section 7)

Must be in alphabetical order      Must be in alphabetical order

Catalog Number Example: DTC8-BBDD-CCCC-2-2-1-2-Y

#### Section 1

Grommet Selection (Select 4)	Cable Diameter Range
A	SOLID / PLUG
B	0.170" – 0.220" (4.3 – 5.6 mm) ROUND CABLES
C	0.220" – 0.270" (5.6 – 6.9 mm) ROUND CABLES
D	0.270" – 0.320" (6.9 – 8.1 mm) ROUND CABLES
E	0.320" – 0.370" (8.1 – 9.4 mm) ROUND CABLES
F	0.370" – 0.420" (9.4 – 10.7 mm) ROUND CABLES
G	0.420" – 0.470" (10.7 – 11.9 mm) ROUND CABLES
H	0.470" – 0.550" (11.9 – 14.0 mm) ROUND CABLES
J	0.156" – 0.170" (4.0 – 4.3 mm) ROUND CABLES
K	0.093" – 0.125" (2.4 – 3.2 mm) ROUND CABLES
L	FOR FLAT DROP CABLES

#### Section 2

Grommet Selection (Select 4)	Cable Diameter Range
A	SOLID / PLUG
B	0.170" – 0.250" (4.3 – 6.4 mm) ROUND CABLES
C	0.250" – 0.350" (6.4 – 8.9 mm) ROUND CABLES
D	0.156" – 0.170" (4.0 – 4.3 mm) ROUND CABLES
E	0.093" – 0.125" (2.4 – 3.2 mm) ROUND CABLES
F	FOR FLAT DROP CABLES
G	0.350" – 0.420" (8.9 – 10.7 mm) ROUND CABLES

#### Section 3

Organizer Options (Select 1)
1  Splice Only - Protected Storage
2  Splice & Adapters
3  Splice Only - Open Storage
4  Adapters Only
5  Splice & Adapters - Open Storage

#### Section 4

Splice Tray Selection Selection/Quantity
N NONE (Organizer 4 & 5)
1 to 4  12 Count Tray

#### Section 5

Adapter Type (Select 1)
N NONE
1  Duplex SC/APC
2  Duplex SC/UPC
3  Quad LC/APC
4  Quad LC/UPC

#### Section 6

Adapter Quantity
0 to 4 (Organizer 2 or 5) 0 to 8 (Organizer 4)

#### Section 7

Pigtails Required (Select 1) (Matches adapter type and quantity)	
N	NONE
Y	
	900 µm
Optional	
G	Ground Stud

#### Accessories

Catalog Number	Description
80812456	Splice Tray, 12 CT., Single Fusion
80812916	Splitter Tray for 1x2, 1x4, 1x8 Bare Fiber Splitters or 1x2, 1x4 Pre-Connectorized Splitters
8004104	COYOTE DTC8 Pole/Wall Mounting Bracket
8004105	COYOTE DTC8 Cable Storage Bracket
8004111	COYOTE DTC8 Aerial Mounting Bracket – Strand Applications
8004112	COYOTE DTC8 Aerial Mounting Bracket – ADSS Applications
8004108	COYOTE DTC8 Pedestal Bracket Kit – For use with Channell Commercial Corp. 10" x 22" Round Pedestal
8004172	COYOTE DTC8 Mounting Bracket – For use with FIBERLIGN® ADSS Cable Storage Bracket



GLOBAL HEADQUARTERS 660 BETA DRIVE CLEVELAND, OHIO 44143  
+1 440 461 5200 [INFO@PLP.COM](mailto:INFO@PLP.COM) [PLP.COM](http://PLP.COM)

© 2024 Preformed Line Products Printed in U.S.A. CO-SS-1147-6 01.24.00