

# Tub Box Kit for 2" and 3" Cast-In Device

(Part No. CD23T)

Maximum 13" Concrete Pour

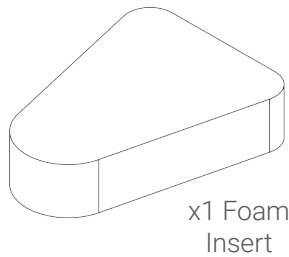
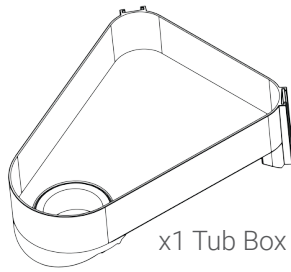

x2  
#6 x 5/8" Screw  
For use with 2"  
Cast-In-Device Tub Box

x2  
#10 X 3/4" Screw  
For use with 2" or 3"  
Cast-In-Device Tub Box

x2  
#6 X 1/4" Screw  
For use with 3"  
Cast-In-Device Tub Box

Parts Included (Not to Scale)

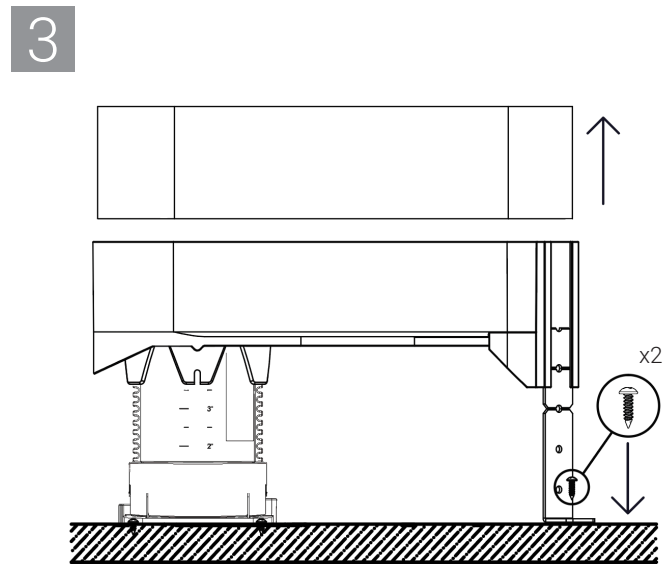
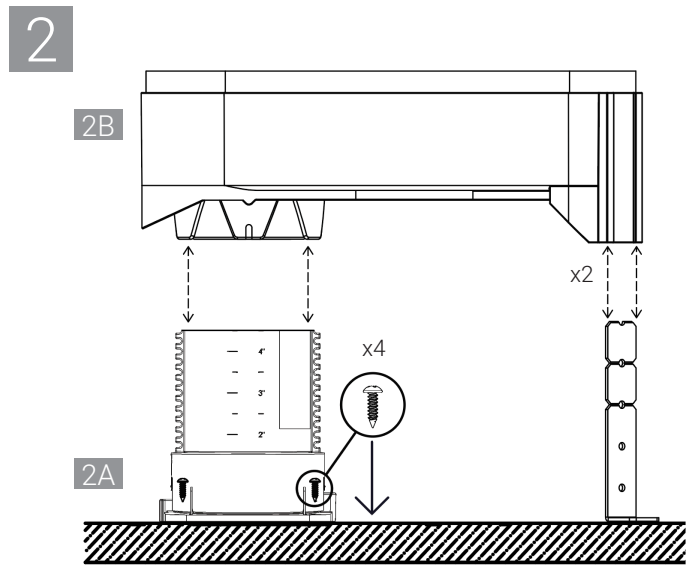
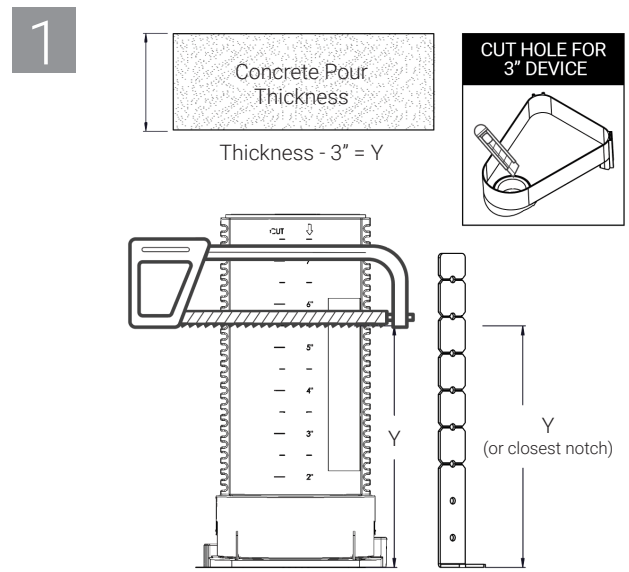
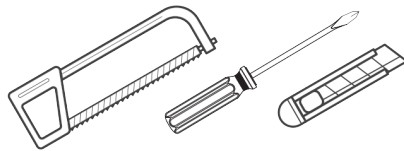
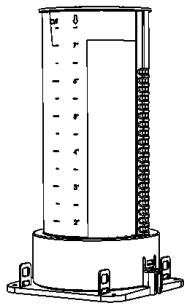

Note: For more information on firestop installation, refer to ASTM E3157.

