

**EZ-Path® Series 44+ Modular Floor Grid System**  
(Part Numbers: EZG444, EZDG444S2, EZG844, EZDG844S2, EZG1644, & EZDG1644S2)

EZG444 Parts Included (not to scale)

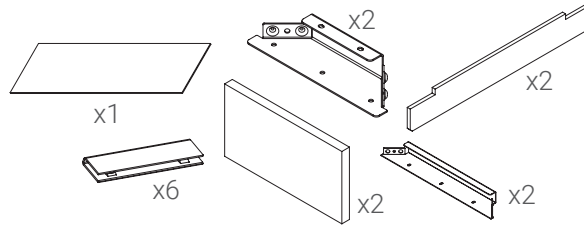

EZG844 Parts Included (not to scale)

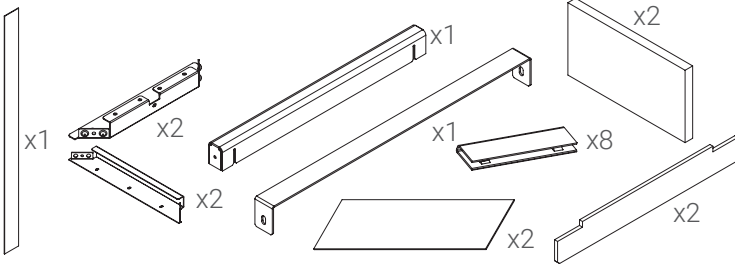

EZG1644 Parts Included (not to scale)

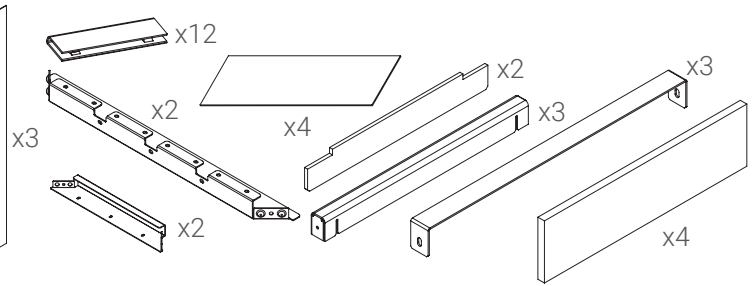

Installing Grid Frame with Devices (1 bank)

1

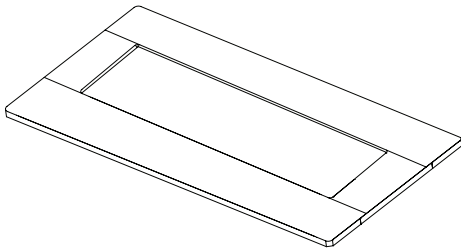

Place fiberglass mat around hole in floor.

2

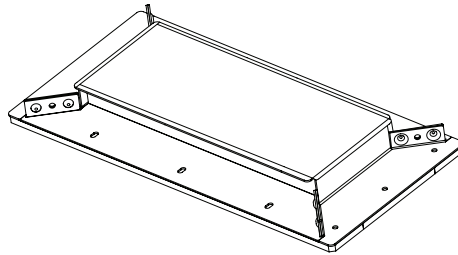

Place pathway bank onto fiberglass mat.

3

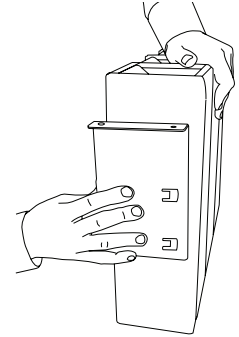

Assemble pathway module by lining up divets in devices and placing them together. Flanges will connect to either side of the end devices.

4

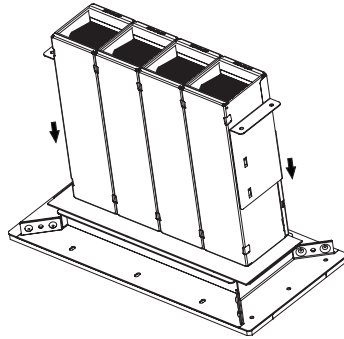

Place connected pathways into pathway bank, lining up flanges.

5

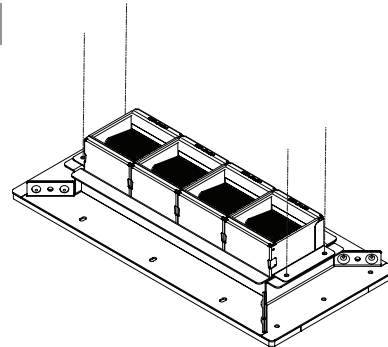

Secure mounting plate to sleeve.

Note: For more information on firestop installation, refer to ASTM E3157.



Installing Grid Frame with Devices (2 bank or 4 bank)

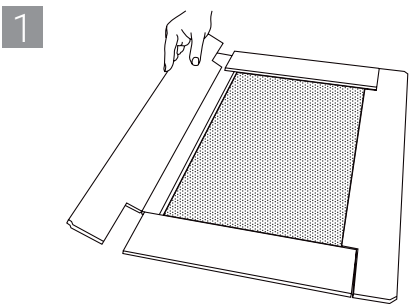

1 Place fiberglass mats around hole in floor.

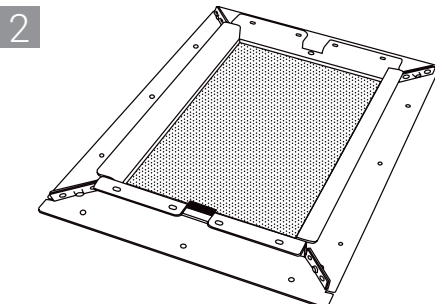

2 Place pathway bank onto fiberglass mat.

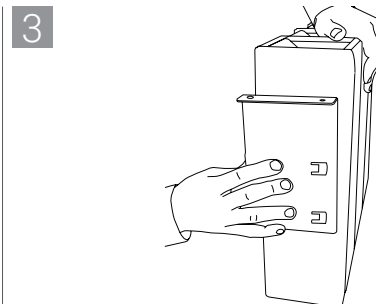

3 Assemble pathway module by lining up divets in devices and placing them together.

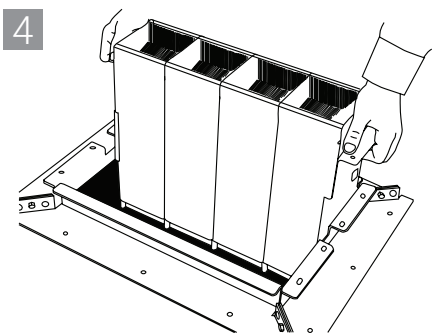

4 Place connected pathways into pathway bank, lining up flanges.

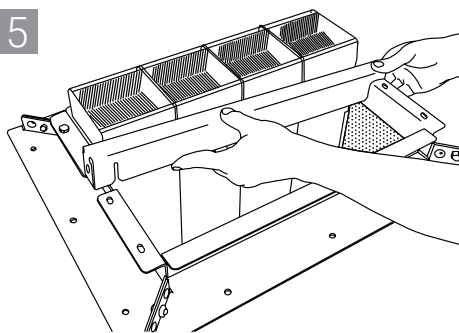

5 Insert space bar.

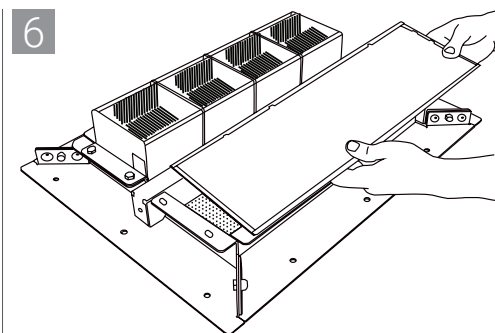

6 If there is not another set of pathways to install right away, install firestop panel.

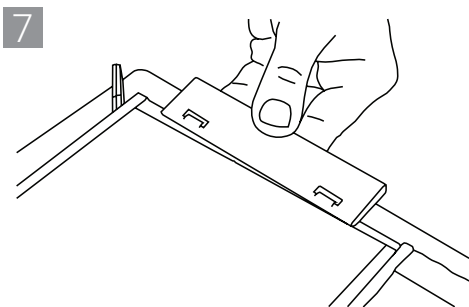

7 Holding panel securely in place with edges aligned, install panel clips at panel ends by pressing over lip of panel and frame flange.

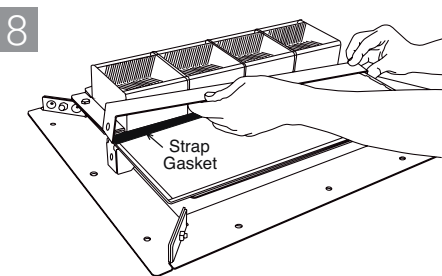

8 Replace spacer bar gasket and spacer bar strap to secure panel edges where they overlap spacer bar.

TABLE A: OPENING DIMENSIONS

Pathway Capacity	Catalog Number With Devices	Catalog Number Blank	Opening Width	Opening Length	Frame Width	Frame Length
4 Devices	EZDG444S2	EZG444	6" (15.3 cm)	18" (45.7 cm)	11" (28 cm)	23" (58.4 cm)
8 Devices	EZDG844S2	EZG844	12" (30.5 cm)	18" (45.7 cm)	17" (43.2 cm)	23" (58.4 cm)
16 Devices	EZDG1644S2	EZG1644	24" (61 cm)	18" (45.7 cm)	29" (73.7 cm)	23" (58.4 cm)

Note: For more information on firestop installation, refer to ASTM E3157.



**EZ-Path® Series 44+ Modular Floor Grid System**

(Part Numbers: EZG444, EZDG444S2, EZG844, EZDG844S2, EZG1644, & EZDG1644S2)

**Installing Blank Grid without Devices**

1

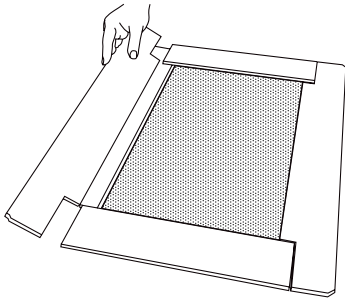

Place fiberglass mats around hole in floor.

2

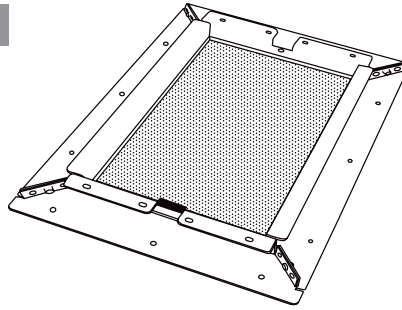

Place pathway bank onto fiberglass mat.

3

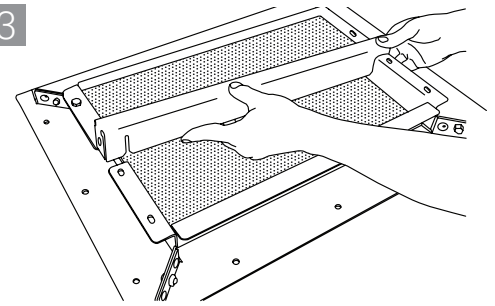

Insert space bar.

4

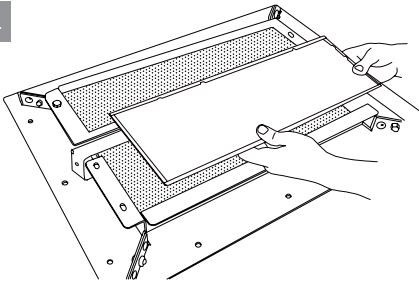

Install firestop panels on both sides.

5

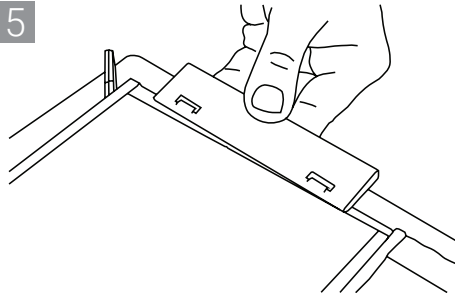

Holding panel securely in place with edges aligned, install panel clips at panel ends by pressing over lip of panel and frame flange.

6

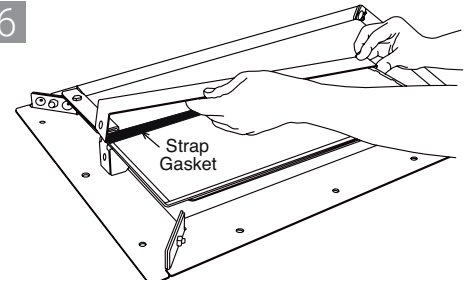

Replace spacer bar gasket and spacer bar strap to secure panel edges where they overlap spacer bar.

**Complete Kits**

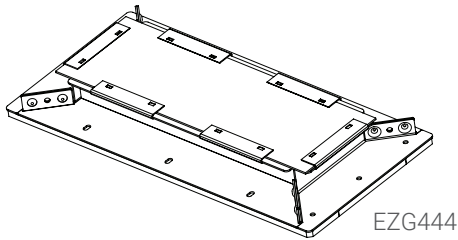

EZG444

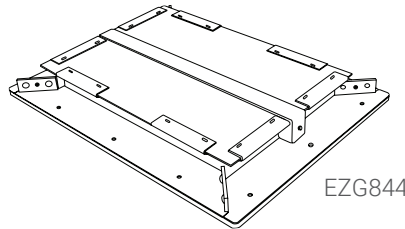

EZG844

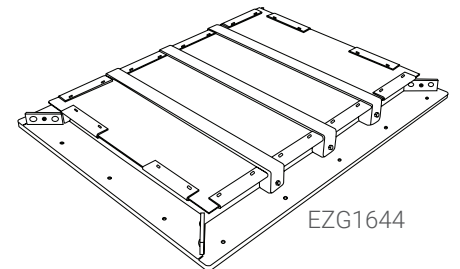

EZG1644

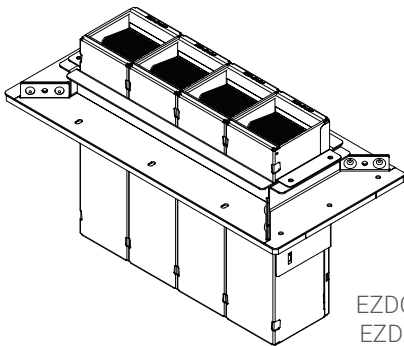

EZDG444S &  
EZDG444S2

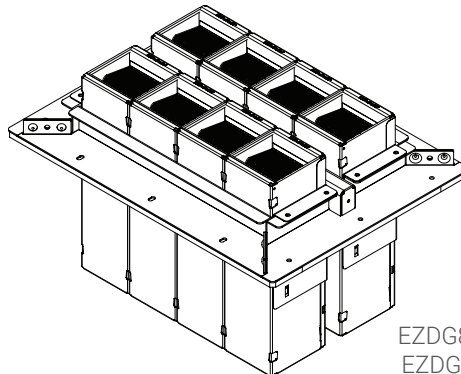

EZDG844S &  
EZDG844S2

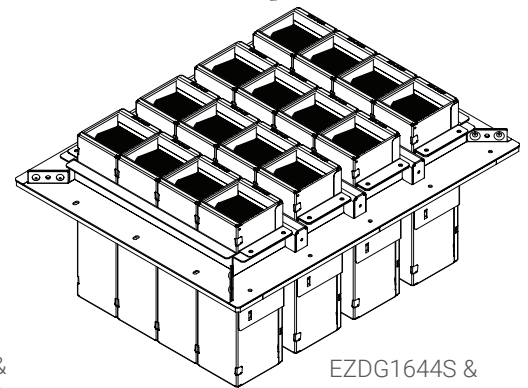

EZDG1644S &  
EZDG1644S2

Note: For more information on firestop installation, refer to ASTM E3157.

