

Optional Ground Attachment

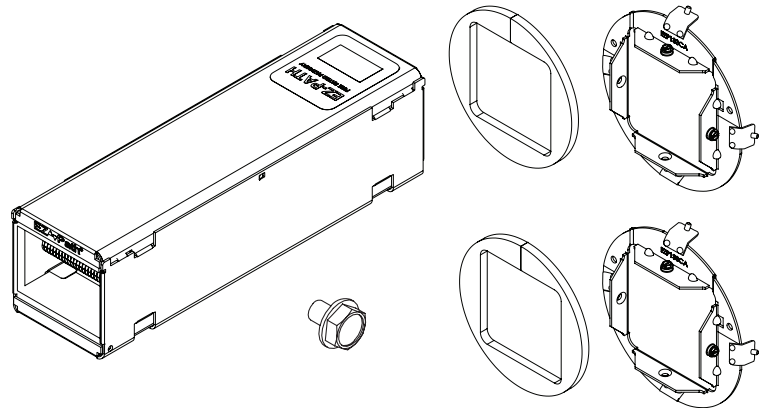

Parts Included (Not to Scale)

Option 1 - New Work Installations

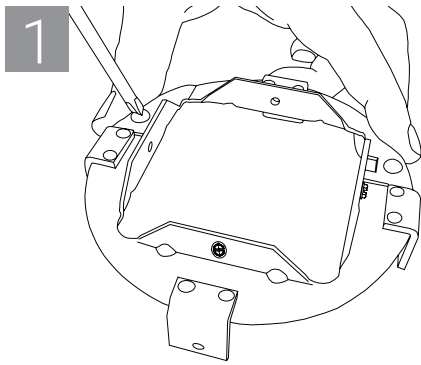

1 Assemble split conduit mounting plates by using (2) #8-32 x 1/4" screws.

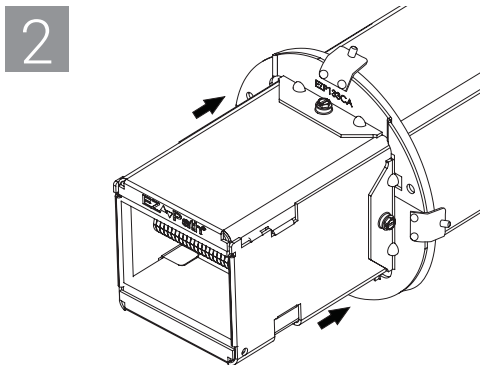

2 Slide pathway and gasket into opening in mounting plate.

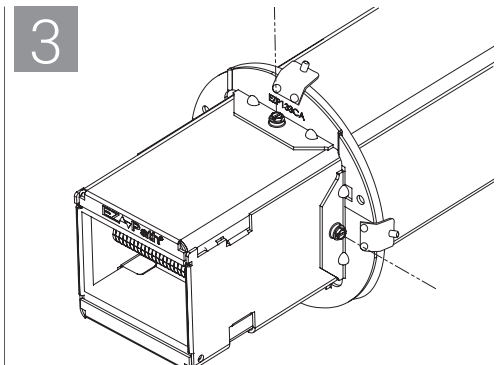

3 Secure plate to pathway by tightening hex head slotted screws.

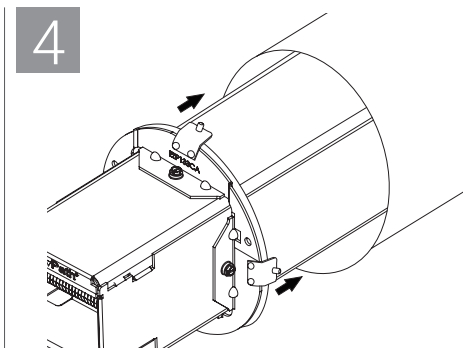

4 Place pathway into sleeve

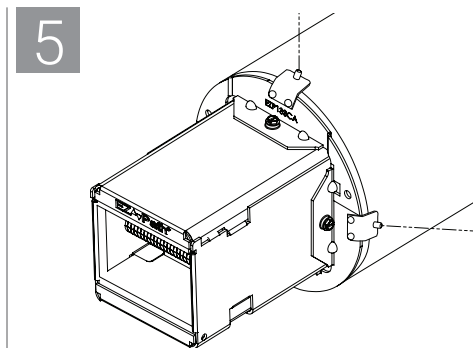

5 Secure mounting plate to sleeve

Note: For more information on firestop installation, refer to ASTM E3157.



Option 2 – Old Work Installations (Cables Already Installed)

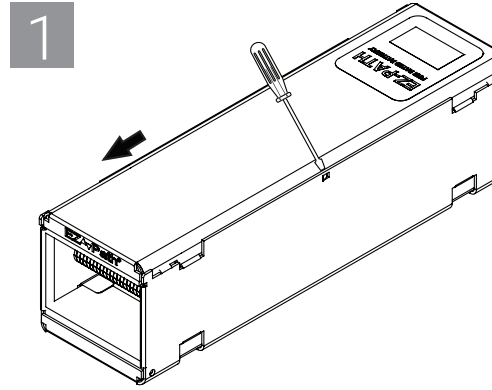

1 Remove lid by placing screw driver into indent on topside of device, sliding lid toward one end of device

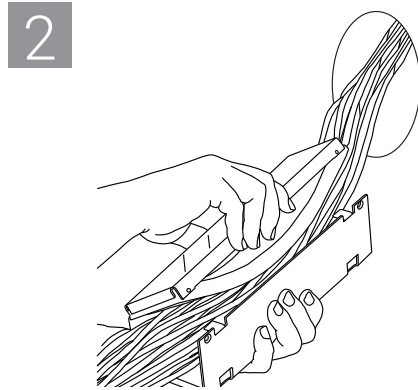

2 Reassemble device lid and body around cables

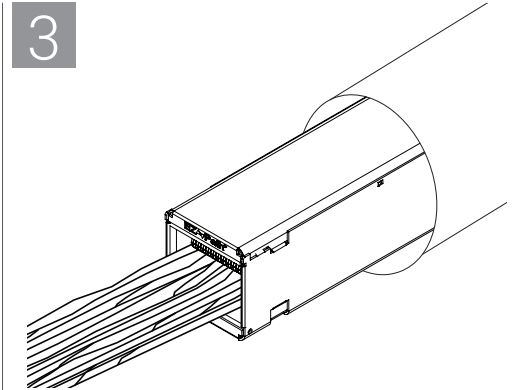

3 Place device in sleeve

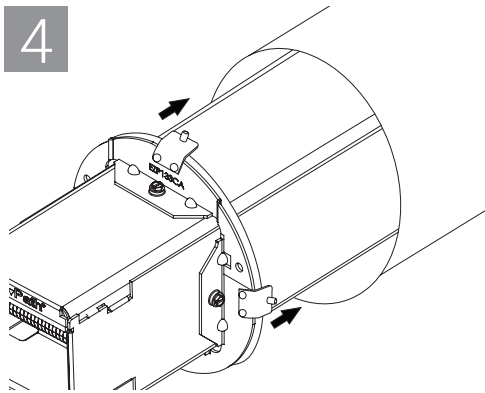

4 Assemble split conduit mounting plate around device and end of conduit, securing in place using hex head slotted screws,

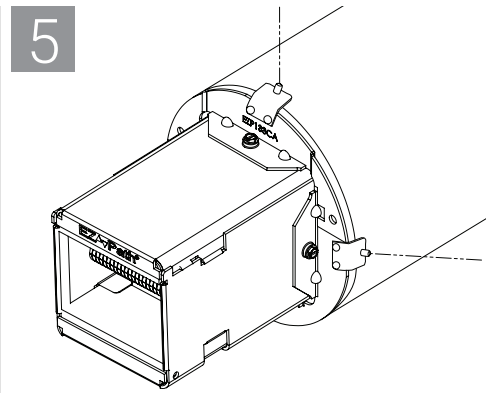

5 Secure mounting plate to sleeve

Note: For more information on firestop installation, refer to ASTM E3157.

