

EZ Path® Cable Tray Retrofit Device (Part Numbers: EZCTR624 & EZCTR624L)

Parts Included (Not to Scale)

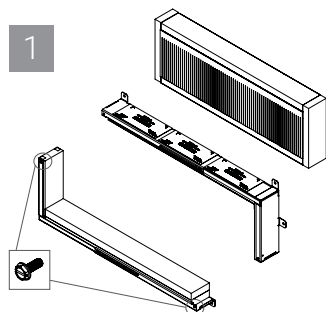

Remove corner screws and separate device into two halves. Remove intumescent foam strips, foam blocks, and rubber gasket assembly from top half of device.

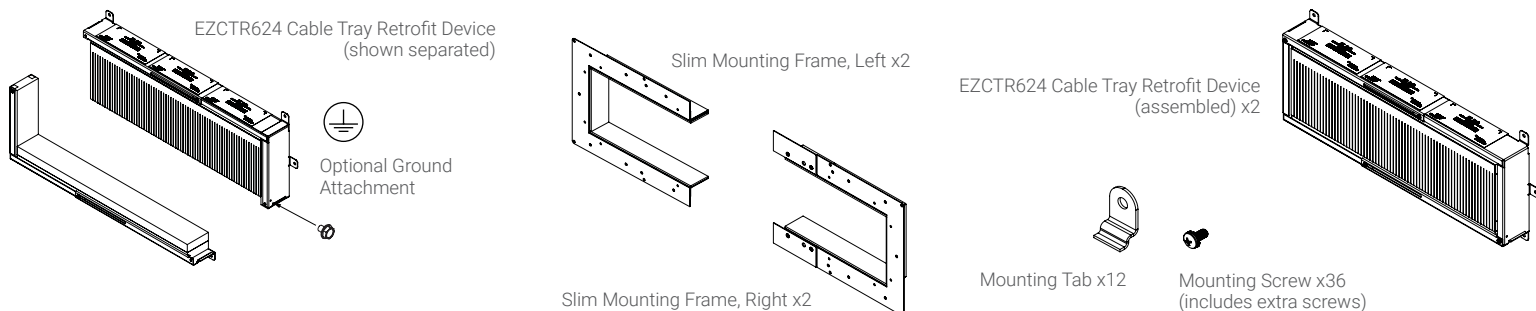
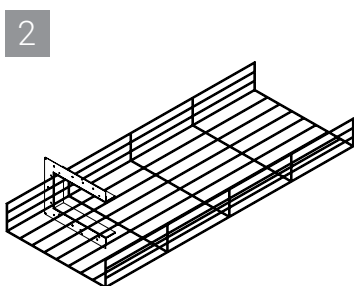

Fasten Slim Mounting Frame, Left to wall so that it covers the opening in the wall. Orient frame with the double layer stack of wrap strip and both rivets towards the top. See table on second page for fastener types.

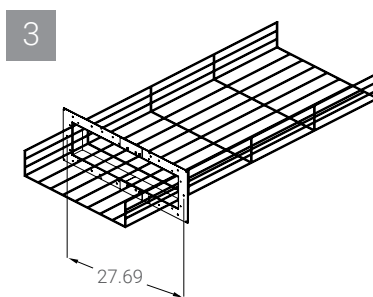

Fasten Slim Mounting Frame, Right to wall so that it covers the opening in the wall, placing the ends over the Slim Mounting Frame, Left. Orient frame with the double layer stack of wrap strip and both rivets towards the top. Verify horizontal CL hole to CL hole dimension shown. See table on second page for fastener types.

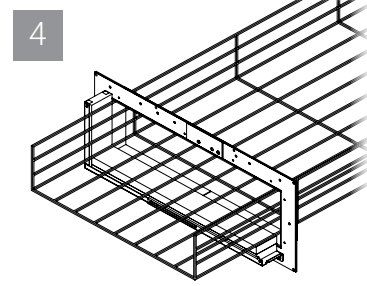

Tightly abut bottom half of tray device against underside of cable tray and face of slim mounting frames. Align holes and fasten mounting tabs of device to slim mounting frames using the screws provided.

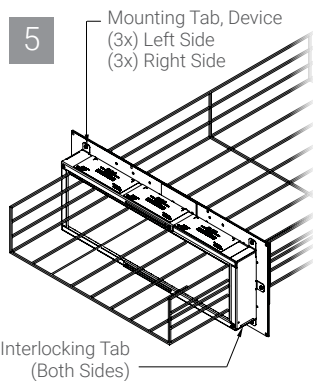

Attach top half of device to bottom half by inserting the interlocking tabs into the rectangular slots on each side of device. Secure device halves together using screws from Step 1. Align holes and fasten mounting tabs of device to slim mounting frames using the screws provided.

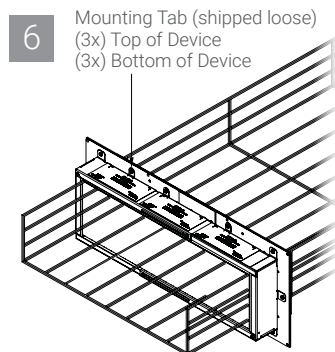

Insert provided mounting tabs into slots on top and bottom of device through clear nameplates as shown. Align holes and fasten mounting tabs to slim mounting frames using the screws provided. Fill any unoccupied holes using the screws provided.

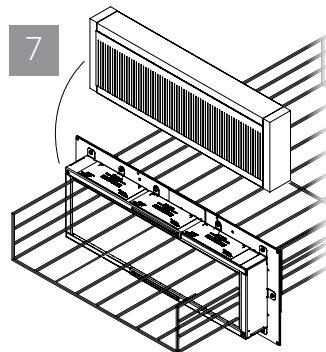

Re-insert intumescent foam strips, foam blocks, and rubber gasket assembly into device as shown.

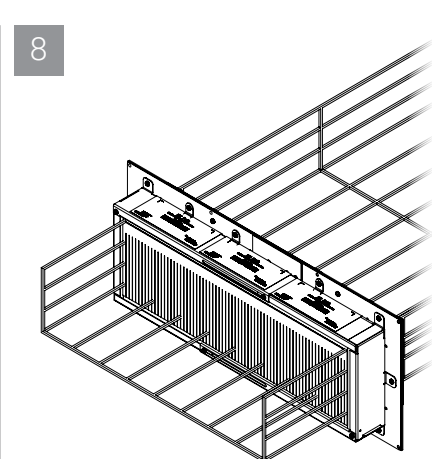

Installation complete.

Note: For more information on firestop installation, refer to ASTM E3157.

Additional framing members shall be used to completely frame around the opening

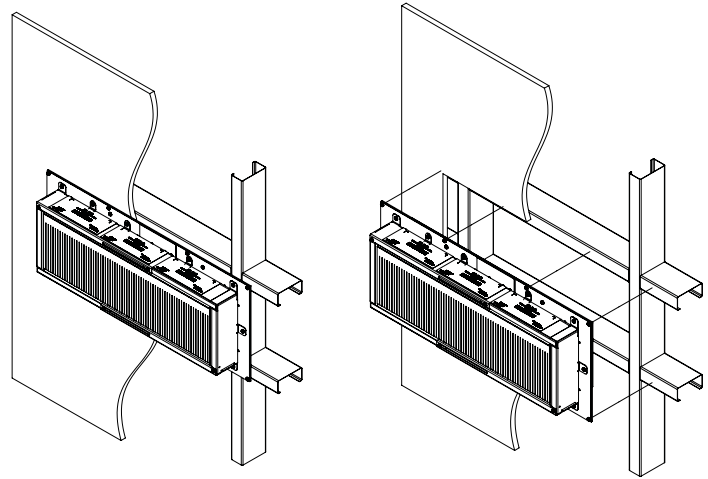

FASTENER TYPES

Type of Wall	Fastener Type
Gypsum Board	No. 8 min 1-1/2 in. (38 mm) long steel screws featuring hi-lo threads and pan-heads
Concrete	3/16" (4.8 mm) diameter steel concrete screws

FRAME AND OPENING DIMENSIONS

Device Used	Frame Size*	Opening Size
EZCTR624	12.04" (306mm) high x 29.44" (748mm) wide	10.75" (273mm) high x 28" (711mm) wide

*combination of the left and right side slim mounting frames

PLATE AND OPENING DIMENSIONS

Device Used	Plate Size**	Opening Size
EZCTR624L	16.75" (425mm) high x 30.91" (785mm) wide	10.75" (273mm) high x 28" (711mm) wide

**combination of the left and right side mounting plates

Note: For more information on firestop installation, refer to ASTM E3157.