

FyreFlange® HVAC Firestop Gasket

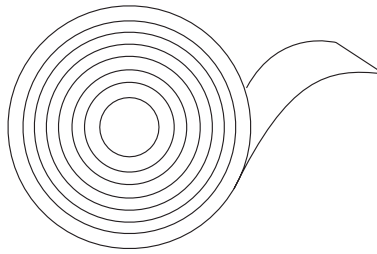

Part Included (Not to Scale)

1

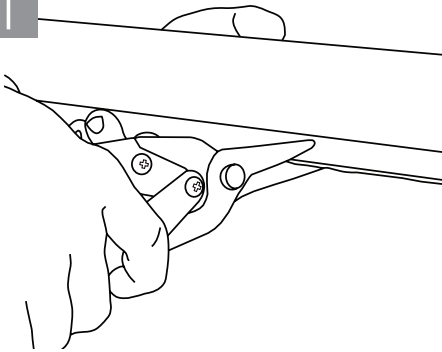

Measure and cut two sections of steel angles 4" (102 mm) longer than duct top and bottom width. Refer to UL systems for additional information regarding the steel angle and use of clips.

2

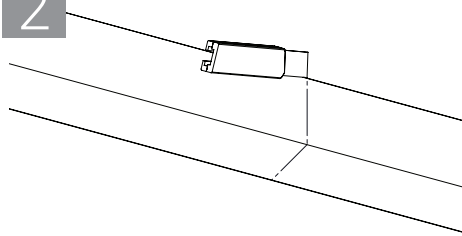

Measure and cut two sections of FyreFlange® Firestop Gasket 4" (102 mm) longer than duct top and bottom width.

3

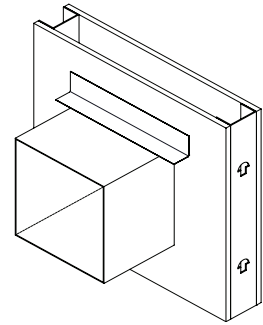

Expose adhesive strip and position FyreFlange® Firestop Gasket such that it extends 2" (51 mm) beyond both ends of the duct. Apply pressure to secure adhesive strip to surface of duct. Repeat process for bottom surface of duct. Alternately, apply gasket to one side of steel angles (Not shown).

4

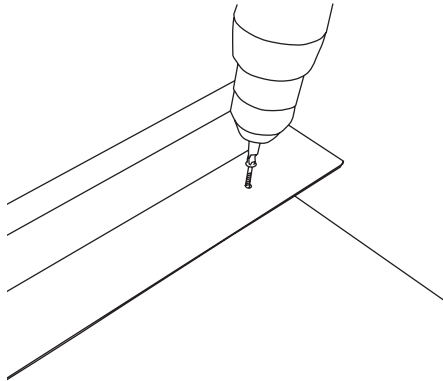

Install steel angle over the surface of the FyreFlange™ Firestop Gasket and position steel angle such that it extends 2" (51 mm) beyond both ends of the duct. Press steel angle in towards barrier, trapping FyreFlange® Firestop Gasket between flange and barrier. Attach steel angle to duct using #10 x 1/2" (13 mm) steel sheet metal screws, spaced max 6" (152 mm) OC. Repeat process for bottom surface of duct.

5

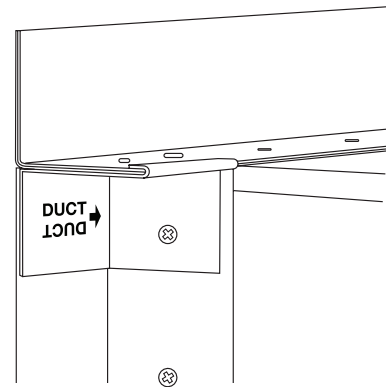

Measure and cut two vertical sections of steel angles and FyreFlange® Firestop Gaskets to fit tightly between the previously installed top and bottom angle/gasket sections. Attach as indicated above. Corner clips (when required) are used to secure vertical and horizontal angles at all corners. Right and Left clips are provided. Clips install over vertical sections and clasp flange of extended horizontal angles. An arrow is stamped on corner clip to assist with proper orientation. Secure clips to vertical angles at all corners using two #10 x 1/2" (13 mm) steel sheet metal screws through each clip.

Note: For more information on firestop installation, refer to ASTM E3157.