

EZ-Path® Oversized Opening Plate Kit
(Part Number: EZCTR600P) For EZ-Path Cable Tray Retrofit
Devices EZCTR612, EZCTR614, EZCTR616, & EZCTR618

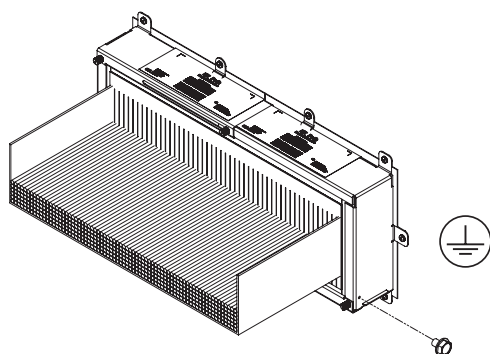

Optional Ground Attachment

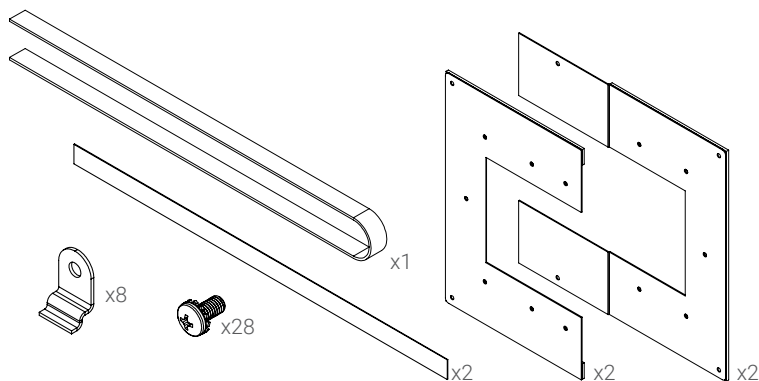

Parts Included (Not to Scale)

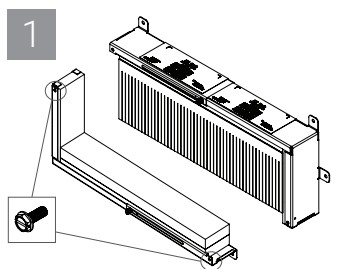

1 Remove corner screws and separate device into two halves.

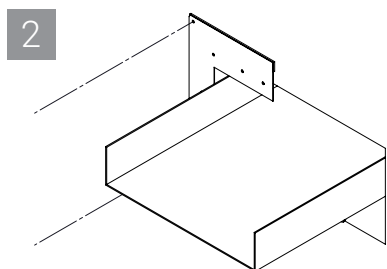

2 Fasten Mounting Plate to wall so that it covers the oversized opening.

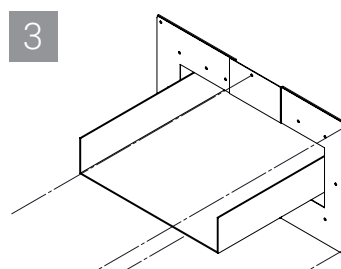

3 Cut to length, peel and stick intumescent gasket to back side of plate where air gap exists. Cut to length, peel and stick closed cell foam tape to intumescent gasket. Repeat for bottom of plate.

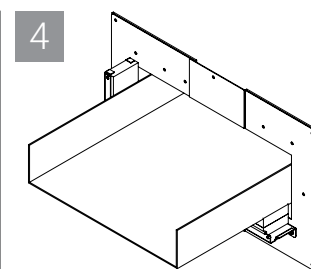

4 Tightly abut bottom half of tray device against underside of cable tray and face of mounting plate. Align holes and fasten mounting tabs of device to mounting plates using the screws provided.

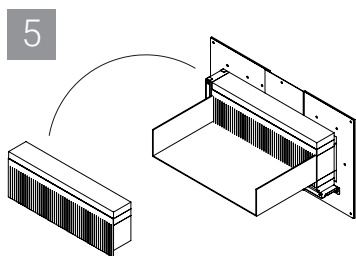

5 Place foam block with skirt into tray.

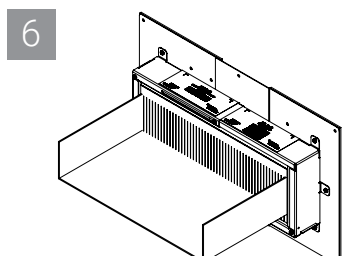

6 Attach top half of device to bottom half by inserting the interlocking tabs into the slots. Secure device halves together using screws from Step 1. Align holes and fasten mounting tabs of device to mounting plates using the screws provided.

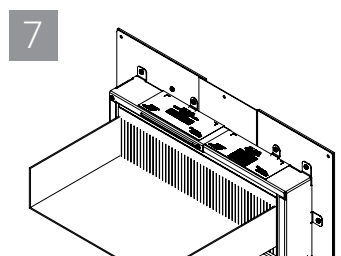

7 Insert provided mounting tabs into slots on top and bottom of device through clear name plates. Align holes and fasten mounting tabs of device to mounting plates using the screws provided. Fill any unoccupied holes using the screws provided.

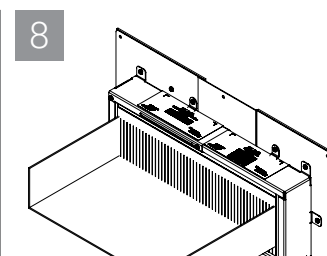

8 Fasten mounting plate to wall using appropriate fasteners (see table A).

Note: For more information on firestop installation, refer to ASTM E3157.



EZ-Path® Oversized Opening Plate Kit (Part Number: EZCTR600P) For EZ-Path Cable Tray Retrofit Devices EZCTR612, EZCTR614, EZCTR616, & EZCTR618

PLATE AND OPENING DIMENSIONS

Device Used	Plate Size*	Opening Size
EZCTR612	14.75" (375 mm) high x 18.75" (476 mm) wide	10" (254 mm) high x 16" (406 mm) wide
EZCTR614	14.75" (375 mm) high x 20.75" (527 mm) wide	10" (254 mm) high x 18" (457 mm) wide
EZCTR616	14.75" (375 mm) high x 22.75" (578 mm) wide	10" (254 mm) high x 20" (508 mm) wide
EZCTR618	14.75" (375 mm) high x 24.75" (629 mm) wide	10" (254 mm) high x 22" (559 mm) wide

TABLE A: FASTENER TYPES

Type of Wall	Fastener Type
Gypsum Board	No. 8 min 1-1/2 in. (38 mm) long steel screws featuring hi-lo threads and pan-heads
Concrete	3/16" (4.8 mm) diameter steel concrete screws

*combination of the left and right side mounting plates

Note: For more information on firestop installation, refer to ASTM E3157.