

MDM150 Fire-Rated Cable Transit

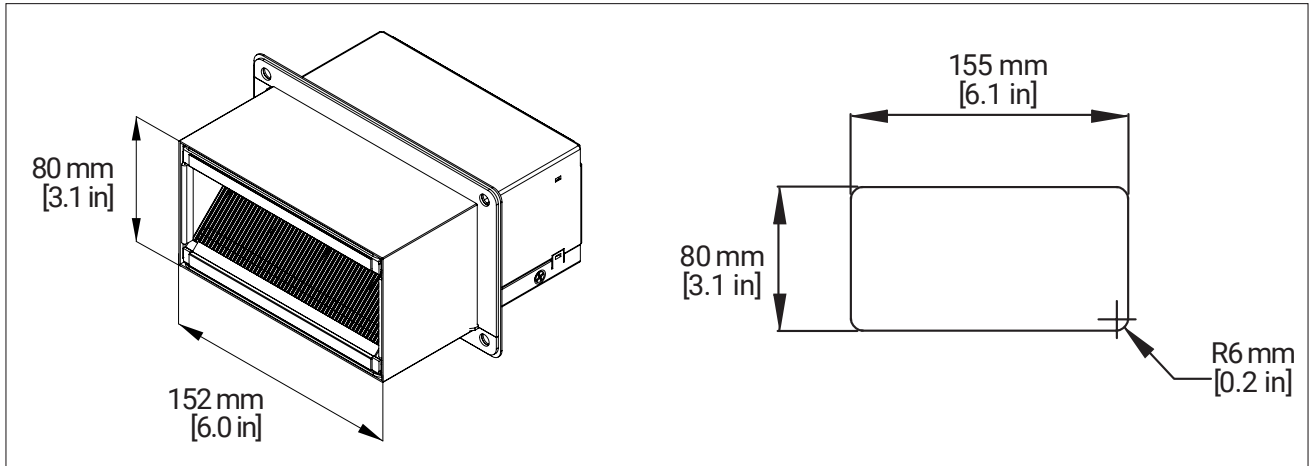

MDM150C - Deck or Bulkhead Installation (Screw Attachment)

Tools & Parts Needed



x4 - #10 x min 13 mm
stainless steel screws

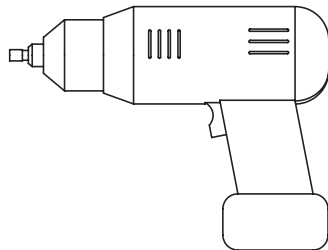

1

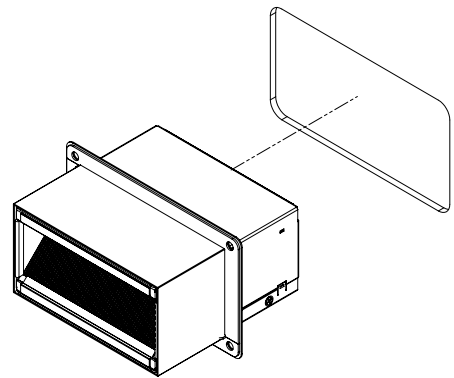

Insert device into opening with gasket against division.

2

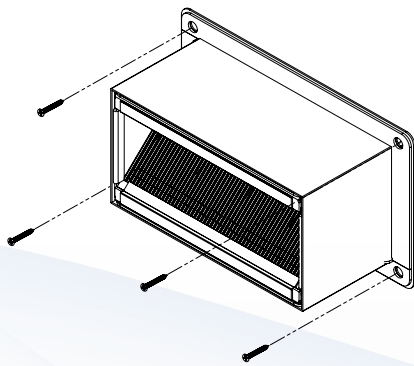

Fasten to division using steel screws (not included).

3

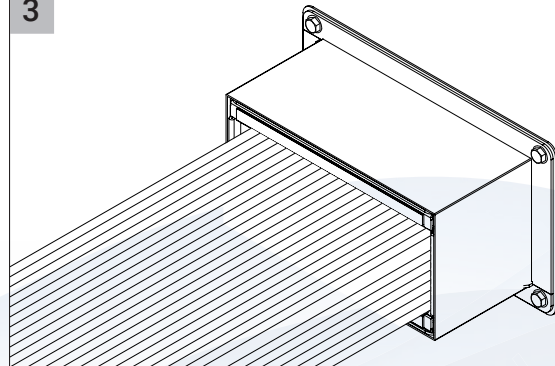

Install cables through pathway.

Note: Please refer to Type Approval Certificates for insulation requirements, maximum opening dimensions and approved attachment methods.



MDM150 Fire-Rated Cable Transit

MDM150C - Deck or Bulkhead Installation (Threaded Stud and Nut Attachment)

Tools & Parts Needed

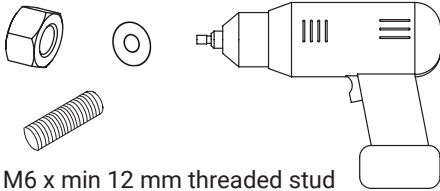

x4 M6 x min 12 mm threaded stud
x4 M6 Aluminum Nylon-insert Locknuts
x4 M6 Screw Size Nylon Washer

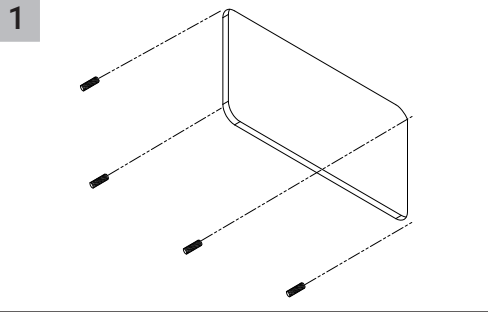

1 Cut opening in division. Insert pathway into opening & mark holes at the four corners. Remove pathway & weld aluminum M6 x min 12 mm long threaded studs (not included) to the division at marked locations.

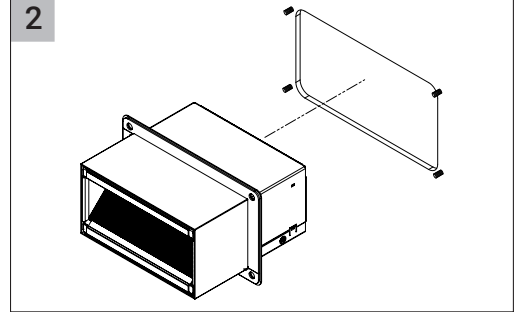

2 Insert pathway into opening with gasket against division. Aluminum threaded studs to slide through openings in retaining attachment plate.

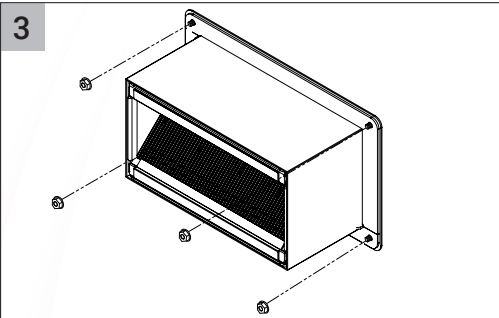

3 Fasten pathway to division using aluminum threaded studs with nylon locknuts & nylon washers (not included).
Recommended torque: 2.8-3.0 N-m

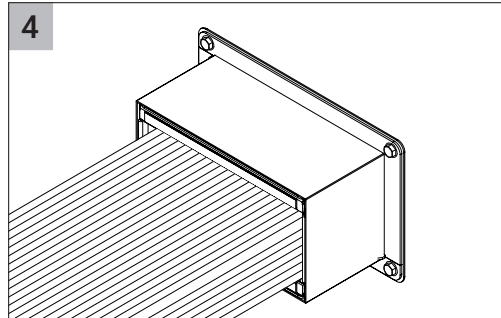

4 Install cables through pathway.

Note: Please refer to Type Approval Certificates for insulation requirements, maximum opening dimensions and approved attachment methods.



MDM150 Fire-Rated Cable Transit

MDM150C - Retrofitting for Installation Around Existing Cables

Tools & Parts Needed

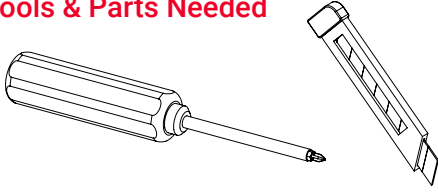

Box cutter
Phillips head screw driver

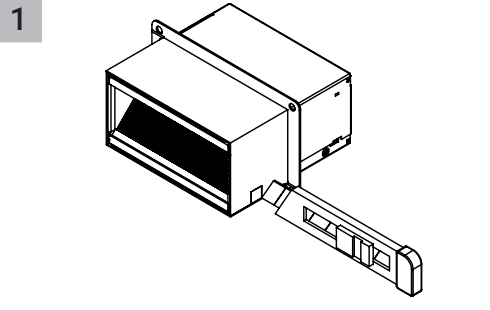

1 Peel back tabs in intumescent wrap to reveal screws.

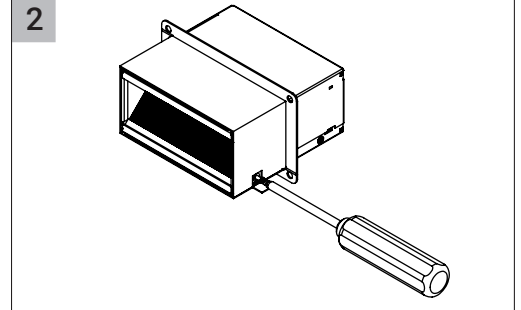

2 Unscrew all four screws holding transit halves together. Save screws for reassembly.

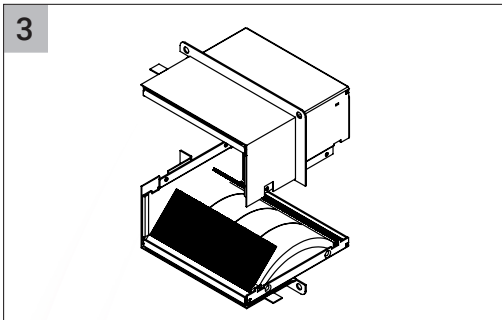

3 Split transit apart.

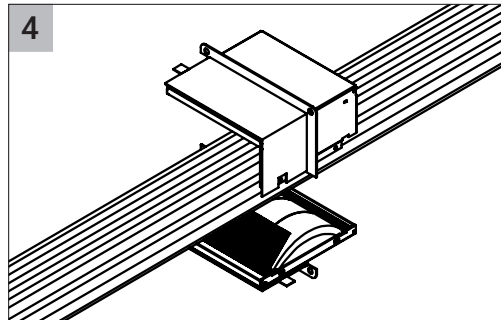

4 Position transit halves around cables.

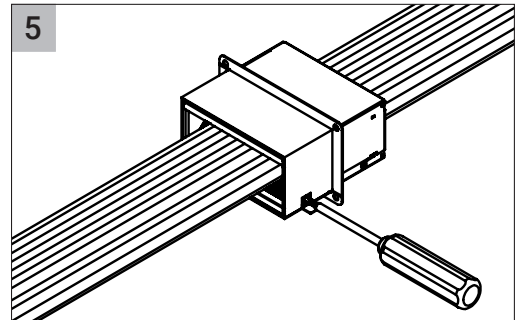

5 Tighten screws to secure transit halves back together.

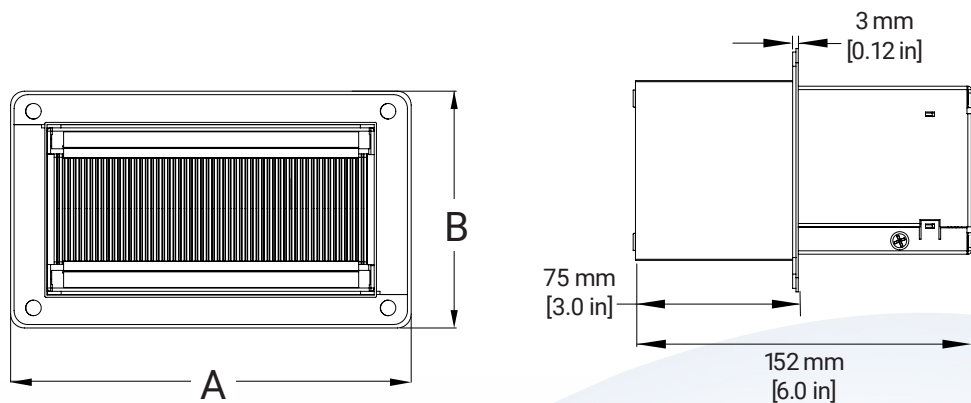

TRANSIT DIMENSIONS				
Catalog Number	(A)		(B)	
	mm	in	mm	in
MDM150C	184	7.2	109	4.3

Note: Please refer to Type Approval Certificates for insulation requirements, maximum opening dimensions and approved attachment methods.



STI Marine Firestop • Somerville, NJ 08876 USA • Toll Free: (800)-992-1180
 Outside US: +1-908-526-8000 • Warranty Information: www.stimarine.com/legal/warranty
 MADE IN THE USA – © 2020 STI Marine Firestop • www.stimarine.com
 ZIS1291 19922 • Page 3 of 3



scan for installation video