

IRONCRAFT

Contact your Authorized Ironcraft Dealer
for all your parts needs

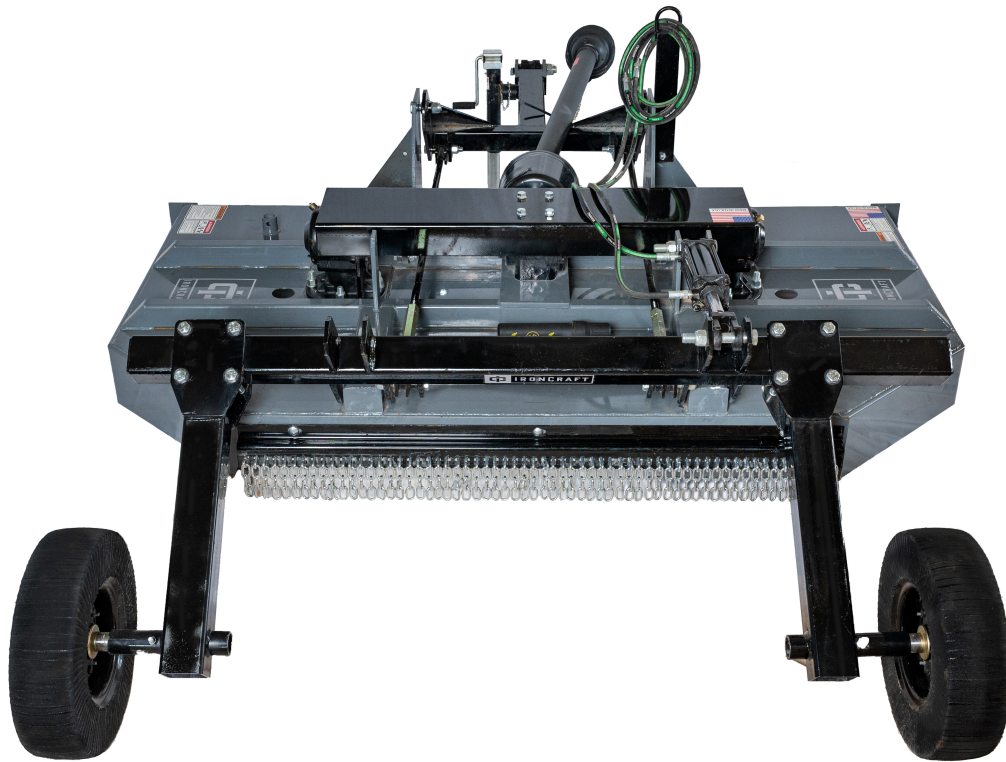

1700 / 1800 SERIES PULL TYPE ROTARY CUTTER PARTS MANUAL

13.1 Hitch Assembly

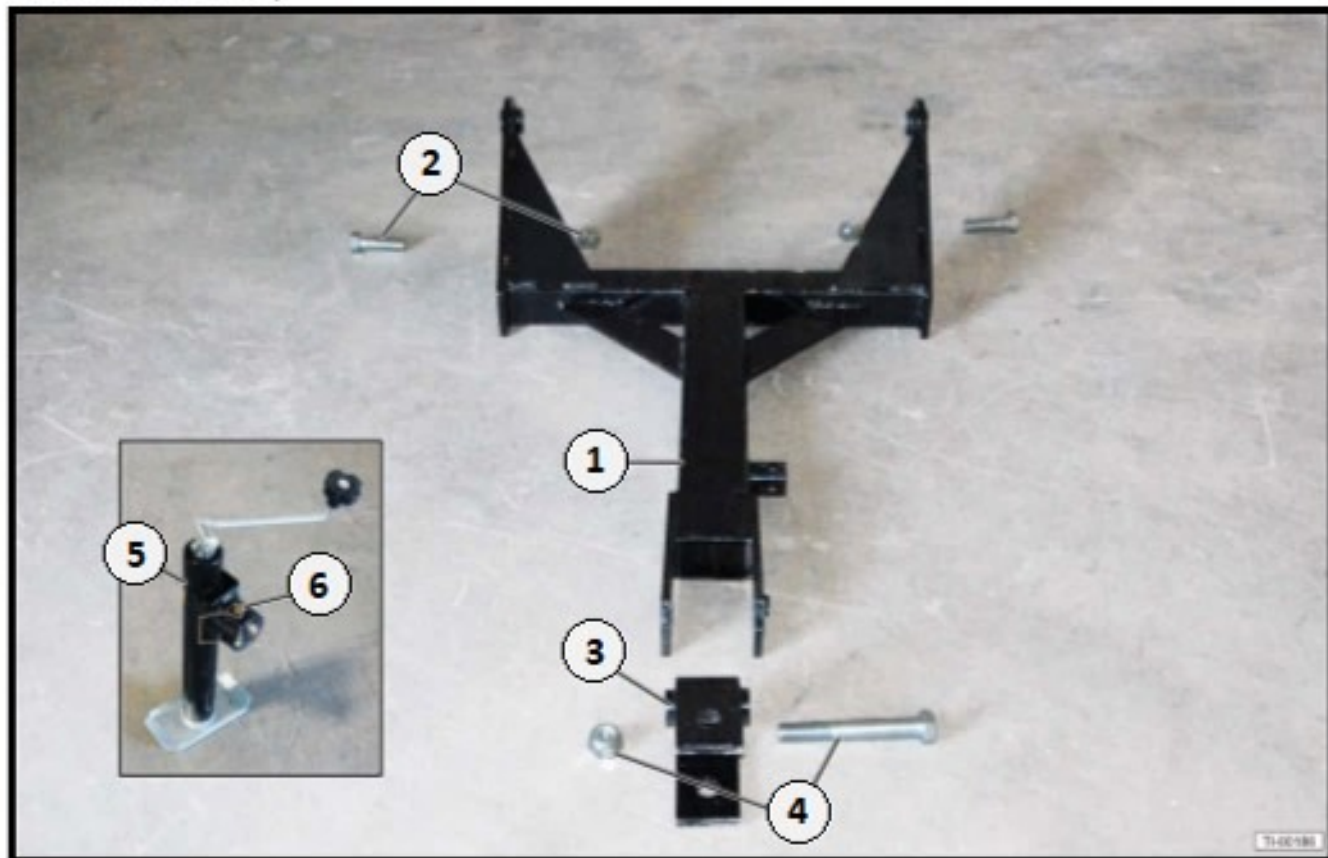

Item	Part #	Description	Qty
1	170007	Hitch (1708P)	1
	180021	Hitch (1808P – 1810P)	1
2	180022	Bolt & Locknut Kit 1"-8 x 3"	2
3	180023	Clevis	1
4	170022	Bolt & Locknut Kit 1-1/4" x 7"	1
5	180024	Jack	1
6	180025	Jack Retaining Pin	1

13.2 Deck Assembly

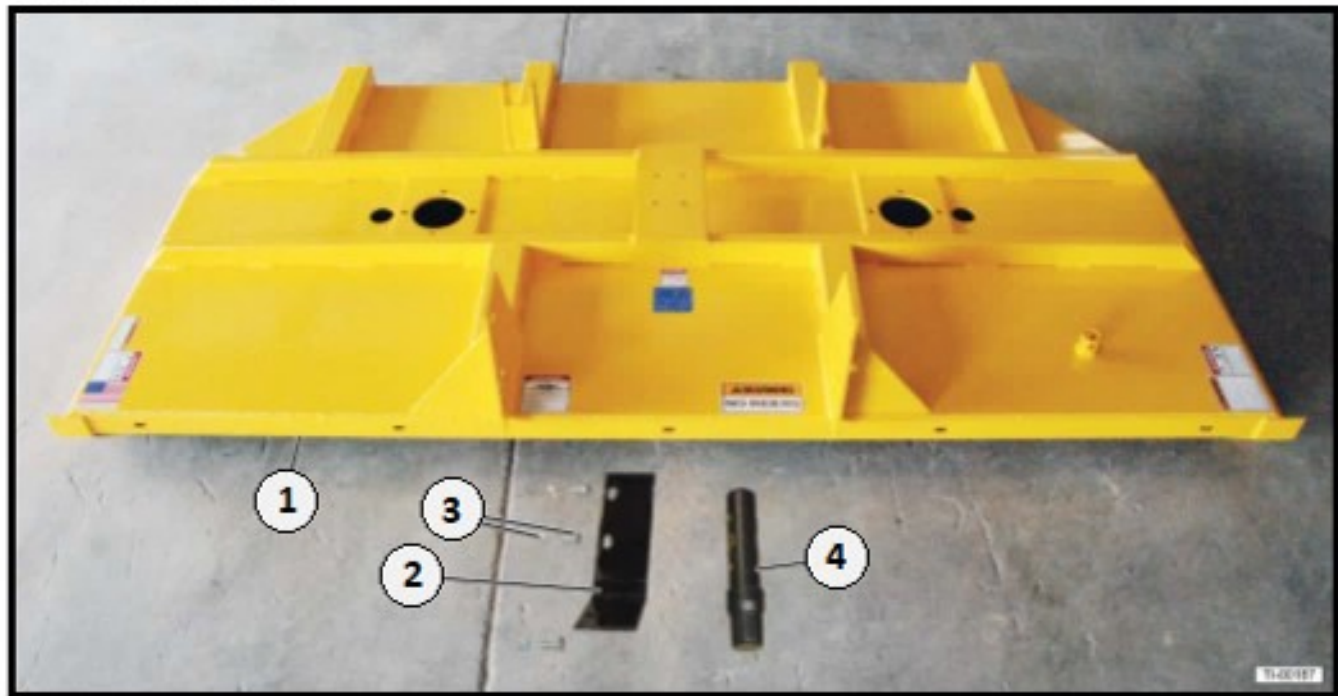

Item	Part #	Description	Qty
1	170011	8-ft Pull Type Deck Only with Decals (1708P) – RED	1
	170012	8-ft Pull Type Deck Only with Decals (1708P) – GREEN	
	170013	8-ft Pull Type Deck Only with Decals (1708P) – ORANGE	
	170014	8-ft Pull Type Deck Only with Decals (1708P) – YELLOW	
	170015	8-ft Pull Type Deck Only with Decals (1708P) – BLUE	
	170016	8-ft Pull Type Deck Only with Decals (1708P) – GREY	
2	120010	Skid Shoes (Sold in Pairs)	1
3	120011	Carriage Bolt & Locknut Kit 1/2" x 1-1/2" (6-Pack)	3
4	110034	Document Holder with Screws	1

Item	Part #	Description	Qty
1	180042	8-ft Pull Type Deck Only with Decals (1808P) – RED	1
	180043	8-ft Pull Type Deck Only with Decals (1808P) – GREEN	
	180044	8-ft Pull Type Deck Only with Decals (1808P) – ORANGE	
	180045	8-ft Pull Type Deck Only with Decals (1808P) – YELLOW	
	180046	8-ft Pull Type Deck Only with Decals (1808P) – BLUE	
	180047	8-ft Pull Type Deck Only with Decals (1808P) – GREY	
2	120010	Skid Shoes (Sold in Pairs)	1
3	120011	Carriage Bolt & Locknut Kit 1/2" x 1-1/2" (6-Pack)	3
4	110034	Document Holder with Screws	1

Item	Part #	Description	Qty
1	180048	10-ft Pull Type Deck Only with Decals (1810P) – RED	1
	180049	10-ft Pull Type Deck Only with Decals (1810P) – GREEN	
	180050	10-ft Pull Type Deck Only with Decals (1810P) – ORANGE	
	180051	10-ft Pull Type Deck Only with Decals (1810P) – YELLOW	
	180052	10-ft Pull Type Deck Only with Decals (1810P) – BLUE	
	180053	10-ft Pull Type Deck Only with Decals (1810P) – GREY	
2	120010	Skid Shoes (Sold in Pairs)	1
3	120011	Carriage Bolt & Locknut Kit 1/2" x 1-1/2" (6-Pack)	3
4	110034	Document Holder with Screws	1

13.3 Tailwheel Assembly

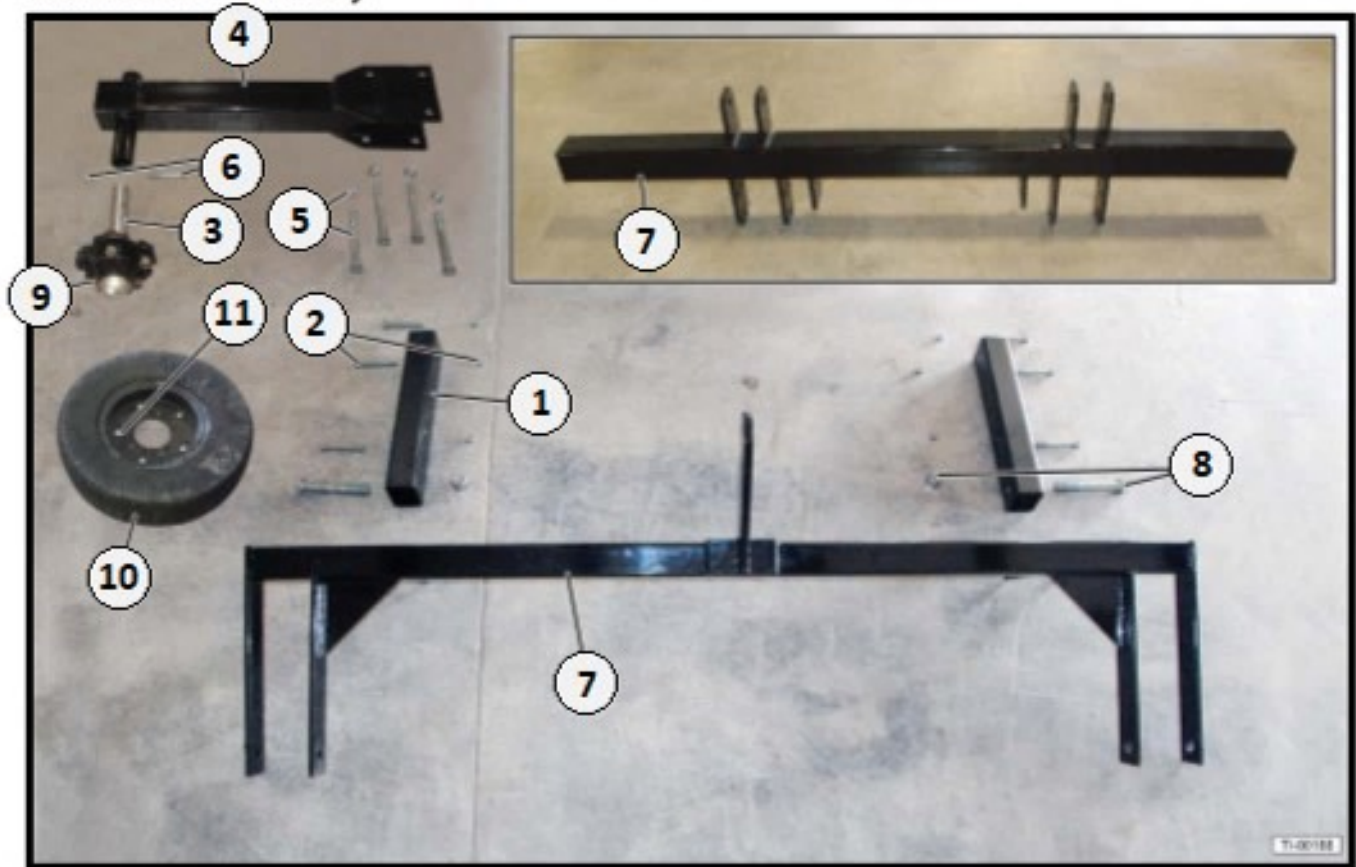

Item	Part #	Description	Qty
1	170010	Tailwheel Tube (1708P)	2
2	120003	Bolt & Locknut Kit 1/2" x 4-1/2" for Tailwheel Tube (1708P)	6
3	180038	Spindle Assembly (1808P-1810P)	2
4	180037	Spindle Tube (1808P-1810P)	2
5	150047	Bolt & Locknut Kit 3/4" x 6" for Spindle Tube (1808P-1810P)	8
6	180039	Bolt & Locknut Kit 1/2" x 3-1/2" for Spindle (1808P-1810P)	2
7	170009	Tailwheel Tube/Fork (1708P)	1
	180035	Tailwheel Tube (1808P-1810P)	1
8	110020	Bolt & Locknut Kit - Axle 1"-8 x 7-1/2"	2
9	110021	Zerk Fitting	1
10	110022	Laminated Wheel (1708P)	2
	180040	Laminated Wheel 20" (1808P-1810P)	2
11	110023	Bolt, Lockwasher & Locknut Kit 5/16" x 3/4"	10

13.4 Leveling Rods

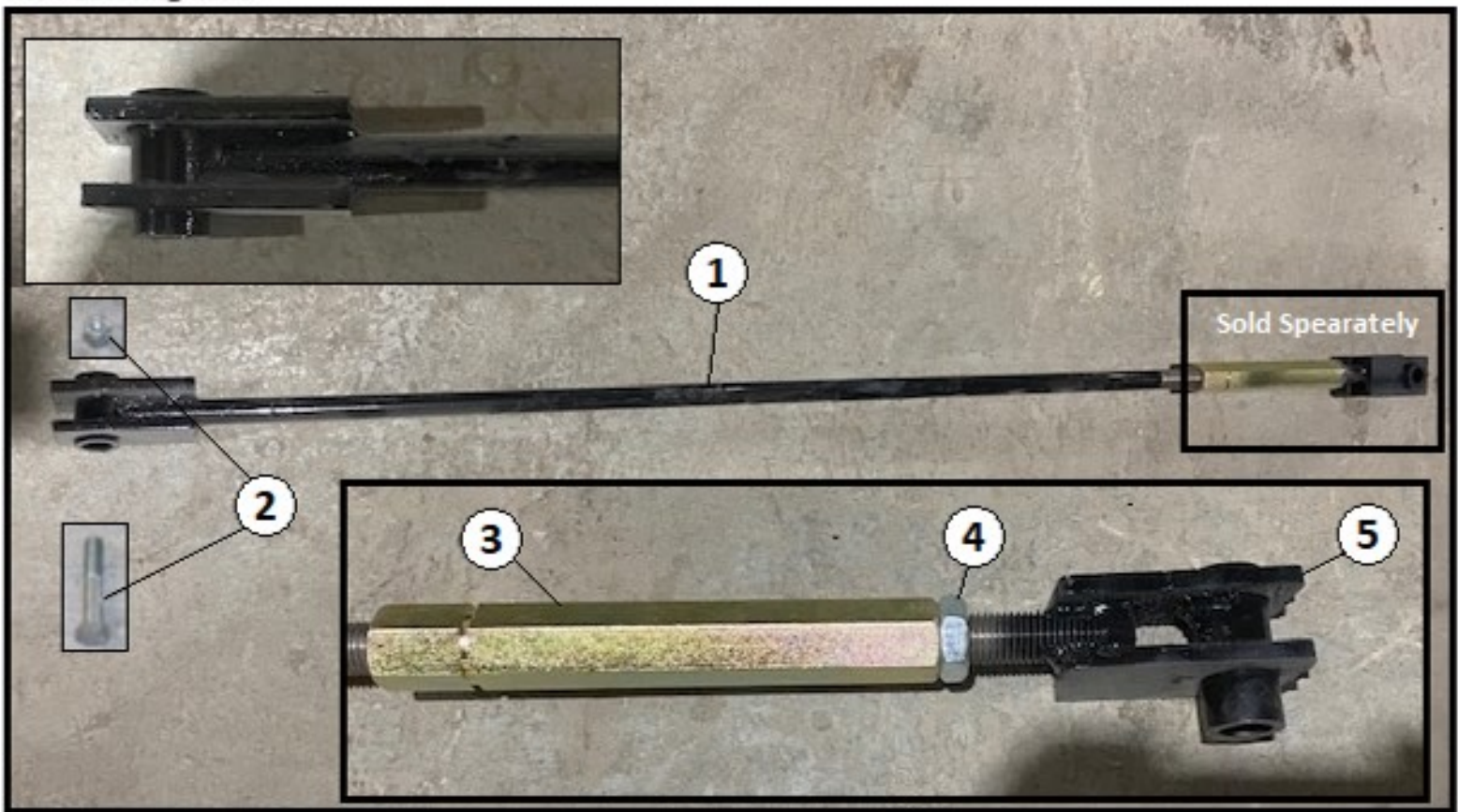

Item	Part #	Description	Qty
1	180026	LEVELING ROD (8-ft) 50.25"	2
	180027	LEVELING ROD (10-ft) 50.25"	2
2	140004	BOLT & LOCKNUT KIT 5/8" X 5 (1808P-1810P)	4
	170008	BOLT & LOCKNUT KIT 5/8" X 4" (1708P)	4
3	191229	LEVELING ROD ADJUSTER	2
4	351508	JAM NUT 7/8"	2
5	180054	SHORT LEVELING ROD (8-ft) 6.125"	2
	180055	SHORT LEVELING ROD (10-ft) 10.625"	2

13.5 Hydraulic System

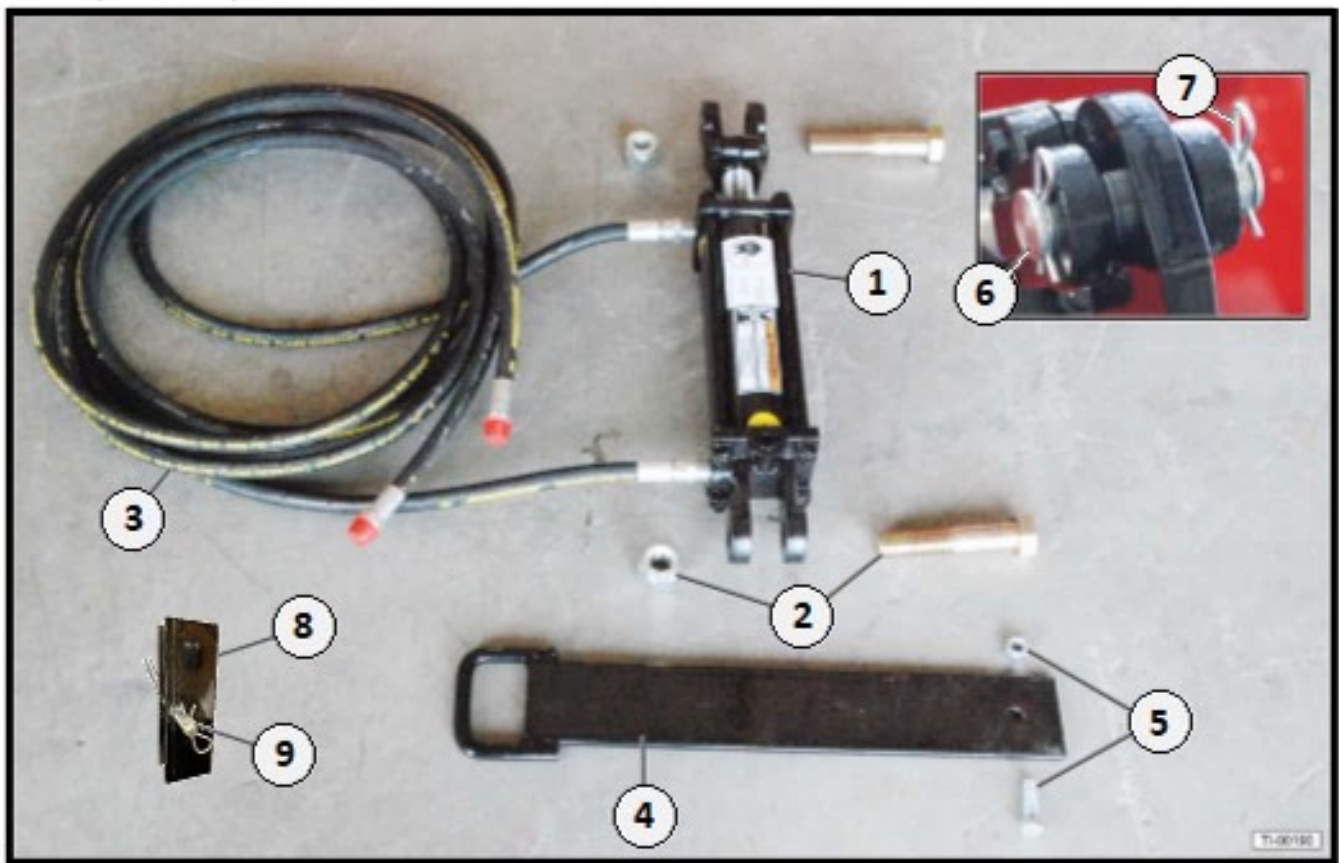

Item	Part #	Description	Qty
1	180030	Hydraulic Cylinder 3"x 8"	1
2	180031	Bolt & Locknut Kit 1"-8 x 5" for Hyd. Cyl. (1808P-1810P)	2
3	180032	Hydraulic Hose - 168"	2
4	180033	Hyd. Hose Support Bracket	1
5	180034	Bolt & Locknut Kit 3/8"x 1-1/2" for Hose Support Brkt.	1
6	170023	Hydraulic Cylinder Pin (1708P)	2
7	170024	Cyl. Pin Clip (1708P)	4
8	180057	Transport Lock	1
9	310034	Pin - Transport Lock	1

13.6 Driveline Assembly

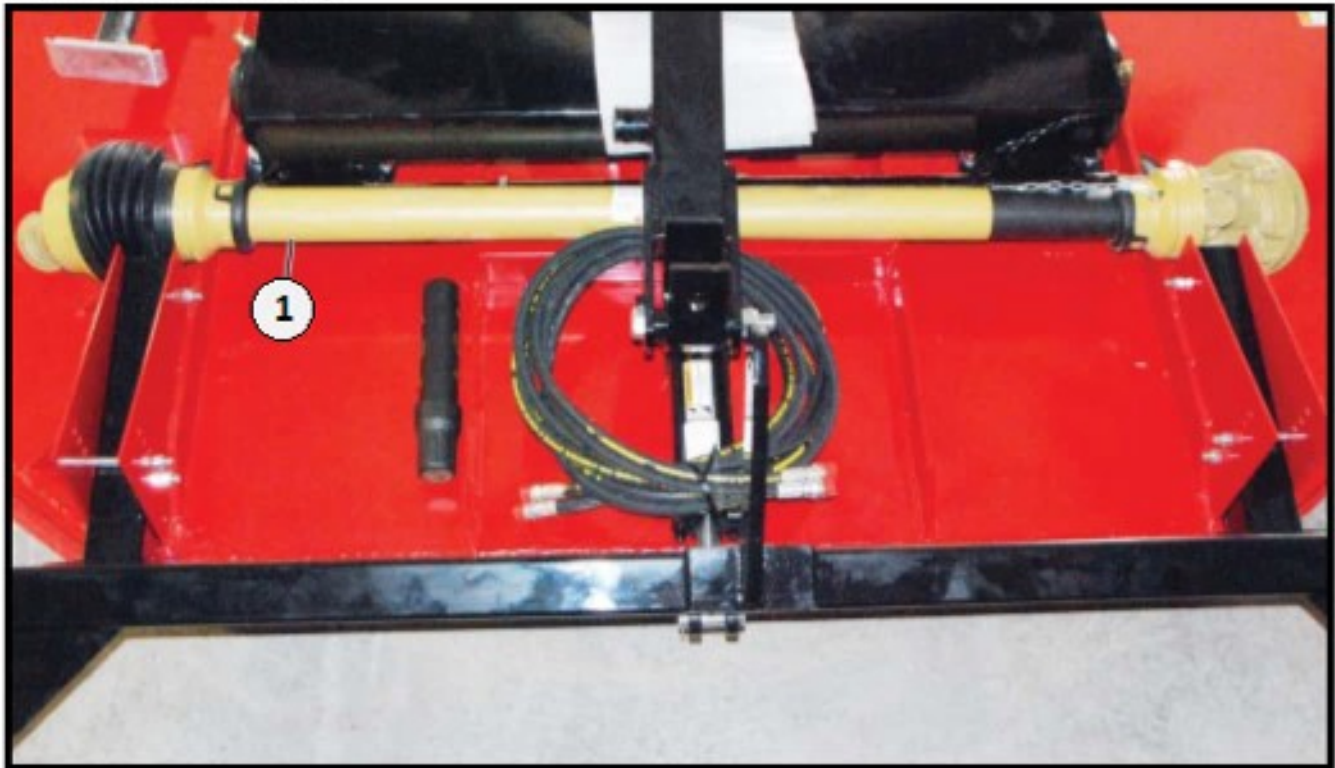

Item	Part #	Description	Qty
1	180041	C.V. Driveline – Series 6 with Slipclutch	1

8-Ft. / 10-Ft. PULL TYPE C.V. Driveline Components

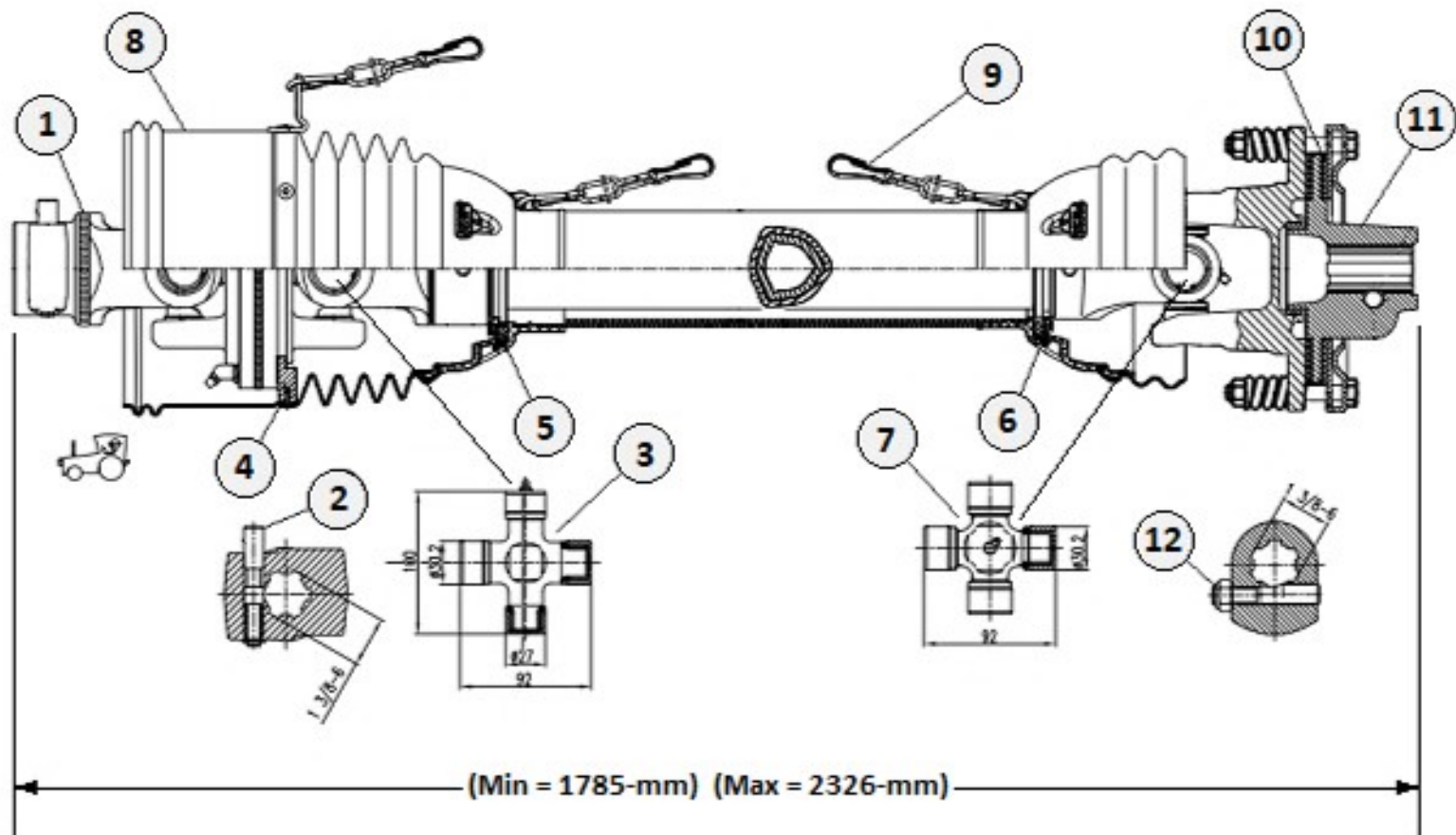

180041 - COMPLETE DRIVELINE

Item	Part #	Description	Qty
1	552050	Tractor Yoke with Push Pin	1
2	552051	Push Pin Kit for Tractor Yoke	1
3	552052	Cross Kit - 27 / 30.2 x 100	2
4	552053	Fixed Ring for C.V. Shield	1
5	552054	Outer Plastic Shield Bearing	1
6	552055	Inner Plastic Shield Bearing	1
7	552056	Cross Kit - 30.2 x 92	1
8	552057	Complete Safety Shield	1
9	552005	Safety Chain	3
10	552058	Clutch lining (2-Pack)	1
11	552059	Complete Slipclutch	1
12	552060	Pin Kit for Slipclutch	1

CONNECTOR SHAFT COMPONENTS

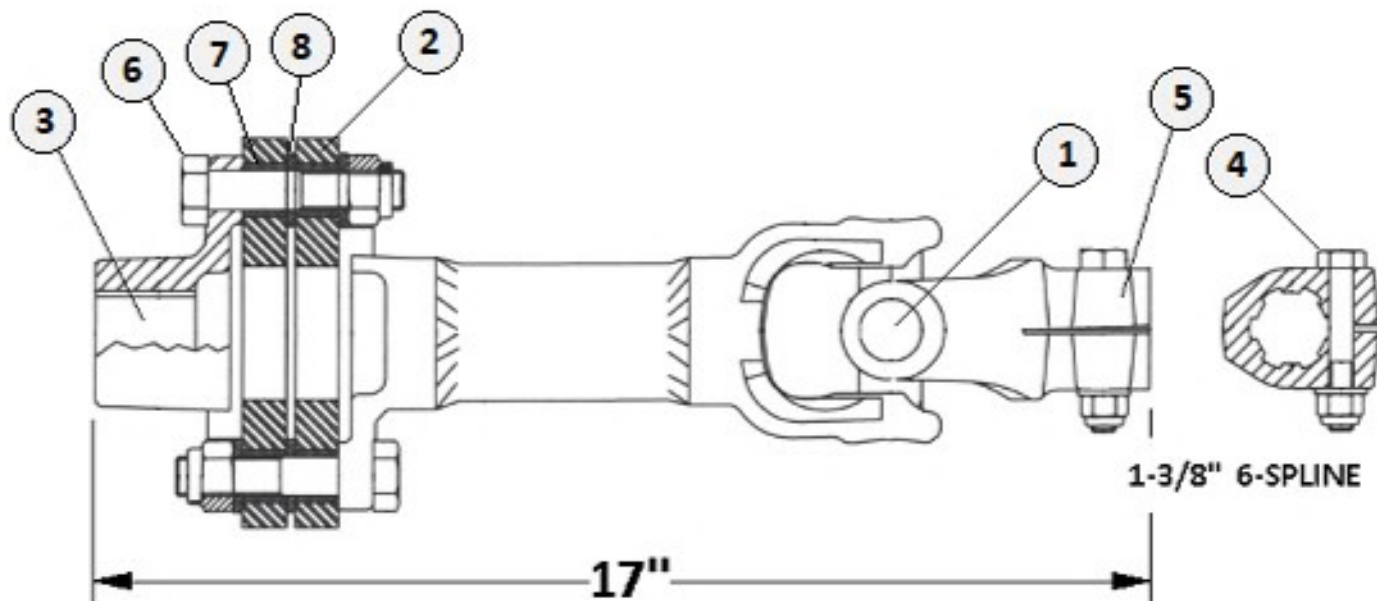

180003 - Complete Connector Shaft for (10-Ft. Cutter)

Item	Part #	Description	8-ft	10-ft
1	552130	Cross Kit – 30.2 x 80	1	1
2	552131	Rubber Pad	1	2
3	552133	Spider – 1-3/8" 6-Spline	1	1
4	552134	Lock Bolt	---	1
5	552132	Yoke – 1-3/8" 6-Spline	---	1
6	552136	Bolt M16 x 60	6	6
7	552137	Spacer	6	6
8	552138	Shim Washer M16	12	12
9	552139	Yoke – 1-3/8" 6-Spline	1	---

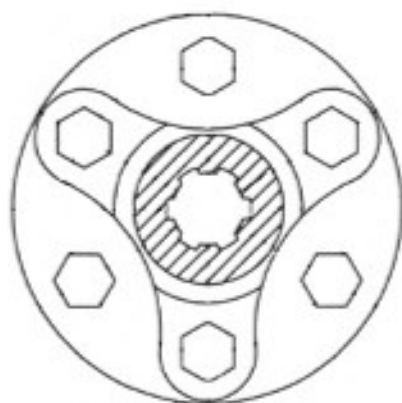

1-3/8" 6-SPLINE

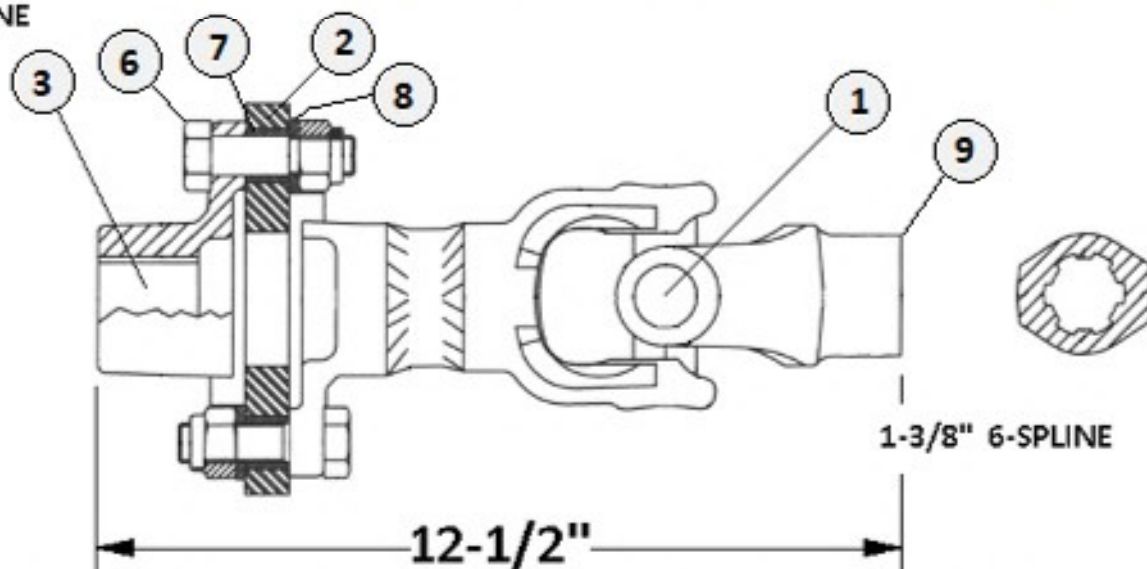

180002 - Complete Connector Shaft for (8-Ft. Cutter)

13.8 Cutter Drive System

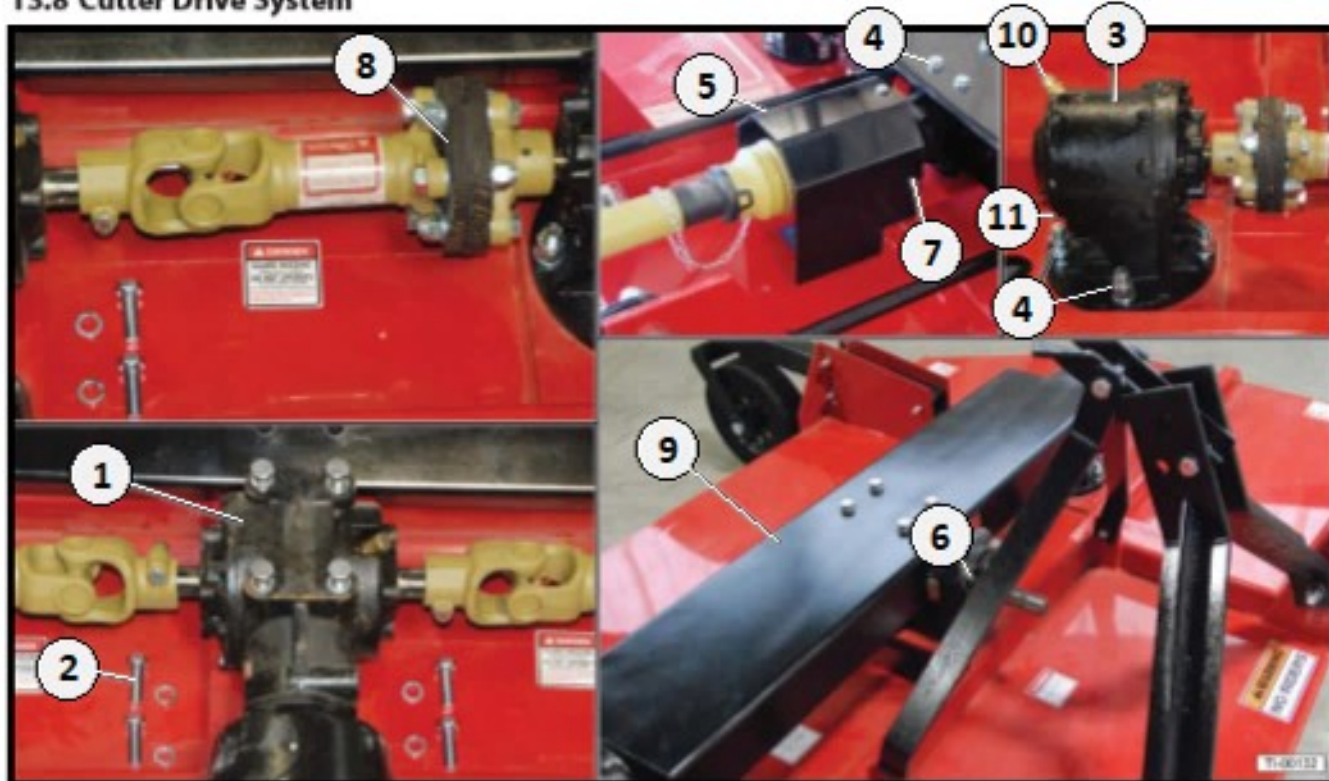

Item	Part #	Description	Qty
1	180000	Gearbox – Center Tee	1
2	180001	Bolt, Lockwasher & Locknut Kit 5/8" x 1-1/4" – for Center Tee G/Box	4
3	130000	Gearbox, Slipclutch Style 100-Hp 1:1.46 Ratio	2
	150027	Gearbox, Slipclutch Style 100-Hp 1:1.93 Ratio	A/R
4	110068	Bolt, Lockwasher & Locknut Kit 3/4" x 3" for Outboard G/Box	8
	170021	Bolt, Lockwasher & Locknut Kit 5/8" x 1-1/2" for Center Tee G/Box	4
5	150076	Gearbox Shield – Plastic (Replaces Metal Shield)	1
6	110006	Bolt & Washer Kit 5/16" x 1/2" (4Pack)	1
7	110017	Bolt & Lockwasher Kit 1/2" x 1-1/2" (for old style Metal Shield)	3
8	180002	Shock Coupler for 8-ft Models	2
	180003	Shock Coupler for 10-ft Models	2
9	180004	Center Gearbox Shield for 8 & 10-ft Models	1
10	110008	Gearbox Vent Plug	2
11	110009	Gearbox Drain Plug	2

A/R = As Required

125 Hp - CENTER T-BOX

Used on Models: 1700 - 1800

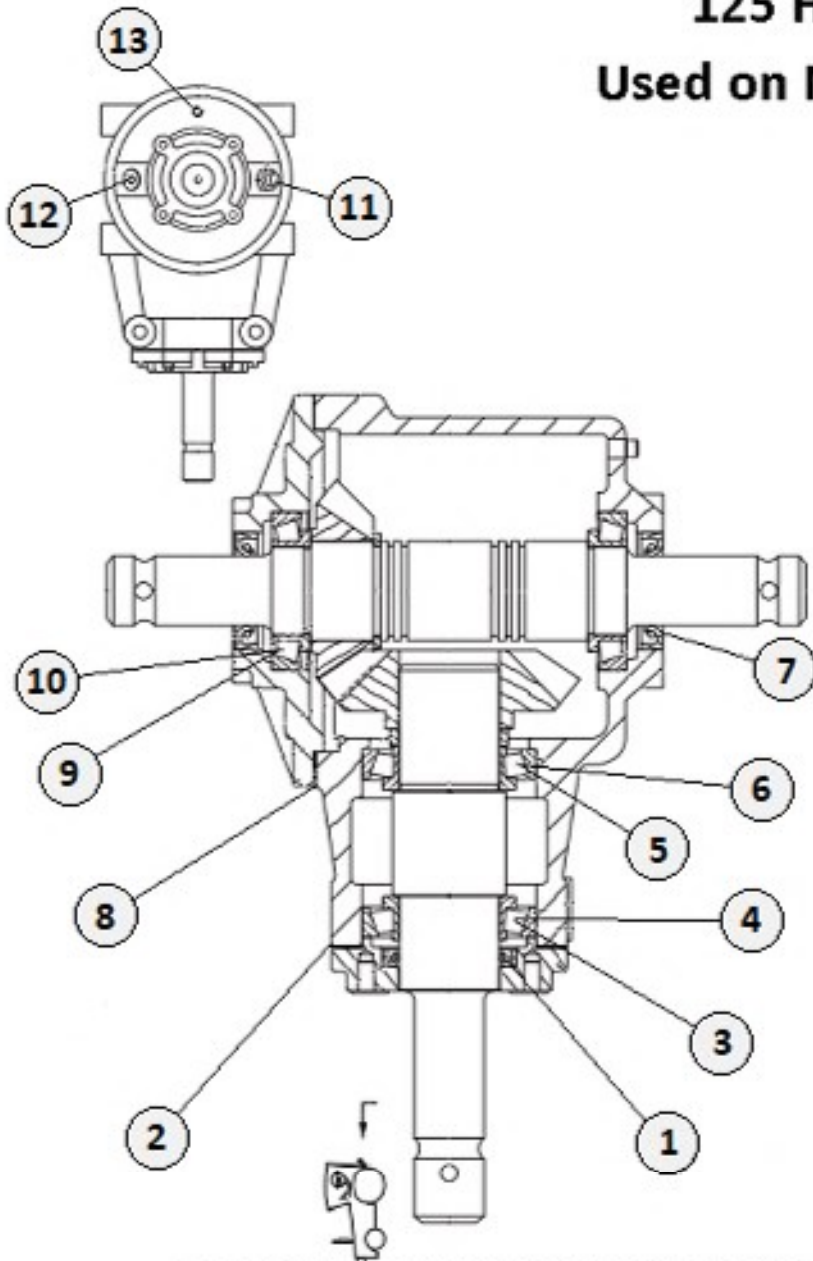

180000 - COMPLETE "T" GEARBOX

Item	Part #	Description	10-ft
1	551050	Input Seal	1
2	551051	Input Gasket Kit	1
3	551026	Input Cone Bearing – Front	1
4	551027	Input Bearing Cup - Front	1
5	551024	Input Cone Bearing – Rear	1
6	551025	Input Bearing Cup – Rear	1
7	551052	Output Seal	2
8	551021	Output Gasket Kit	1
9	551022	Output Cone Bearing	2
10	551023	Output Bearing Cup	2
11	110008	Pressure Relief Plug	1
12	551053	Drain Plug (Allen Head)	1
13	110009	Pipe Plug (Square Head)	1

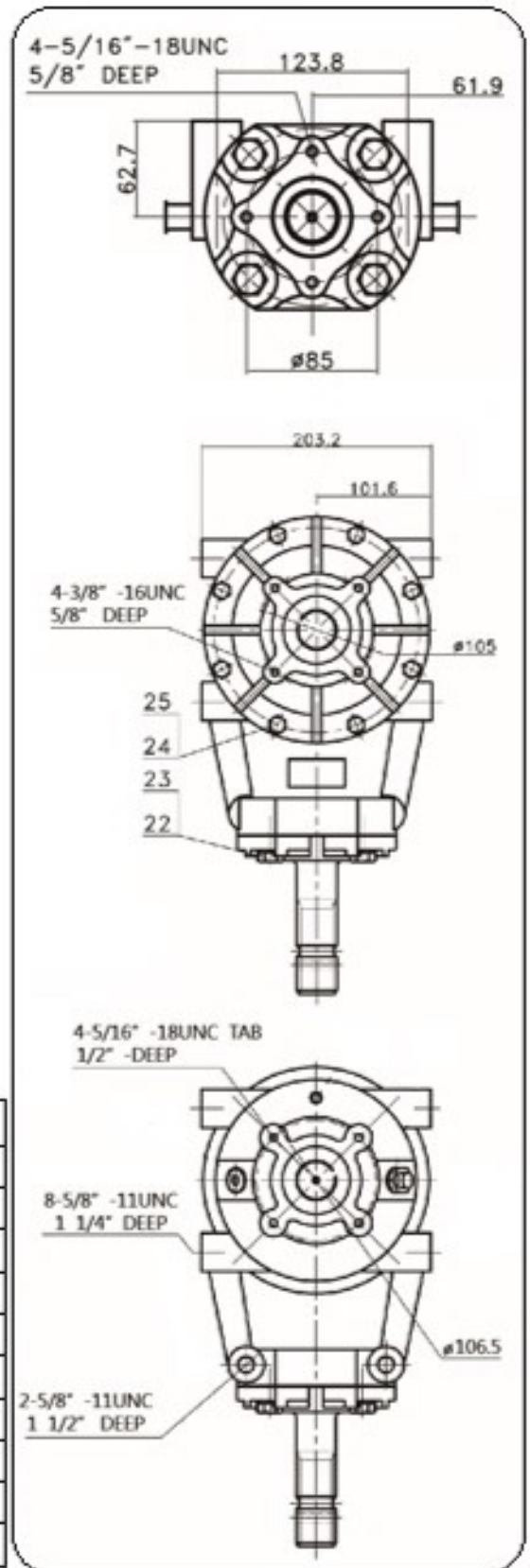

100 Hp GEARBOX

used on Models: 1700 - 1800

Note: Complete Gearbox
 150027 610-Series 1:1.93 Ratio
 130000 610-Series 1:1.46 Ratio

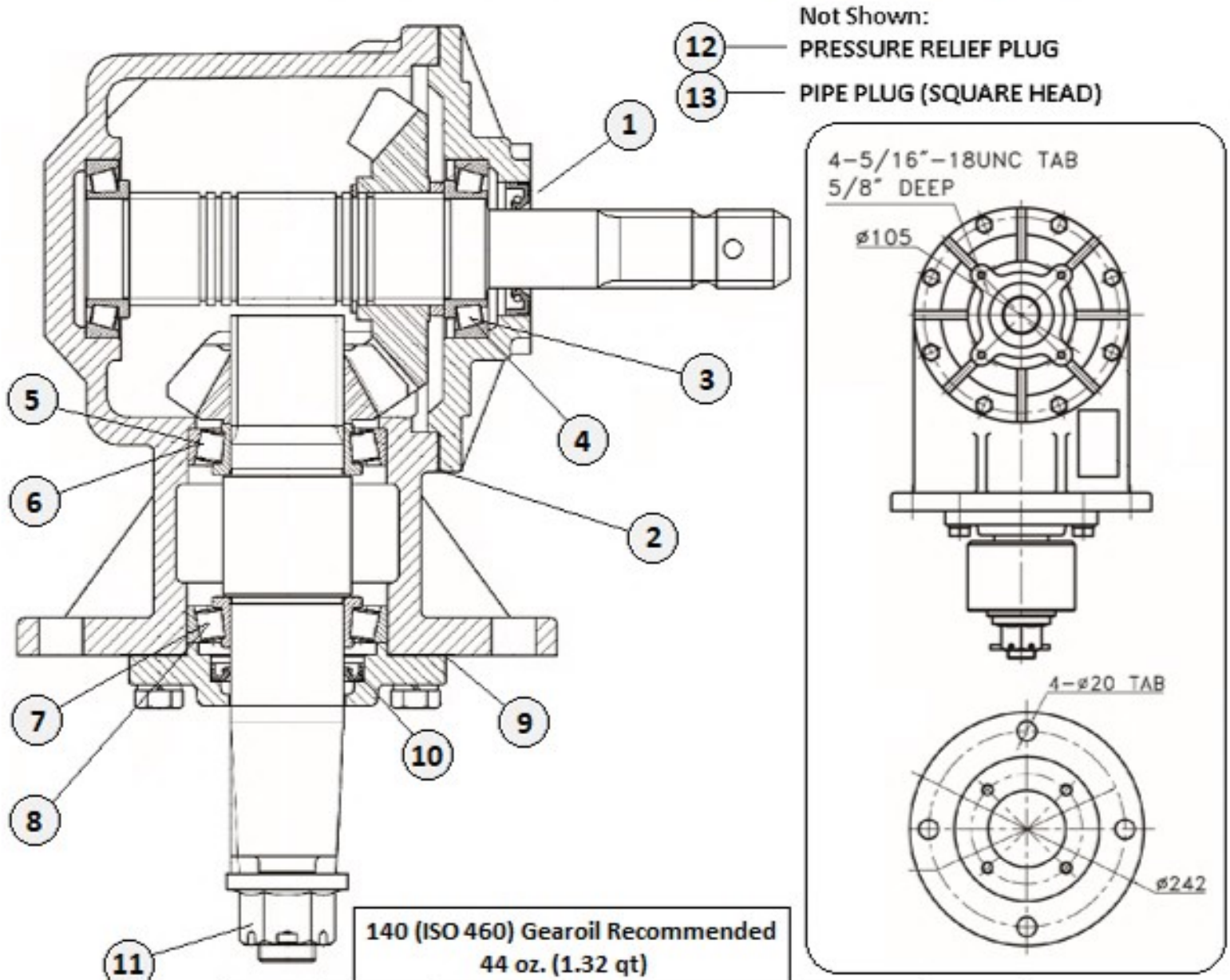

Item	Part #	Description	Qty
1	551020	Input Seal	1
2	551021	Input Gasket Kit	1
3	551022	Input Cone Bearing	2
4	551023	Input Bearing Cup	2
5	551024	Output Cone Bearing – Top	1
6	551025	Output Bearing Cup – Top	1
7	551026	Output Cone Bearing – Bottom	1
8	551027	Output Bearing Cup – Bottom	1
9	551028	Output Gasket Kit	1
10	551029	Output Seal	1
11	110013	Castle Nut / Cotter Pin Kit 1" Fine Thread	1
12	110008	Pressure Relief Plug	1
13	110009	Pipe Plug (Square Head)	1

150 HP Gearbox Components (1000-Rpm)

RW81 1.21:1 Ratio

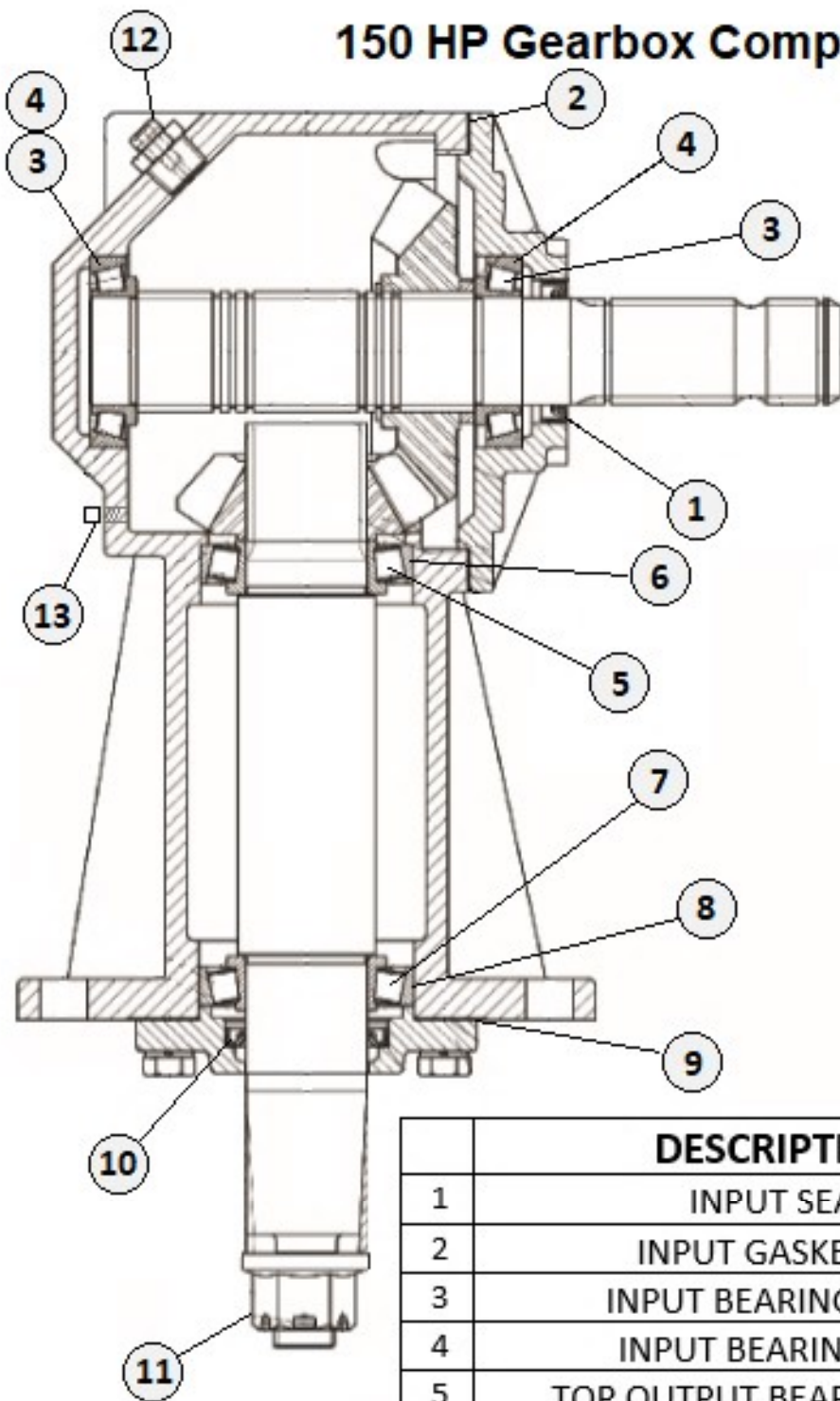

1-3/8" 6-Spline

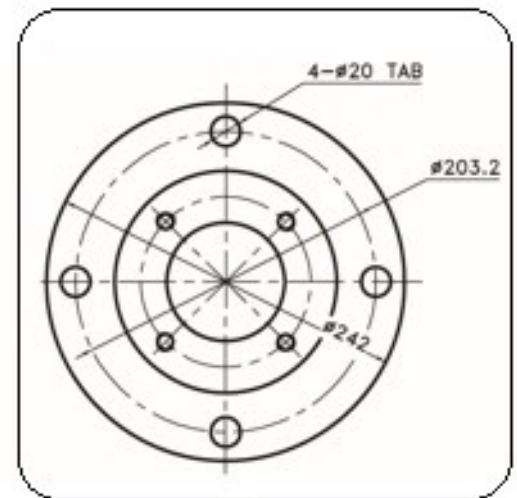

140 (ISO 460) Gearoil Recommended
Fill level 44-oz. (1.32-Qt)

	DESCRIPTION	Item #	Qty
1	INPUT SEAL	551040	1
2	INPUT GASKET KIT	551021	1
3	INPUT BEARING CONE	551022	2
4	INPUT BEARING CUP	551023	2
5	TOP OUTPUT BEARING CONE	551024	1
6	TOP OUTPUT BEARING CUP	551025	1
7	BOTTOM OUTPUT BEARING CONE	551026	1
8	BOTTOM OUTPUT BEARING CUP	551027	1
9	OUTPUT GASKET KIT	551028	1
10	OUTPUT SEAL	551029	1
11	CASTLE NUT/COTTER PIN KIT	110013	1
12	PRESSURE RELIEF PLUG	110008	1
13	SQ. HEAD PIPE PLUG	110009	1
COMPLETE G/BOX 150-HP (1000-Rpm)		150035	

13.9 Blade Assembly

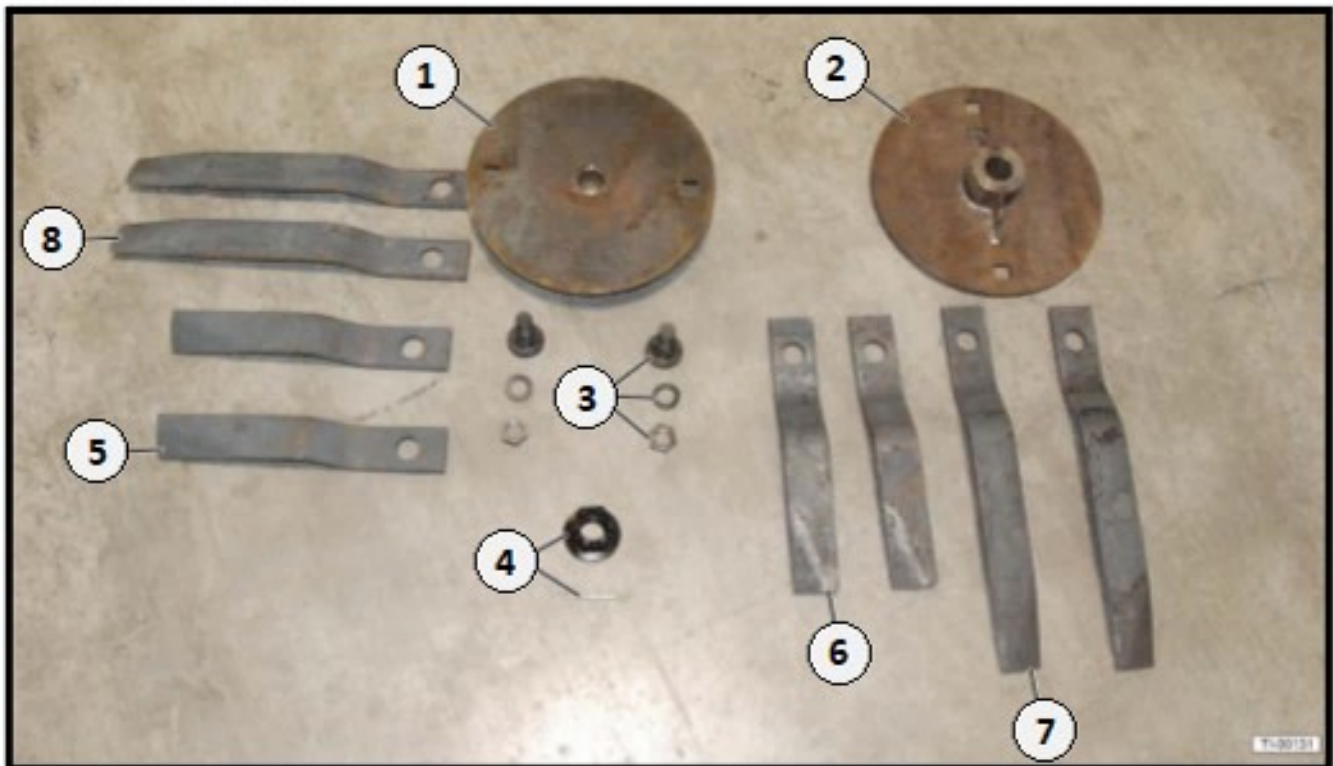

Item	Part #	Description	Qty
1	180007	Blade Carrier 5/8"x 19-1/2" - Flat Type (1708-1808) for 1:1.46 Gearbox	A/R
	180090	Blade Carrier - 1808 (New) for 1:1.93 Gearbox (Bolt Holes 15.50" Ctr to Ctr)	A/R
2	130014	Blade Carrier 5/8"x 17" - Flat Type (1810) (Bolt holes 13.50" Ctr to Ctr)	1
3	110012	Blade Bolt, Lockwasher & Nut Kit 1-1/8" (2-Pack)	1
4	110013	Blade Carrier Retainer Kit - 1" Fine Thread Nut & 1/8" Cotter Pin	1
5	T-48	Cutter Blades, 8-ft (1708-1808) Sold in Pairs Useable Length 16"	1
6	T-48R	Reverse Cutter Blades, 8-ft (1708-1808) Sold in Pairs Useable Length 16"	1
7	T-60	Cutter Blades, 10-ft (1810) Sold in Pairs Useable Length 22"	1
8	T-60R	Reverse Cutter Blades, 10-ft (1810) Sold in Pairs Useable Length 22"	1

A/R = As Required

NOTE: Uses 1-11/16" Socket size for Blade Bolt Nut

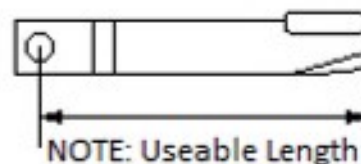

13.10 Optional Chain Guard

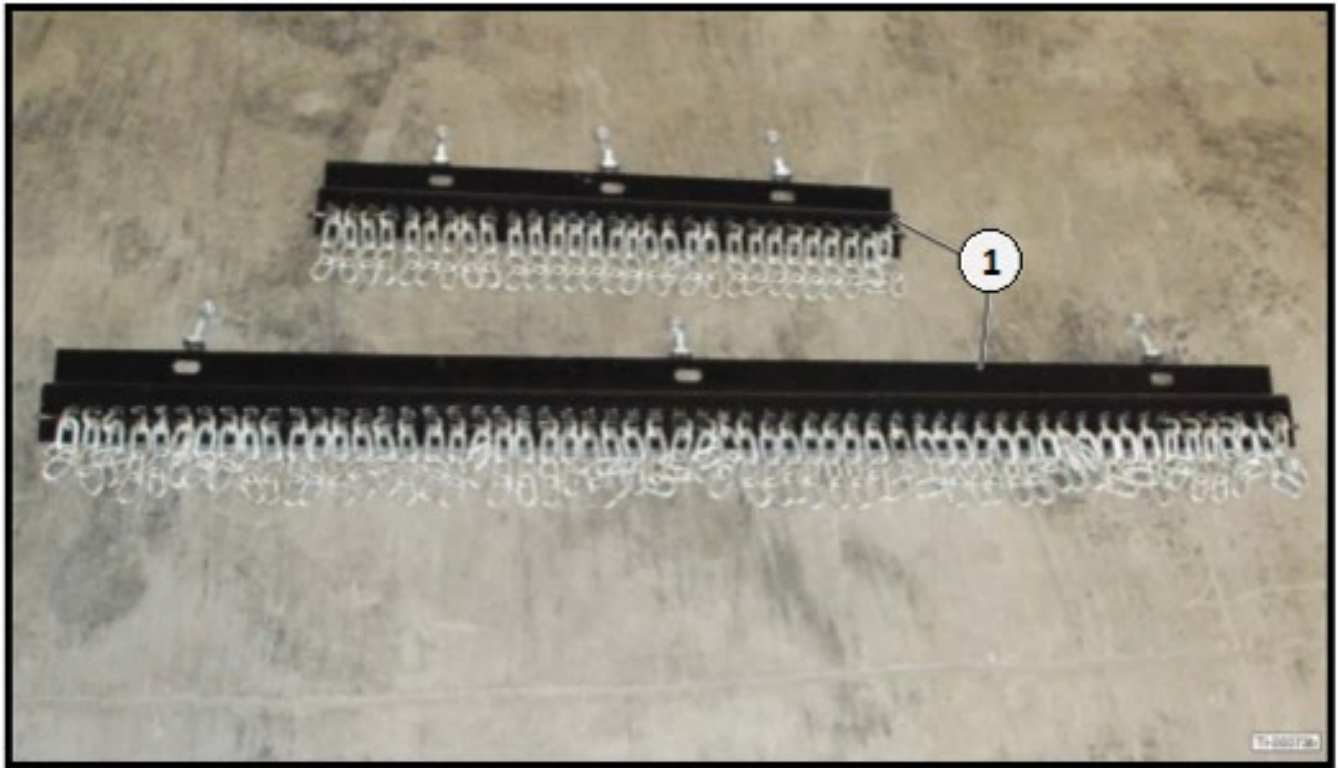

Item	Part #	Description	Qty
1	CG-1708	Front & Rear Chain Shield Kit 8-ft (1708)	1
	CG-1808	Front & Rear Chain Shield Kit 8-ft (1808)	1
	CG-1810	Front & Rear Chain Shield Kit 10-ft (1810)	1