

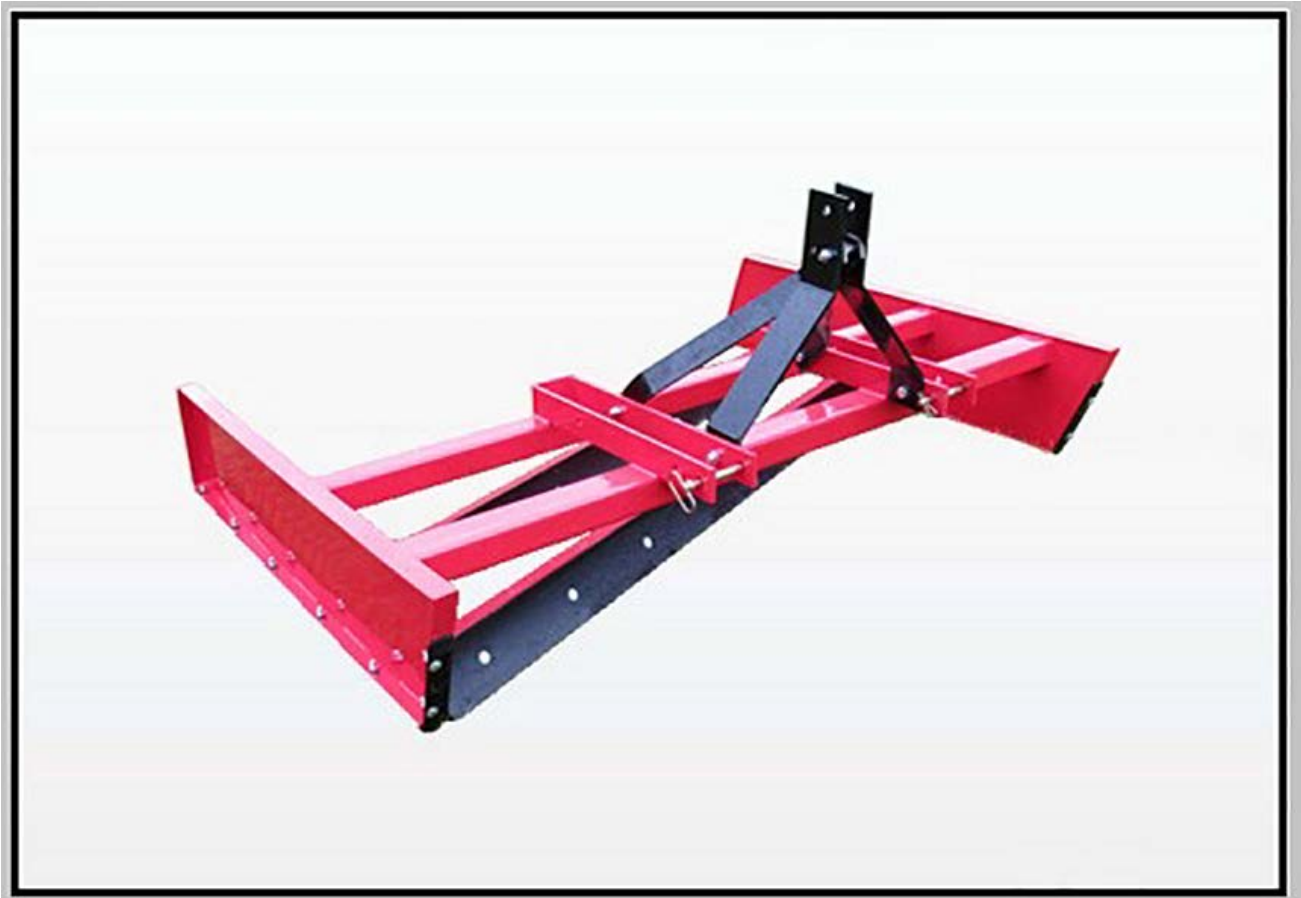

Contact your Authorized Ironcraft Dealer
for all your parts needs



**3400 SERIES
DUAL EDGE GRADER
PARTS MANUAL**

9. Parts

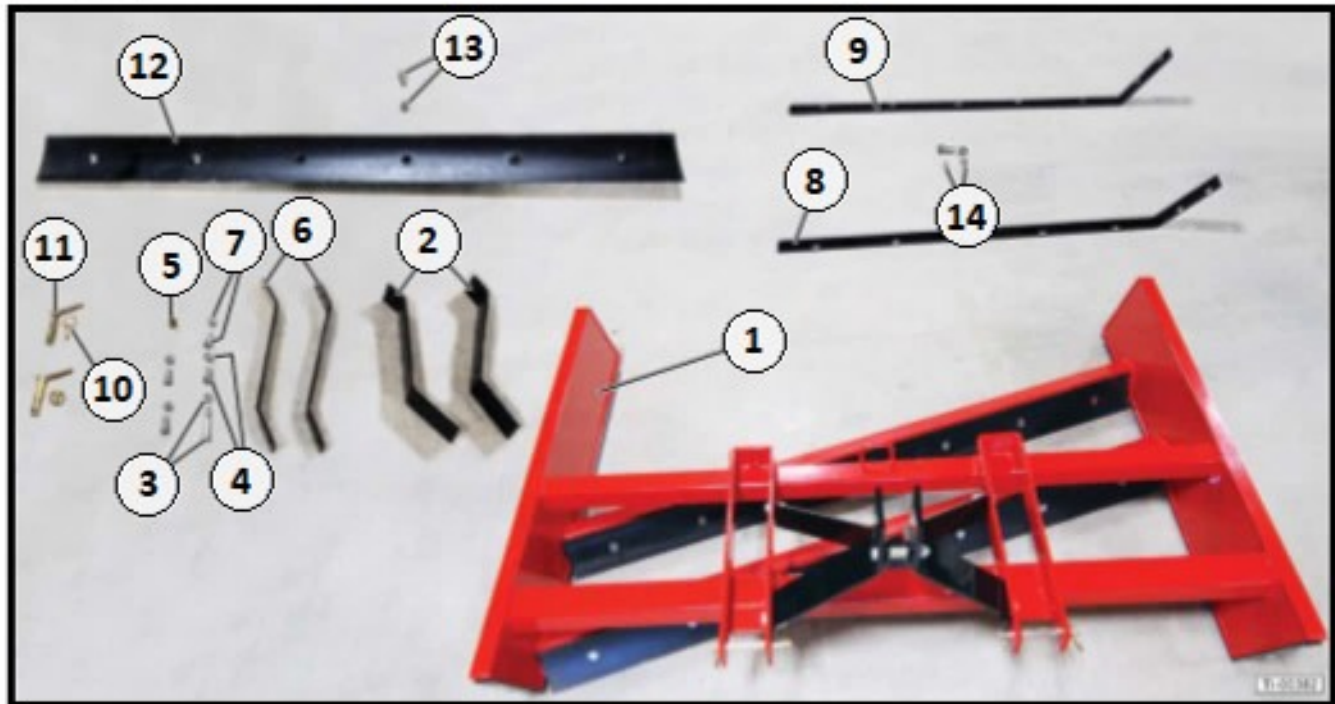

Item	4-ft Part #	5-ft Part #	6-ft Part #	7-ft Part #	Description	Qty
1	340000	340006	340012	340018	Frame, Standard - BLUE	1
	340001	340007	340013	340019	Frame, Standard - GREEN	
	340002	340008	340014	340020	Frame, Standard - GREY	
	340003	340009	340015	340021	Frame, Standard - ORANGE	
	340004	340010	340016	340022	Frame, Standard - RED	
	340005	340011	340017	340023	Frame, Standard - YELLOW	
2	320019	320019	320019	320019	A-Frame, Heavy Duty 1/2"x 4" x 26"	2
3	110029	110029	110029	110029	Bolt & Locknut Kit 5/8"x 4-1/2" - for Top A-Frame	1
4	320020	320020	320020	320020	Bolt & Locknut Kit 3/4"x 2" - for Bottom A-Frame	1
5	320021	320021	320021	320021	Spacer 1-1/2" - for A-Frame	1
6	320022	320022	320022	320022	Back Brace 3/8"x 2-1/2"x 28-1/2"	2
7	110004	110004	110004	110004	Bolt & Locknut Kit 5/8"x 2" - for Back Brace	1
8	340024	340024	340024	340024	Skid Shoe - Left 1/4"x 2"x 73-1/4"	1
9	340025	340025	340025	340025	Skid Shoe - Right 1/4"x 2"x 73-1/4"	1
10	310032	310032	310032	310032	Lynch Pin 3/8"	A/R
11	310031	310031	310031	310031	Lift Pin CAT-I Handle Type	A/R
12	310035	---	---	---	Cutting Edge 3/8"x 6" x 47-3/4"	2
	---	310036	---	---	Cutting Edge 3/8"x 6" x 59-3/4"	
	---	---	310037	---	Cutting Edge 3/8"x 6" x 71-3/4"	
	---	---	---	310038	Cutting Edge 3/8"x 6" x 83-3/4"	
13	310040	310040	310040	310040	Plow Bolt & Nut Kit 5/8"x 1-1/2"	A/R
14	120011	120011	120011	120011	Carriage Bolt & Nut Kit 1/2"x 1-1/2"	14

A/R = As Required