

IRONCRAFT

Contact your Authorized Ironcraft Dealer
for all your parts needs



**1100 SERIES
ROTARY CUTTER
PARTS MANUAL**

14.1 Hitch Assembly

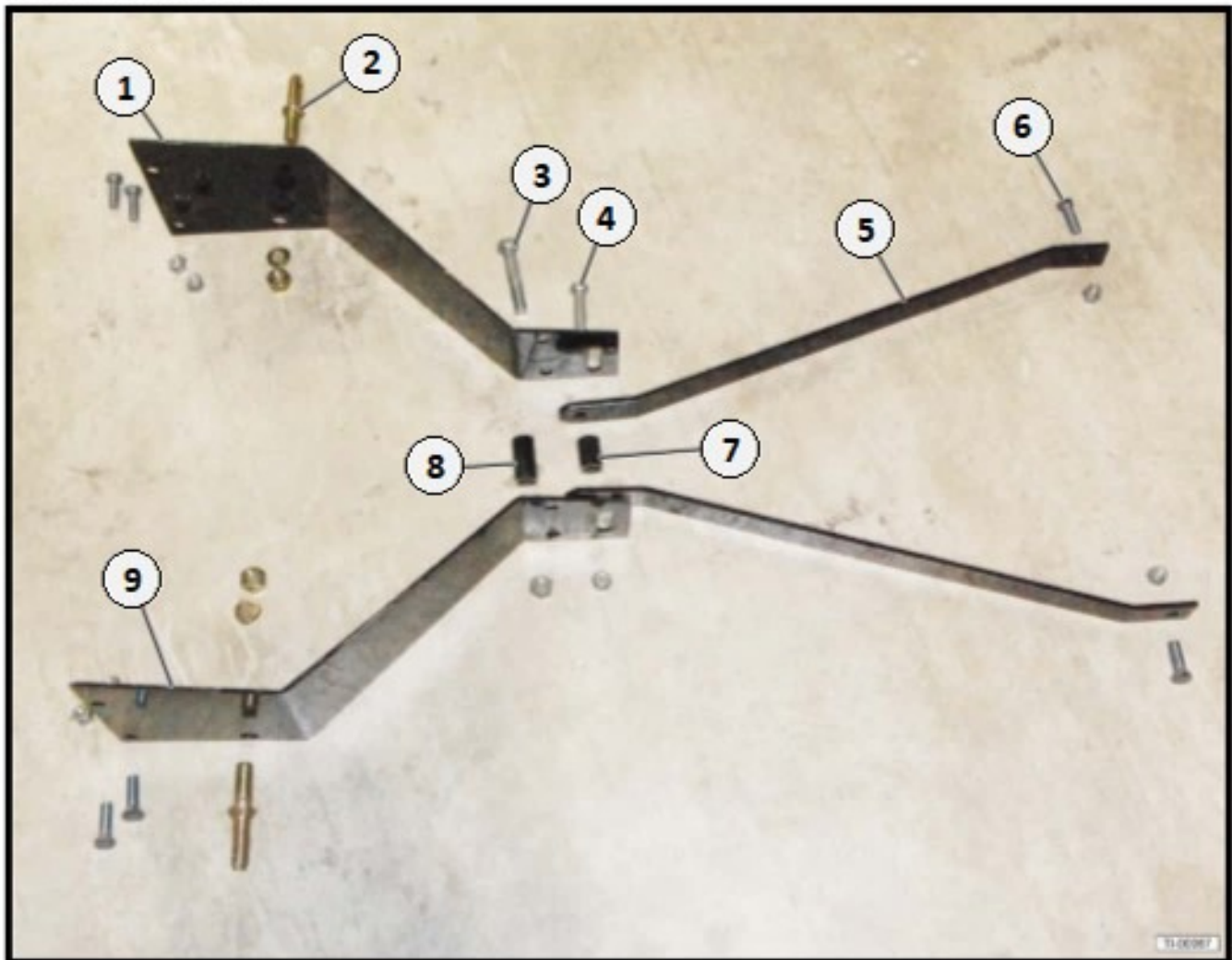

Item	Part Number	Description	Qty
1	110025	A-Frame, Left Side	1
2	110032	Lift Pin Kit CAT-I	1
3	110027	A-Frame Top Bolt & Locknut Kit 3/4-10 X 4-1/2"	1
4	110029	A-Frame Top Rear Bolt & Locknut Kit 5/8-11 x 4-1/2"	1
5	110031	Back Brace	2
6	110015	Bolt & Locknut Kit 5/8-11 x 2"	6
7	110030	A-Frame Top Rear Bolt Spacer 2"	1
8	110028	A-Frame Top Front Bolt Spacer 2-3/4"	1
9	110026	A-Frame, Right Side	1
10	110033	Flat Washer 1"	2

14.2 Deck Assembly

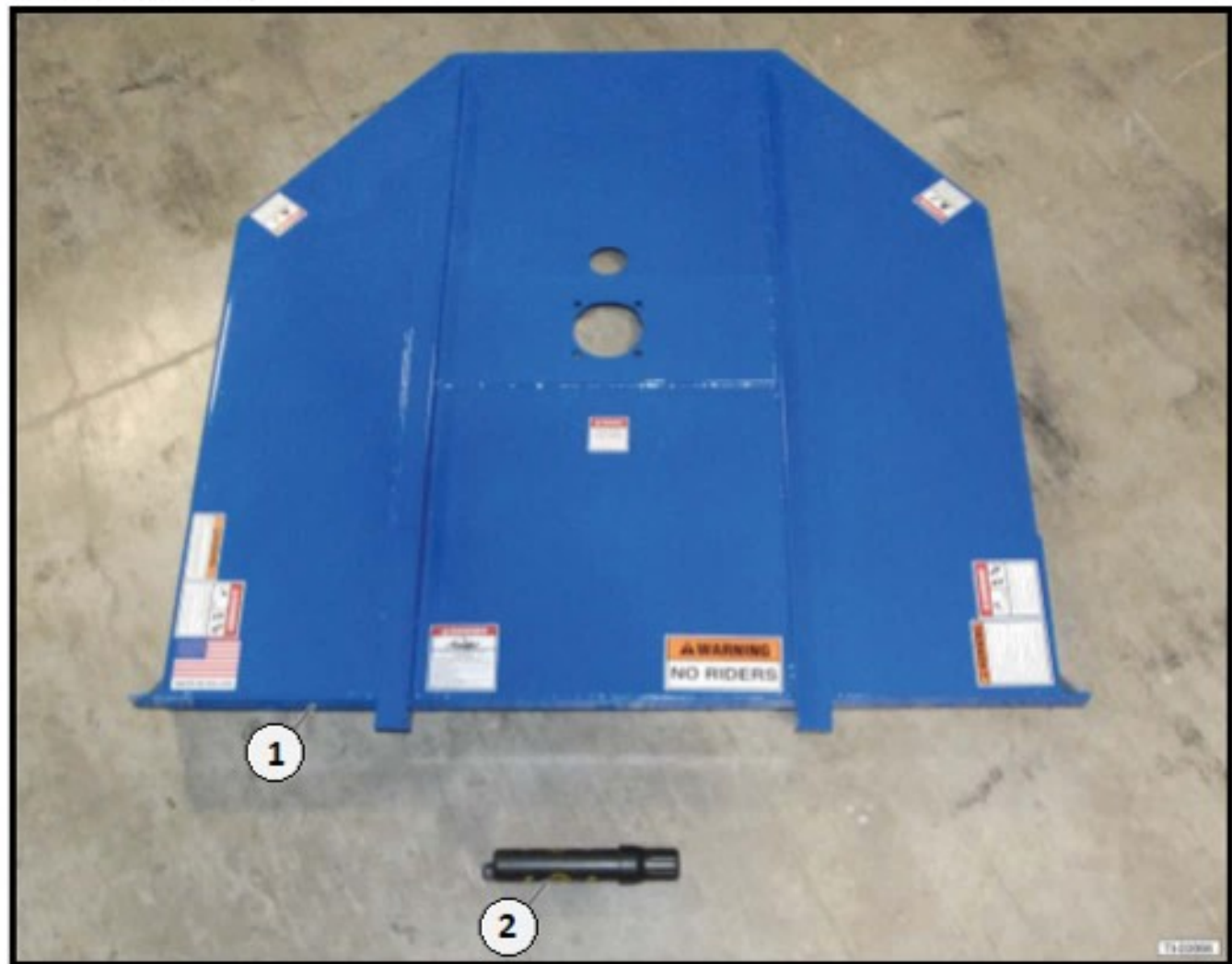

Item	Part #	Description	Qty
1	110038	3.5' Deck Only with Decals RED	1
	110039	3.5' Deck Only with Decals GREEN	1
	110040	3.5' Deck Only with Decals ORANGE	1
	110041	3.5' Deck Only with Decals YELLOW	1
	110042	3.5' Deck Only with Decals BLUE	1
	110043	3.5' Deck Only with Decals-GREY	1

Item	Part #	Description	Qty
1	110044	4' Deck Only with Decals RED	1
	110045	4' Deck Only with Decals GREEN	1
	110046	4' Deck Only with Decals ORANGE	1
	110047	4' Deck Only with Decals YELLOW	1
	110048	4' Deck Only with Decals BLUE	1
	110049	4' Deck Only with Decals-GREY	1

Item	Part #	Description	Qty
1	110050	5' Deck Only with Decals RED	1
	110051	5' Deck Only with Decals GREEN	1
	110052	5' Deck Only with Decals ORANGE	1
	110053	5' Deck Only with Decals YELLOW	1
	110054	5' Deck Only with Decals BLUE	1
	110055	5' Deck Only with Decals-GREY	1

Item	Part #	Description	Qty
1	110056	6' Deck Only with Decals RED	1
	110057	6' Deck Only with Decals GREEN	1
	110058	6' Deck Only with Decals ORANGE	1
	110059	6' Deck Only with Decals YELLOW	1
	110060	6' Deck Only with Decals BLUE	1
	110061	6' Deck Only with Decals-GREY	1

Item	Part #	Description	Qty
1	110062	6' 100 HP Deck Only with Decals RED	1
	110063	6' 100 HP Deck Only with Decals GREEN	1
	110064	6' 100 HP Deck Only with Decals ORANGE	1
	110065	6' 100 HP Deck Only with Decals YELLOW	1
	110066	6' 100 HP Deck Only with Decals BLUE	1
	110067	6' 100 HP Deck Only with Decals-GREY	1
	2	110034	Document Holder with Screws

14.3 Tailwheel Assembly

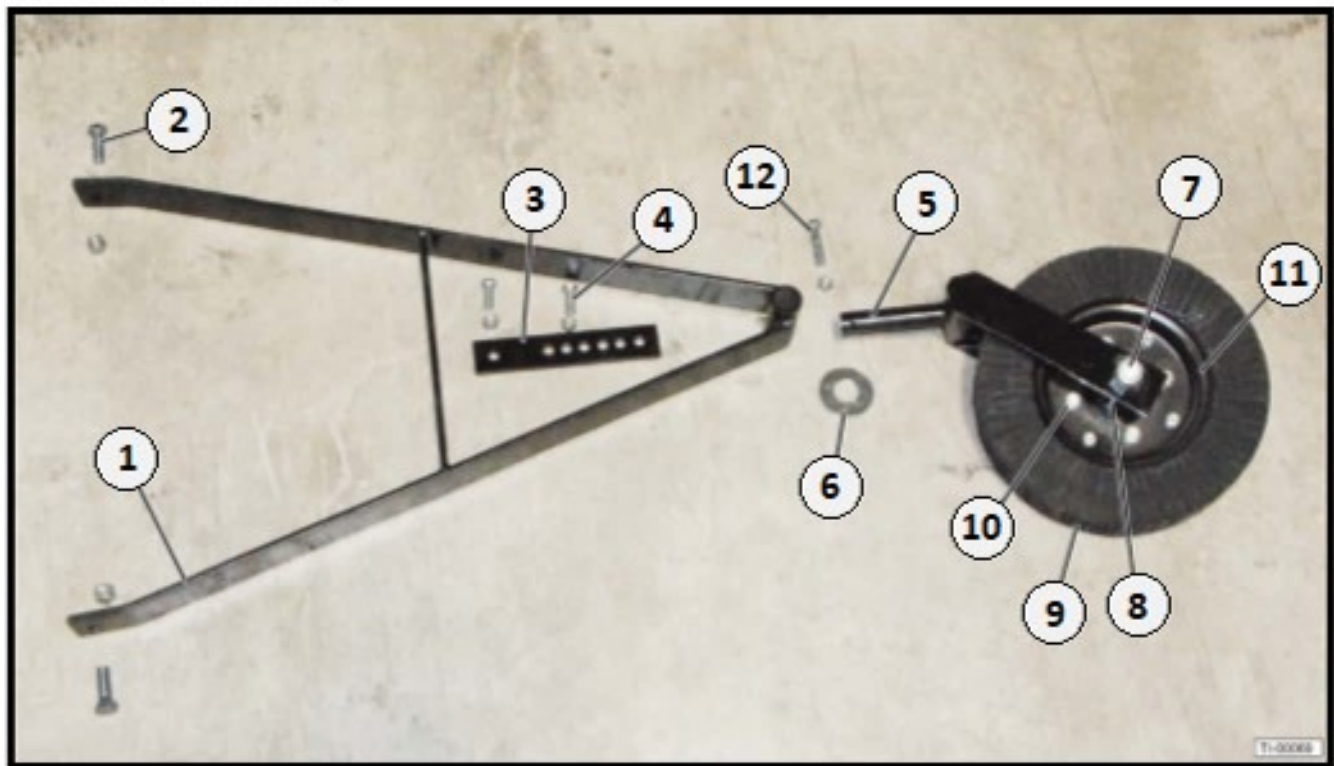

Item	Part #	Description	Qty
1	110014	Tailwheel Frame	1
2	110015	Bolt & Locknut Kit 5/8-11 x 2"	2
3	110016	Tailwheel Adjustment Plate, 7 Hole	1
4	110069	Bolt & Locknut Kit 1/2-13 x 2"	2
5	110018	Tailwheel Fork	1
6	110019	Flatwasher 1-1/4"	1
7	110020	Axle Bolt & Locknut Kit 1-8 x 8"	1
8	110021	Zerk Fitting	1
9	110022	Laminated Wheel	1
10	110023	Bolt, Lockwasher & Locknut Kit 5/16 x 3/4"	1
11	110024	Standard Wheel Hub Kit with Bolt	1
12	110070	Bolt & Locknut Kit 1/2-13 x 2-1/2"	1

14.4 Driveline Assembly

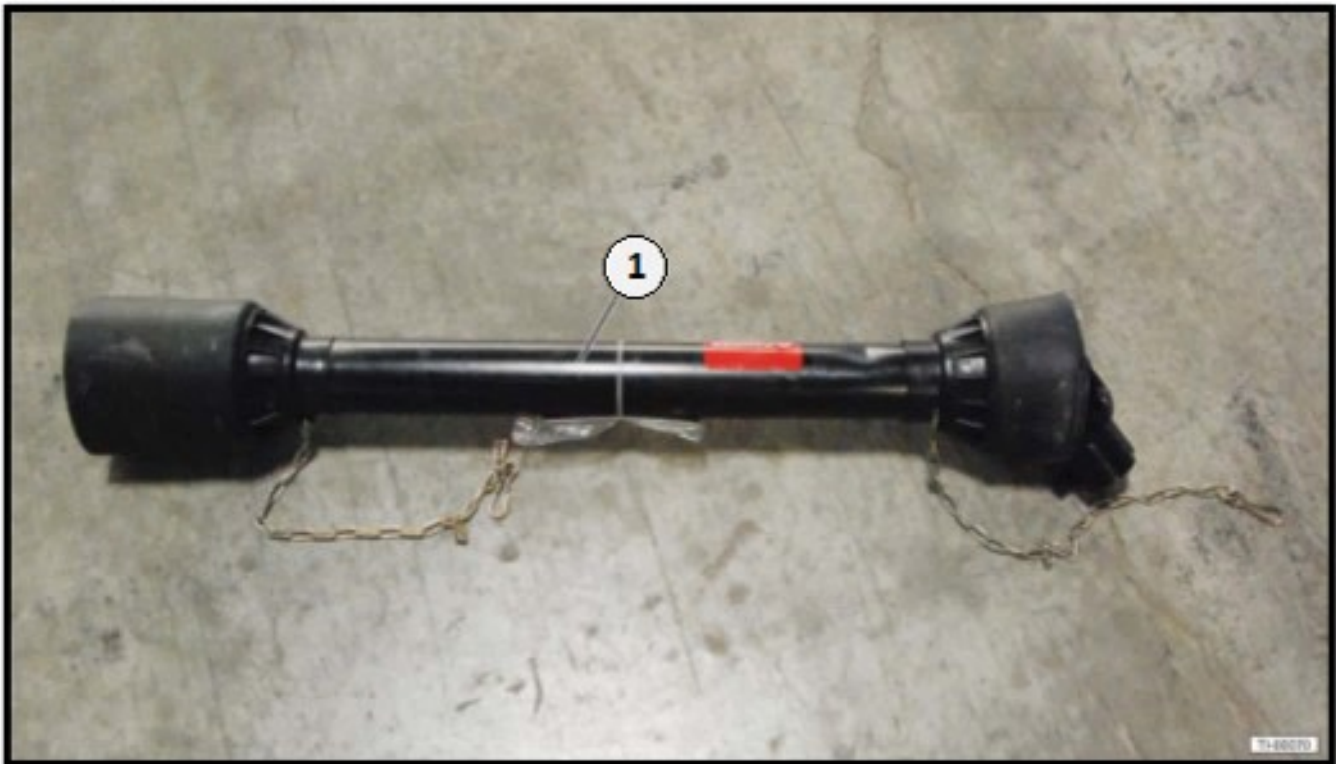

Item	Part #	Description	Qty
1	110035	Driveline, Series-4 (830mm) Shear Pin For 1104 & 1135	1
	110036	Driveline, Series-4 (960mm) Shear Pin For 1105	1
	110037	Driveline, Series-4 (1200mm) Shear Pin For 1106 & 1106BG	1

SHEAR PIN - DRIVELINE COMPONENTS

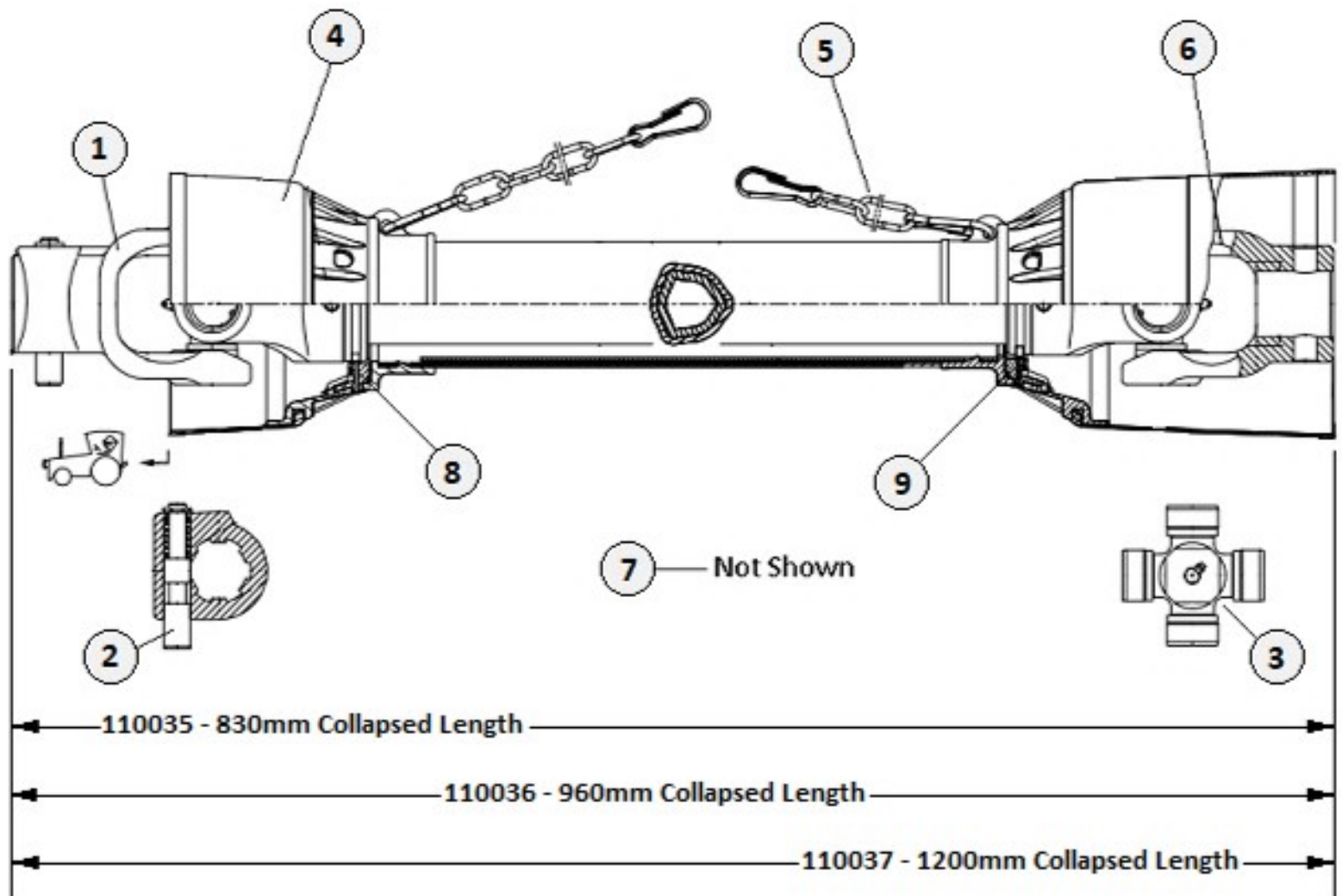

Item	Part #	Description	Qty
1	552000	Tractor Yoke with Push Pin 1-3/8" 6-S	1
2	552001	Push Pin Kit	1
3	552003	Cross Kit 27 x 74.6	2
4	552004	Complete Safety Shield	1
5	552005	Safety Chain	2
6	552006	Yoke 1-3/8"-Smooth	1
7	110007	Shearbolt Kit 1/2"x 3-1/2" Gr.2 (5-Pack)	1
8	552008	Outer Plastic Shield Bearing	1
9	552009	Inner Plastic Shield Bearing	1
	110035	Complete Shearpin Driveline for 4-ft (Series 4)	
	110036	Complete Shearpin Driveline for 5-ft (Series 4)	
	110037	Complete Shearpin Driveline for 6-ft (Series 4)	

SLIPCLUTCH DRIVELINE COMPONENTS

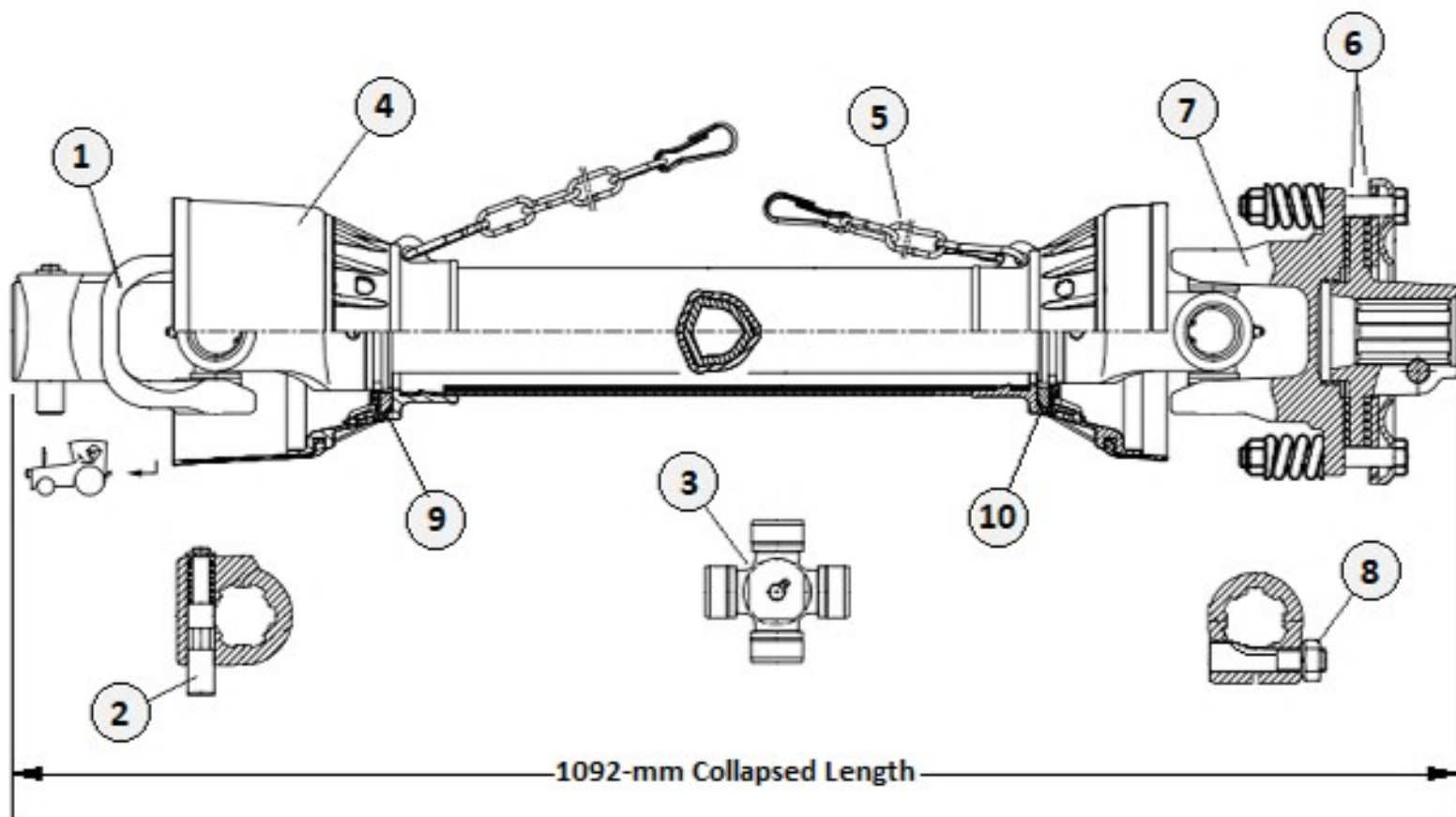

Item	Part #	Description	Qty
1	552000	Tractor Yoke with Push Pin 1-3/8" 6-S	1
2	552001	Push Pin Kit	1
3	552003	Cross Kit 27 x 74.6	2
4	552030	*Complete Safety Shield	1
5	552005	Safety Chain	2
6	552031	Clutch Lining (2-Pack)	1
7	552032	Complete Slipclutch	1
8	552033	Eccentric Pin with Nut	1
9	552034	Outer Plastic Shield Bearing	1
10	552035	Inner Plastic Shield Bearing	1
	120012	*Complete Slipclutch Driveline	

*May need to cut driveline shorter to fit 4-ft & 5-ft Applications

14.5 Gearbox

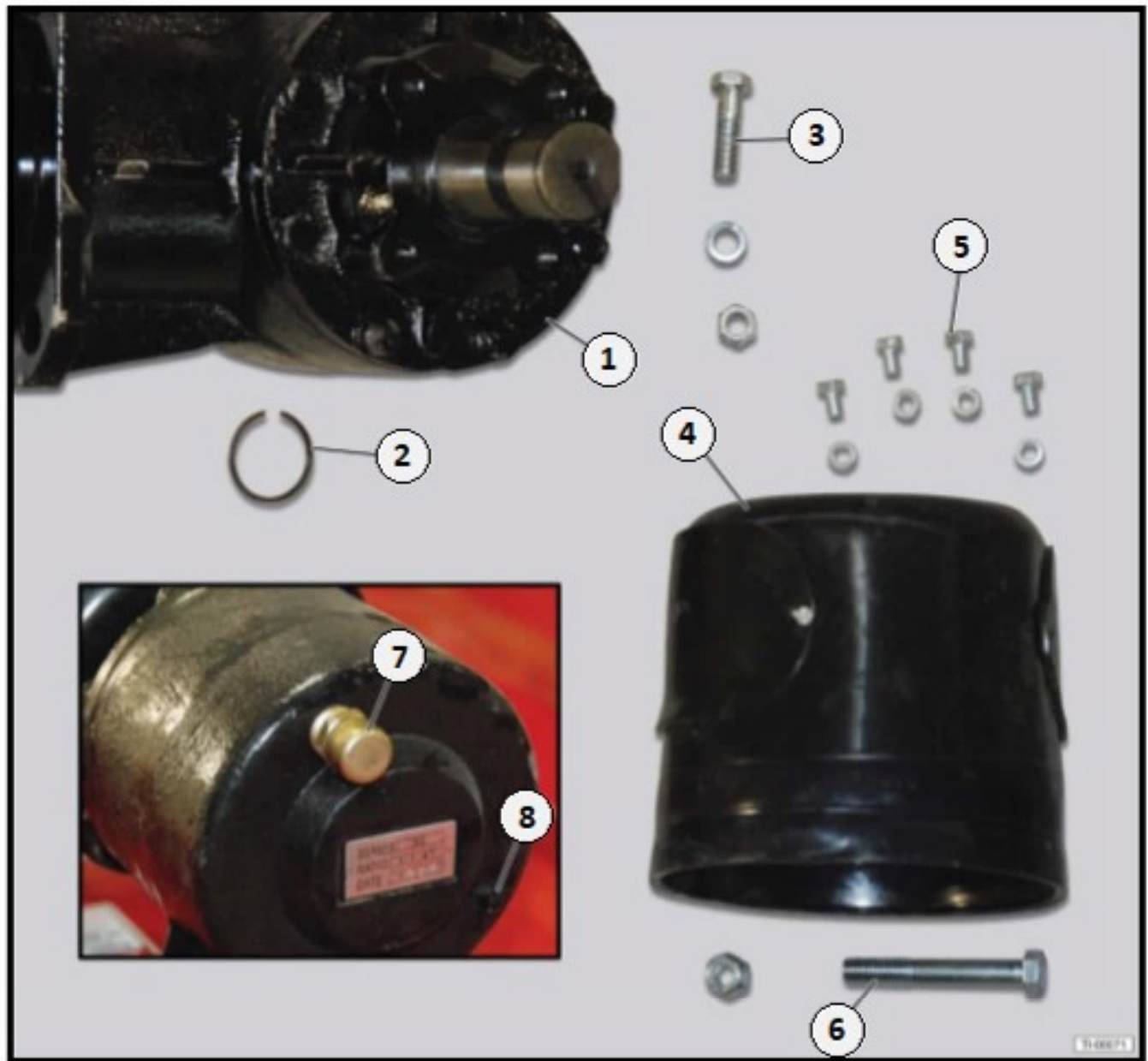

Item	Part #	Description	Qty
1	110001	Gearbox, Shear Pin 55 HP	1
	110002	Gearbox, Shear Pin 100 HP (1106BG)	1
2	110003	Snap Ring 1-3/8"	1
3	110004	Bolt, Lockwasher & Locknut Kit 5/8" x 2" (4-Pack)	1
	110068	Bolt, Lockwasher & Locknut Kit 3/4" x 3" (4-Pack) 1106BG	1
4	110005	Gearbox Shield, Shear Pin	1
5	110006	Bolt & Lockwasher Kit 5/16" x 1/2" (4-Pack)	1
6	110007	Shear Pin Bolt Kit 1/2" x 3" Grade-2 (5-Pack)	1
7	110008	Gearbox Vent Plug	1
8	110009	Gearbox Drain Plug	1

110001 - COMPLETE GEAR BOX - (1-3/8" SMOOTH INPUT)

120000 - COMPLETE GEARBOX - (1-3/8" 6 SPLINE INPUT)

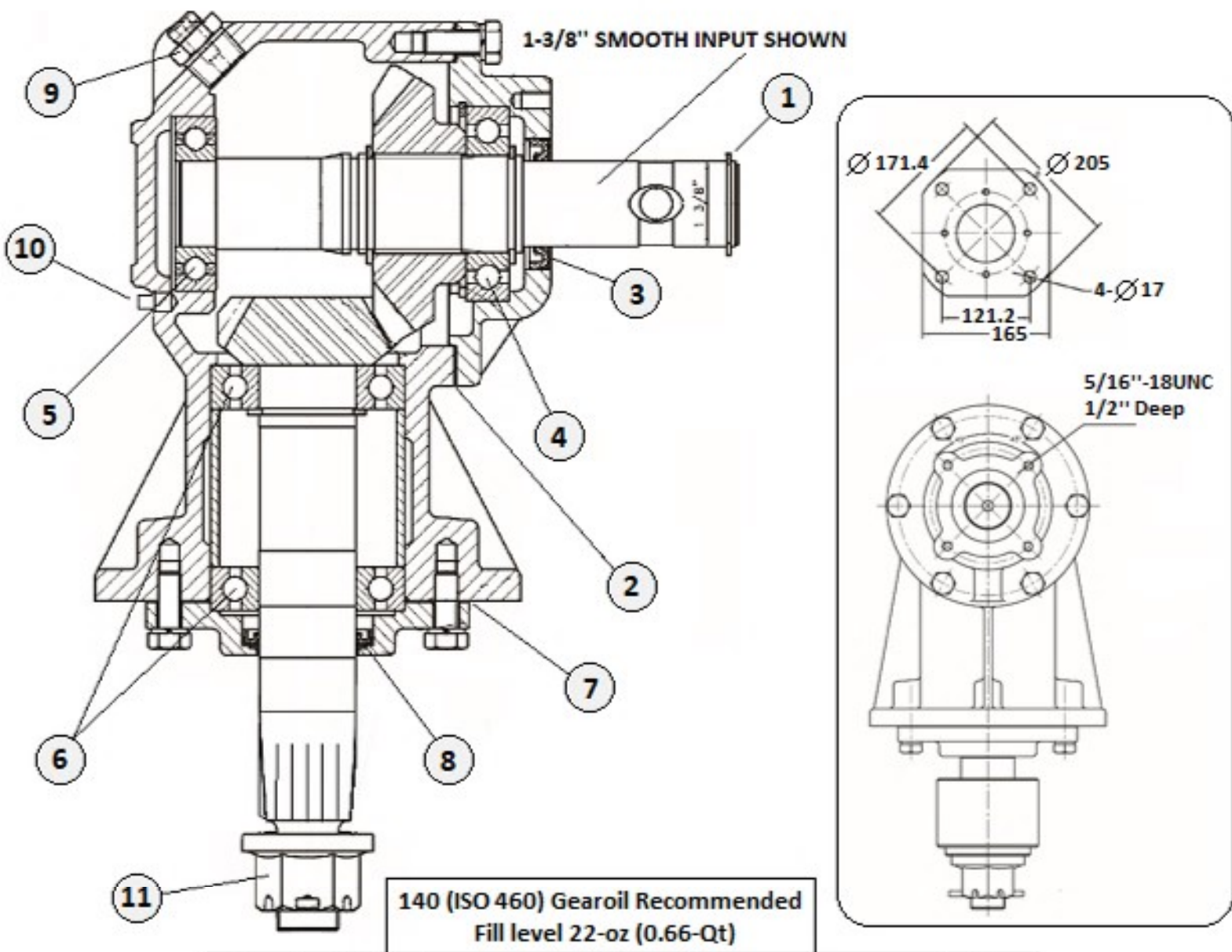

140 (ISO 460) Gearoil Recommended
Fill level 22-oz (0.66-Qt)

Item	Part #	Description	Qty
1	110003	Retaining Ring	1
2	551000	Input Gasket Kit	1
3	551001	Input Seal	1
4	551004	Input Bearing – Front	1
5	551005	Input Bearing – Rear	1
6	551006	Output Bearing	2
7	551007	Output Gasket Kit	1
8	551008	Output Seal	1
9	110008	Pressure Relief Plug	1
10	110009	Pipe Plug (Square Head)	1
11	110013	Castle Nut / Cotter Pin Kit – 1" Fine Thread	1
	110001	Complete Gearbox (1-3/8" Smooth) Shown	
	120000	Complete Gearbox (1-3/8" 6-S) Not Shown	

100 Hp GEARBOX used on Models: 1100

Not Shown:

- 12 — PRESSURE RELIEF PLUG
- 13 — PIPE PLUG (SQUARE HEAD)

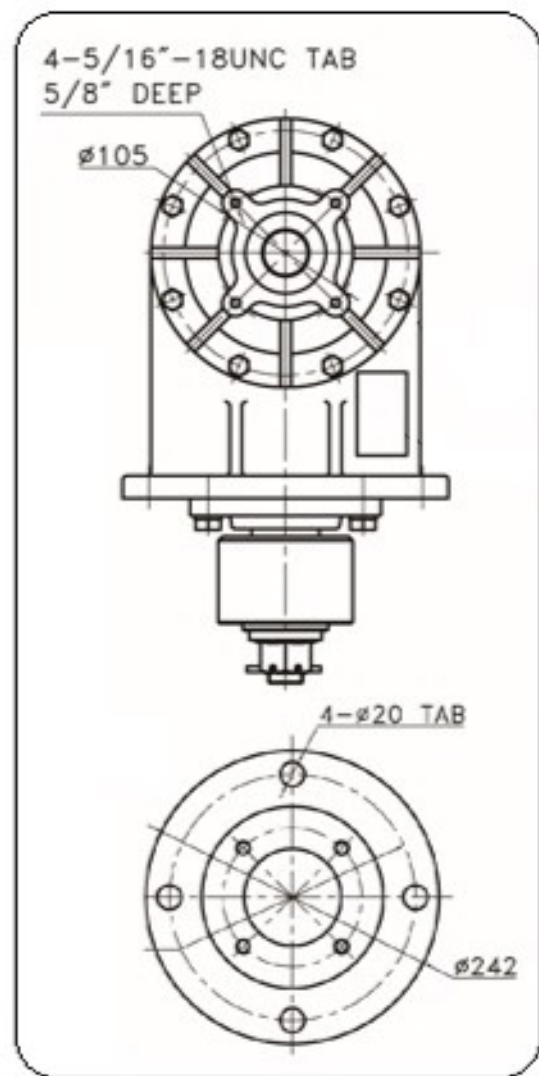
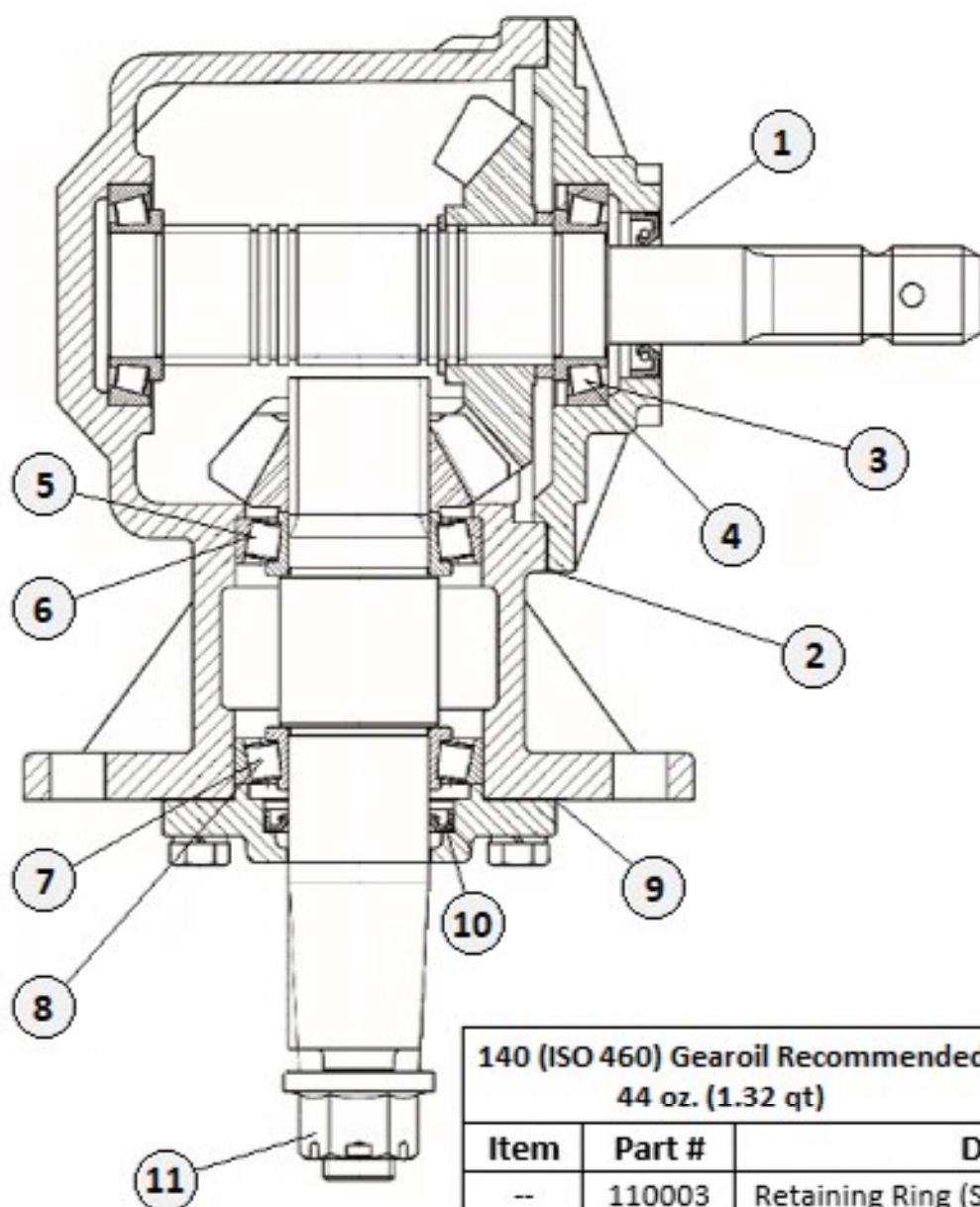

140 (ISO 460) Gearoil Recommended
44 oz. (1.32 qt)

Item	Part #	Description	Qty
--	110003	Retaining Ring (Shear Pin Only)	1
1	551020	Input Seal 35 x 60 x 12	1
2	551021	Input Gasket Kit	1
3	551022	Input Cone Bearing	2
4	551023	Input Bearing Cup	2
5	551024	Output Cone Bearing – Top	1
6	551025	Output Bearing Cup – Top	1
7	551026	Output Cone Bearing – Bottom	1
8	551027	Output Bearing Cup – Bottom	1
9	551028	Output Gasket Kit	1
10	551029	Output Seal 50 x 68.5 x 10	1
11	110013	Castle Nut / Cotter Pin Kit – 1" Fine Thread	1
12	110008	Pressure Relief Plug	1
13	110009	Pipe Plug (Square Head)	1
130000		Complete Gearbox (1-3/8" Spline) Shown	
110002		Complete Gearbox (1-3/8" Smooth) Not Shown	

14.6 Blade Assembly

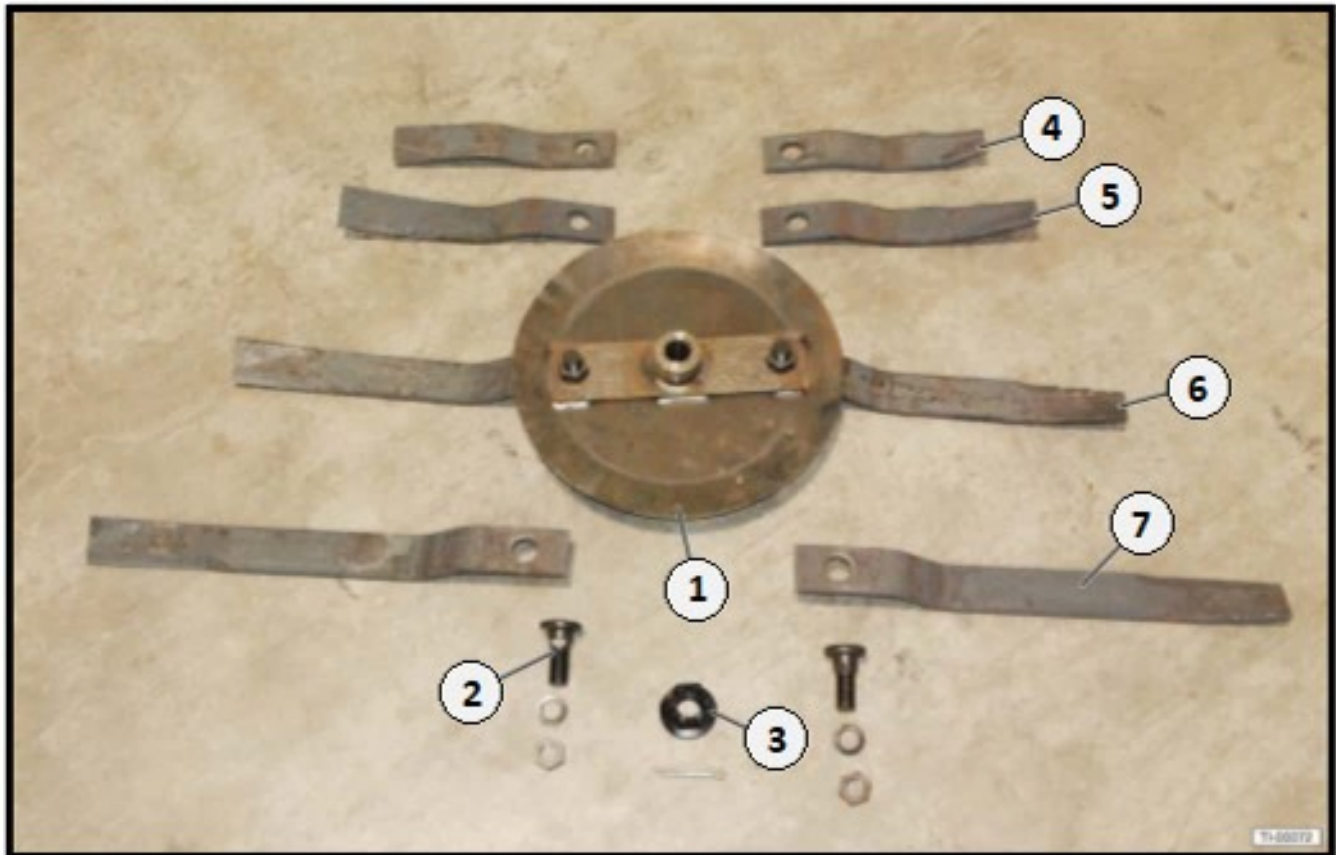

Item	Part #	Description	Qty
1	110010	Blade Carrier, 3.5', 4', 5' & 6' Models 55HP G/B (Bolt holes 13" Ctr to Ctr)	1
	110011	Blade Carrier, 6' Models (1106GB) 75/100 HP G/B (Bolt holes 13" Ctr to Ctr)	1
2	110012	Blade Bolt, Lockwasher & Nut Kit (2-Pack) 1-1/8"	1
3	110013	Blade Carrier Retainer Kit 1" Fine Thread Nut & 1/8" Cotter Pin	1
4	T-42	3.5' Cutter Blade (Sold in Pairs) 1135 Useable Length 13-1/2"	1
5	T-48	4' Cutter Blade (Sold in Pairs) 1104 Useable Length 16"	1
6	T-60	5' Cutter Blade (Sold in Pairs) 1105 Useable Length 22"	1
7	T-72	6' Cutter Blade (Sold in Pairs) 1106 Useable Length 27"	1

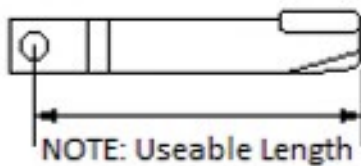

NOTE: Uses 1-11/16" Socket size for Blade Bolt Nut

14.7 Optional Chain Guard

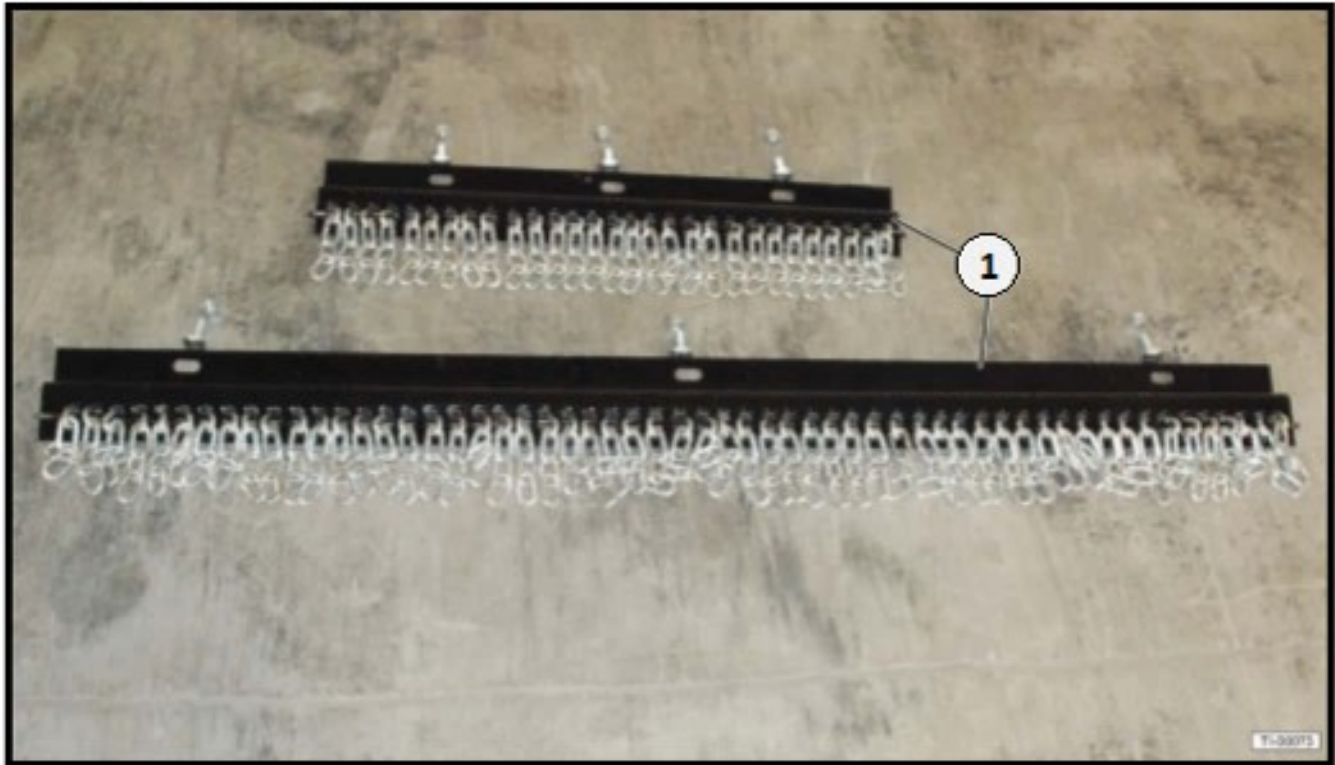

Item	Part #	Description	Qty
1	CG-1135	Front & Rear Chain Shield Kit 3.5-ft.	1
	CG-1104	Front & Rear Chain Shield Kit 4-ft.	1
	CG-1105	Front & Rear Chain Shield Kit 5-ft.	1
	CG-1106	Front & Rear Chain Shield Kit 6-ft.	1