



Contact your Authorized Ironcraft Dealer  
for all your parts needs



# **3600 / 3700 SERIES LAND LEVELER PARTS MANUAL**

## Land Leveler Components

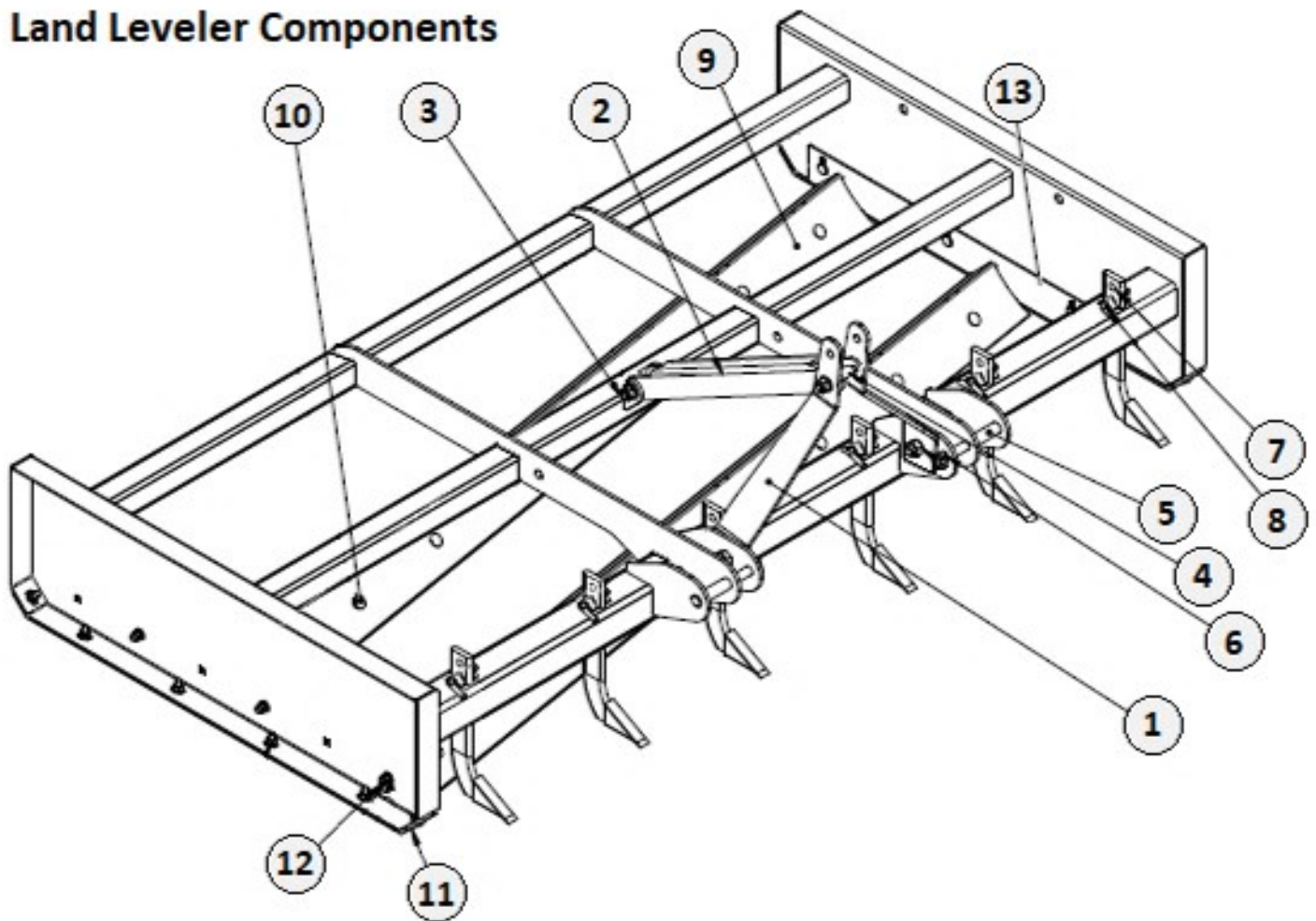

Item	Part #	Description	Qty
1	3610009	A-Frame – Front	2
2	3610006	Rear Support Channel	1
3	140018	Bolt & Locknut 3/4"x 5"	2
4	150051	A-Frame Spacer 1-1/4"	4
5	450006	Step Pin CAT-II (3700 7-ft & 8-ft Models Only)	2
	310031	Handle Type Lift Pin CAT-I (3600 5-ft & 6-ft Models Only)	2
6	310032	Lynch Pin 7/16"	2
7	310033	Box Shank	A/R
8	310034	L-Shape Shank Pin 1/2"	A/R
9	310036	Cutting Edge, 5-ft (2-per Model)	A/R
	310037	Cutting Edge, 6-ft (2-per Model)	A/R
	310038	Cutting Edge, 7-ft (2-per Model)	A/R
	310039	Cutting Edge, 8-ft (2-per Model)	A/R
10	310040	Plow Bolt & Locknut 5/8"x 1-1/2"	A/R
11	3610001	Skid Shoe (3600 5-ft & 6-ft Models)	2
	3710001	Skid Shoe (3700 7-ft & 8-ft Models)	2
12	120011	Carriage Bolt, Nut & Lockwasher Kit 1/2"x 1-1/2"	18
13	360004	5-Ft Angle Frame 3605	A/R
	360000	6-Ft Angle Frame 3606	A/R
	370004	7-Ft Angle Frame 3707	A/R
	370000	8-Ft Angle Frame 3708	A/R

A/R = As Required