



# BALE SQUEEZE



## USE AND MAINTENANCE GUIDE

X-TREME DUTY	HEAVY DUTY
XBS	HDBS



Scan QR code for a digital version of this manual



October 2023

# CONTENTS

<b>REGISTER</b> .....	<b>2</b>
<b>THANK YOU.</b> .....	<b>3</b>
<b>MODEL COMPARISON</b> .....	<b>4</b>
<b>SAFETY INFORMATION</b> .....	<b>5</b>
1.1 Introduction	5
1.2 Safety Symbols	6
1.3 Safety Decals	8
1.4 Skid Steer Tractor Requirements	10
1.5 General Safety Instructions	11
<b>OPERATING PROCEDURES</b> .....	<b>12</b>
2.1 Unpacking Your Hay Bale Squeezer	12
2.2 How to Mount Hay Bale Squeezer	12
2.3 How to Dismount Hay Bale Squeeze	14
2.4 Controls	14
2.5 Initial Use Procedure	15
2.6 Operating Tips	16
<b>MAINTENANCE PROCEDURES</b> .....	<b>17</b>
3.1 Maintenance Overview	17
3.2 Maintenance Schedule	18
3.3 Storage	19
<b>TROUBLESHOOTING</b> .....	<b>20</b>
<b>SPECIFICATIONS</b> .....	<b>21</b>
<b>PARTS INFORMATION</b> .....	<b>23</b>
6.1 Parts Assembly Diagrams	24
<b>WARRANTY INFORMATION</b> .....	<b>26</b>
7.1 Limited Warranty Statement	26
7.2 Warranty Service Procedure	27
<b>SAFETY ACKNOWLEDGEMENT FORMS</b> .....	<b>28</b>
<b>MAINTENANCE LOG</b> .....	<b>30</b>



[WWW.IRONCRAFTUSA.COM](http://WWW.IRONCRAFTUSA.COM)

Revised October 7, 2023 6:33 PM  
©2023 IronCraft Attachments. All rights reserved.

# REGISTER THIS PRODUCT

WWW.IRONCRAFTUSA.COM/WARRANTY/REGISTER-WARRANTY/

PURCHASE DATE

DEALER NAME

ADDRESS

PHONE NUMBER

MODEL

SERIAL



## “WHY WOULD I WANT TO REGISTER MY MACHINE?”

HERE'S THE LOWDOWN. YOU NEED TO REGISTER YOUR NEW PRODUCT WITHIN 30 DAYS OF DELIVERY. WITHOUT REGISTRATION, YOUR WARRANTY CLAIMS WILL NOT BE HONORED.

Registering your machine means you get the full benefits of the warranty terms we offer.

Scan this QR code to our warranty page and select the “REGISTER” tab for an easy-peasy process.  
**You'll be glad you did.**



# THANK YOU

Dear Owner:

We appreciate your business, and thank you for your purchase. This manual will provide instructions on how to safely operate and maintain your BALE SQUEEZE ATTACHMENT. All users must read and understand this manual before operating this machine. Users should sign the “Safety Acknowledgement Form” at the end of this manual. DO NOT discard this manual. This manual should be kept with the attachment and be available for all users to read.

Please record the model and serial number on the inside front cover and provide this information to your dealer when requesting assistance with this product.

This HAY BALE SQUEEZE attachment is designed to be attached to a skid loader, for Hay Bale handling purposes only. The manufacturer concludes this product is safe if used as intended. In no event shall the manufacturer, distributor, or dealer be liable for any direct, indirect, punitive, incidental, or consequential damages to property or life arising out of or connected with the misuse of this product.

Sincerely,



The Ironcraft Team



## NOTICE

Illustrations and drawings in this manual may not reflect the actual product or part in exact detail, but are intended for reference only.



## NOTICE

Information in this manual is subject to change without notice.

# MODEL COMPARISON

BALE SQUEEZE		
MODEL	XBS	HDBS
DESCRIPTION	X-Treme Duty	Heavy Duty
LOAD CAPACITY	2,800 lbs	1,800 lbs
BALE CAPACITY	4', 5' or 6'	
CYLINDER SIZE	Twin 2-1/2" x 8"	Single Cylinder
HP REQUIRED		Recommended for 65 HP & under tractors

# SAFETY INFORMATION

## 1.1 INTRODUCTION

The following terms are used interchangeably throughout this manual.

HAY BALE SQUEEZE	SKID STEER	OPERATOR
implement, attachment, product, machine, bale squeeze, squeezer	skid steer loader, skid steer tractor, loader, prime mover	user, personnel

The HAY BALE SQUEEZE ATTACHMENT is designed and manufactured with safety in mind. However, improper use and operator error can result in death or serious injury. It is important that you read and fully understand the safety instructions and operating procedures in this manual before operating this attachment. Accident prevention is a combination of good judgement, common sense, awareness and proper training!



### BEFORE YOU OPERATE THIS ATTACHMENT:



#### KNOW

how to safely operate your skid steer loader.

#### READ AND UNDERSTAND

the safety instructions and operating procedures contained in this manual.

#### ACKNOWLEDGE

your understanding of all safety instructions presented in this manual by signing the "Safety Acknowledgement Form" at the end of this manual.

Although every effort has been made to ensure a safe product, every possible circumstance that could pose a potential hazard cannot be anticipated. The safety warnings in this manual and on this product, are therefore not all-inclusive.

In addition to the safety messages presented in this section, you must also read and understand the safety messages presented in the other sections of this manual.

## 1.2 SAFETY SYMBOLS

This manual and decals on this machine use safety symbols, pictograms and color coded signal words to alert you to potential hazards that may cause death or severe injury if a safety instruction is ignored. Become familiar with the following symbols.



### SAFETY ALERT SYMBOL

This symbol is used to alert you to potential personal injury hazards. Obey all safety messages that follow this symbol to avoid possible injury or death.

### HAZARD CLASSIFICATIONS

Hazards are identified by the “Safety Alert Symbol” and followed by the signal word “DANGER”, “WARNING”, or “CAUTION”.



### DANGER

Indicates an imminently hazardous situation which, if not avoided, will result in death or serious injury \This signal word is limited to the most extreme situations.



### WARNING

Indicates a potentially hazardous situation which, if not avoided, could result in death or serious injury.



### CAUTION

Indicates a potentially hazardous situation which, if not avoided, may result in minor or moderate injury.



### NOTICE

Indicates a situation which may cause damage to equipment or property. Messages are not related to personal injury.



### SAFETY INSTRUCTIONS

Indicates specific safety-related instructions or procedures.

## SAFETY PICTOGRAMS

Pictograms are graphic symbols meant to alert you of a potential hazard. Read and understand the hazard description for each of these symbols.



### OPERATING MANUAL:

Operators must read and understand the safety instructions in the operating manual to prevent death or serious injury.



### EYE PROTECTION & CARDBOARD:

Operators and Maintenance personnel must wear proper eye protection and use cardboard or wood to investigate hydraulic leaks to prevent death or serious injury from being injected with high pressure hydraulic fluid.



### HIGH PRESSURE FLUID INJECTION HAZARD:

Operators and Maintenance personnel must not place fingers or hands directly over a hydraulic leak to prevent death or serious injury from being injected with high pressure hydraulic fluid.









### CRUSHING AND CUTTING HAZARD:

Operators and Maintenance personnel must keep body parts away from the hydraulic ram and blades to prevent death or serious injury from being crushed or cut.

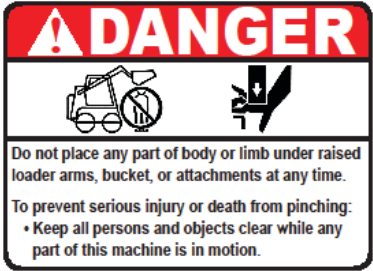
## 1.3 SAFETY DECALS

The safety decals affixed to this machine are to keep you safe. DO NOT ignore these decals. Read and understand each decal's safety message. Follow these Safety Decal Instructions:

1.  **SCAN TO VIEW OWNER'S MANUAL** 
2. 
3. 
4. 
5. 



### SAFETY INSTRUCTIONS

- Decals must be kept clean and legible at all times.
- Operators must inspect the machine for safety decals.
- Replace missing, worn or damaged decals immediately.
- When using a hot pressure washer to clean this machine, make sure water jet is not too close to the decal as this may cause the decal to peel.
- When replacing parts, be sure safety decals are in place prior to using the machine.
- Make sure metal surface is dry and free of dirt and grease before applying a new decal to this machine.
- Contact your local dealer to order replacement decals.

## SAFETY DECAL LOCATIONS



REF	DESCRIPTION	QTY.
1	Scan to view manual QR code Sticker (not shown)	1
2	Crush hazard warning label	2
3	High-pressure fluid hazard warning label	1
4	Do not operate machine before reading owner's manual warning label	2
5	IronCraft Logo Decal (not shown) Note: Non-Safety Decal	1

## 1.4 SKID STEER LOADER REQUIREMENTS



### CAUTION

Ensure your skid steer loader is in good operating condition. Follow the operating instructions found in your skid steer operator's manual. Failure to do so could result in minor or serious injury.

### PERSONAL PROTECTIVE EQUIPMENT (PPE) REQUIREMENTS



All operators should wear hearing protection, hand protection and safety glasses while operating this machine.

## 1.5 GENERAL SAFETY INSTRUCTIONS

Below are general safety instructions that relate to the overall operation and maintenance of this machine. It is important that you read and understand each message to prevent serious injury or death.



### ALWAYS

watch for overhead power lines.



### USE

this machine to move materials only.



### DO NOT

allow riders on the skid steer loader or on this attachment.



### DO NOT

operate this machine during severe weather.



### NEVER

use drugs or alcoholic beverages while operating or servicing this machine.



### ALWAYS

operate this attachment during daylight or well-lit areas.



### PREVENT

the skid loader and implement from rolling forward, stop the engine and set the parking brake when exiting the cab.



### INSPECT

implement for missing or loose hardware prior to use.



### DO NOT

allow children to play on or around this equipment at any time. Store this implement in an area not frequented by children.



### ALWAYS

wear the proper personal protection equipment while operating or servicing this machine. NEVER operate or service this machine with bare feet, sandals, or other light footwear.



### DO NOT

speed! Keep your driving speed between 2 and 5 mph.



### ENSURE

load does not become entangled with surrounding objects that could compromise the center of gravity resulting in a roll-over.



# OPERATING PROCEDURES

## 2.1 UNPACKING YOUR HAY BALE SQUEEZER

Your attachment arrives from the factory strapped to a wood pallet, and requires no final assembly. Use a pair of tin snips to remove the steel strapping.



### CAUTION

Shipping straps are under great tension, and could lash out uncontrollably when cut causing injuries to your body. Keep bystanders away and wear safety glasses and gloves while removing the straps.

## 2.2 HOW TO MOUNT HAY BALE SQUEEZER

Refer to your skid loader's operator's manual for specific instructions on how to mount and dismount your attachment.

### GENERAL ATTACHMENT METHOD

1. Enter operator's cab and start skid loader engine.
2. Tilt the skid loader quick attach coupler slightly down and drive forward to the rear of the cutter until the top edge of the quick attach coupler connects into the attachment mounting bracket.
3. Slightly tilt the skid loader quick attach coupler up until the coupler and mounting bracket fully engage.
4. Activate the coupler pin mechanism to lock the pins into the attachment bracket. If your skid loader does not have this mechanism, shut the skid loader engine off and exit the cab.

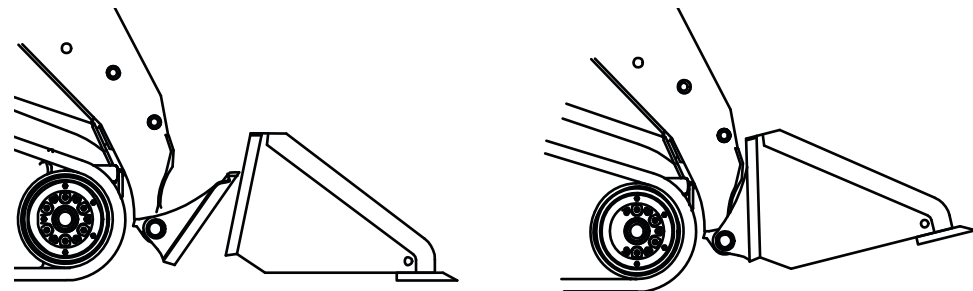

FIGURE 2.2A QUICK ATTACH MECHANISM LOCKED TO ATTACHMENT

5. Push the skid loader quick attach locking levers down until you can see the coupler pins extend into the slots on the attachment bracket. (See Figure 2.2b)

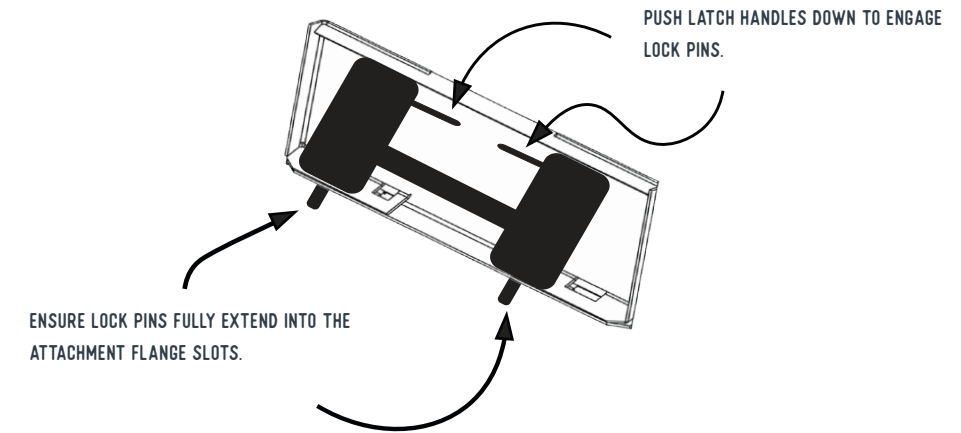

FIGURE 2.2B QUICK ATTACH MECHANISM LOCKED TO ATTACHMENT PLATE



### WARNING

To avoid serious injury or death, ensure coupler pins fully extend through the slots on the attachment bracket and that levers are down in the locked position to prevent log splitter attachment from detaching from the prime mover.



### NOTICE

To keep contaminants from entering the hydraulic system, use a clean cloth to wipe away dirt and grease from the hydraulic couplers.

6. Connect hydraulic hoses to the auxiliary supply couplers located on your skid loader's lift arm.



## 2.3 HOW TO DISMOUNT HAY BALE SQUEEZE

1. Turn off auxiliary hydraulic circuit; relieve hydraulic pressure.
2. Park skid loader on a flat and level surface, then lower the attachment to the ground.
3. Set parking brake and disengage lock pins using the lock lever switch (if installed).
4. Turn off skid loader engine.
5. Disconnect hydraulic hoses.
6. Pull latch handles to disengage lock pins.
7. Re-enter cab and start skid loader engine.
8. Tilt mounting coupler forward until mounting bracket is free from mounting plate.
9. Drive skid loader backward to clear the attachment.

## 2.4 CONTROLS



### WARNING

Review the “Controls” section of your skid steer owner’s manual before operating this trencher. Be familiar with the function of all controls to prevent a serious injury or death.



### NOTICE

Before operating this attachment, check the skid loader’s hydraulic oil level and add oil if necessary.

### HAY BALE SQUEEZER CONTROLS

This attachment is controlled by the operator sitting in the cab of the skid loader. The Hay Bale Squeezer’s open and close function are operated by activating the auxiliary hydraulic circuit.

Height and tilt functions of this attachment is operated with the control handles or pedals in the cab.



### NOTICE

If during your initial startup you realize the hay bale squeezer operates in the opposite direction that you prefer, you can change positions of the quick disconnect couplers on the attachment hoses to remedy your problem.

## 2.5 INITIAL USE PROCEDURE

### AFTER STARTING THE SKID LOADER

01

#### HYDRAULIC SYSTEM

With the skid loader engine RPM just above idle, activate skid loader’s auxiliary hydraulic system.

02

#### RAISE

the attachment 12-18 inches off the ground.

03

#### SKID STEER

Slowly engage the hydraulic flow until the squeezer arms are fully open.

04

#### CLOSE

squeezer arms.

05

#### REPEAT

Repeat steps 2 and 3 above two more times to purge air from the system.

06

#### LOWER

the attachment to the ground, set parking brake, shutdown engine and exit the cab.

07

#### CHECK

the skid loader’s hydraulic oil level, add oil if necessary.

08

#### INSPECT

the attachment’s hydraulic plumbing for any noticeable leaks. Fix before continuing.

## 2.6 OPERATING TIPS



### WARNING

Never operate this attachment in an enclosed work area. Exhaust fumes could result in serious injury or death. This attachment should be used in an open air environment.

### GENERAL OPERATING TIPS

#### KEEP ALL BYSTANDERS AWAY

when transporting or stacking hay bales.

#### TRANSPORT

hay bales as low to the ground as possible.

#### WHEN STACKING HAY BALES

watch for overhead obstructions/cables or wires.

#### WHEN CARRYING BALES THAT HAVE BEEN WRAPPED IN PLASTIC

make sure the squeezer arms are fully opened before pulling away with the tractor to prevent tearing the plastic and causing possible spoilage.

#### AFTER CLAMPING A BALE

the skid loader arms should tilt back slightly when transporting.

#### WHEN PICKING A HAY BALE FROM A STACK

always pick from the top. Never try to grab or transport a hay bale with another bale stacked on top.

#### NEVER

use the hay bale squeezer to clamp trees or other objects.

## MAINTENANCE PROCEDURES

### 3.1 MAINTENANCE OVERVIEW

The maintenance procedures described in this manual should only be carried out by qualified mechanics who have been trained to repair this machine.

Some procedures require special tools and skills to complete. DO NOT attempt to repair or perform service work on this machine unless you have the skills and tools to do so. Contact your local dealer for maintenance and repair services.

### WELDING REPAIRS

Contact your local dealer before performing any type of welding repair to this attachment, as this may void warranty.

All authorized welding repairs must be performed by qualified welders in accordance to the American Welding Society (AWS) standards. Welding procedures performed by unqualified welders may deem this attachment unsafe to operate.



### NOTICE

Improper maintenance or modifications to the design or performance of this machine will void the manufacturer's warranty. ONLY use genuine OEM replacement parts on this machine.

## SAFETY INSTRUCTIONS

Obey the following safety instructions when servicing or repairing this machine.



#### WEAR

proper Personal Protective Equipment (PPE) while working on this machine, which may include safety glasses, hard hats, steel toe boots, gloves, etc.



#### WEAR

a welding helmet when welding to protect your eyes, face and neck from flash burn, ultra-violet radiation and heat.



#### ONLY

perform service work in a well-lit area.



#### ALLOW

the machine to cool down before servicing this machine. Hot oils can burn your skin.

## 3.2 MAINTENANCE SCHEDULE

This attachment will provide years of dependable service if routine maintenance procedures are performed. The maintenance tasks listed below are based on normal operating conditions. More frequent maintenance may be necessary with intense use or when operating in adverse environmental conditions.

MAINTENANCE TASK	BEFORE EACH USE	WEEKLY	YEARLY
Check skid steer loader hydraulic fluid level. Add fluid as necessary.	✓		
Check that all fasteners (nuts, bolts, washers, pins, keepers) are in place. Tighten as necessary.	✓		
Inspect and replace any worn, torn, or missing safety decals.	✓		
Inspect hydraulic plumbing (hoses and connectors) for damage or leakage. Repair or replace hydraulic items as necessary.	✓	✓	
Lubricate all pivot joints using #2 lithium grease.	✓		
Check attachment for major scratches and dings. Sand and repaint these areas to prevent rust damage. *Use a paint formulated for farm equipment which can be found at your local hardware store.			✓

### MAINTENANCE LOG

Document all maintenance and service activities performed on this trencher using the maintenance log included at the end of this manual.

## 3.3 STORAGE

### STORAGE TIPS

To get years of quality use out of your brush cutter, follow these tips when storing your brush cutter:



#### WASH

Ensure attachment is free of debris, dirt, grime and grease.



#### STORE

Store your attachment in a dry shed or garage.



#### COVER

When storing your attachment outside, cover with a weather proof tarp to protect it from the elements.

# TROUBLESHOOTING

## 4.1 TROUBLESHOOTING CHART

PROBLEM	CAUSE	RESOLUTION
Arms do not open and close	Quick disconnect couplers not connected.	Connect quick disconnects.
	Hydraulic hose damaged.	Check for smashed or kinked hose and replace if necessary.
	Skid loader auxiliary hydraulic circuit not activated.	Check skid loader auxiliary hydraulic system and confirm if activated.
Skid loader hydraulic oil level goes down during operation	Hydraulic leak at hoses on attachment.	Investigate and repair.
	Leak in skid loader hydraulic system.	Investigate and repair.
Arms move very slowly	Restricted hydraulic hose.	Check for damaged hose between skid loader & bale squeezer cylinders.
	Hydraulic circuit relief not working on skid loader.	Investigate and repair.
	Auxiliary valve spool on skid loader not shifting properly.	Investigate and repair.
	Faulty cylinder seals.	Have cylinders repacked or replace with new ones.

# SPECIFICATIONS

	BALE SQUEEZER	
	X-TREME DUTY	HEAVY DUTY
CLOSED WIDTH	30" (762mm)	
LENGTH	69.2" (1758 mm)	
OPENING WIDTH	79.3" (2014 mm)	
WEIGHT	691 lbs (313 kg)	
CAPACITY	2800 lbs (1270 kg)	
SSL AUXILIARY HYD. CIRCUITS REQUIRED	1	
HYD. RELIEF SETTING	3000 PSI (207 bar)	

### X-TREME DUTY

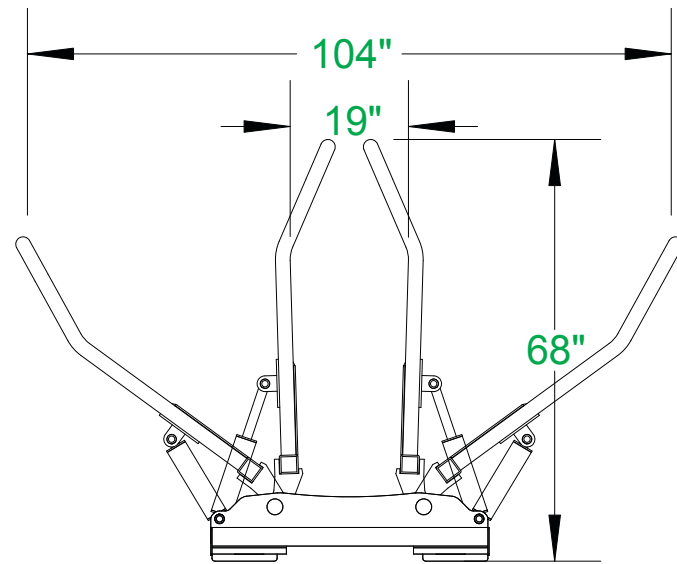

### HEAVY DUTY

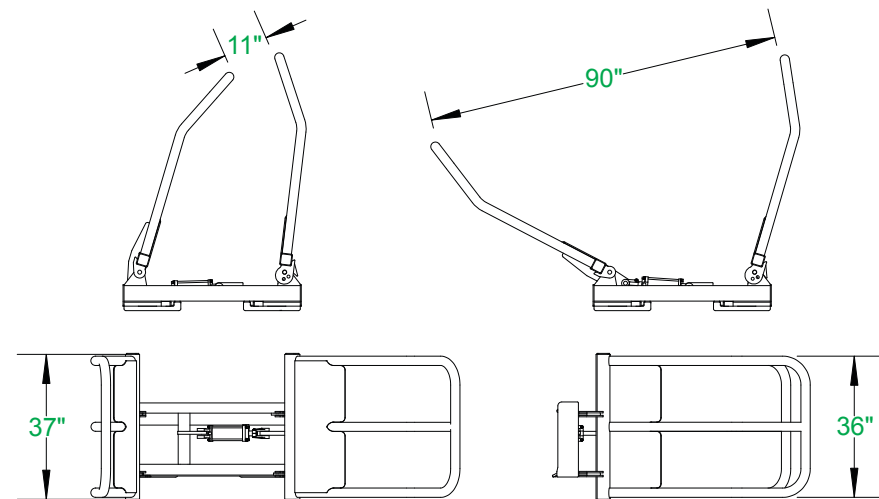

## PARTS INFORMATION

Factory fresh parts specifically designed for your implement are readily available.

For hassle free service and to ensure you receive the correct parts for your implement, please provide your dealer with the following information:

<b>MODEL</b>	
<b>SERIAL NUMBER</b>	
<b>GPM REQUIREMENTS</b>	
<b>DATE OF OWNERS MANUAL</b> (On cover Page)	
<b>PARTS DIAGRAM</b> <b>PAGE NUMBER</b>	
<b>PART DESCRIPTION</b>	
<b>REFERENCE NUMBER</b>	
<b>QUANTITY DESIRED</b>	
<b>SHIP TO INFORMATION</b>	
<b>BILL TO / PAYMENT</b> <b>INFORMATION</b>	

Use Genuine Parts from Construction Implements Depot, Inc.

## 6.1 PARTS ASSEMBLY DIAGRAMS

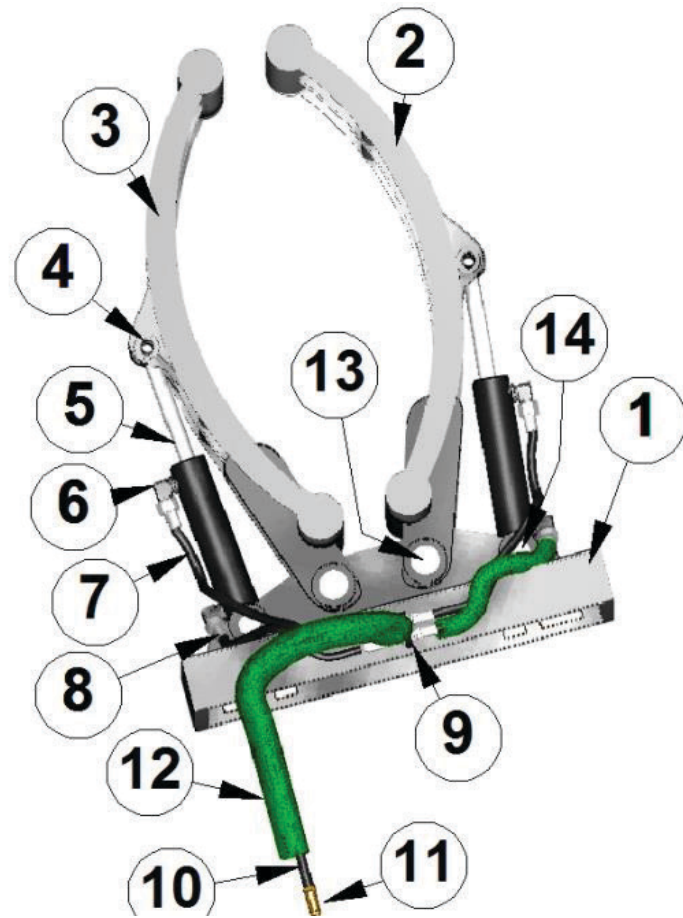

REF	DESCRIPTION	QTY.
1	Frame Weldment	1
2	Squeezer Arm Weldment - RH	1
3	Squeezer Arm Weldment - LH	1
4	Pin, Cylinder Rod End to Squeezer Arm	2
5	Cylinder, frame to Squeezer Arm	2
6	Elbow 90°, Hoses to Cylinder	4
7	Hose, Tee to Rod End of Cylinder	2
8	Hose, Tee to Base End of Cylinder	2
9	Tee	2
10	Hose, Quick Disconnect to Tee	2
11	Quick Disconnect Set	1
12	Sleeve, Protective Hose — Specify Size & Length	A/R
13	Pin, Squeezer Arm to Frame	2
14	Pin, Cylinder to Frame	2+

### NOT SHOWN

PART #	DESCRIPTION	WT
50516591	2.5 x 8 Cylinder -XD	21
50516592	2.5 x 8 Cylinder Seal Kit	3
50516593	Tie Rod Cylinder -HD	23

# WARRANTY INFORMATION

## 7.1 WARRANTY INFORMATION

### LIMITED WARRANTY

Ironcraft products are warranted to be free from defects in workmanship or materials for a period of 12 months from the initial sale, lease or rental date.

### WARRANTY EXCLUSIONS

This warranty does not cover normal wear items, including but not limited to: bearings, hoses, ground engaging parts such as teeth, blades, cutting edges, pilot bits, auger teeth and broom bristles. This warranty does not cover maintenance, service or adjustments. This warranty does not cover damage due to misuse, negligence, accidents, improper maintenance or modifications of this product. This warranty is void if any components have been disassembled, i.e., pumps, gear boxes or motors. Specially modified attachments built by Ironcraft X-treme Attachments to meet your customers' needs shall not be warranted by Construction Implement Depot, Inc. This warranty does not cover replacement parts not supplied by Ironcraft, Inc.

### WARRANTY STATEMENT

Our obligation under this Limited Warranty shall be solely limited to repairing or replacing any part (see non-covered items above) free of charge that, according to our judgment, show evidence of a defect in quality of workmanship or materials for the stated 12 month warranty period. All defective parts must be routed directly to Ironcraft with freight or delivery charges to be prepaid. This limited warranty shall not be interpreted to render Ironcraft liable for any injury or damage to persons, businesses or property of any kind nor expenses or losses incurred for labor, supplies, substitute machinery rental or for any other reason. Repair or replacement parts are subject to the supply conditions at the time of repair or replacements, which may directly affect our ability to obtain material and/or replacement parts. Ironcraft reserves the right to make improvements in design or changes in specifications at any time without incurring any obligations to owners of previously purchased products. No one but Ironcraft is allowed to alter, modify or enlarge this warranty nor the exclusions, limitations and reservation at any time.

## 7.2 WARRANTY SERVICE

### WARRANTY SERVICE PROCEDURE

RGA (Returning Goods Authorization) Policy:

If repairs are required, Ironcraft must obtain an RGA number from the manufacturer of the defective part and proof of purchase. RGA and services are rendered by Ironcraft only. Any responsibility of shipping costs on any item returned for repair is at the discretion of Ironcraft.

All returned parts must have:

1. A legible RGA number written on the outside of the package.
2. A Service Request Form.
3. The defective part.

RGA numbers are only valid for 30 days from the date of issue. All shipped replacement parts will require a PO number from the original Ironcraft Customer. If the defective part is rendered non-warranty, the PO number will be invoiced for the replacement. Should you have any problems with your attachment, please follow the following procedures to obtain service.

**Call the Warranty Department at (336) 859-2002 ext 215.** You will need to provide the model and serial number of the defective item(s), a description of the problem and have photographs available.

Upon a warranted issue, visit [www.ironcraftusa.com](http://www.ironcraftusa.com), click on the warranty tab, and fill in the warranty information. Ironcraft will retain an RGA number from the manufacturer of the defective part. If all the information above is fulfilled the manufacturer will issue an RGA number.

Obtain a PO number from the original Ironcraft customer. PO numbers will be invoiced in the event the defective part(s) is un-warranted

Ironcraft will ship a replacement part with a Service Request Form and RGA #. There will be a call tag with the Manufacturer's address and instructions for returning the defective part.

Once the defective part is warranted by the manufacturer, Ironcraft will be issued a credit and the PO number will be void.

In the event the manufacturer renders that the attachment be returned to Ironcraft for repair, Ironcraft will make arrangements for pickup and return. Repairs will be performed by Ironcraft qualified technicians. Non-warranted issues will be discussed and repairs will be performed upon agreement of the owner, and payment for parts and labor will be issued.



# SAFETY ACKNOWLEDGEMENT FORM

ATTN ALL OPERATORS: Print your name, sign and date in the boxes below to acknowledge that you have read and fully understand the safety instructions presented in this manual, and have been trained on how to safely operate this attachment.

OPERATOR NAME	SIGNATURE	DATE

OPERATOR NAME	SIGNATURE	DATE

# MAINTENANCE LOG

Use this log sheet to document all routine maintenance and repair services performed on this machine.

DESCRIPTION OF MAINTENANCE	SERVICED BY	DATE

DESCRIPTION OF MAINTENANCE	SERVICED BY	DATE

DESCRIPTION OF MAINTENANCE	SERVICED BY	DATE

DESCRIPTION OF MAINTENANCE	SERVICED BY	DATE



7 ROCKY MT RD  
*Athens, Tennessee 37303*



(P) 423-405-5150

(F) 423-405-5904

WWW.IRONCRAFTUSA.COM



Association of  
Equipment Manufacturers

MEMBER