

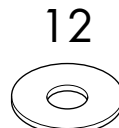

PARTS CHECKLIST		
Item	Description	Quantity
1	Bowl Top	1
2	Gasket	1
3	Bowl Base	1
4	Hub	1
5	Paddle	2
6	Strengthen Plate	1
7	Bolt M8 x 25mm	14
8	Nyloc Nut M8	24
9	Set Screw M8 x 35	8
10	Set Screw M8 x 40	2
11	Plain Washer M8	44
12	Penny Washer M8	4

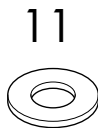
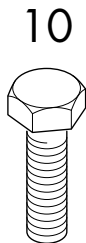
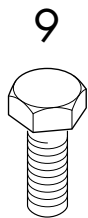
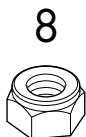
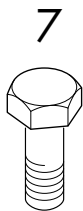
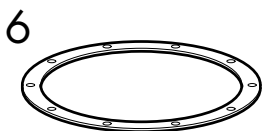
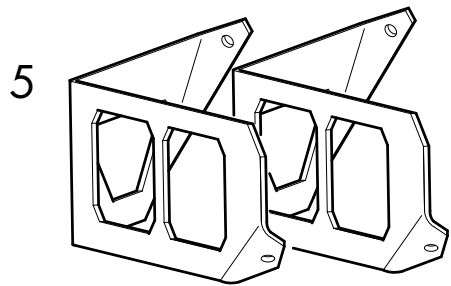
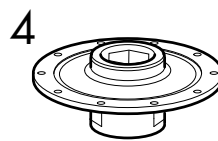
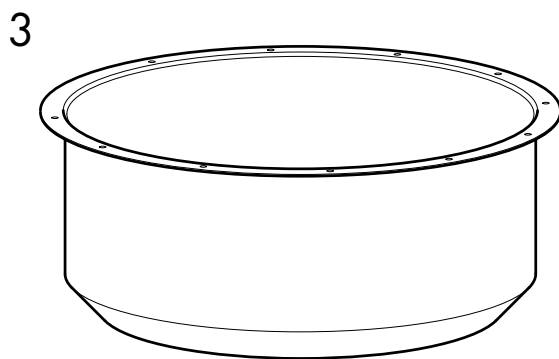
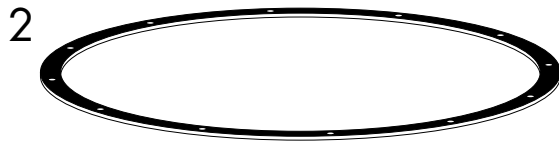
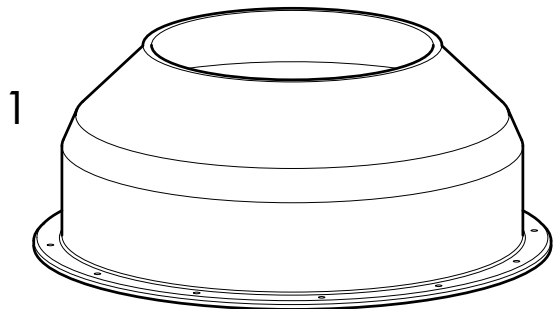

1

With the bowl base inverted, insert 8 screws, washers and nyloc nuts up through the bowl base, leaving 2 holes as shown.

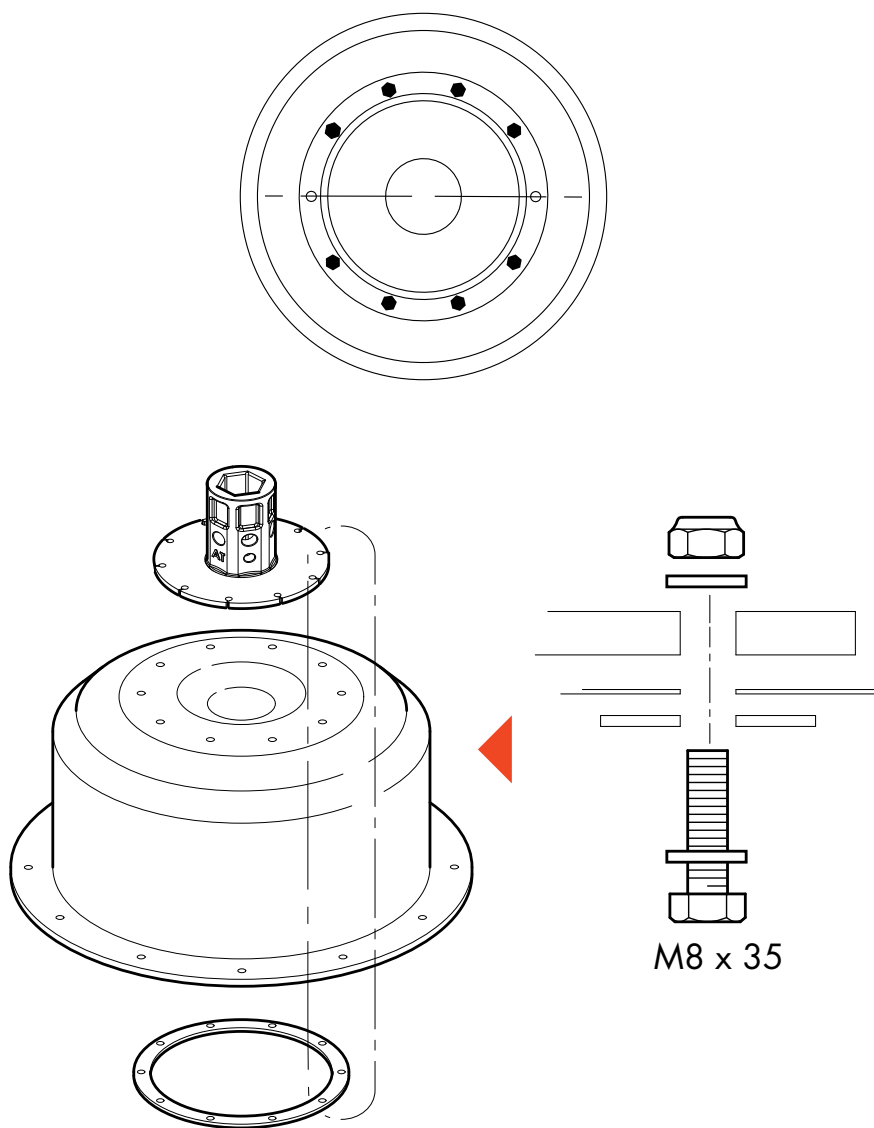

2

With the bowl top inverted, insert 12 screws with washers up through the holes in the rim of the bowl top and the gasket. The holes in the gasket are a tight fit on the screws and will prevent them from falling out.

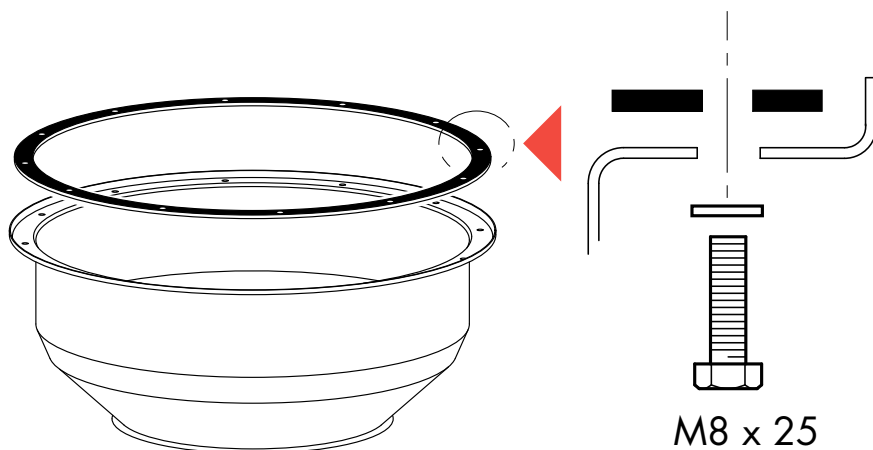

3

Turn the bowl top over and lower it on to the bowl base. Holes for mounting the mixer paddles are located in the hood top and the drive hub, where 2 bolts have been left out. Use Detail A as a guide for the arrangement of the mounting holes when aligning the screws to fix the bowl top together.

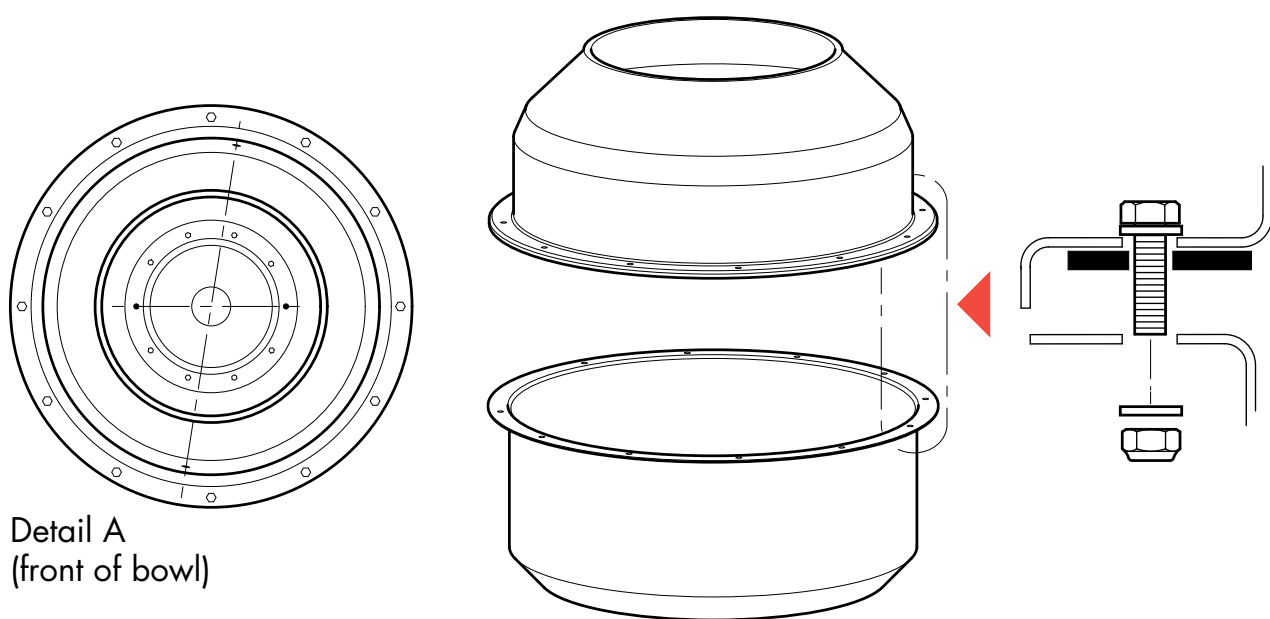

4

Attach the paddles as shown in Details B, C & D.

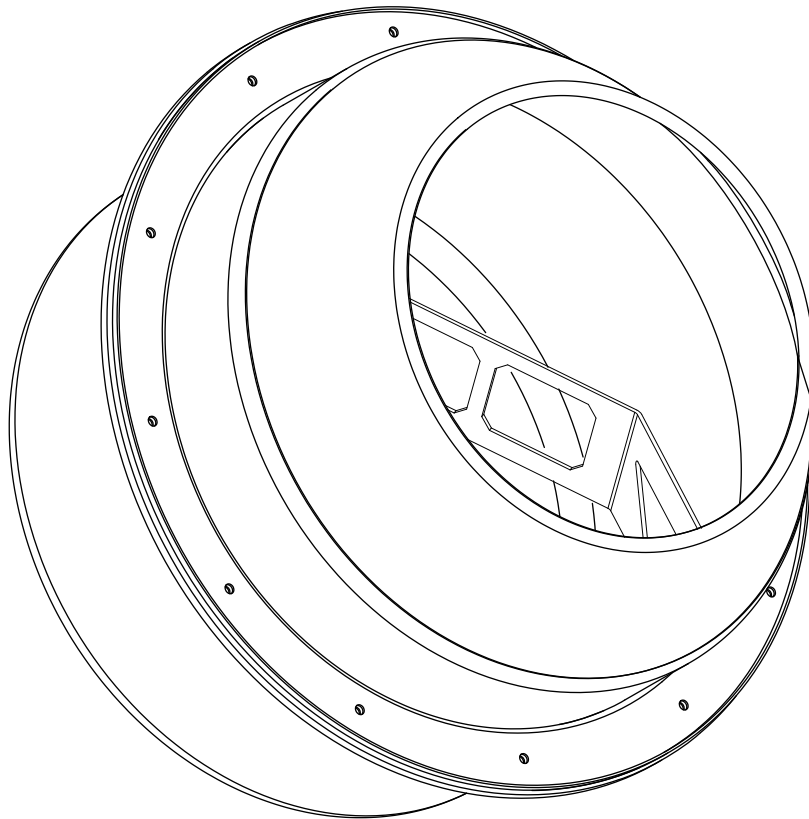
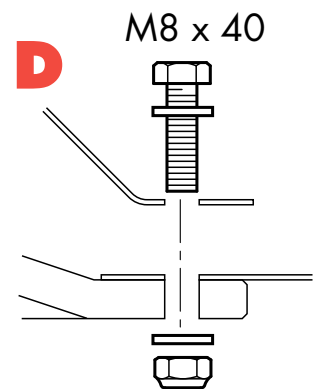
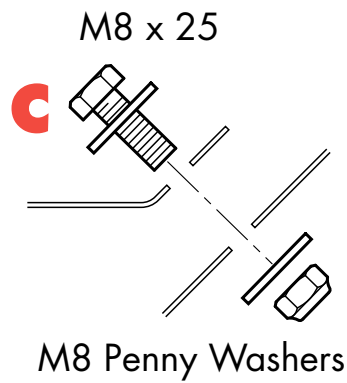
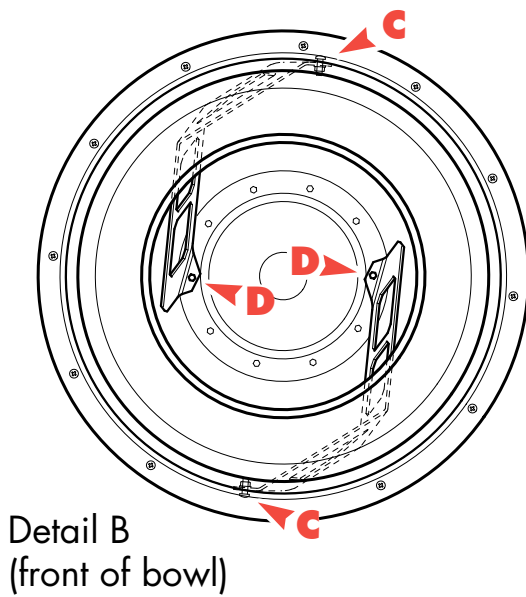



MIXER BOWL

ASSEMBLY INSTRUCTIONS

ETERRA WARRANTY STATEMENT

LIMITED PRODUCT WARRANTY

If you find physical defects in the materials or the workmanship used in making the product described in this document; Eterra will repair, or at its option, replace, the product at no charge to you, provided it is returned (freight prepaid, with proof of your purchase from the original reseller) within 1 year of the date of original purchase. Some Eterra products may have longer, partial, or more specific additional warranties, please contact your dealer for more information.

RMA REPLACEMENT PRODUCT WARRANTY

If you find physical defects in the materials or the workmanship used in the refurbishment of an RMA (Return Merchandise Authorization) product replacement; Eterra will repair, or at our option replace the product at no charge to you for a period of 90-days from the date the RMA was created, or until the end of your original warranty period (whichever is greater).

REFURBISHED PRODUCT WARRANTY

If you find physical defects in the materials or the workmanship used in a product sold as a refurbished unit; Eterra will repair, or at our option replace, the product at no charge to you for a period of 90-days from the original date of purchase.

LEGAL TERMS

Eterra warrants that the equipment delivered by seller will be of the kind and quality described in the order or contract and will be free from defects in workmanship or material. Should any failure to conform with this warranty occur, and the buyer having given written notice to seller within 180 days from the date of purchase, the manufacturer shall correct such nonconformity at its option by either repairing the defective part(s) or making available F.O.B. at sellers locations.

This warranty is in lieu of all warranties of merchantability, fitness for particular purpose or any other warranties, express or implied. Correction and nonconformities in the manner and for the period of time provided above, shall constitute fulfillment of all liabilities of seller to buyer, whether based on contract, negligence or otherwise respect to or arising out of such goods.

Neither party shall be liable for special, indirect, or consequential damages. The remedy set forth in this instrument are exclusive, and the liability of seller with respect to any contract or sale of anything done in connection with the same, whether in contract, in tort, under warranty, or otherwise, shall not exceed the price of the goods or part upon which such liability is allegedly based.

All exclusions and limitations of this warranty are made only to the extent permitted by applicable law and shall be of no effect to the extent of conflict with the express requirements of applicable Washington State law.



YOUR DEALER IS

Eterra
2316 East Bakerview Rd.
Bellingham,
Washington 98226
USA

Tel: 360-203-7730
sales@eterraattachments.com
www.eterra-usa.com