

Standard Duty Root Grapple

Our Standard Duty Grapple is built from 3/8" thick steel plate on the top and bottom, and incorporates 3" square tubing.

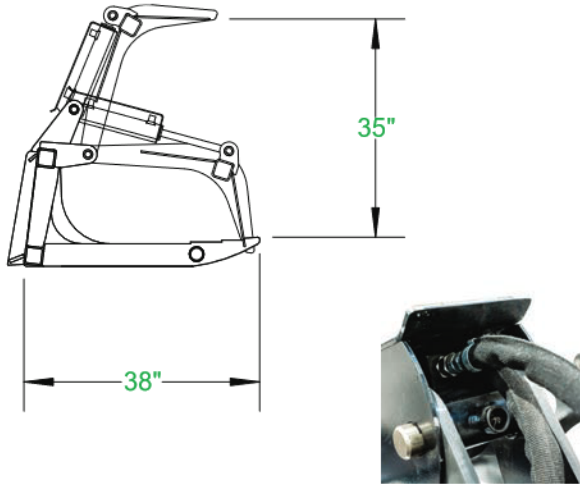

- Rated for 45 HP and under
- 2" x 10" cylinders
- Hydraulic lines routed inside the tubing to prevent tears
- Optional spacer tines



Heavy Duty Root Grapple

Our heavy Duty Grapple is built from 1/2" thick steel plate on the top and bottom, and incorporates 3" square tubing.

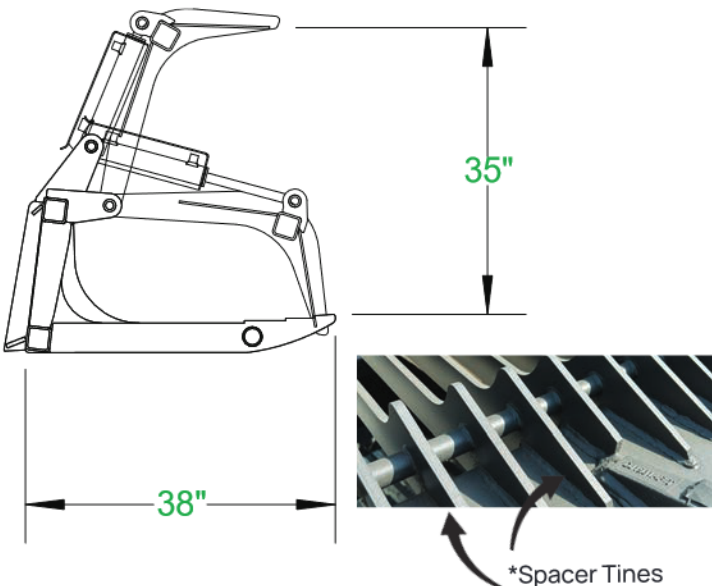

- Rated for 45 - 65 HP
- 2" x 10" cylinders
- Hydraulic lines routed inside the tubing to prevent tears
- Optional spacer tines

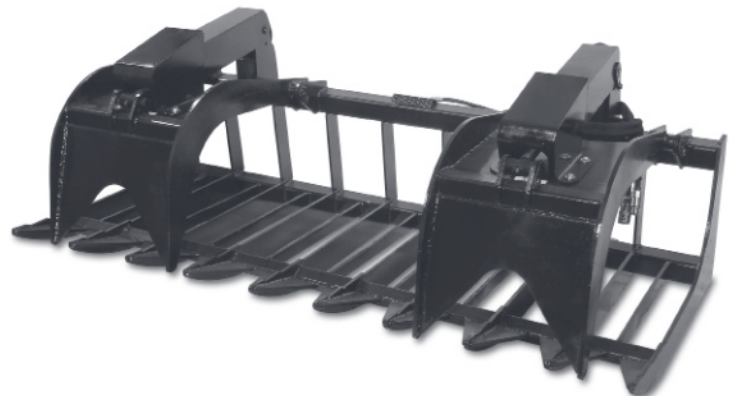

***Picture shown with optional spacer tines and optional bolt on rod cover kit.**