

FINISHED PRODUCT SPECIFICATION

Document:	Research and Development
Effective Date: 06/27/2023	Program: Specification Program
Revised By: Nancy Zuniga	Location: GH/KRONOS
Approved By: Nick Spondike, Chief Innovation Officer	

Item Name:

PRE-CUT POCKET PITA 6" ORIGINAL

Item Number:

002227



FINAL WEIGHT PER PITA			
2.5 oz		71 g	
FINISHED PITA DIMENSIONS			
	MINIMUM	TARGET	MAXIMUM
WEIGHT (g)	70	71	72
LENGTH (in.)	6.14	6.00	6.50
WIDTH (in.)	N/A	N/A	N/A
HEIGHT (in.)	N/A	N/A	N/A
MOISTURE	30%	32%	34%
FINISHED pH	5.4	5.5	5.65

ITEM DESCRIPTION

Flavor:

Typical Baked Flavor

Color:

Fully Baked with Toast Points on Top and Bottom

Texture:

Firm, Moist and Tender

ITEM PACKAGING

Primary Packaging:	Printed Bags / Cardboard	Primary Case Type:	Printed Master Case Box
No. of Pieces / Bag:	10 Pitas	No. of Bags / Case:	12 count bags
No. of Pieces / Case:	120 Pitas	Case Gross Wt. (lbs):	20.00 lbs
Cases Per Pallet:	49 cases	Case Gross Wt. (kg):	9.07 kg
Rows Per Pallet (Hi):	7 High	Case Net Wt. (lbs):	18.75 lbs
Cases Per Row (Ti):	7 Per Layer	Case Net Wt. (kg):	8.50 kg
Case Dimensions:	19.563 x 13.563 x 10.750 in	Cases Cube (Cu. Ft.):	1.65 Cu. Ft.
UPC Code Number:	0 77589 40227 3	Pallet Weight (lbs/kg):	1030 lbs (467 kg)

STORAGE & SHELF LIFE & CODE DATE FORMAT

Storage Conditions:	FROZEN (0°F)	Distributed:	10°F or Less
Shelf Life from Production:	Frozen (0°F): 9 Months (270 days) Refrigerated (40°F): 14 Days Ambient (70°F): 7 Days	Code Date Format:	Kwik Lok: 163-20 N 22:43 Example: 163 (Julian Date) 20 (Year) N (Shift) 22:43 (Military Hour) MasterCase: 163-20 22:43 Example: 163 (Julian Date) 20 (Year) 22:43 (Military Hour)

Certified Kosher	Certified Halal	Certified Organic	Certified CN
YES	NO	NO	NO

INGREDIENT STATEMENT

INGREDIENTS:

Enriched flour (wheat flour, malted barley flour, niacin, iron, thiamin mononitrate, riboflavin, folic acid), water, wheat gluten, yeast, contains less than 2% or less of the following: salt, calcium propionate (preservative), guar gum, cellulose gum, acacia gum, dextrose, calcium sulfate, microcrystalline cellulose.

CONTAINS:

WHEAT

FINISHED PRODUCT SPECIFICATION	
Document:	Research and Development
Effective Date: 06/27/2023	Program: Specification Program
Revised By: Nancy Zuniga	Location: GH/KRONOS
Approved By: Nick Spondike, Chief Innovation Officer	

NUTRITIONALS PER SERVING SIZE

Recommend Serving Size: 1 Pita - 2.5 oz. (71 g)

Nutrition Facts	
10 servings per container	
Serving size	1 Pita (71g)
Amount per serving	
Calories	170
% Daily Value*	
Total Fat 0.5g	1%
Saturated Fat 0g	0%
Trans Fat 0g	
Cholesterol 0mg	0%
Sodium 290mg	13%
Total Carbohydrate 34g	12%
Dietary Fiber 1g	4%
Total Sugars 1g	
Includes 0g Added Sugars	0%
Protein 7g	
Vitamin D 0mcg	0%
Calcium 50mg	4%
Iron 2mg	10%
Potassium 58mg	2%
Thiamin 0.3mg	25%
Riboflavin 0.2mg	15%
<small>*The % Daily Value tells you how much a nutrient in a serving of food contributes to a daily diet. 2,000 calories a day is used for general nutrition advice.</small>	
<small>Calories per gram: Fat 9 • Carbohydrate 4 • Protein 4</small>	

ALLERGENS AND OTHER SENSITIVE INGREDIENTS

	Column I	Column II	Column III
ALLERGEN	Present in the Product	Present in other products manufactured on the same line	Present in the same manufacturing plant
Peanut	NO	NO	NO
Tree Nuts	NO	NO	NO
Milk and Dairy Products	NO	NO	NO
Eggs	NO	NO	NO
Fish	NO	NO	NO
Shellfish and Molluscs	NO	NO	NO
Soy	NO	NO	NO
Wheat	YES	YES	YES
Sulfites, e.g., sulfur dioxide and sodium metabisulfites, etc	NO	NO	NO
Monosodium Glutamate (MSG)	NO	NO	NO

Document: Research and Development

Effective Date: 06/27/2023

Program: Specification Program

Revised By: Nancy Zuniga

Location: GH/KRONOS

Approved By: Nick Spondike, Chief Innovation Officer

MASTER CASE

FOR BEST RESULTS STORE FROZEN			
OPERATOR NAME MM/DD/YR			

PALLET PATTERN

Friday, October 12, 2012

Product Name TOUFAYAN BAKERY
Product Code 2222 KRONOS
Datafile Name 2222 kronos (10/12/2012)
Load Ref. 1 I
Cube Used 88.2 %
Area Used 96.7 %
Pallet type 48x40

7 Case / Layer
7 Layer / Load
49 Case / Load

	Length	Width	Height	Net	Gross	Volume
Case (ID)	19.188	13.188	10.000 in	20.000	20.000 lb	1.46 cuft
Case (OD)	19.563	13.563	10.750 in	20.000	20.000 lb	1.65 cuft
Product	46.688	40.688	75.250 in	980.000	980.000 lb	82.72 cuft
Load	48.000	40.688	80.750 in	980.000	1030.000 lb	91.27 cuft
Overhang	-0.656	0.344	in			

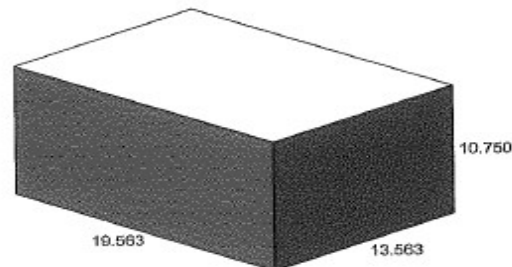
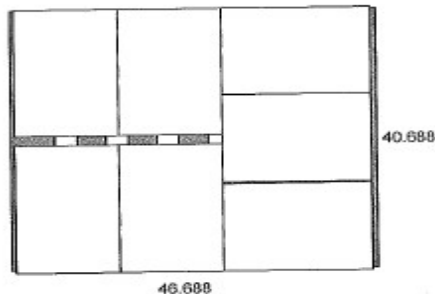
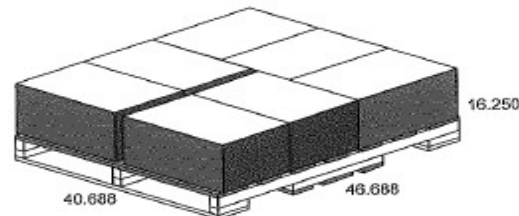
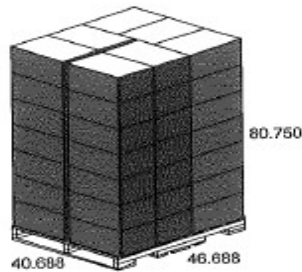

CAPE PALLET LAYOUT
Prepared By Bell Container Corp.

*** FOR PALLET PATTERN GUIDE ONLY ***