

Quick Start Guide

Global Payments Terminal

Semi-Integrated with

Epic POS System– T650C/T650P



Get started

Welcome to the **Quick Start Guide**! It's your go-to resource for quickly and easily setting up and using your new payments terminal. This guide covers everything from the initial setup to processing payments, ensuring you have all the essential information at your fingertips. We'll also provide you with helpful links to additional resources to maximize the potential of your new payment solution. **Let's get started!**

Terminal ON/OFF

The terminal power configuration differs across devices; view the table below to see the power connectivity method for your device(s):

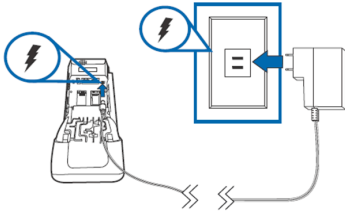
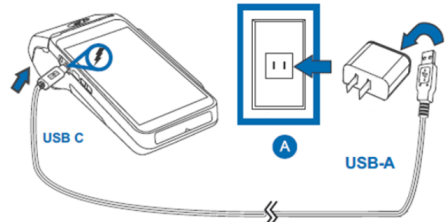
| Countertop—T650C | Wireless—T650P |
|---|--|
| <p>The T650C features a dedicated DC power connector for easy and convenient power supply.</p>  | <p>The T650P comes pre charged, but we advise you to charge the terminal to ensure it maintains a battery life above 15% for seamless transaction processing. Inside the box, you will find the power cable. To charge the device, insert the USB port into the T650P and connect the other end to the power supply.</p>  |

- **Power On:** Press and hold the power button [⏻] to turn on the device.
- **Power Off:** Press and hold the power button [⏻] to wake the device up. After it is turned on, press and hold the power button [⏻] until the "User Menu" displays on the screen. Tap [⏻ **Power off**] to turn off the device.

Network communication

Network configuration differs across devices; view the table below to see the available connectivity method for your device(s):

| Device name | Countertop—T650C | Wireless—T650P |
|-----------------------------|--------------------|----------------|
| Available connectivity mode | Wi-Fi and Ethernet | Wi-Fi |

To set up your device connectivity, follow the steps based on the communication mode configuration that you ordered.

For a Wi-Fi set-up

1. Ensure the payment device has been added to the merchant's Wi-Fi network first.
2. **Swipe down** from the top of the home screen. When you see the status bar, **swipe down** again.
3. Tap the **Wi-Fi icon** to toggle "**Wi-Fi On**"
4. Tap the **arrow** at the bottom of the Wi-Fi icon to display available networks
5. Tap the **SSID name** of the Wi-Fi network that you want to connect to from the list.
6. Enter the Wi-Fi password, and then tap [**CONNECT**].

For an ethernet set-up (Countertop—T650C only)

1. Ensure the payment device has been added to the merchant's Ethernet network first.
2. Insert the Ethernet cable into the T650C device.
3. Connect the other end of the cable to the ETH port, as illustrated on the right.

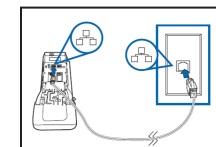

Performing a sale transaction

1. Initiate a transaction from the Epic POS system.
2. Follow the on-screen prompts provided by the EPIC POS application.
3. The cardholder taps/inserts/swipes their payment method and follows the prompts on the terminal screen for each card entry.
4. Transaction complete

Additional resources

Scan the QR code for additional support materials (User Guide) for your device(s).

Should you have any questions or require additional instructions, please contact the Global Payments Customer Care Centre at **1-888-682-3309**.

