

Replace Nest with tado°

How to replace your Nest setup with tado° Wireless Receiver X (EU)

Step 1.

Switch off the mains power and open the Heat Link Receiver

1. Make sure that the power to your heating system is turned off completely. You may need to switch the circuit breaker and the boiler off.
2. Your Nest Thermostat always comes with the Heat Link Receiver. Find the HeatLink unit (it is usually located next to your boiler) and open it.

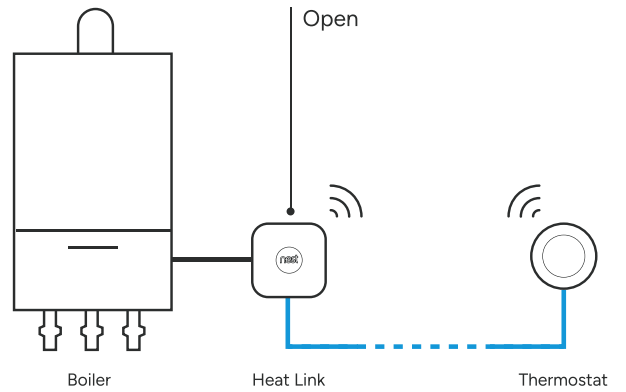

Step 2.

Move the cables from the Nest Heat Link Receiver to tado°

Please double-check which of the below cases reflects the wiring in your Nest Heat Link Receiver, as the tado° device will have to be wired accordingly.

Note: dashed wires in the pictures are optional and may not be present in your system.

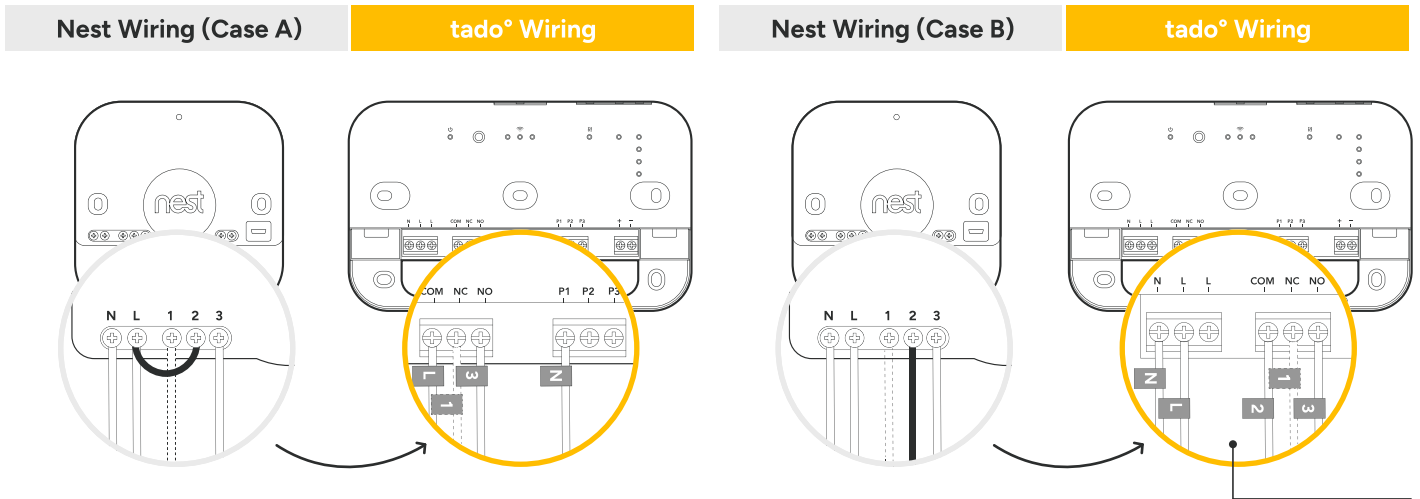

Before connecting the wires from your heating system, remove the pre-connected wires from the terminals N and L of the tado° Wireless Receiver X

Step 3.

Download the tado° App



If you have any questions or need more detailed instructions, you'll find a step-by-step guide for this installation —and many others— in the tado° app.

The app will also help you with installing your tado° Wireless Thermostat and any additional tado° device such as the Smart Radiator Thermostats or the Heat Pump Optimizer.

If you have any questions before purchasing you can contact our support team through the [tado° Help Center](#)