

QUICK START

Putnam 18-C Base Pedestal



VIDEO INSTRUCTIONS:

<https://vimeo.com/284290388>

Visit our website for detailed instructions.

www.lockncharge.com/support (International)

www.pclocs.com.au/support (AUS and NZ)

What's included?



x5



x4



x1



x2

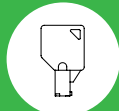

x2

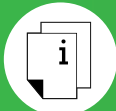

x2

1

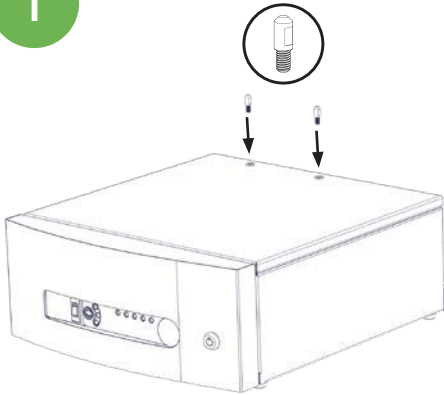

2

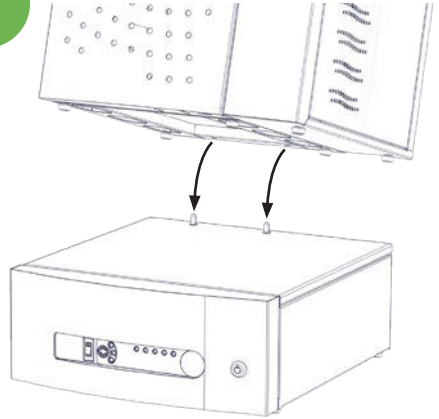

3

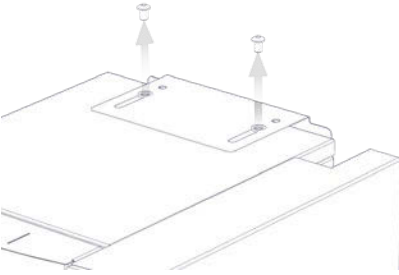

4

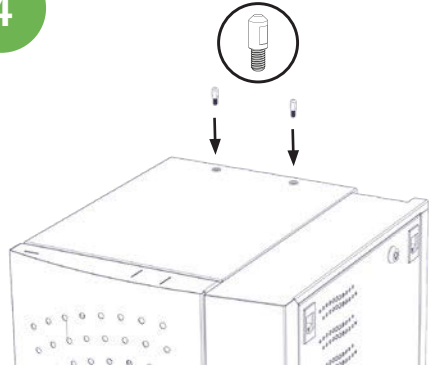

5

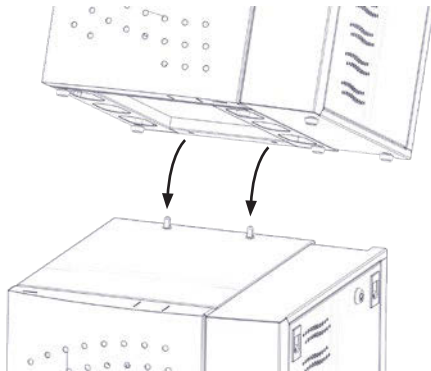

6

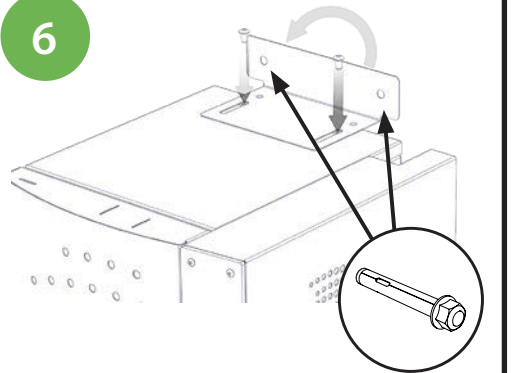

MANDATORY!!
Fix Unit to the wall using the supplied bracket before use.

7

Replace Y-cables with supplied cables

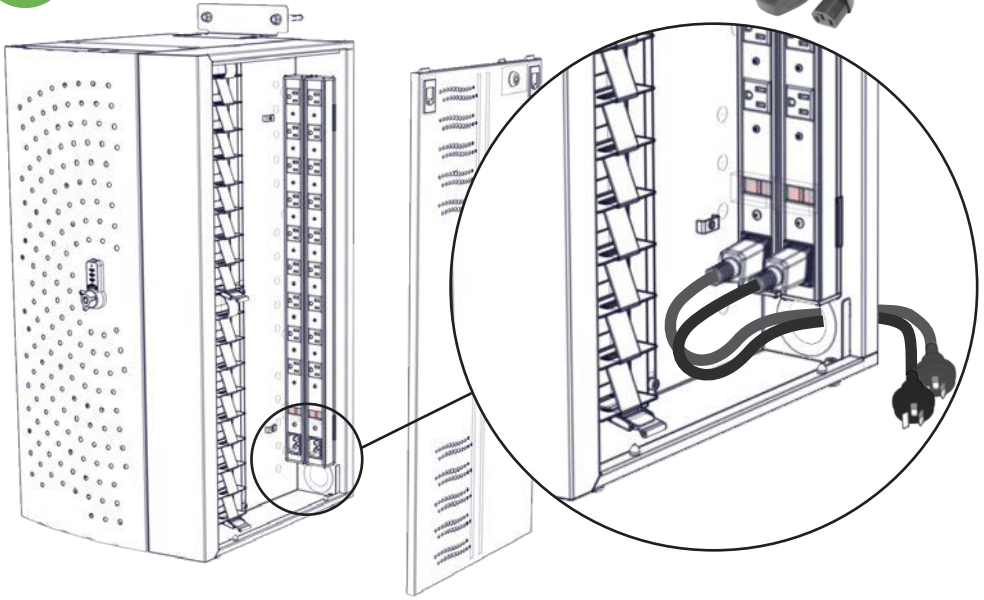

8

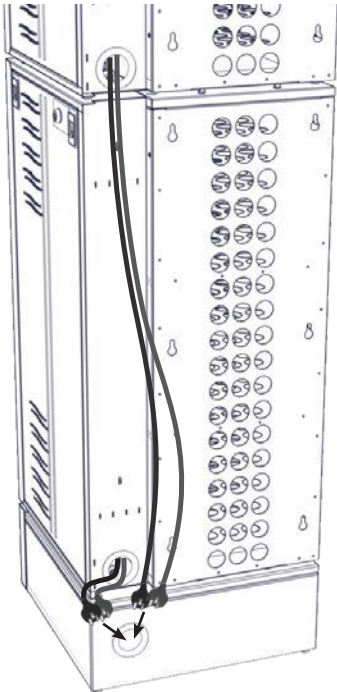

9

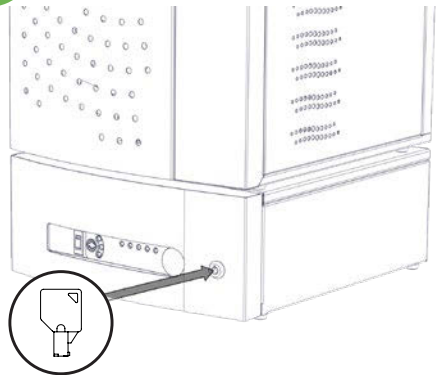

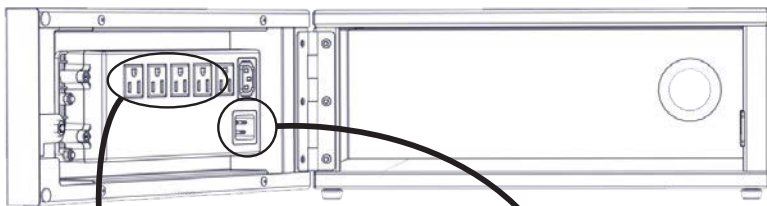

10

11

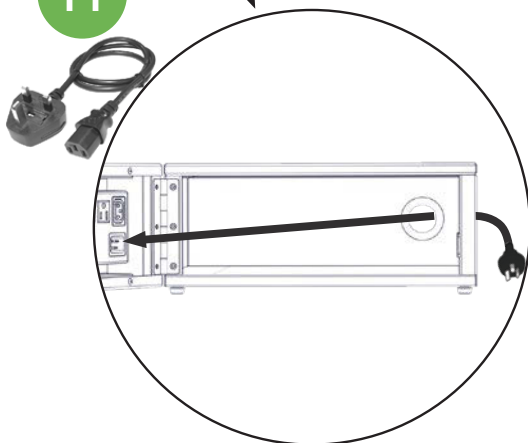
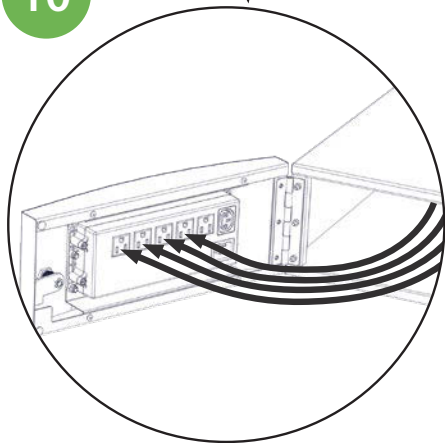

12

Using the ECO Safe Charge™



ADDITIONAL INSTRUCTIONS:
Detailed instructions included in the box.



VIDEO INSTRUCTIONS:
<https://vimeo.com/194627704>



DETAILED INSTRUCTIONS:
Visit our website and press the support button.



13

Visit our website for more details



VISIT:
www.lockncharge.com (International site)
www.pclocs.com.au (Australia and New Zealand)