

Light As Sculptural Art

A PureEdge Lighting Case Study



Location: KPFF, Portland, OR

Lighting System: Pipeline 1 Suspension 24VDC Rotatable Modular System

Architects: GBD Architects

Interior & Lighting Designer: Erika Beehler

Photography: Sally Painter Photography

When KPFF, a civil engineering firm with offices around the country, wanted to renovate their Portland location, up and coming Interior & Lighting Designer Erika Beehler from GBD Architects drew inspiration from the type of work KPFF does, and envisioned custom pipe art installations with lighting to accent the art, and also to be a part of the art.

Erika explains, "Very early on in the process of figuring out how to represent the type of work KPFF does through art and what form that would take, PureEdge Lighting's **Pipeline Suspension Modular system** was recommended, because of its ability to mimic those similar curves that we were creating with the pipes, both vertical plane and in ceiling. We really wanted to be able to celebrate the work they do through the art. It stuck for the whole time through the design, which was really awesome. It really sold the client in our renderings, where we were able to show how the installation and lighting fixtures interact. Pipeline was very successful from the beginning, and we were really excited to be able to get so much of it in the project".

The **Pipeline 1 (176° Lens) Suspension Rotatable Modular System** offers sleek tubes of diffused LED light and series of connectors, allowing you to easily piece together the fixture of your dreams. Run Pipeline 1 Suspension Light and Track Channels along an exposed ceiling, turn corners or climb walls with L, T, X, Y and Flexible Connectors, all in an easy-to-install plug and play package. With a low profile of 1.25" diameter Channel, length options from one to ten feet, 360° Rotatable Channel for direct or indirect lighting, high lumen output up to 1313 lm/ft, high CRI up to 95+, 9 Color Temperature Options from 2400K-4000K, and Warm Dim (27D, 30D), and a lamp life of 60,000 hours, the system offers solutions for every need.

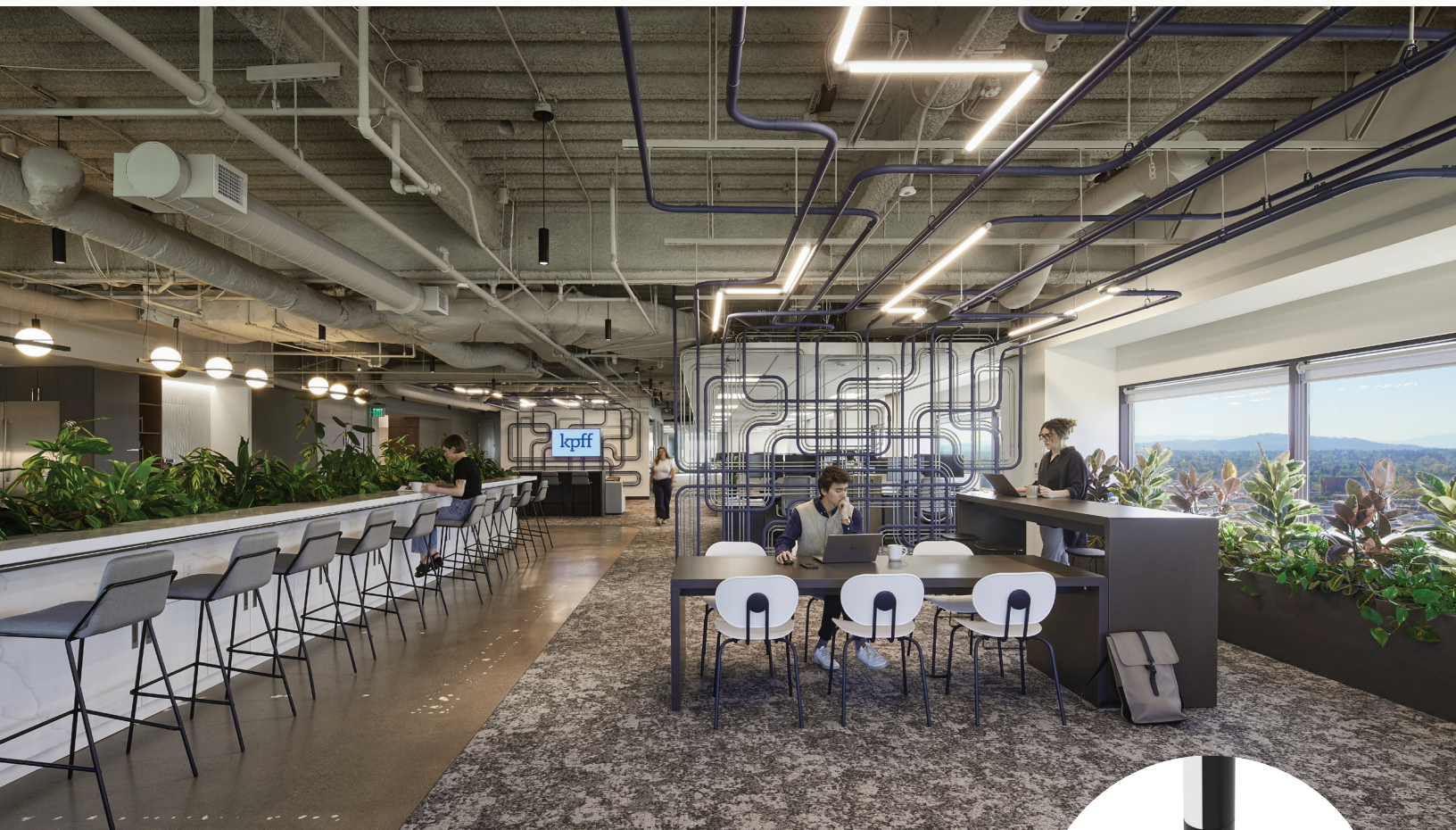

Erika continues, "There's so many options for attachments, and it was really cool to be able to see the kind of customization you're able to get. It's an off the shelf product, but the fact you're able to get drawings to see how the lighting integrates with the design is great. We chose to go with 3000K temperature with warm dim, which is controlled by light sensors, so if it's really bright and sunny outside, the system will automatically be a little dimmer".





Erika concludes, "We were trying to have sources of light that were beautiful as a sculptural piece and to make them kind of sing, be more visible and appreciated than just having all the lights being basic, and Pipeline contributed to the sculptural nature. Now that Pipeline 360 has been introduced, with more bendable shapes, that will be cool to use on future projects".

