



# LubeMate Lube System

## Owner's Manual

### Mobile & Permanent

Specifications • Installation • Safety • Operation

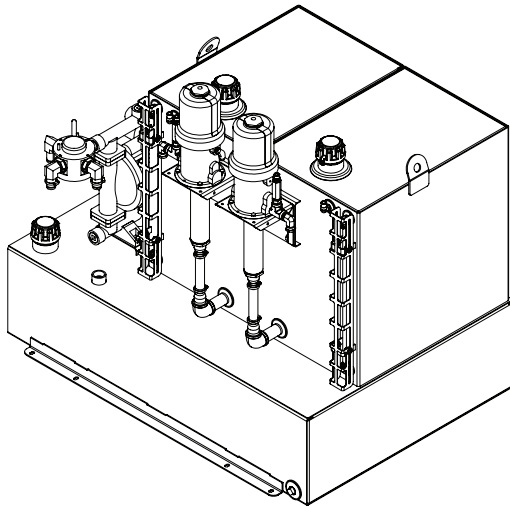

Permanent Mount

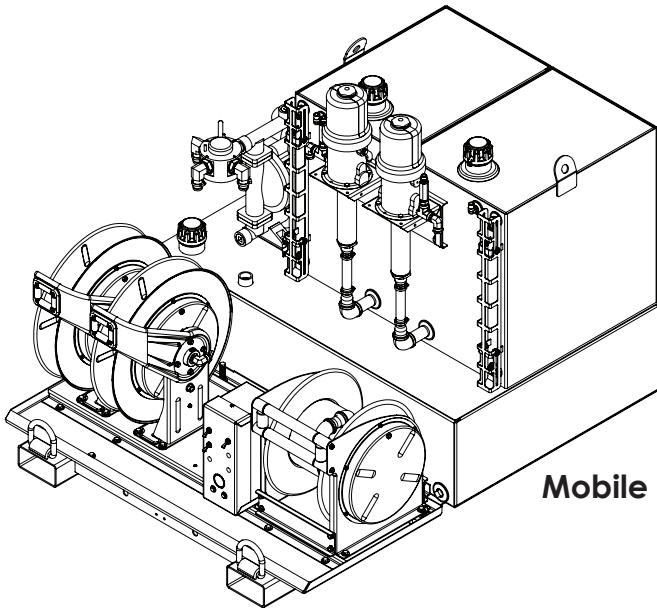
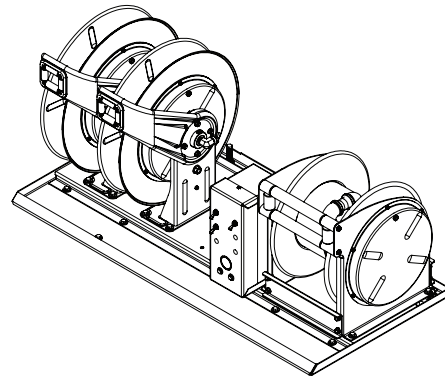

Mobile Mount

**Stellar Industries, Inc.**

**190 State Street**

**PO Box 169**

**Garner, IA 50438**

**800-321-3741**

**Fax: 641-923-2811**

**[www.stellarindustries.com](http://www.stellarindustries.com)**

Subject to Change without Notification.  
© 2022 Stellar Industries, Inc.

PN 121984

# Lube Skid Manual Revisions

Date of Revision	Section Revised	Description of Revision

## Serial Tag



# Table of Contents

Introduction .....	iv
<b>Chapter 1 - Operation .....</b>	<b>1</b>
General Operation .....	1
Operator Requirements.....	1
Decal Placement (V160 Perm Mt shown as example).....	2
Operating LubeMate® Lube System .....	3
<b>Chapter 2 - Installation .....</b>	<b>5</b>
Component Installation.....	5
General Installation.....	5
Torque Data Chart .....	6
Installation Instructions.....	7
<b>Chapter 3 - Lube System Maintenance .....</b>	<b>11</b>
General Maintenance Guidelines .....	11
<b>Chapter 4 - Assembly Drawings .....</b>	<b>13</b>
V160/Pumps/Reels/Cabinet - 110476 .....	13
Permanent Assembly V160 w/Separate Reels - 95644 .....	14
Cabinet Assembly 42R 2N/1W - 112861 .....	15
Mobile Assembly V160 - 96653.....	16
Tank Assembly V160 - 110729.....	17
Mobile Skid Assembly - 111172 .....	18
Drip Pan Assembly - 103306 .....	19
Sightglass Cage Assembly - 108419 .....	20
Fresh Oil Tank Breather Cap Assembly - 107499 .....	21
Salvage Oil Tank Dipstick Cap Assembly - 110847 .....	22
Fresh Oil Pump Mount Assembly - 110883 .....	23
Fresh Oil Pump Assembly (5:1) - 95767 .....	24
Salvage Oil Pump Assembly - 102564.....	25
Salvage Oil Reel Assembly - 95734.....	26
Fresh Oil Reel Assembly - 95738 .....	27
Mounting Kit (4 Spring) - 110794 .....	28
Optional Mounting Angle Kit - 110795 .....	29
Drain Pan Assembly (7.5 Gal) - 110888 .....	30
Control Panel - 95934.....	31
<b>Chapter 5 - Replacement Parts .....</b>	<b>33</b>

**For Technical Questions, Information, Parts, or Warranty, Call Toll-Free at**

**800-321-3741**

Hours: Monday - Friday, 8:00 a.m. - 5:00 p.m. CST

Or email at the following addresses:

**Technical Questions, and Information**

[service@stellarindustries.com](mailto:service@stellarindustries.com)

**Order Parts**

[parts@stellarindustries.com](mailto:parts@stellarindustries.com)

**Warranty Information**

[warranty@stellarindustries.com](mailto:warranty@stellarindustries.com)

# Introduction

Stellar® LubeMate® lube systems are designed to provide safe and dependable service. With proper use and maintenance, this lube system will operate at peak performance for many years.

To promote this longevity, carefully study the information contained in this manual before putting the equipment into service. Though it is not intended to be a training manual for beginners, this manual should provide solid guidelines for the safe and proper usage of the lube system.

Once you feel comfortable with the material contained in this manual, strive to exercise your knowledge as you safely operate and maintain the lube system. This process is vital to the proper use of the unit.

## A few notes on this manual:

A copy of this manual is provided with every lube system. Place it box mounted on the inside of the curb side channel near the front of the trailer. A copy of this manual shall remain with the trailer at all times.

Throughout the manual, three signal words will be used to bring attention to important items:

### **NOTICE**

A NOTICE signal word indicates a practice not related to physical injury.

### **⚠ WARNING**

A WARNING signal word indicates a hazardous situation which, if not avoided, could result in death or serious injury.

### **⚠ DANGER**

A DANGER signal word indicates a hazardous situation which, if not avoided, will result in death or serious injury.

Information contained within this manual does not cover all maintenance, operating, or repair instructions pertinent to all possible situations. Please be aware that some sections of this manual contain information pertaining to Stellar® manufactured lube systems in general and may or may not apply to your specific model.

This manual is not binding. Stellar Industries, Inc. reserves the right to change, at any time, any or all of the items, components, and parts deemed necessary for product improvement or commercial/production purposes. This right is kept with no requirement or obligation for immediate mandatory updating of this manual.

## In closing:

If more information is required or technical assistance is needed, or if you feel that any part of this manual is unclear or incorrect, please contact the Stellar Customer Service Department by phone at 800-321-3741 or email at [service@stellarindustries.com](mailto:service@stellarindustries.com).

# Chapter 1 - Operation

Safety should be the number one thought on every operator's mind. Three factors should exist for safe operation: a qualified operator, well-maintained equipment, and the proper use of this equipment.

This chapter contains information regarding the safety and operation of the LubeMate® lube system and should be read and understood completely by everyone working with or near the system before putting the unit into operation.

**⚠ WARNING** Failure to follow operating, maintenance, or safety instructions can result in death or serious injury.

## General Operation

It is the responsibility of the owner to instruct the operator in the safe usage of the equipment, as well as providing them with properly maintained equipment.

**⚠ WARNING** LubeMate® lube system operators must conform to the qualifications specified in this manual. Trainees or untrained persons shall be under the direct supervision of qualified persons.

**⚠ WARNING** Do NOT use system pumps to pump any fluids other than products intended for use in the LubeMate® lube system. Never pump fuel or gasoline.

Operators shall consult with the owner of the equipment regarding current safety regulations and required personal protective equipment.

Operators should never operate the lube system while under the adverse influence of alcohol, drugs, or medication.

Please take note that Stellar Industries, Inc. is not liable for accidents incurred by the lube system because of non-fulfillment from the operator's side of current rules, laws, and regulations.

## Operator Requirements

**Operation is limited to the following people:**

1. Qualified individual.
2. Trainees under direct supervision of the qualified individual.
3. Test or maintenance individual.
4. Lube system Inspector.

**Qualified individuals must:**

1. Demonstrate the ability to understand all decals, the owner's manual, and any other information required for safe operation of the lube system.
2. Demonstrate the ability to safely control the lube system.
3. Know all pertinent safety regulations.
4. Be responsible for maintenance requirements.
5. Understand and be fully capable of implementing all emergency procedures.
6. Understand all operating procedures as outlined by this manual.

## Pre-Operation Inspection

Before operating the equipment, make sure all regular maintenance has been performed. Each day, inspect the lube skid or lube trailer for all of the following:

- All safety covers for proper installation.
- Equipment for missing, illegible, or defaced operating decals and safety signs (monthly).
- Structural weldments for bends, cracks, or breaks (monthly).
- Hoses, valves, and connections.
- Connections for leaks.
- Presence of this owner's manual.
- Replace/repair as necessary prior to operation.

## Decal Placement (V160 Perm Mt shown as example)

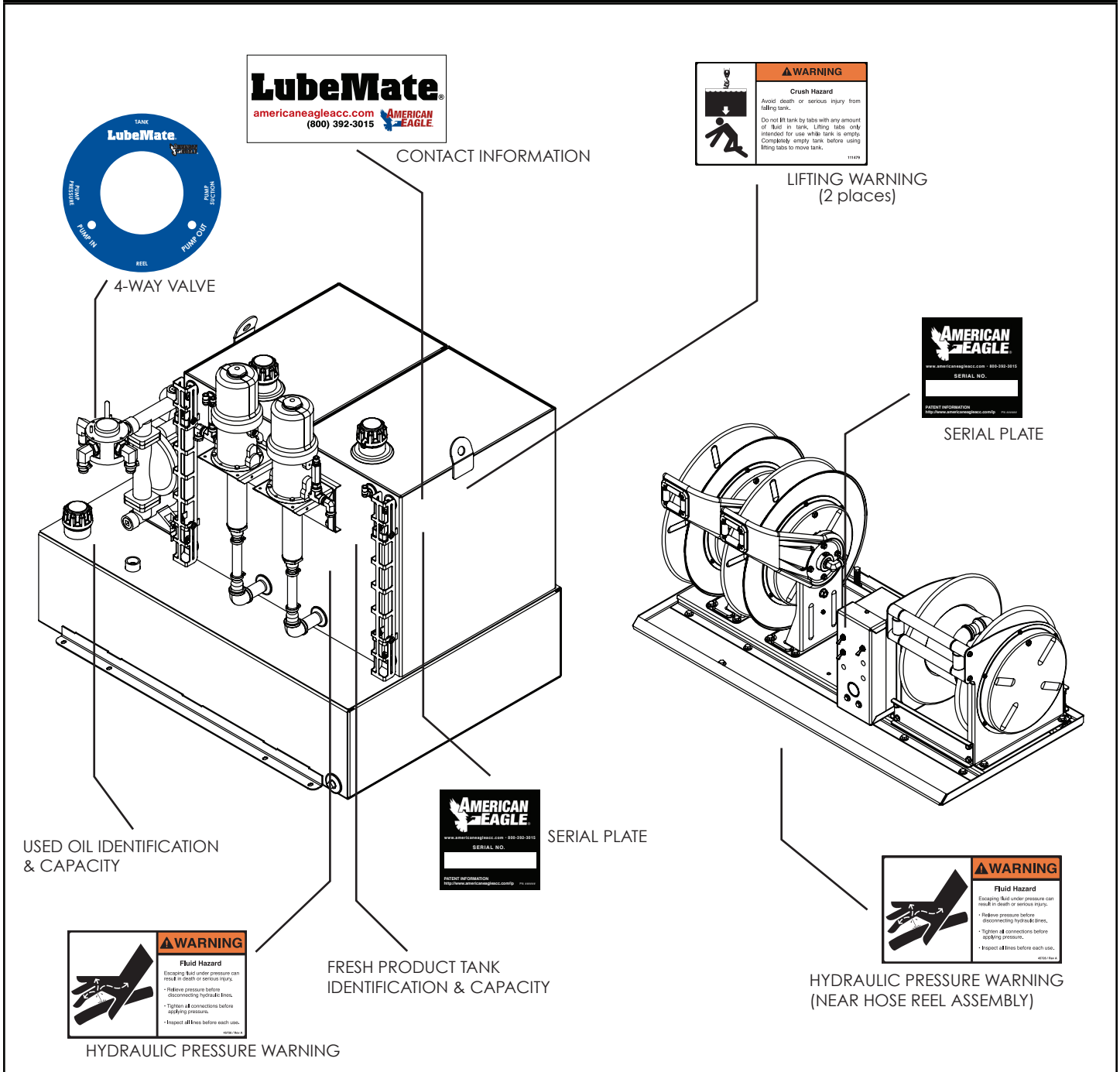

# Operating LubeMate® Lube System

## Suggested PPE While Operating Lube Transfer System

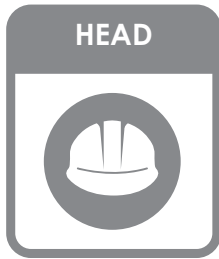

## New Product (Engine Oil, Antifreeze, Hydraulic Oil, Grease etc.) Tank Operation

1. Fill tanks with the proper fluid for lubricating or cooling. Refer to machine's service manual for proper fluid selection.
2. Unreel the hose of the product you want to dispense far enough to reach the fill location and place the nozzle tip in the fill neck or hole.
3. Activate air supply.

### NOTICE

Each new product tank is connected to a centrifugal pump that is powered by an air compressor. Completely read the operation manual from the air compressor manufacturer before operating the air system.

### ⚠ WARNING

Do NOT exceed 120 psi air pressure for fluid transfer.

4. To activate the pump of any given tank, flip the switch for the appropriate tank and reel.
5. Reset the nozzle flow meter.
6. Press the trigger to begin flow. Nozzle may need to be adjusted for desired flow.
7. Release the trigger when desired amount has been dispensed and turn off the pump with the switch for that tank.
8. Retract the hose onto the reel.
9. Deactivate air supply and relieve air pressure from system.

Regulate fluid pump air system to 120 psi max.

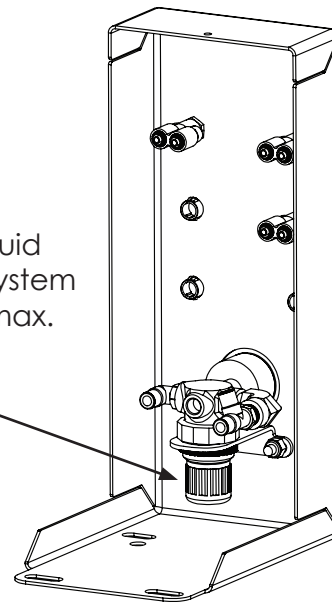

Product tank pump activation switches.

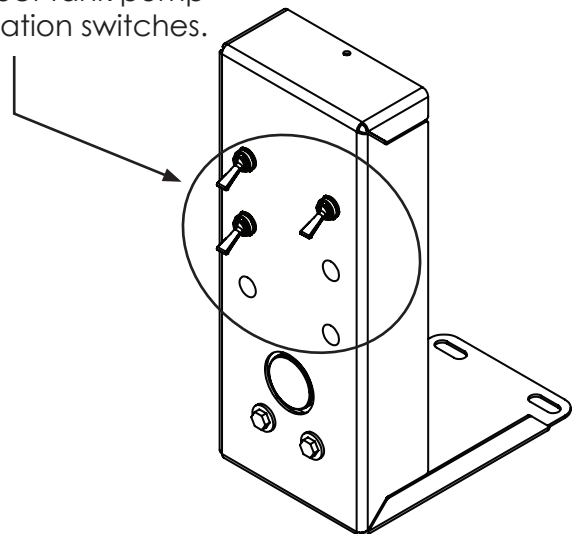

# Waste Oil System Operation

## Transferring Waste Oil From Machine to Waste Oil Tank

1. Unreel enough hose from the Waste Oil reel to reach the machine.
2. Connect the quick coupler to the drain pan under the unit. If your machine has the correct drain plug, you can connect the coupler directly to the drain plug.
3. Rotate the handle of the brass valve all the way to "PUMP IN" position.
4. Activate air supply.
5. Flip switch labeled "Waste Oil" to ON position.
6. Adjust pump speed with the brass air regulator on the inlet of the pump. Maintain an air pressure that maximizes pump speed without causing pump cavitation.

### IMPORTANT

The brass air regulator located on the air inlet is to control the pump speed only. Do not use this as the sole regulator for this pump. Air pressure must be regulated to 120 psi with the gauged regulator on the control panel.

7. When finished, turn off pump switch.
8. Disconnect hose and roll it back onto the hose reel.
9. Deactivate air supply and relieve air pressure from system.

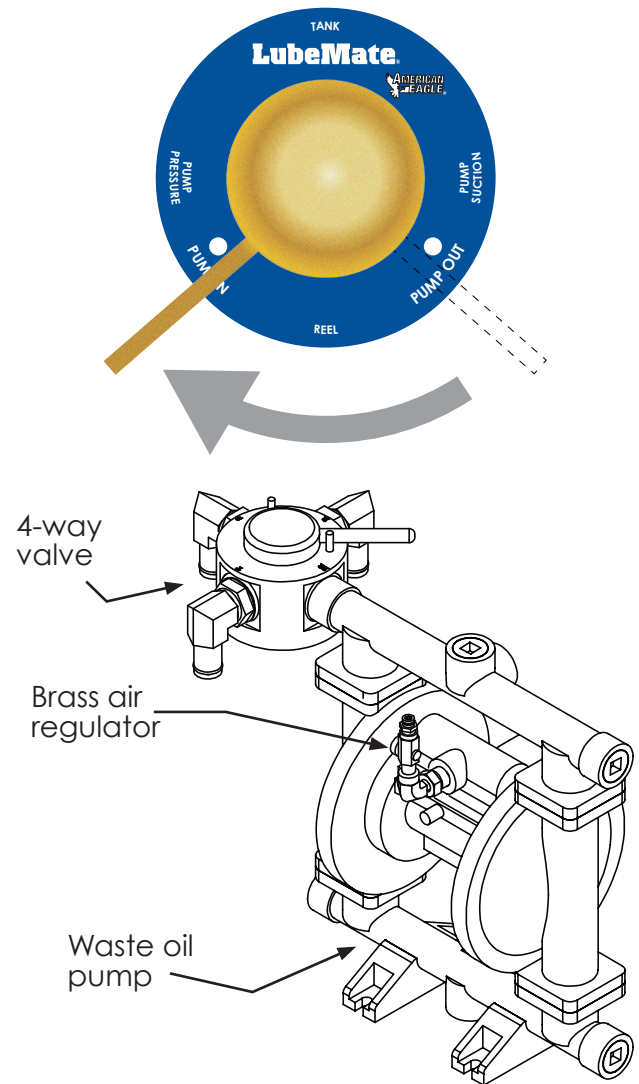

## Transferring Waste Oil From Waste Oil Tank to Disposal Container

1. Unreel enough hose from the Waste Oil reel to reach the disposal container.
2. Install the stub hose piece with the male quick coupler to the waste oil hose.
3. Activate air supply.
4. Secure the end of the waste oil hose before flipping switch labeled "Waste Oil" to ON position.
5. When finished, turn off pump switch.
6. Disconnect stub hose piece and roll hose back onto the hose reel.
7. Deactivate air supply and relieve air pressure from system.

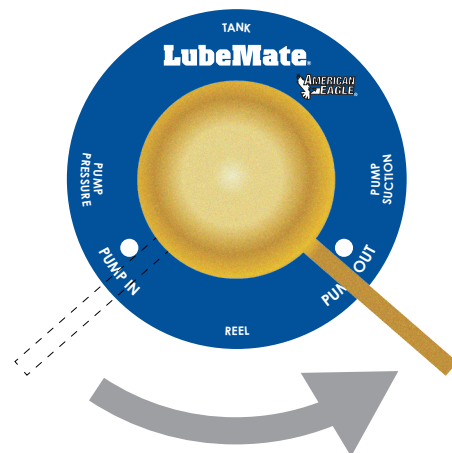



# Chapter 2 - Installation

## Component Installation

### General Installation

This chapter is designed to serve as a general guide for the installation of a LubeMate® lube system - permanent or mobile. Each installation is considered unique so certain portions of this chapter may or may not apply to your direct application. If a question should arise during the installation process, please contact Stellar Customer Service at (800) 321 3741.

It is the installer's responsibility to assure that the lube system is mounted on a platform that will support the maximum crane rating of this crane.

**⚠ WARNING** Do not install this lube system on a body not capable of supporting or safely handling the extra weight as braking and handling performance may be affected. Failure to do so may result in serious injury or death.

**⚠ WARNING** Do not lift lube system by tabs with any amount of fluid in tank. Lifting tabs only intended for use while tanks are empty. Completely empty tanks before using lifting tabs to move.

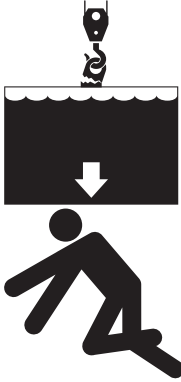
 A diagram illustrating a safety hazard. At the top, a crane hook is shown lifting a rectangular tank. Below the tank, a downward-pointing arrow indicates the direction of movement. At the bottom, a stick figure is shown falling backwards, representing a person who has been struck or crushed by the falling tank.	<p><b>⚠ WARNING</b></p> <p><b>Crush Hazard</b></p> <p>Avoid death or serious injury from falling tank.</p> <p>Do not lift tank by tabs with any amount of fluid in tank. Lifting tabs only intended for use while tank is empty. Completely empty tank before using lifting tabs to move tank.</p> <p>111479</p>
--	--

### Installer Notice

According to Federal Law (49 cfr part 571), each final-stage manufacturer shall complete the vehicle in such a manner that it conforms to the standards in effect on the date of manufacture of the incomplete vehicle, the date of final completion, or a date between those two dates. This requirement shall, however, be superseded by any conflicting provisions of a standard that applies by its terms to vehicles manufactured in two or more stages.

Therefore, the installer of a permanent LubeMate® skid is considered one of the manufacturers of the vehicle. As such a manufacturer, the installer is responsible for compliance with all applicable federal and state regulations. They are required to certify that the vehicle is in compliance with the Federal Motor Vehicle Safety Standards and other regulations issued under the National Traffic and Motor Vehicle Safety Act.

Please reference the Code of Federal Regulations, title 49 - Transportation, Volume 5 (400-999), for further information, or visit <http://www.gpoaccess.gov/nara/index.html> for the full text of Code of Federal Regulations.

# Torque Data Chart

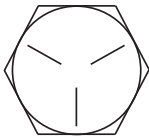
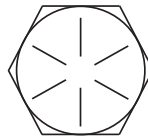
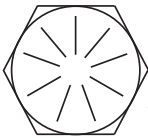
		GRADE 5		GRADE 8		GRADE 9
						
Size (DIA-TPI)	Bolt DIA (Inches)	Plain (Ft-Lb)	Plated (Ft-Lb)	Plain (Ft-Lb)	Plated (Ft-Lb)	Plated (Ft-Lb)
5/16-18	0.3125	17	13	25	18	22
3/8-16	0.3750	31	23	44	33	39
7/16-14	0.4375	49	37	70	52	63
1/2-13	0.5000	75	57	105	80	96
9/16-12	0.5625	110	82	155	115	139
5/8-11	0.6250	150	115	220	160	192
3/4-10	0.7500	265	200	375	280	340
7/8-9	0.8750	395	295	605	455	549
1-8	1.000	590	445	910	680	823
1 1/8-7	1.1250	795	595	1290	965	1167
1 1/4-7	1.2500	1120	840	1815	1360	1646
1 3/8-6	1.3750	1470	1100	2380	1780	2158
1 1/2-6	1.500	1950	1460	3160	2370	2865

When using the torque data in the chart, the following rules should be observed:

- Bolt manufacturer's particular specifications should be consulted when provided.
- Flat washers of equal strength must be used.
- All torque measurements are given in foot-pounds. To convert to inch-pounds, multiply by 12.
- Torque values specified are for bolts with residual oils or no special lubricants applied. If special lubricants of high stress ability, such as Never-Seez compound graphite and oil, molybdenum disulphite, colloidal copper or white lead are applied, multiply the torque values in the charts by the factor .90. The use of Loctite does not affect the torque values listed above.
- Torque values for socket-head capscrews are the same as for Grade 8 capscrews.

# Installation Instructions

## Installing Mobile Lube Skid

	<b>⚠ WARNING</b>
	<b>Crush Hazard</b> Avoid death or serious injury from falling tank.  Do not lift tank by tabs with any amount of fluid in tank. Lifting tabs only intended for use while tank is empty. Completely empty tank before using lifting tabs to move tank.

111479

Make sure system is completely empty before lifting with tank tabs.

Attach air supply to air regulator on control panel.

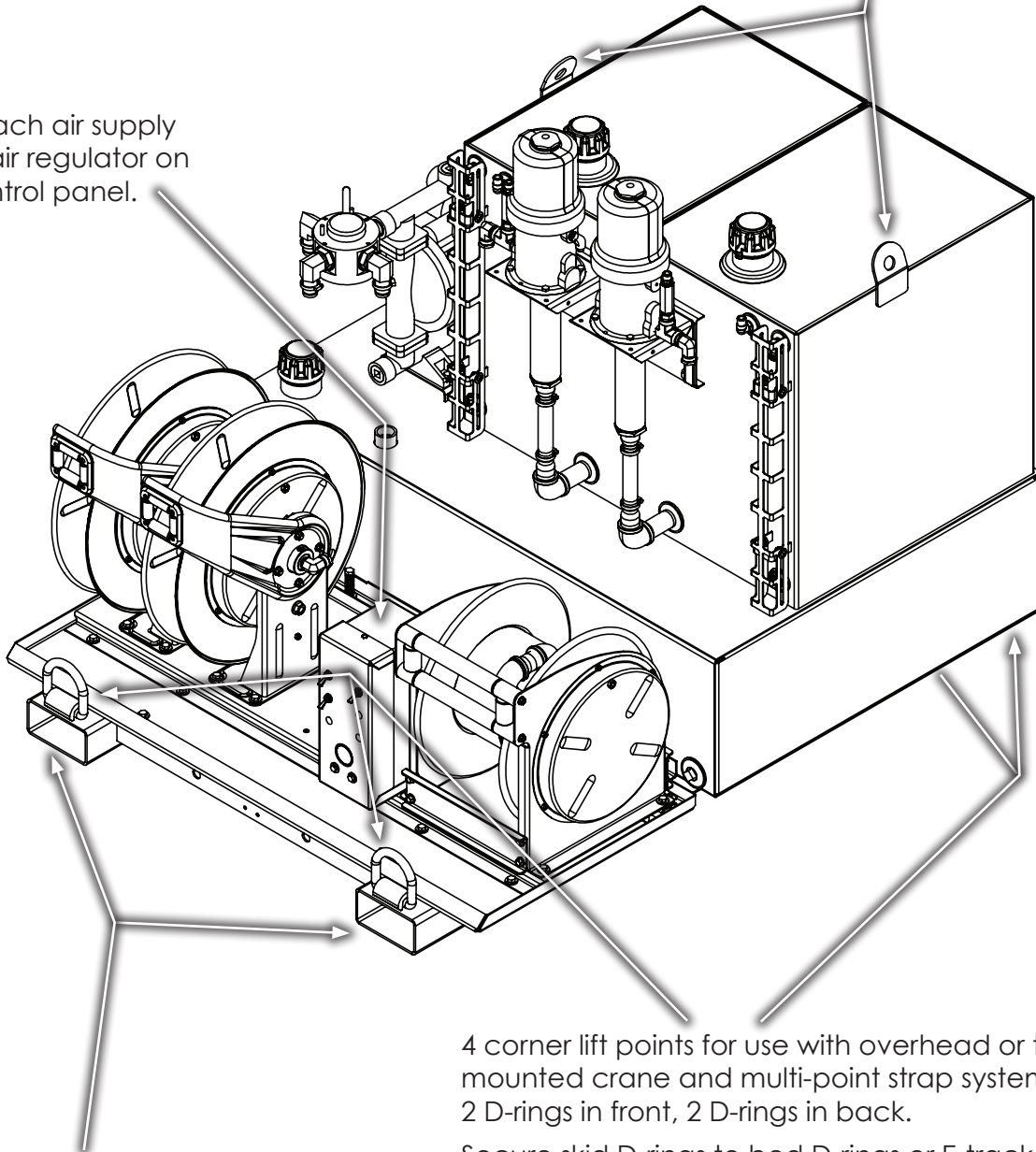

4 corner lift points for use with overhead or truck-mounted crane and multi-point strap system:  
2 D-rings in front, 2 D-rings in back.

Secure skid D-rings to bed D-rings or E-track.

Fork channels for use with fork truck to lift into bed.

## Installing Permanent Lube Assembly

To accommodate all the various options and mounting possibilities of all the additional components, it is recommended you refer to your local Stellar Distributor for installation assistance with your permanent lube system.

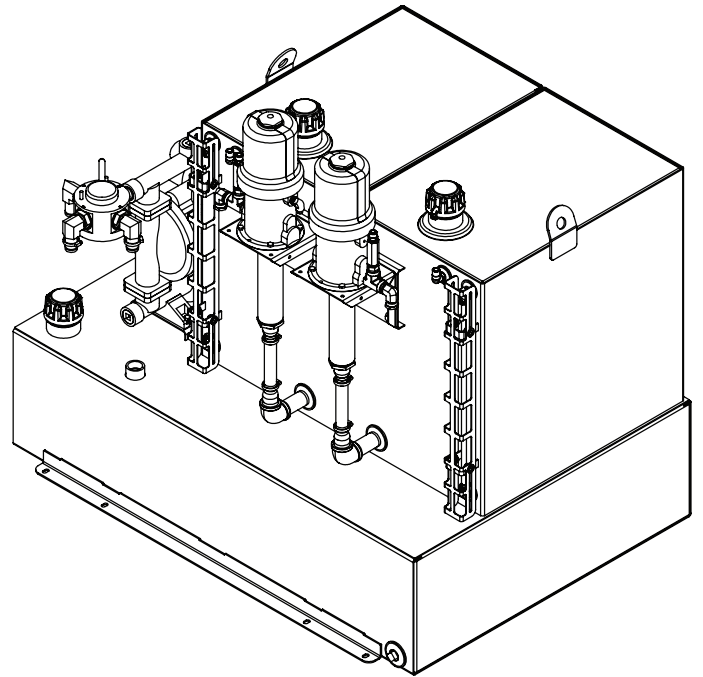

## Installing Hose Reel Cabinet

To accommodate all the various mounting locations of your hose reel cabinet and all of the additional components, it is recommended you refer to your local Stellar Distributor for installation assistance with your lube system reel cabinet.

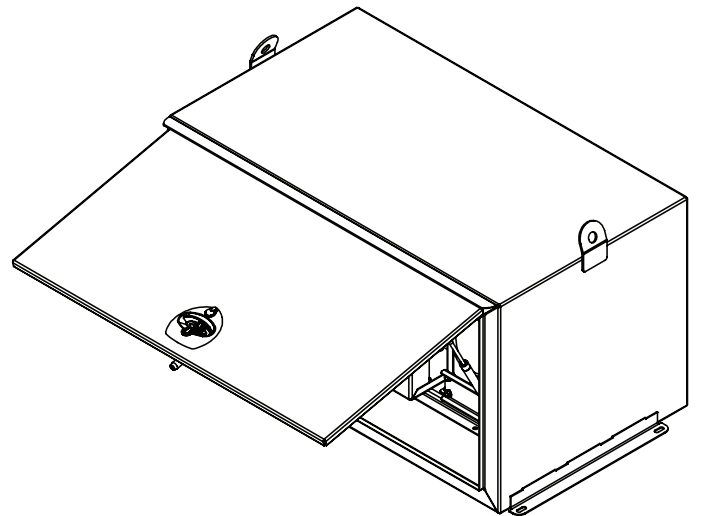

## Installing Hose Reel Drip Pan

To accommodate all the various mounting locations of your hose reel drip pan assembly and all of the additional components, it is recommended you refer to your local Stellar Distributor for installation assistance with your lube system drip pan assembly.

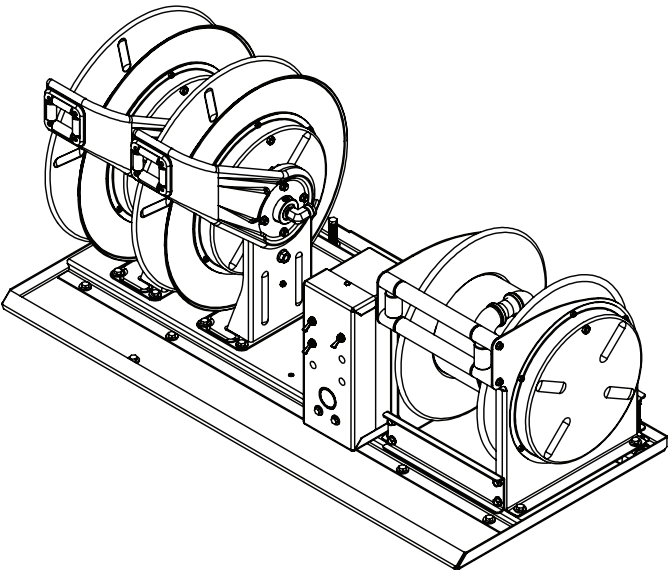

## Installing Loose Reels, Waste Pump, and Control Panel

To accommodate all the various combinations of reels and other loose equipment, as well as numerous mounting locations, it is recommended you refer to your local Stellar Distributor for installation assistance with your lube system dispensing/recovery equipment.

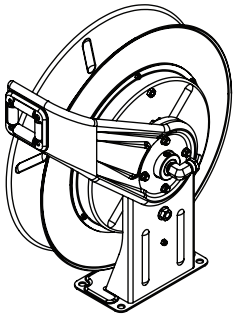

hose reel

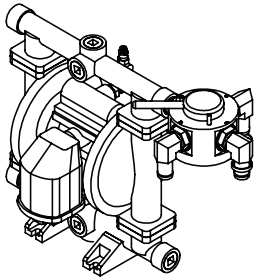

waste pump

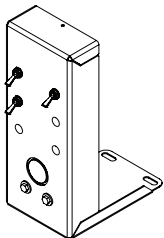

control panel

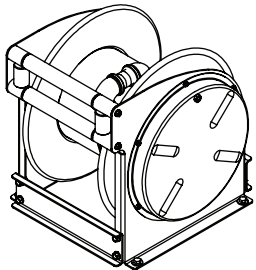

waste hose reel

**This page intentionally left blank.**

# Chapter 3 - Lube System Maintenance

## Cold Weather Use

If your LubeMate® lube system will be exposed to frequent cold weather use, consider contacting Stellar customer support at **800-321-3741** and order an optional tank heater kit (P/N 95751) for your lube system tank.

Maintenance is an important part of extending the life of any LubeMate® lube system. Performing key maintenance items on a scheduled program will prevent unnecessary downtime.

## General Maintenance Guidelines

Before performing any maintenance to the lube system, consider the following:

- ⚠ WARNING** Only qualified service personnel are to perform maintenance on the lube system. Never modify or alter any of the equipment, whether mechanical, electrical, or hydraulic, without explicit approval from Stellar® Industries.
- Disconnect system from air supply and relieve pressure from unit before performing any service or repair.
- Place all controls in the off position and secure operating features from inadvertent motion. Follow all company directed lockout/tagout procedures.
- Before performing any maintenance on electrical components, disconnect the power source.
- Allow systems to cool before performing any maintenance.
- Replace parts with Stellar approved parts only.
- Keep the lube system tank area clean and free from grease build-up, oil and dirt.
- Label or tag parts when disassembling.
- After relieving air pressure from lube system, repair or have repaired any components found to be inadequate.

## Lube System Inspection and Maintenance Schedule

Maintenance Item	Action	Note	Interval
Lift pts on mobile skid	Inspect	If cracked or damaged, repair as necessary	Monthly
Structural weldments	Inspect	Check for bends, cracks, or breaks	Monthly
Decals	Inspect	Inspect all decals attached to the trailer to ensure they are all still legible. Replace as needed.	Monthly
Dirt & Debris	Wash	Wash the lube system to prevent damage from any type of corrosive substances collected from roads or job sites or inadvertently leaked product.	Weekly
Hydraulic & pneumatic connections	Inspect	Check for leaks and tighten or repair as necessary	Daily
Hoses	Inspect	Check for wear. Replace as necessary.	Daily
Mounting Hardware	Torque	Inspect all hardware and torque to proper specification	Quarterly

**NOTE:** Perform maintenance procedures on air compressor, product pumps, and hose reels according to each manufacturer's instructions supplied with this lube skid.

**This page intentionally left blank.**



# Chapter 4 - Assembly Drawings

## V160/Pumps/Reels/Cabinet - 110476

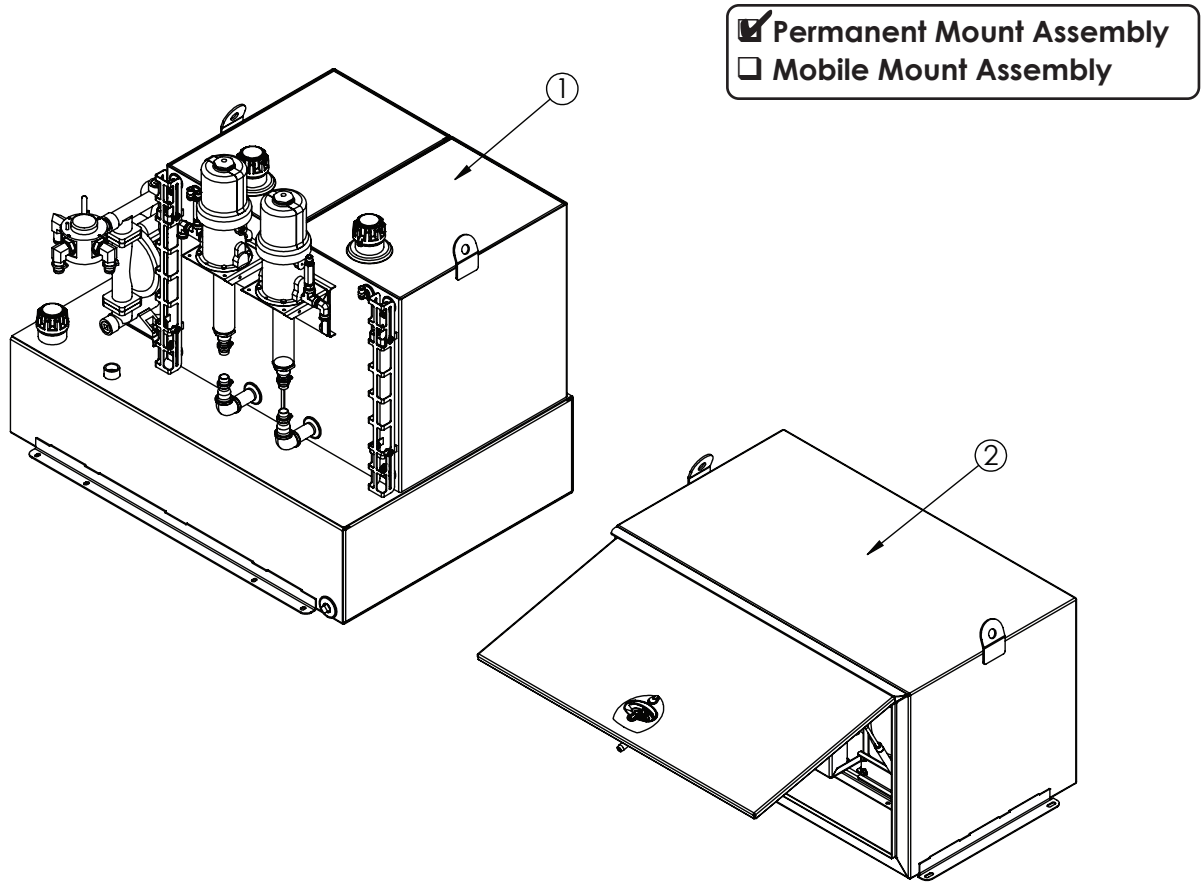

### PN 110476

ITEM	PART No.	DESCRIPTION	QTY.
01	110729	TANK ASM V160 5:1	1
01	112861	CABINET ASM 42R 2N/1W	1

ITEMS NOT SHOWN		
PART No.	DESCRIPTION	QTY.
110881	MAT 0.19 TIREPLAST 4X50 ROLL (RM)	13
95746	METER MECH QT FLX GRACO	2
110798	HOSE 1.00(300PSI)-16MP-180CL	1
C4659	HOSE CLAMP #16 SS	1
110797	HOSE 0.50(3000PSI)-8MP-8MP-180CL	2
110794	MTG KIT LUBE SKID 4 SPRING	1
110795	MTG ANGLE KIT LUBE SKID	1
110888	DRAIN PAN ASM 7.50 GAL 1.00	1
97297	STUB WASTE OIL 1.00 W/QUICK CPLR	1
C6244	TUBING NYLON AIR BRAKE 0.25	65
76975	FTG 4-4 MP-PTC STRAIGHT BRASS	1
103502	FTG 16-16 MP-FP STREET ELBOW 90 GALV	1
52529	FTG 8-8 MP-FPS 90	2

# Permanent Assembly V160 w/Separate Reels - 95644

- Permanent Mount Assembly  
 Mobile Mount Assembly

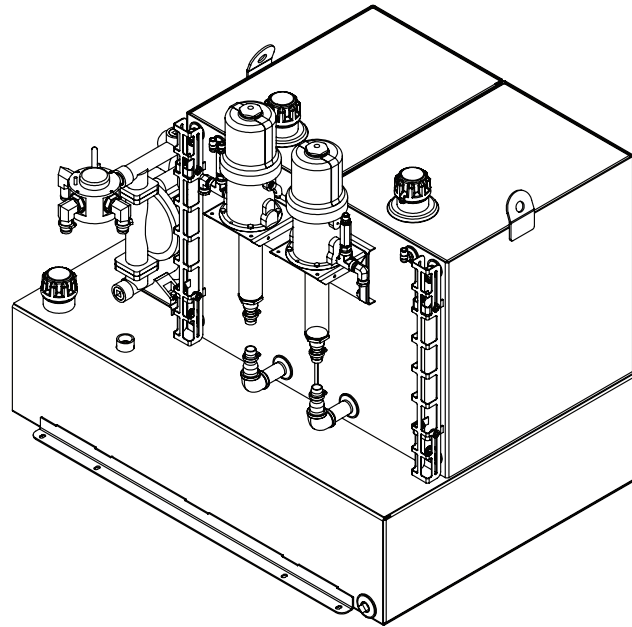

## PN 96544

ITEM	PART No.	DESCRIPTION	QTY.
01	110729	TANK ASM V160 5:1	1

ITEMS NOT SHOWN		
PART No.	DESCRIPTION	QTY.
110881	MAT 0.19 TIREPLAST 4X50 ROLL (RM)	12
95734	HOSE REEL ASM 1 X 25 SALV REELCRAFT	1
95738	HOSE REEL ASM 1/2 X 50 OIL REELCRAFT	2
95746	METER MECH QT FLX GRACO	2
110798	HOSE 1.00(300PSI)-16MP-180CL	1
C4659	HOSE CLAMP #16 SS	1
110797	HOSE 0.50(3000PSI)-8MP-8MP-180CL	2
110794	MTG KIT LUBE SKID 4 SPRING	1
110795	MTG ANGLE KIT LUBE SKID	1
110888	DRAIN PAN ASM 7.50 GAL 1.00	1
97297	STUB WASTE OIL 1.00 W/QUICK CPLR	1
95934	CONTROL PANEL PNEUMATIC 3 TOGGLE	1
102186	CONTROL PANEL 7 SWITCH BACK PANEL 18GA	1
107495	SCREW HEX HEAD 0.25X1.00 SELF TAPPING #3 DRILL TIP	1
C6244	TUBING NYLON AIR BRAKE 0.25	65
76975	FTG 4-4 MP-PTC STRAIGHT BRASS	1

# Cabinet Assembly 42R 2N/1W - 112861

- Permanent Mount Assembly
- Mobile Mount Assembly

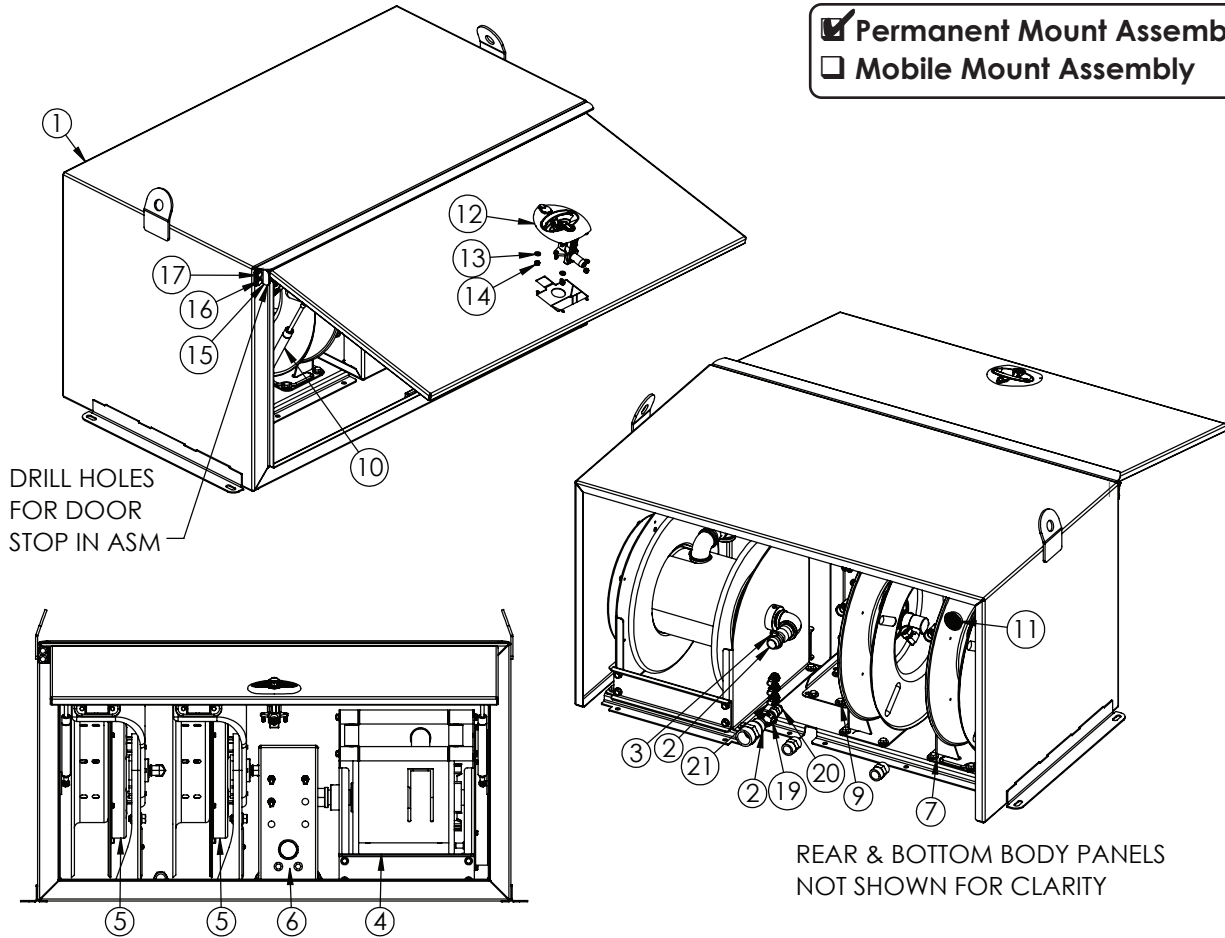

## PN 112861

ITEM	PART No.	DESCRIPTION	QTY.
01	100275	REELCAB WLDMT 42.00x23.00x24.00 2R-1R	1
02	103499	FTG 16-16 MP-HB INSERT ADAPTER	2
03	C4659	HOSE CLAMP #16 SS	2
04	95734	HOSE REEL ASM 1 X 25FT SALV REELCRAFT	1
05	95738	HOSE REEL ASM 1/2 X 50 OIL REELCRAFT BLK	2
06	95934	CONTROL PANEL PNEUMATIC 3 TOGGLE	1
07	111174	HARDWARE KIT REEL MNT	2
08	111174	HARDWARE KIT REEL MNT	1
09	111173	HARDWARE KIT CONTROL PANEL MNT	1
10	107123	6557 UP 64# STRUT	2
11	107122	1.50" ALUM. LOUVER VENT	1
12	102594	LATCH VECTOR 3PT	1
13	D0178	WASHER #10 SAE FLAT	4
14	26034	NUT #10-24 HH NYLOC	4
15	109283	ANGLE 1.50x1.00x1.00 CUSTOM 10GA	1
16	0480	CAP SCR 0.25-20X1.00 HHGR5	2
17	0340	WASHER 0.25 USS FLAT	4
18	0333	NUT 0.25-20 HHGR5 NYLOC	2
19	95704	FTG 4-6 PTC-MP 90	1
20	102048	FTG 4-6 PTC-MP STRAIGHT	1
21	102136	FTG 4-4 PTC-PTC BULKHEAD UNION	3

ITEMS NOT SHOWN		
PART No.	DESCRIPTION	QTY.
123598	WEATHERSTRIP CLIP ON 0.05-0.13X1.38 75001820	12.17
123596	HOSE 0.50(3000PSI)-8MP-8MP-14CL	2
D1449	HOSE SUCT 1.00(RM) 100R4 BRD	0.75
C6244	TUBING NYLON AIR BRAKE 0.25	4

# Mobile Assembly V160 - 96653

- Permanent Mount Assembly  
 Mobile Mount Assembly

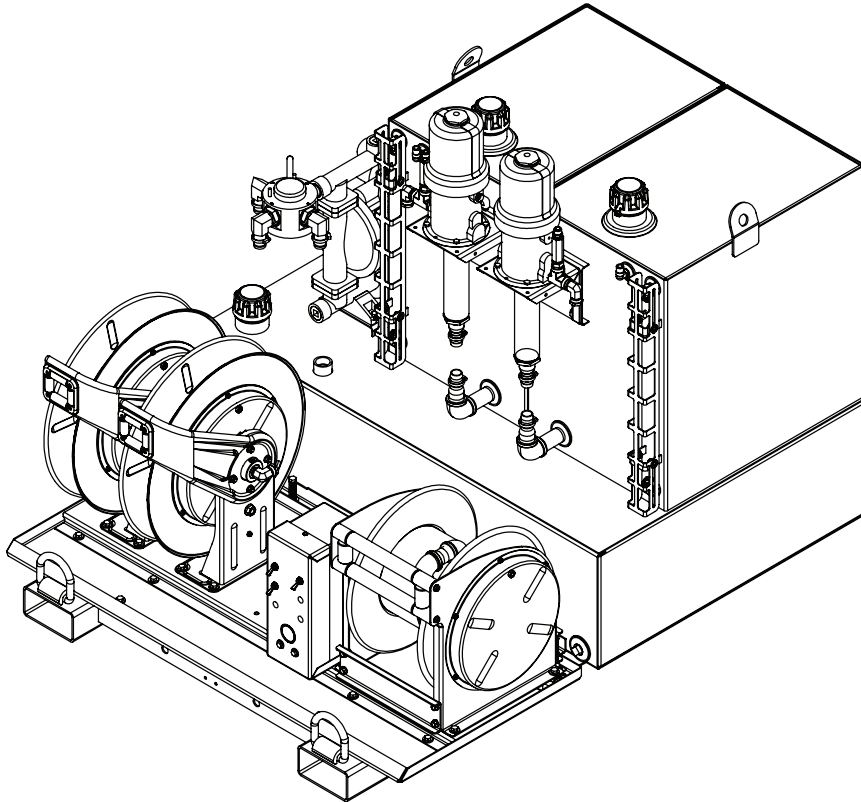

## PN 96653

ITEM	PART No.	DESCRIPTION	QTY.
01	111172	SKID ASM V160M 5:1	1

ITEMS NOT SHOWN		
PART No.	DESCRIPTION	QTY.
95746	METER MECH QT FLX GRACO	2
110888	DRAIN PAN ASM 7.50 GAL 1.00	1
97297	STUB WASTE OIL 1.00 W/QUICK CPLR	1
C6244	TUBING NYLON AIR BRAKE 0.25	15
76975	FTG 4-4 MP-PTC STRAIGHT BRASS	1
17215	TIEDOWN RATCHET STRAP 3000LB WLL	2

# Tank Assembly V160 - 110729

- Permanent Mount Assembly
- Mobile Mount Assembly

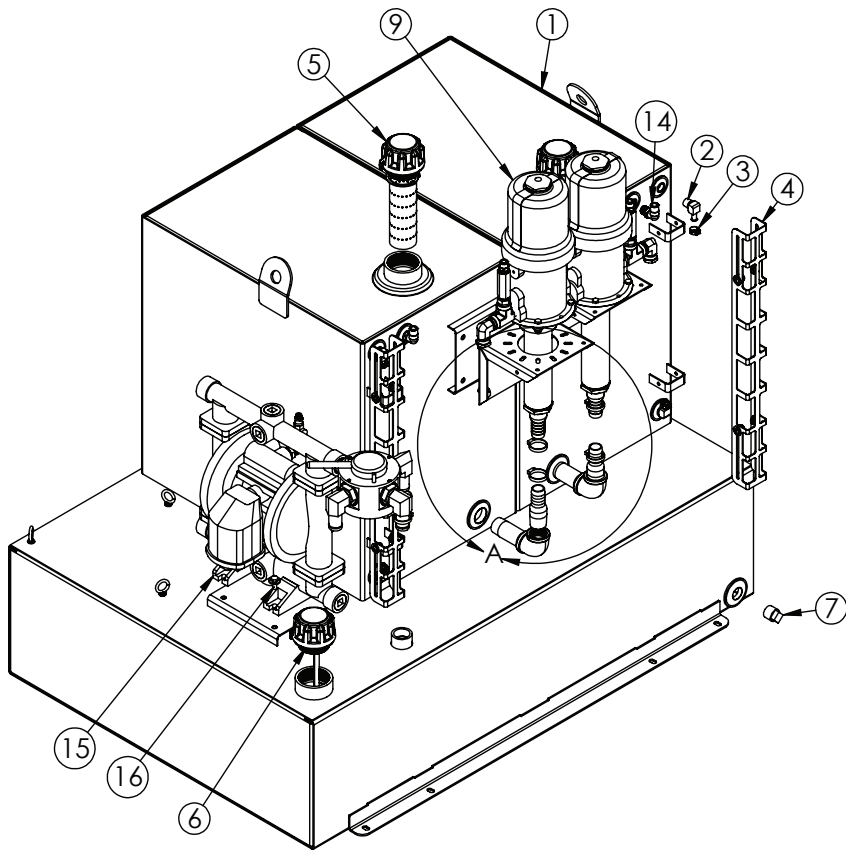

DETAIL A

## PN 110729

ITEM	PART No.	DESCRIPTION	QTY.
01	100351	TANK WLDMT V160 STD	1
02	102005	FTG 6-6 HB-MP 90 BRASS	4
03	110879	CLAMP 0.38 PEX CRIMP	4
04	108419	CAGE ASM SIGHTGLASS 24.00	2
05	107499	CAP ASM 1PSI SAE32 W/ 6.00 CAGE	2
06	110847	CAP ASM 12.00 DIPSTICK	1
07	C2126	MAGNETIC PLUG DRAIN 3/4"	1
08	110883	MNT ASM GRACO NEW OIL	2
09	95767	PUMP ASM GRACO FIRE-BALL 300 5:1	2
10	110730	FTG 16-16X3.50 MP-MP NIPPLE STRAIGHT SCH40 GALV	2
11	97866	FTG 16-16 FP-FP 90 GALV	2
12	103499	FTG 16-16 MP-HB INSERT ADAPTER	2
13	C4659	HOSE CLAMP #16 SS	5
14	97863	FTG 6-6 PTC-MP 90 SWIVEL ZINC	2
15	102564	PUMP ASM GRACO 1050 CONFIG 1	1
16	110799	HARDWARE KIT WST PUMP MNT	1

ITEMS NOT SHOWN		
PART No.	DESCRIPTION	QTY.
110876	HOSE 1.00(300PST)-16MP-12CL	1
C6348	TUBING NYLON 0.38ID X 0.56OD CLEAR	3.17
60200	TUBING NYLON AIR BRAKE 0.38	2
D1449	HOSE SUCT 1.00(RM) 100R4 BRD	1.5
112788	DECAL LUBMATE 2.80X6.40	1
112787	DECAL SERIAL NUMBER AMERICAN EAGLE 2.00X2.00	1
111479	DECAL TANK DO NOT LIFT FULL	2

# Mobile Skid Assembly - 111172

- Permanent Mount Assembly  
 Mobile Mount Assembly

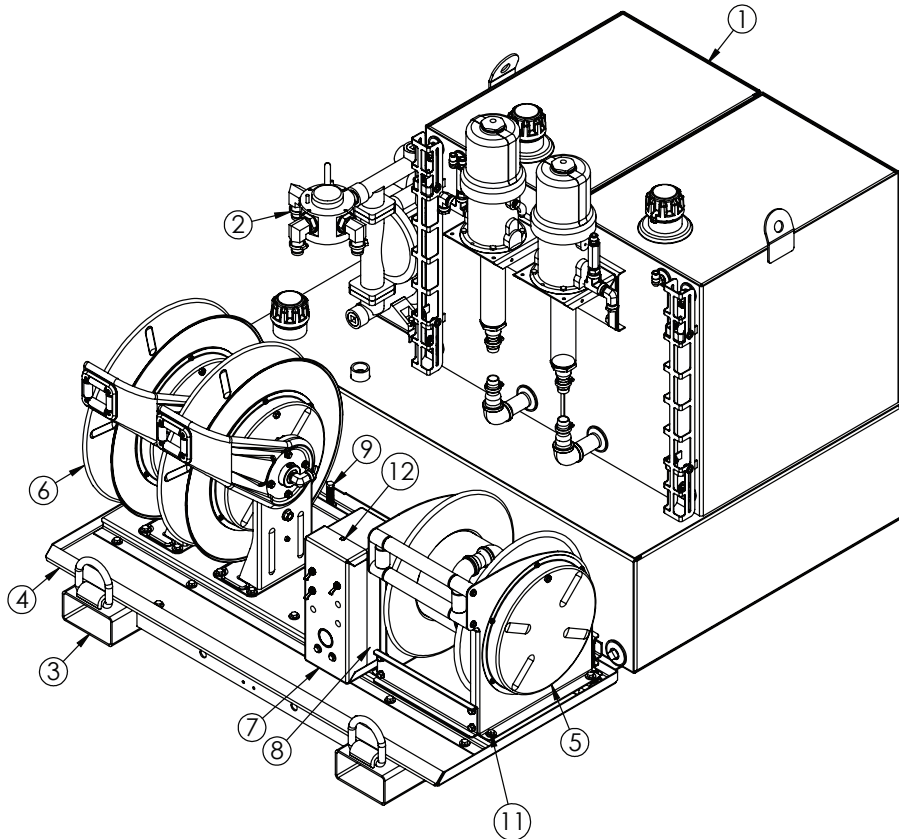

## PN 111172

ITEM	PART No.	DESCRIPTION	QTY.
01	110729	TANK ASM V160 5:1	1
02	C4659	HOSE CLAMP #16 SS	1
03	104919	MOBILE MOUNT SKID+DRIP 39.00x63.00	1
04	103306	DRIP PAN ASM M SERIES REELCRAFT	1
05	95734	HOSE REEL ASM 1 X 25FT SALV REELCRAFT	1
06	95738	HOSE REEL ASM 1/2 X 50 OIL REELCRAFT BLK	2
07	95934	CONTROL PANEL PNEUMATIC 3 TOGGLE	1
08	102186	CONTROL PANEL 6 SWITCH BACK PANEL 18GA	1
09	110794	MTG KIT LUBE SKID 4 SPRING	1
10	111173	HARDWARE KIT CONTROL PANEL MNT	1
11	111174	HARDWARE KIT REEL MNT	4
12	107495	SCREW HEX HEAD 0.25X1.00 SELF TAPPING #3 DRILL TIP	1

ITEMS NOT SHOWN		
PART No.	DESCRIPTION	QTY.
110881	MAT 0.19 TIREPLAST 4X50 ROLL (RM)	4.13
116047	HOSE 0.50(3000PSI)-8MP-8MP-31.50CL	1
116048	HOSE 0.50(3000PSI)-8MP-8MP-45CL	1
116049	HOSE 1.00(300PSI)-16MP-43CL	1
C6244	TUBING NYLON AIR BRAKE 0.25	20

# Drip Pan Assembly - 103306

- Permanent Mount Assembly
- Mobile Mount Assembly

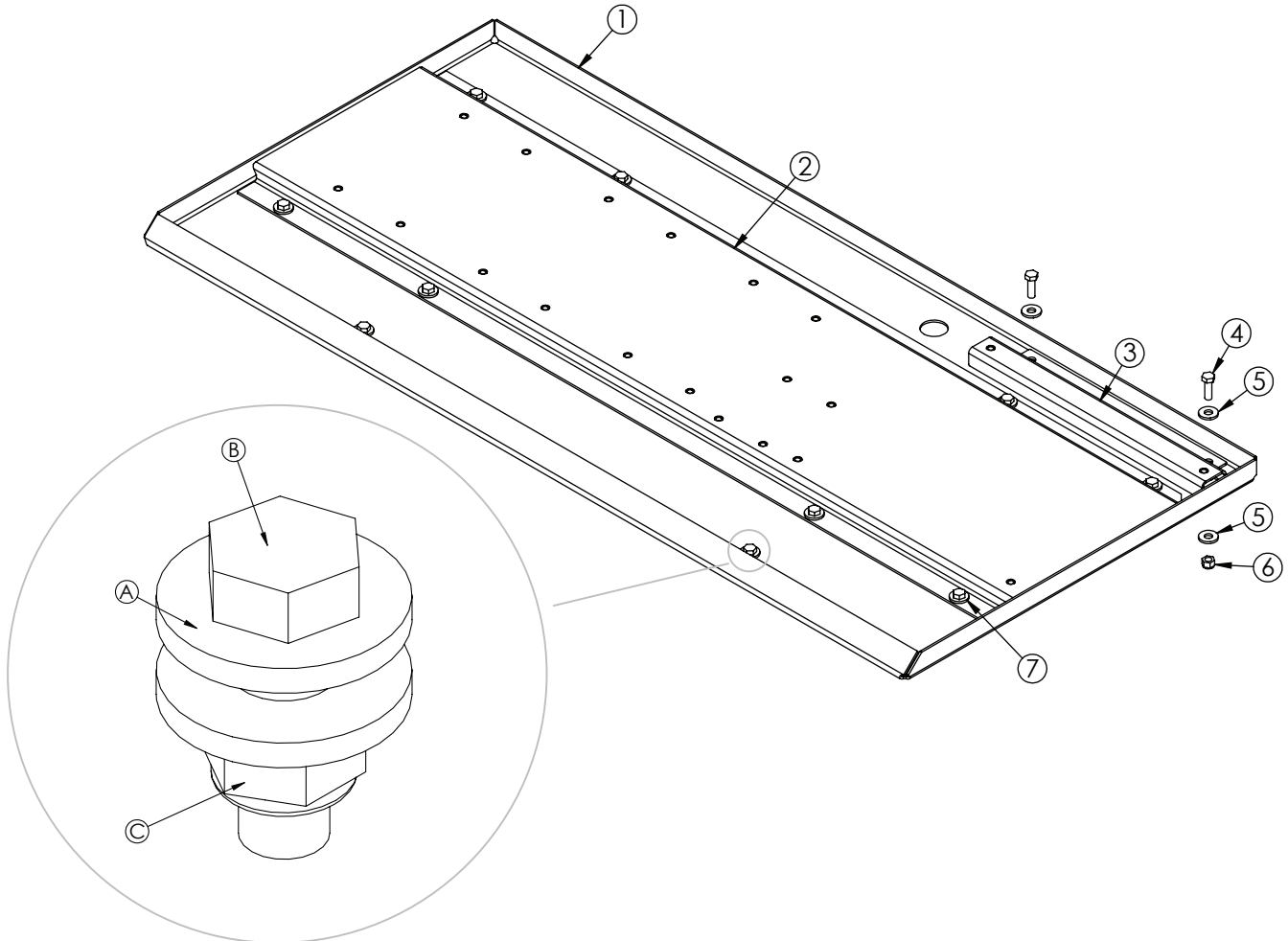

## Drip Pan Hardware Kit - 112405

ITEM	PART No.	DESCRIPTION	QTY.
A	0343	WASHER 0.31 USS FLAT	20
B	C0922	CAP SCR 0.31-18X1.00 HHGR5	10
C	0342	NUT 0.31-18 HHGR5 NYLOC	10

## PN 103306

ITEM	PART No.	DESCRIPTION	QTY.
01	102340	DRIP PAN STD 47.50X22.00 12GA	1
02	102757	REEL MOUNT U1 WLDMT REELCRAFT ONLY	1
03	110826	REEL MOUNT- RC 125-HALF HAT WLDMT PC WHITE	1
04	C0922	CAP SCR 0.31-18X1.00 HHGR5	2
05	0343	WASHER 0.31 USS FLAT	4
06	0342	NUT 0.31-18 HHGR5 NYLOC	2
07	112405	DRIP PAN M SERIES HARDWARE KIT	1

# Sightglass Cage Assembly - 108419

- Permanent Mount Assembly
- Mobile Mount Assembly

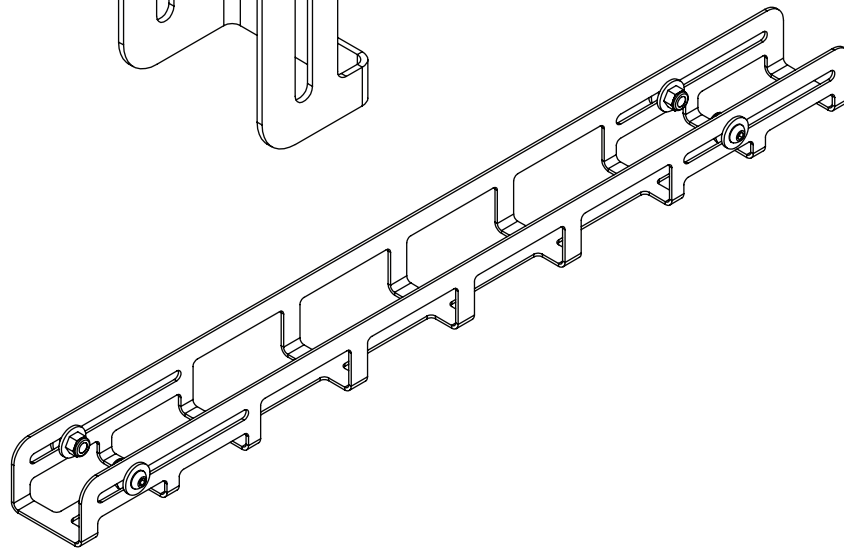
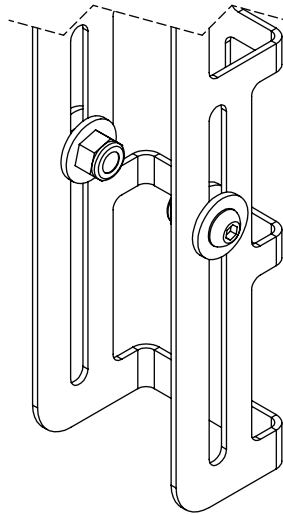
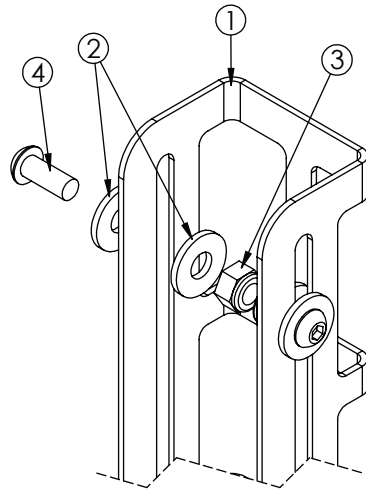

## PN 108419

ITEM	PART No.	DESCRIPTION	QTY.
01	101628	SIGHTGLASS CAGE 24 14 GA SS	1
02	D0917	WASHER 0.25 FLAT SS	8
03	30659	NUT 0.25-20 HH NYLOC SS	4
04	110014	CAP SCR 0.25-20X0.63 BTNHD SS	4



# Fresh Oil Tank Breather Cap Assembly - 107499

- Permanent Mount Assembly
- Mobile Mount Assembly

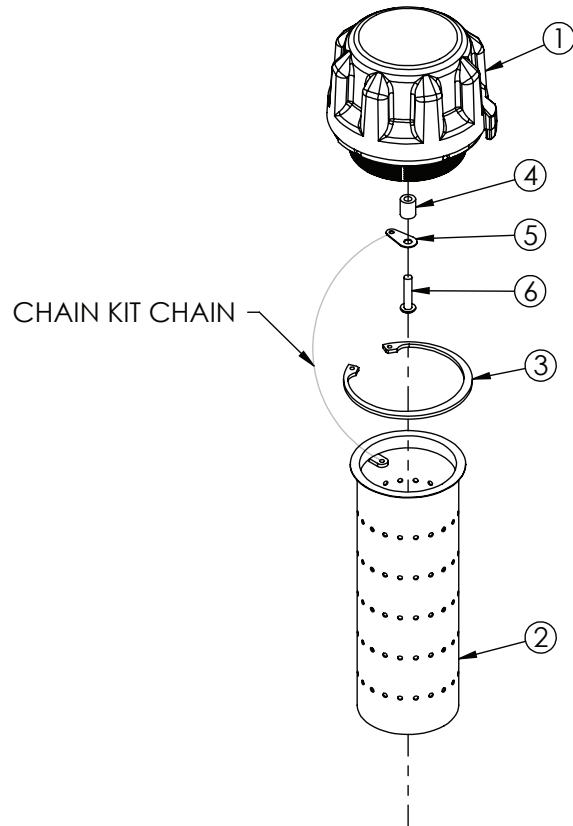

## PN 107499

ITEM	PART No.	DESCRIPTION	QTY.
01	73278	CAP 1PSI ZINGA THREADED	1
02	102625	BASKET WITH TETHER TAB ZINGA	1
03	107963	SNAP RING INTERNAL 2.38 OD	1
04	102664-1	CHAIN KIT NYLON SPACER	1
05	102664-2	CHAIN KIT TAB	1
06	102664-3	SCREW #8-32X0.75 PHMS (CHAIN KIT)	1

# Salvage Oil Tank Dipstick Cap Assembly - 110847

- Permanent Mount Assembly
- Mobile Mount Assembly

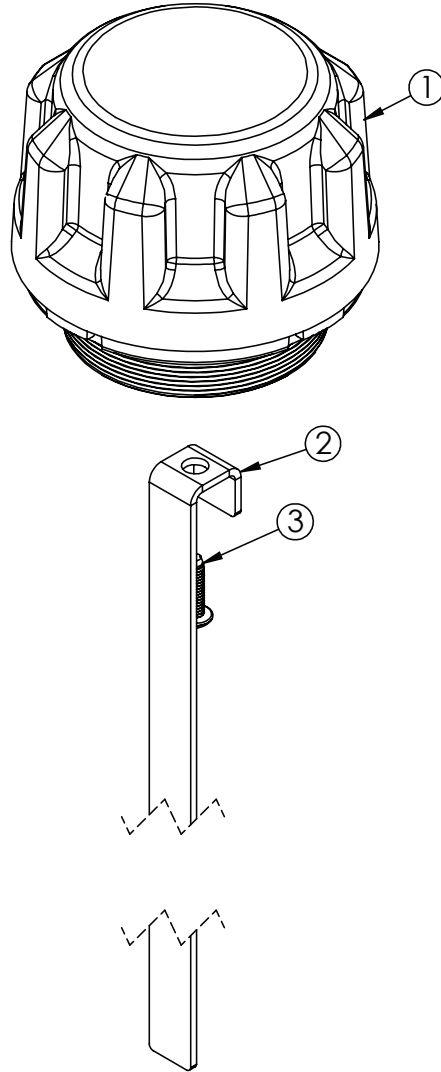

## PN 110847

ITEM	PART No.	DESCRIPTION	QTY.
01	81018	CAP FILL NO RELIEF ZINGA THREADED	1
02	110817	DIPSTICK 12.00 14GA	1
03	110884	SCREW #8-32X0.63 PHTCS	1

# Fresh Oil Pump Mount Assembly - 110883

- Permanent Mount Assembly
- Mobile Mount Assembly

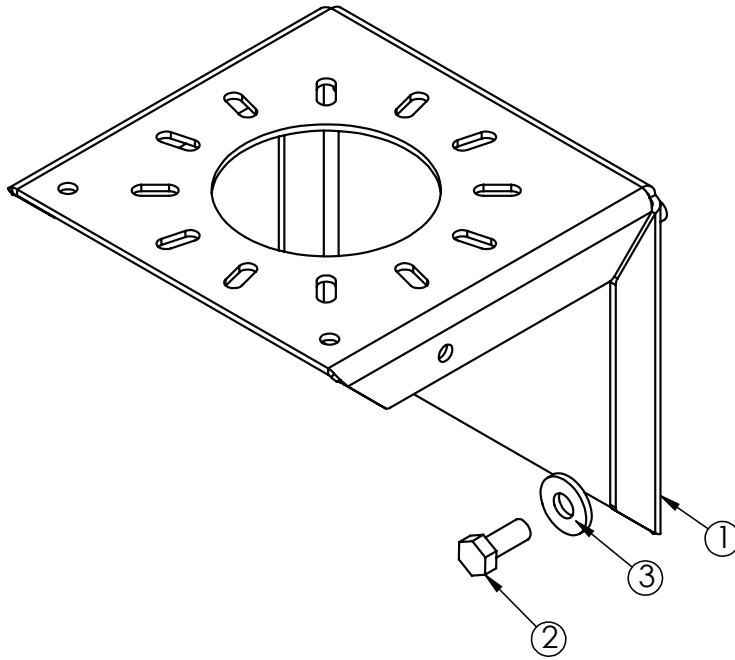

## PN 110883

ITEM	PART No.	DESCRIPTION	QTY.
01	101809	BRACKET GRACO NO 3-5 CS 12 GA	1
02	0420	CAP SCR 0.31-18X0.75 HHGR5	4
03	0343	WASHER 0.31 USS FLAT	4

# Fresh Oil Pump Assembly (5:1) - 95767

- Permanent Mount Assembly
- Mobile Mount Assembly

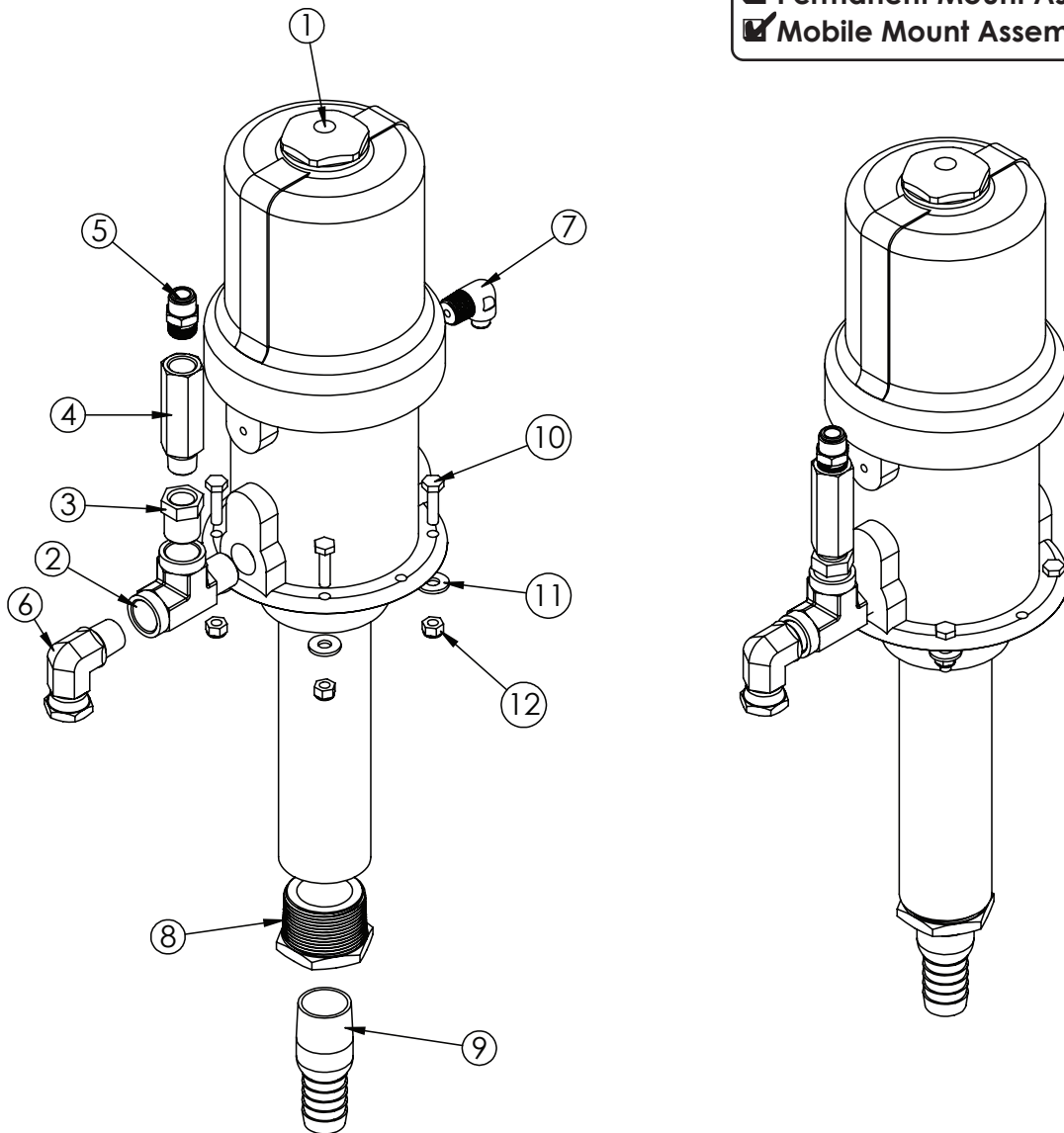

## PN 95767

ITEM	PART No.	DESCRIPTION	QTY.
01	97862	PUMP GRACO FIRE-BALL 300 5:1	1
02	52183	FTG 8-8-8 MP-FP-FP STREET TEE	1
03	0548	FTG 8-6 MP-FP REDUCER BUSHING	1
04	97860	VALVE RELIEF PUMP 3:1/5:1	1
05	97861	FTG 6-6 PTC-MP STRAIGHT ZINC	1
06	52529	FTG 8-8 MP-FPS 90	1
07	95704	FTG 4-6 PTC-MP 90 BRASS	1
08	108345	FTG 24-16 MP-FP REDUCER BUSHING	1
09	103499	FTG 16-16 MP-HB INSERT ADAPTER	1
10	0480	CAP SCR 0.25-20X1.00 HHGR5	4
11	0340	WASHER 0.25 USS FLAT	4
12	0333	NUT 0.25-20 HHGR5 NYLOC	4

# Salvage Oil Pump Assembly - 102564

- Permanent Mount Assembly
- Mobile Mount Assembly

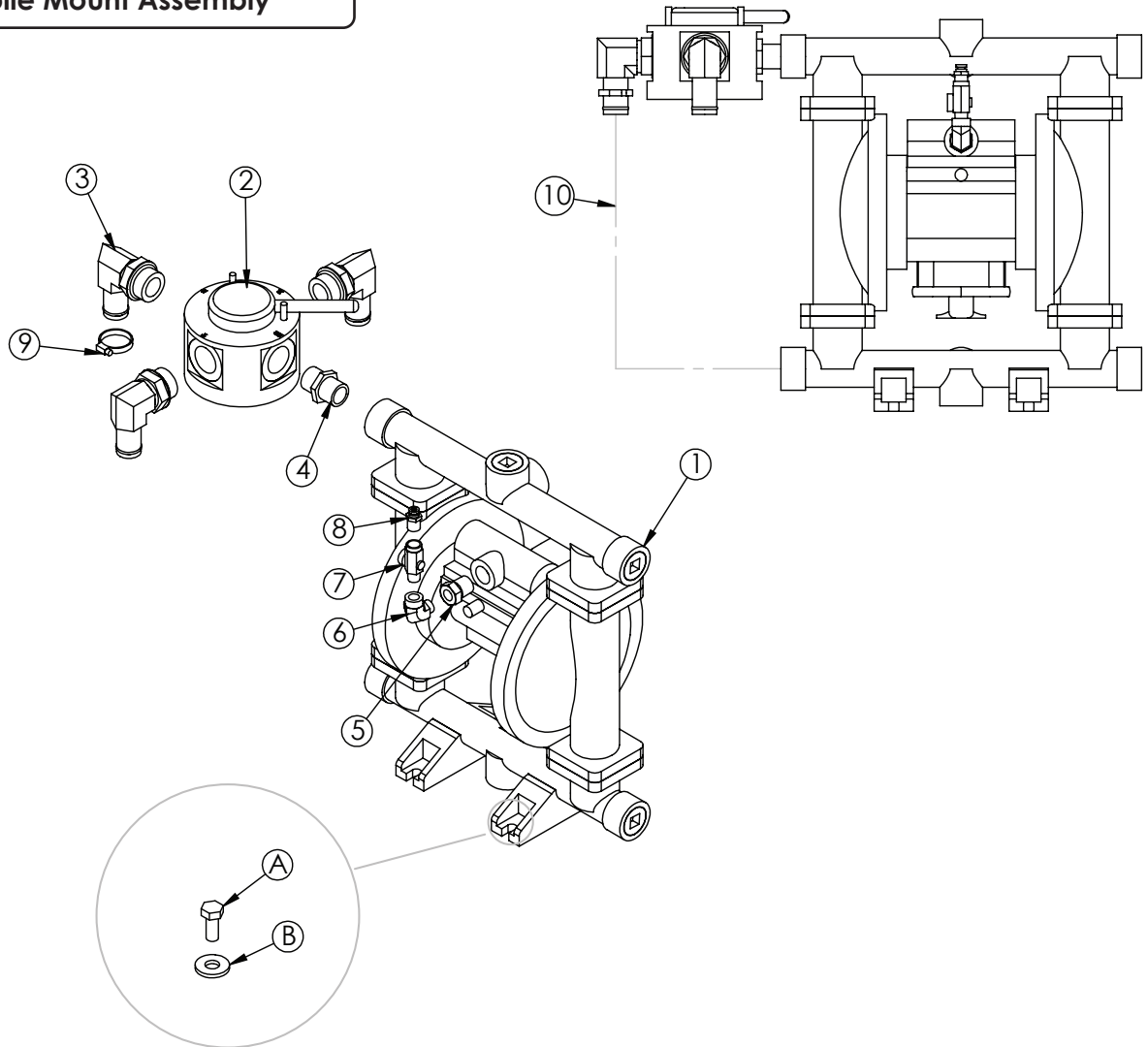

## Salvage Pump Mt Hardware Kit - 110799

ITEM	PART No.	DESCRIPTION	QTY.
A	0420	CAP SCR 0.31-18X0.75 HHGR5	4
B	0343	WASHER 0.31 USS FLAT	4

## PN 102564

ITEM	PART No.	DESCRIPTION	QTY.
01	58266	PUMP GRACO 1050 PN647016	1
02	100022	VALVE 4 WAY 1IN ORING EVAC	1
03	22181	FTG 16-16 HB-MAORB 90	3
04	19800	FTG 16-16 MORB-MP STRAIGHT	1
05	C0550	FTG 8-4 MP-FP REDUCER BUSHING	1
06	C5908	FTG 4-4 MP-FP 90 STREET ELBOW	1
07	102624	REGULATOR AIR 0.25 ADJ BRASS	1
08	76975	FTG 4-4 MP-PTC STRAIGHT BRASS	1
09	C4659	HOSE CLAMP #16 SS	1
10	102665	HOSE 1.00(250PSI)-16MP-16CL	1

# Salvage Oil Reel Assembly - 95734

- Permanent Mount Assembly
- Mobile Mount Assembly

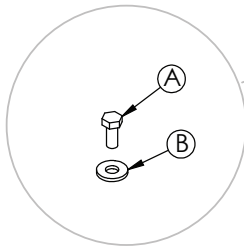
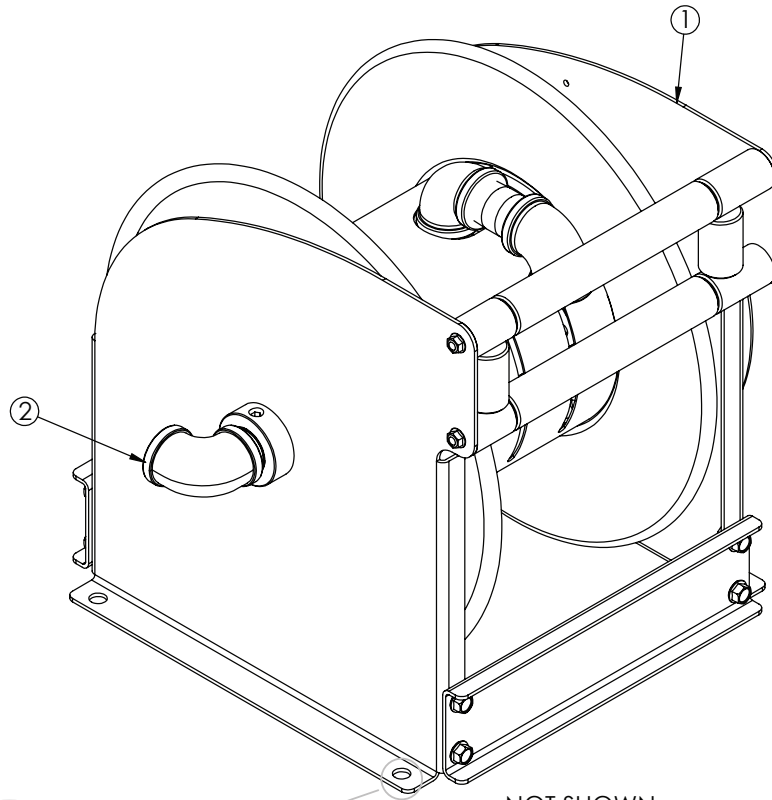

NOT SHOWN:

- (1) 110698-HOSE 1.00(300PSI)-16MP-16MP-300CL
- (1) 95705-QUICK CPLR 6601-16 FL 1.00 NPT
- (1) 107280-HOSE STOP 1.00 BP-1529L

## Reel Mt Hardware Kit - 111174

ITEM	PART No.	DESCRIPTION	QTY.
A	0420	CAP SCR 0.31-18X0.75 HHGR5	4
B	0343	WASHER 0.31 USS FLAT	4

## PN 95734

ITEM	PART No.	DESCRIPTION	QTY.
01	102492	HOSE REEL 1 X 25 CSD14000-OVP-SW-247 BARE SALV REELCRAFT	1
02	97866	FTG 16-16 FP-FP 90 GALV	1

# Fresh Oil Reel Assembly - 95738

- Permanent Mount Assembly
- Mobile Mount Assembly

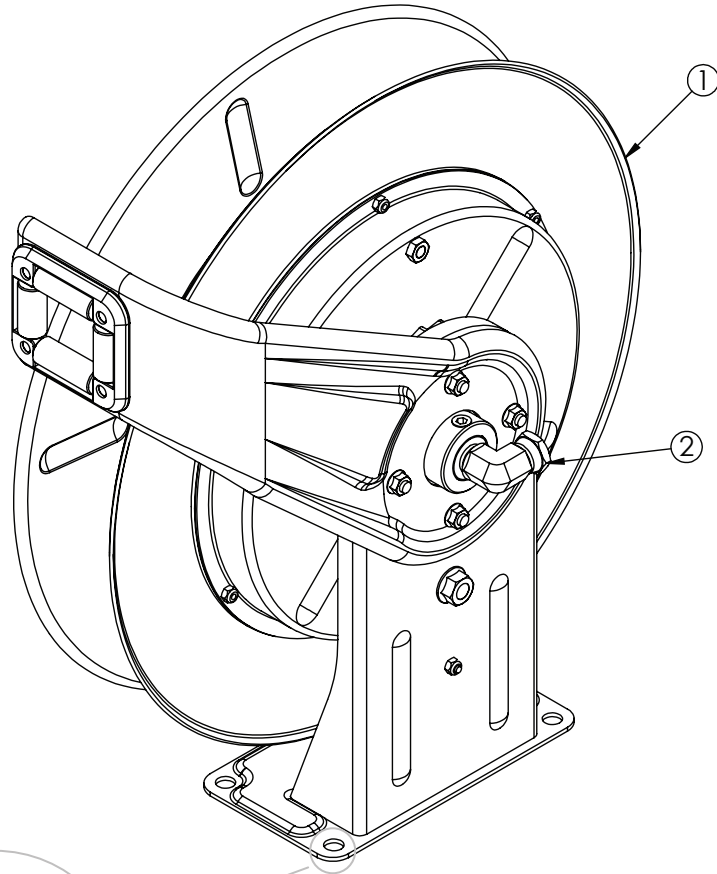

(102488 COMES W/ HOSE AND STOP INSTALLED)

## Reel Mt Hardware Kit - 111174

ITEM	PART No.	DESCRIPTION	QTY.
A	0420	CAP SCR 0.31-18X0.75 HHGR5	4
B	0343	WASHER 0.31 USS FLAT	4

## PN 95738

ITEM	PART No.	DESCRIPTION	QTY.
01	102488	HOSE REEL 1/2 X 50 7850-OMP REELCRAFT	1
02	52529	FTG 8-8 MP-FPS 90	1

# Mounting Kit (4 Spring) - 110794

- Permanent Mount Assembly
- Mobile Mount Assembly

TANK MOUNTING ANGLES  
SHOWN FOR REFERENCE ONLY

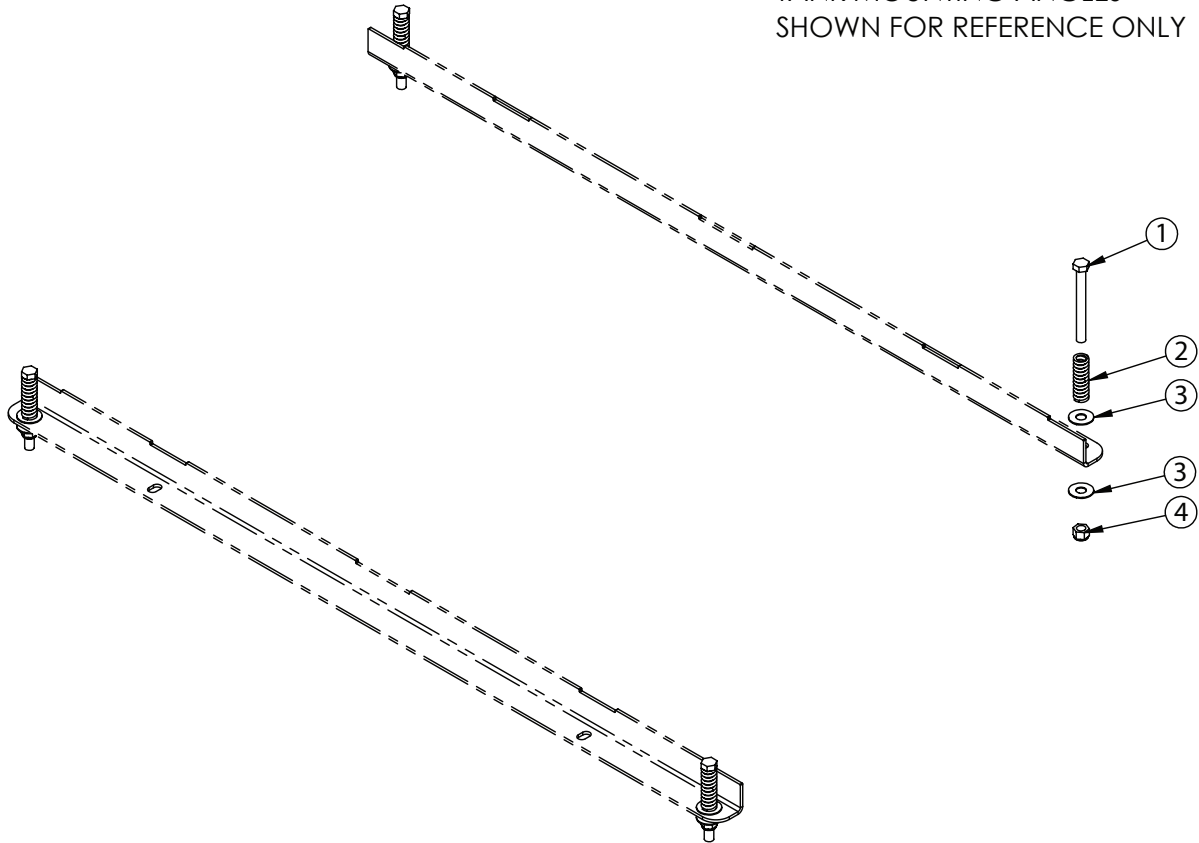

## PN 110794

ITEM	PART No.	DESCRIPTION	QTY.
01	0531	CAP SCR 0.38-16X3.50 HHGR5	4
02	105431	SPRING LEE SPRING LC 120HH 06S	4
03	22166	WASHER 0.38 USS FLAT SS	8
04	0347	NUT 0.38-16 HHGR5 NYLOC	4



# Optional Mounting Angle Kit - 110795

- Permanent Mount Assembly  
 Mobile Mount Assembly

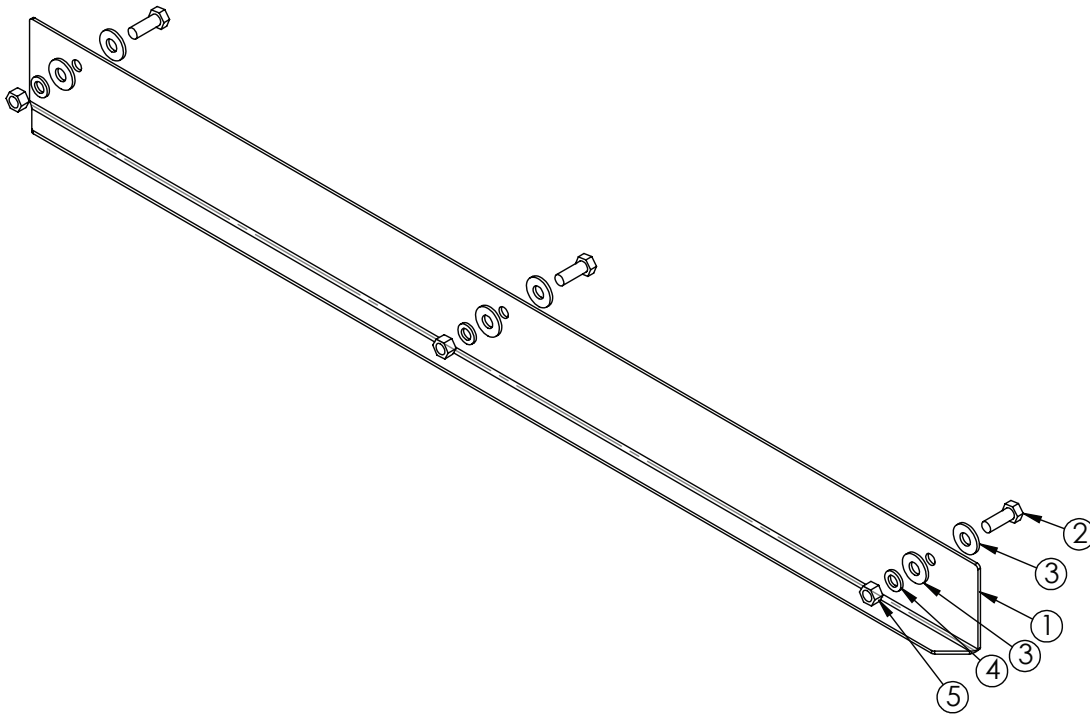

## PN 110795

ITEM	PART No.	DESCRIPTION	QTY.
01	105611	ANGLE FRMD SKID BULKHEAD MNT 12GA	1
02	0351	CAP SCR 0.38-16X1.00 HHGR5	3
03	0346	WASHER 0.38 USS FLAT	6
04	0523	WASHER 0.38 LOCK	3
05	0535	NUT 0.38-16 HHGR5	3

# Drain Pan Assembly (7.5 Gal) - 110888

- Permanent Mount Assembly
- Mobile Mount Assembly

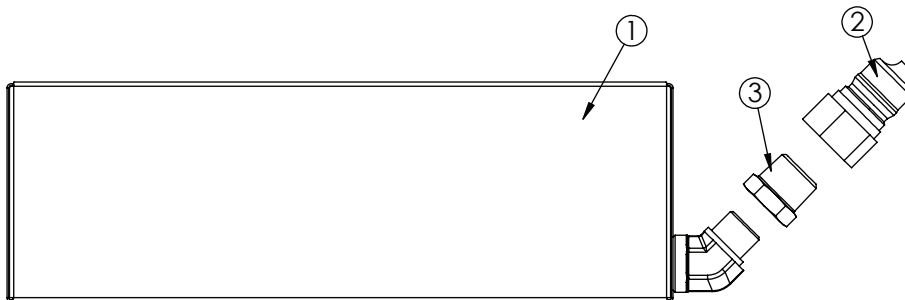
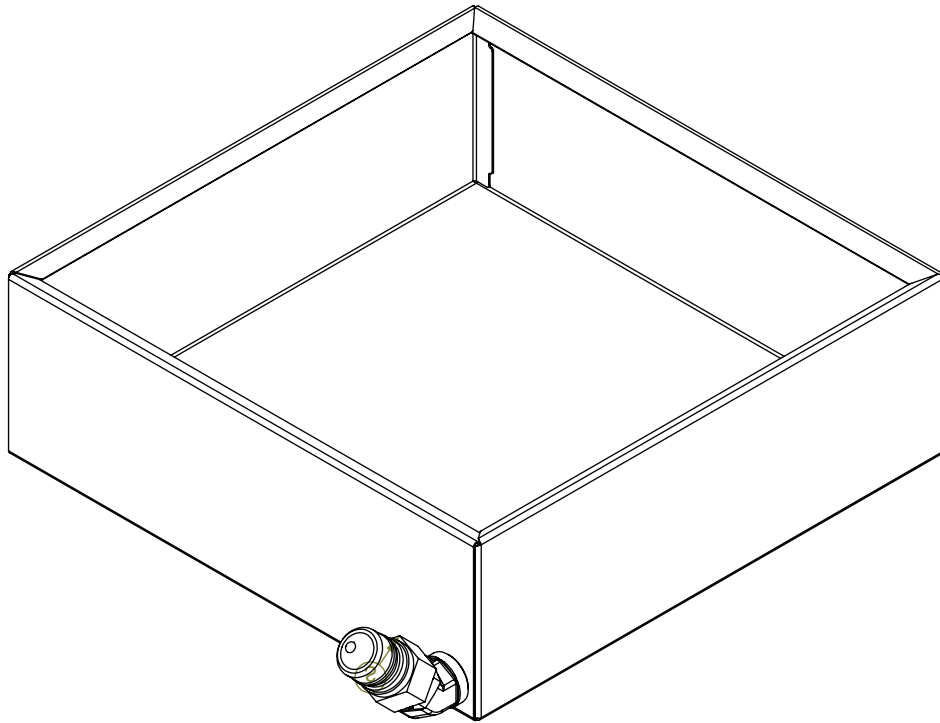

## PN 110888

ITEM	PART No.	DESCRIPTION	QTY.
01	95938	DRAIN PAN WLDMT 7.50 GAL	1
02	95707	QUICK CPLR 6602-16 ML 1.00 NPT	1
03	111875	FTG 16-12 MP-FP REDUCER BUSHING	1

# Control Panel - 95934

- Permanent Mount Assembly
- Mobile Mount Assembly

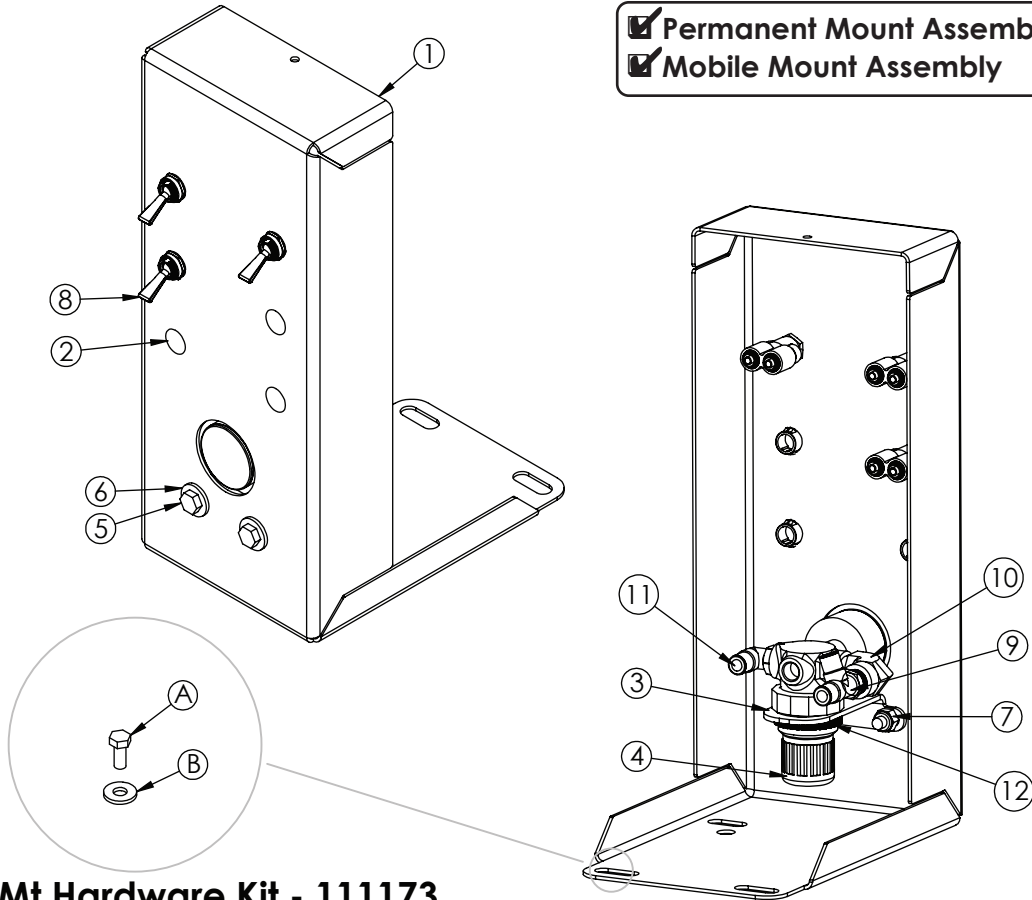

## Ctrl Panel Mt Hardware Kit - 111173

ITEM	PART No.	DESCRIPTION	QTY.
A	0420	CAP SCR 0.31-18X0.75 HHGR5	4
B	0343	WASHER 0.31 USS FLAT	4

## PN 95934

ITEM	PART No.	DESCRIPTION	QTY.
01	102190	CONTROL PANEL 6 SWITCH 14GA	1
02	107060	HOLE PLUG 0.500" NYLON BLACK	3
03	107100	BRACKET REGULATOR NORGREN 0.50"	1
04	98923	REGULATOR NORGREN 0.25 PORTS R07-200-RGLA	1
05	0479	CAP SCR 0.25-20X0.75 HHGR5	2
06	0340	WASHER 0.25 USS FLAT	2
07	0333	NUT 0.25-20 HHGR5 NYLOC	2
08	94919	SWITCH ASM AIR PNEUMATIC (RM) 32231	3
09	102135	FTG 4-4-4 PTC-MPS-PTC RUN TEE	1
10	C5908	FTG 4-4 MP-FP 90 STREET ELBOW	1
11	102049	FTG 4-4 PTC-MPS 90	1
12	110882	NUT RETAINER R07 REGULATOR	1

ITEMS NOT SHOWN		
PART No.	DESCRIPTION	QTY.
C6244	TUBING NYLON AIR BRAKE 0.25	2.5
102047	FTG 4-4-4 PTC-PTC-PTC UNION TEE	1
112787	DECAL SERIAL NUMBER AMERICAN EAGLE 2.00X2.00	1

**This page intentionally left blank.**

# Chapter 5 - Replacement Parts

---

<b>PN</b>	<b>Description</b>
96158	4-Way vavle with fittings
58266	Graco 1" Diaphragm pump
52529	Elbow 1/2" NPTF-NPSM
52183	1/2" Street T Tompkins
0548	1/2" x 3/8" reducing bushing Tompkins
97860	3:1/5:1 relief valve
97861	3/8 x 3/8 Male poly push connect
63494	3:1 Graco Fireball Pump
97862	5:1 Graco Fireball Pump
95704	3/8 x 1/4 male elbow push connect
73277	1 PSI Breather cap
60200	3/8" black poly-flo tubing
97863	3/8" 90-degree push connect fitting
71411	3/8"MP x 1/2(3/8) Barb 90
C6348	3/8" Clear vinyl hose (site gauge)
97864	Sight gauge screen
97865	2" galvanized square head plug
4348	1 1/2 x 1 Hex bushing - Black
C4659	1 1/16 - 1 1/2 Hose Clamp #16
D1449	16GMV Suction Hose
48960	1" MAS Hose Barb
97866	1" 90 deg elbow - galvanized







Subject to Change without Notification.  
© 2022 Stellar Industries, Inc.