

Model CCR Container Carrier Owner's Manual

Specifications • Installation • Assembly Drawings

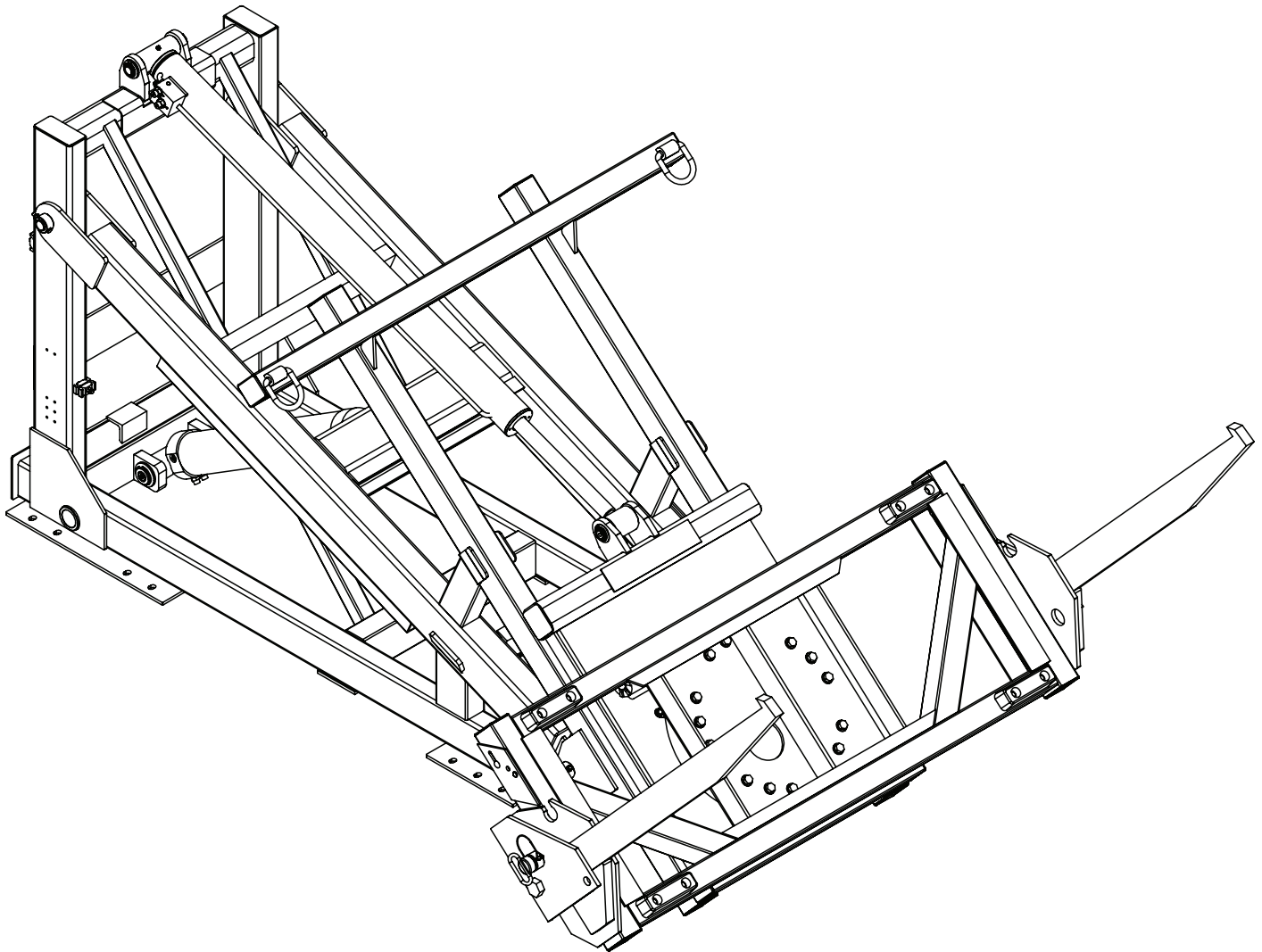

**Notice: A copy of this manual must remain with the equipment at all times.
For a printable download copy, please visit: www.stellarindustries.com**

Stellar Industries, Inc.

190 State Street

PO Box 169

Garner, IA 50438

800-321-3741

Fax: 641-923-2811

www.stellarindustries.com

Subject to Change without Notification.
© 2024 Stellar Industries, Inc.

Rev 4
PN 89042

P65 Warning / Notice / Serial Tag Location

WARNING

Operating, maintaining, and servicing a Stellar product may expose you to chemicals including, but not limited to, engine exhaust, carbon monoxide, phthalates, and lead. These chemicals are known to the State of California to cause cancer and birth defects (or other reproductive harm). To keep your exposure to a minimum, be sure to avoid breathing exhaust and service your Stellar product in a well-ventilated area while wearing gloves or washing your hands frequently. For more information, go to www.P65Warnings.ca.gov/passenger-vehicle.

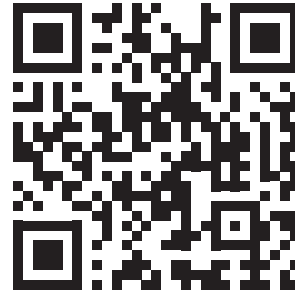

www.p65warnings.ca.gov

NOTICE

Cold Weather Performance

Although clear data on cold weather performance from every steel manufacturer is not available for all types and thicknesses of steel, Stellar Industries is confident that the weldments on our products will operate to 100% of their intended purpose to temperatures down to -40° F / C.

It is recommended if Stellar manufactured equipment needs to be used in temperatures below -40° F / C, the operator should pull the unit into a climate-controlled area and allow the weldments to warm up to and then maintain a temperature above this level.

Serial Tag Location

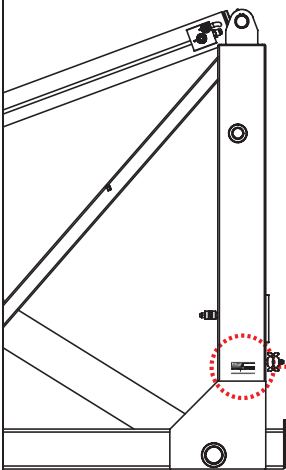

		DATE
PATENT INFORMATION http://www.stellarindustries.com/ip		<input type="text"/>
MODEL NO.	SERIAL NO.	
<input type="text"/>	<input type="text"/>	
MADE IN THE U.S.A. BY STELLAR INDUSTRIES, INC.		
PN C5942		

Table of Contents

Introduction	vi
Chapter 1 - Specifications	1
Container Carrier Nomenclature	2
Container Carrier Dimensions.....	3
Container Carrier Specifications	3
General Installation	4
Installer Notice	4
Torque Data Chart	5
Chapter 2 - Installation.....	7
Step 1: Clear the Truck Frame.....	8
Step 2: Shorten the Truck Frame.....	8
Step 3: Install Bumper.....	9
Step 4: Set the Container Carrier on the Truck.....	10
Step 5: Install Tie-Down Castings	10
Step 6: Install the PTO and Pump	11
Step 7: Install Reservoir.....	11
Step 8: Install Valve Bank	11
Step 9: Route Hydraulics	12
Face Seal/O-Ring Size Chart.....	12
CCR Hose Kit - PN 53039	13
CCR Hose Kit (18.50IN Lower Mnt) - PN 106929	14
Step 10: Install In-Cab Controls	15
Controller Asm 3-Sect DVS10 96" 53815	18
Controller Asm 3-Sect DVS10 96" 53815 Parts List	19
Controller Asm 3-Sect DVS10 144" 60806	20
Controller Asm 3-Sect DVS10 144" 60806 Parts List	21
Control Tower Asm 3-Section - 88651	22
Control Tower Asm 3-Section - 88651	23
Step 11: Install Hoist Up Light Kit.....	24
Step 12: Install bumper accessories.....	25
Step 12: Install Bumper Accessories	26
Step 13: Route Electrical	27
Step 14: Install Fenders and Mud Flaps	29
Step 15: Operate the Container Carrier	29
Setting System Relief Pressure	30
Step 16A: Apply Carrier Decals	31
Step 16B: Apply Chassis Decals	32
Chapter 3 - Assembly Drawings.....	33
Base Assembly - PN 53392	34
Base Assembly - PN 53392 Part List.....	35
Lift Cylinder Assembly - PN 23462	36
Lift Cylinder Assembly - PN 23462 Parts List	37
Base Asm 18" Drop Forks - PN 130151.....	38
18" Drop Forks	38
Base Asm 18" Drop Forks - PN 130151 Parts List	39
Lift Cyl Asm 18" Drop Forks - PN 130152.....	40
Lift Cyl Asm 18" Drop Forks - PN 130152 Parts List.....	41
Tilt Cylinder Assembly - PN 53242	42
Tilt Cylinder Assembly - PN 53242 Parts List	43
Lift Frame Assembly - PN 52927	44
Lift Frame Assembly - PN 52927 Parts List	45
Lift Frame Asm 18" Drop Forks - PN 130241.....	46
Lift Frame Asm 18" Drop Forks - PN 130241 Parts List.....	47
Extendable Fork Frame Assembly - PN 57775.....	48
Extendable Fork Frame Assembly - PN 57775 Parts List.....	49

Table of Contents

Adjustable Fork Frame Assembly - PN 58145.....	50
Adjustable Fork Frame Assembly - PN 58145 Parts List.....	51
Fork Frame Assembly - PN 51308.....	52
Fork Frame Assembly - PN 51308 Part List.....	53
Fork Frame Assembly 8" Drop Forks - PN 67322.....	54
Fork Frame Assembly 8" Drop Forks - PN 67322 Parts.....	55
Fork Frame Asm 18" Drop Forks - PN 79374.....	56
Fork Frame Asm 18" Drop Forks - PN 79374 Parts List.....	57
RSRVR ASM 10 Gal BLKHD 3-Sect - 134276.....	58
RSRVR ASM 10 Gal BLKHD 3-Sect - 134276 Parts.....	59
RSRVR Assembly VB Detail - 134276.....	60
RSRVR Assembly Decal Brkt Detail - 134276.....	61
RSRVR Assembly Port Tubes - 134276.....	62
Air Actuator DVS10 - PN 64634.....	63
Cable Kit DVS10 - PN 67319.....	63
Reservoir Assembly - PN 98545.....	64
Reservoir Assembly - PN 98545 Parts List.....	65
Fender Kit Assembly - PN 80045.....	66
Fender Kit Assembly - PN 80045 Parts List.....	67

This Page Left Intentionally Blank

Introduction

A copy of this manual is provided with every crane and can be found in the hard plastic manual case that is installed on the chassis. A copy of this manual shall remain with the crane at all times.

Throughout the manual, three signal words will be used to bring attention to important items:

NOTICE

A NOTICE signal word indicates a practice not related to physical injury.

⚠ WARNING

A WARNING signal word indicates a hazardous situation which, if not avoided, could result in death or serious injury.

⚠ DANGER

A DANGER signal word indicates a hazardous situation which, if not avoided, will result in death or serious injury.

Information contained within this manual does not cover safety or operation. Please refer to the Container Carrier General Manual for details on these items.

This manual is not binding. Stellar Industries, Inc. reserves the right to change, at any time, any or all of the items, components, and parts deemed necessary for product improvement or commercial/production purposes. This right is kept with no requirement or obligation for immediate mandatory updating of this manual.

If more information is required or technical assistance is needed, or if you feel that any part of this manual is unclear or incorrect, please contact the Stellar Customer Service Department by phone at 800-321-3741 or email at service@stellarindustries.com.

For Technical Questions, Information, Parts, or Warranty, Call Toll-Free at

800-321-3741

Hours: Monday - Friday, 8:00 a.m. - 5:00 p.m. CST

Or email at the following addresses:

Technical Questions, and Information

service@stellarindustries.com

Order Parts

parts@stellarindustries.com

Warranty Information

warranty@stellarindustries.com

Chapter 1 - Specifications

CHAPTER CONTENTS

Container Carrier Nomenclature	2
Container Carrier Dimensions.....	3
Container Carrier Specifications	3
General Installation	4

Container Carrier Nomenclature

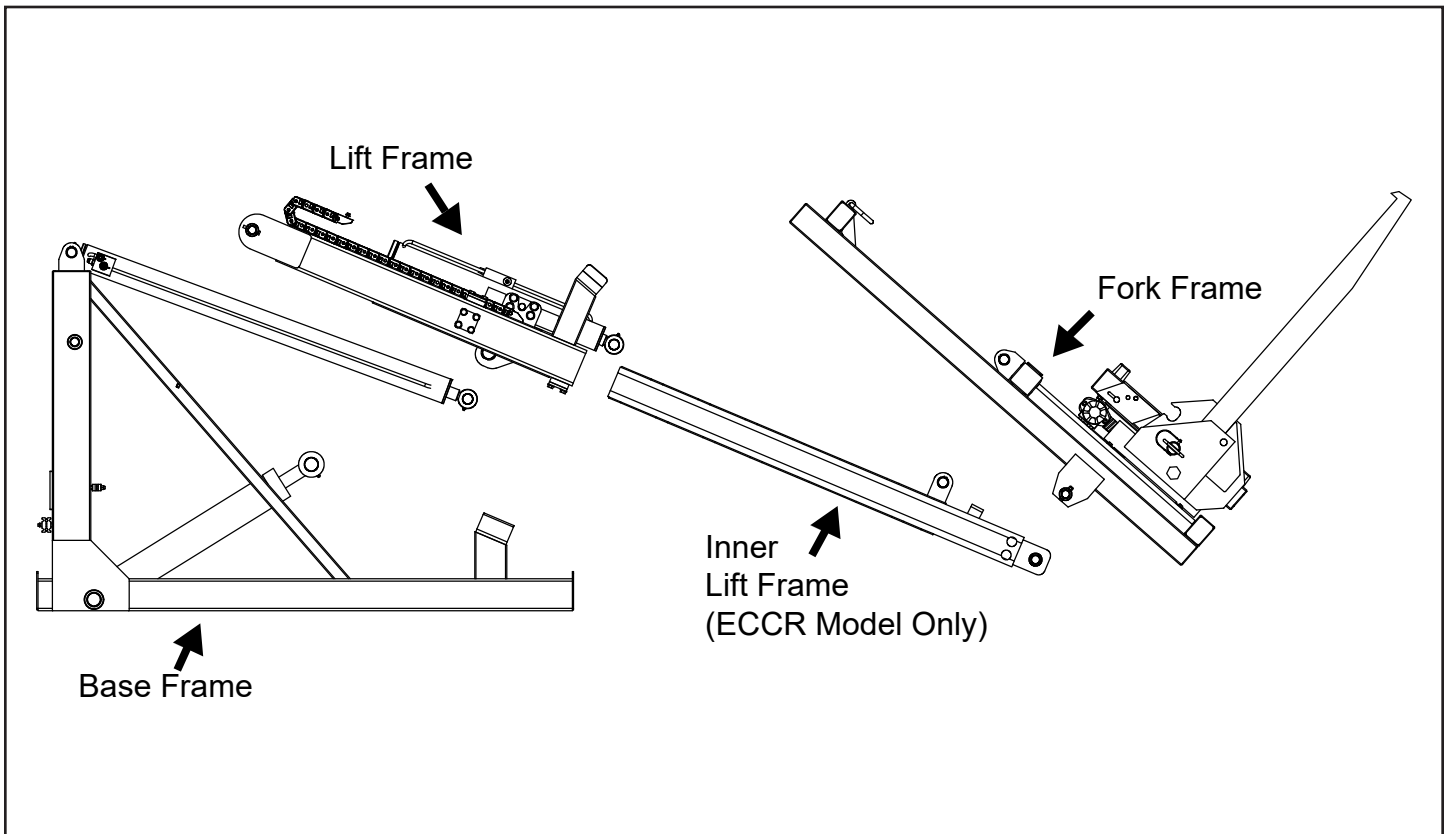

Container Carrier Dimensions

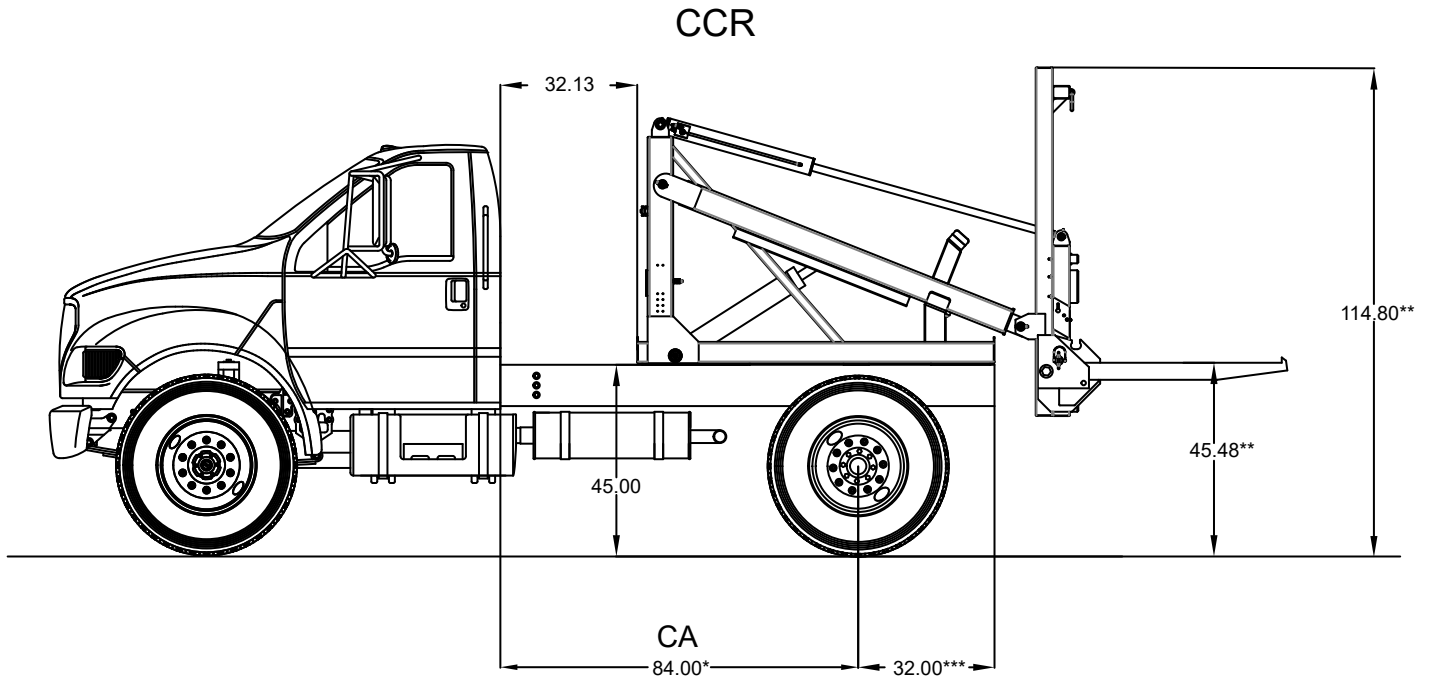

* 84"-114" recommended CA. 60" is possible with reduced capacity rating.

** 8.00" drop models subtract 8" from this dimension.

18.50" drop models subtract 18.5" from this dimension.

*** Needs to be 35" when installing on a Ford F750 chassis.

Container Carrier Specifications

Lifting capacity	8,000lbs
Dumping capacity	8,000lbs (4,000lbs on 18.50" Drop Model)
Transporting capacity	8,000lbs (4,000lbs on 18.50" Drop Model)*
Container sizes	2-10yd
Type of containers	Front and rear load
Range of travel	76.06"
Rotation	Worm/Turntable Gear Bearings
Stacking capability	2-8yd
Operating pressure	4,500psi
GPM	12
Hydraulic tank	10 gallon
Recommended CA	84" min.
Controls	Inside and outside
Bushings and grease zerks	All pivot and rotation points
Container bumpers	Molded rubber
Hydraulic pump	Bent-axis piston type
Valve bank	2, 3, and 4 spool cable controlled standard
* Driver responsible for using safe driving practices.	

General Installation

This chapter is designed to serve as a general guide for the installation of a Stellar® Container Carrier. Each installation is considered unique so certain portions of this chapter may or may not apply to your direct application. If a question should arise during the installation process, please contact Stellar Customer Service at (800) 321 3741.

PTO and Pump installation instructions are provided by the corresponding manufacturers. For more information on which PTO and Pump fit your application, please contact your local Stellar Distributor or Stellar Customer Service.

⚠ WARNING Do not install this container carrier on a chassis not capable of handling the loads imposed on it. Failure to do so may result in serious injury or death.

Container carrier Mounting and Assembly

Study names and locations of the parts and familiarize yourself with the container carrier before starting the assembly. Reading the step-by-step instructions that follow will be helpful.

Assembly

Select an area for assembly that will be large enough to accommodate the completed unit. The surface of the work area should be as level as possible. Use the proper hand tools to ensure proper bolt tightness. Refer to the torque data chart in this chapter for the recommended torque values for different sizes of bolts.

Installer Notice

According to Federal Law (49 cfr part 571), each final-stage manufacturer shall complete the vehicle in such a manner that it conforms to the standards in effect on the date of manufacture of the incomplete vehicle, the date of final completion, or a date between those two dates. This requirement shall, however, be superseded by any conflicting provisions of a standard that applies by its terms to vehicles manufactured in two or more stages.

Therefore, the installer of Stellar® Container carriers is considered one of the manufacturers of the vehicle. As such a manufacturer, the installer is responsible for compliance with all applicable federal and state regulations. They are required to certify that the vehicle is in compliance with the Federal Motor Vehicle Safety Standards and other regulations issued under the National Traffic and Motor Vehicle Safety Act.

Please reference the Code of Federal Regulations, title 49 - Transportation, Volume 5 (400-999), for further information, or visit <http://www.gpoaccess.gov/nara/index.html> for the full text of Code of Federal Regulations.

Torque Data Chart

When using the torque data in the chart, the following rules should be observed:

- Bolt manufacturer's particular specifications should be consulted when provided.
- Flat washers of equal strength must be used.
- All torque measurements are given in foot-pounds. To convert to inch-pounds, multiply by 12.
- Torque values specified are for bolts with residual oils or no special lubricants applied.
- Torque values for socket-head capscrews are the same as for Grade 8 capscrews.

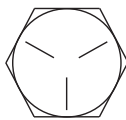
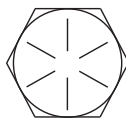
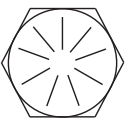
		GRADE 5		GRADE 8		GRADE 9
						
Size (DIA-TPI)	Bolt DIA (Inches)	Plain (Ft-Lb)	Plated (Ft-Lb)	Plain (Ft-Lb)	Plated (Ft-Lb)	Plated (Ft-Lb)
5/16-18	0.3125	17	13	25	18	22
3/8-16	0.3750	31	23	44	33	39
7/16-14	0.4375	49	37	70	52	63
1/2-13	0.5000	75	57	105	80	96
9/16-12	0.5625	110	82	155	115	139
5/8-11	0.6250	150	115	220	160	192
3/4-10	0.7500	265	200	375	280	340
7/8-9	0.8750	395	295	605	455	549
1-8	1.000	590	445	910	680	823
1 1/8-7	1.1250	795	595	1290	965	1167
1 1/4-7	1.2500	1120	840	1815	1360	1646
1 3/8-6	1.3750	1470	1100	2380	1780	2158
1 1/2-6	1.500	1950	1460	3160	2370	2865

- **NOTICE** Do not use these values if a different torque value or tightening procedure is given for a specific application. Torque values listed are for general use only. Check tightness of fasteners periodically.
- Shear bolts are designed to fail under predetermined loads. Always replace shear bolts with identical grade.
- Fasteners should be replaced with the same or higher grade. If higher grade fasteners are used, these should only be tightened to the strength of the original.
- Tighten plastic insert or crimped steel-type lock nuts to approximately 110 percent of the dry torque values shown in the chart below, applied to the nut, not to the bolt head. Tighten toothed or serrated-type lock nuts to the full torque value. *Note: "Lubricated" means coated with a lubricant such as engine oil, or fasteners with phosphate and oil coatings. "Dry" means plain or zinc plated without lubrication. Tighten lubricated bolts to approximately 80% of dry bolts.*

This Page Left Intentionally Blank.

Chapter 2 - Installation

CHAPTER CONTENTS

Step 1: Clear the Truck Frame	8
Step 2: Shorten the Truck Frame.....	8
Step 3: Install Bumper.....	9
Step 4: Set the Container Carrier on the Truck.....	10
Step 5: Install Tie-Down Castings	10
Step 6: Install the PTO and Pump	11
Step 7: Install Reservoir.....	11
Step 8: Install Valve Bank	11
Step 9: Route Hydraulics	12
Face Seal/O-Ring Size Chart.....	12
CCR Hose Kit - PN 53039	13
CCR Hose Kit (18.50IN Lower Mnt) - PN 106929	14
Step 10: Install In-Cab Controls.....	15
Controller Asm 3-Sect DVS10 96" 53815	18
Controller Asm 3-Sect DVS10 96" 53815 Parts List	19
Controller Asm 3-Sect DVS10 144" 60806	20
Controller Asm 3-Sect DVS10 144" 60806 Parts List	21
Control Tower Asm 3-Section - 88651	22
Control Tower Asm 3-Section - 88651	23
Step 11: Install Hoist Up Light Kit.....	24
Step 12: Install bumper accessories.....	25
Step 12: Install Bumper Accessories	26
Step 13: Route Electrical	27
Step 14: Install Fenders and Mud Flaps	29
Step 15: Operate the Container Carrier.....	29
Setting System Relief Pressure	30
Step 16A: Apply Carrier Decals	31
Step 16B: Apply Chassis Decals	32

Installation Note

Every container carrier installation is unique. However, certain guidelines exist that apply to every model. Listed below is a general set of chronological steps that may be followed when installing a Stellar Container Carrier. If any questions arise during the installation process, feel free to contact your local dealer or Stellar Customer Service at 800-321-3741.

Step 1: Clear the Truck Frame

- A. Remove any object on top of the truck frame that will interfere with the installation of the Container Carrier.
- B. Remove any temporary lights and mud flaps.

Step 2: Shorten the Truck Frame

- A. Cut the truck frame off a minimum of 1" behind the rear spring shackle.
- B. Make sure not to cut rear of frame off shorter than 32" (35" when installing on Ford F750 Chassis) from center of axle to end of frame.

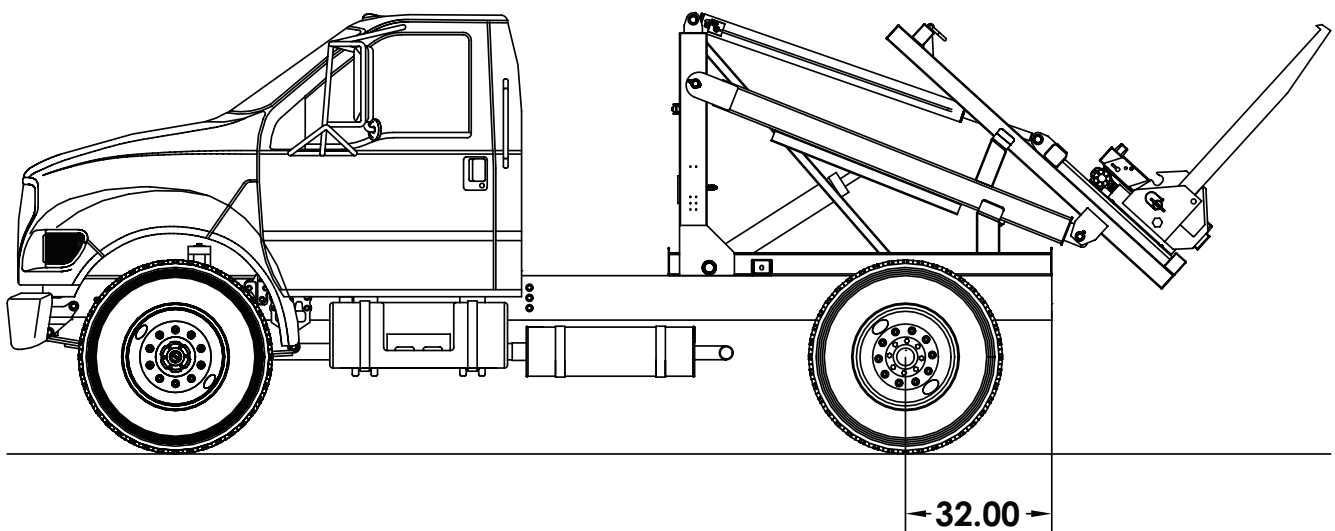

Step 3: Install Bumper

- Prep the end of the truck frame so the frame rails have a flat face for the bumper pull plate to mount to.
- Clamp bumper pull plate to the end of the truck frame. Once bumper is level and placed correctly, tack weld in place.
- Fully weld the bumper pull plate to the outside and inside of the truck frame.

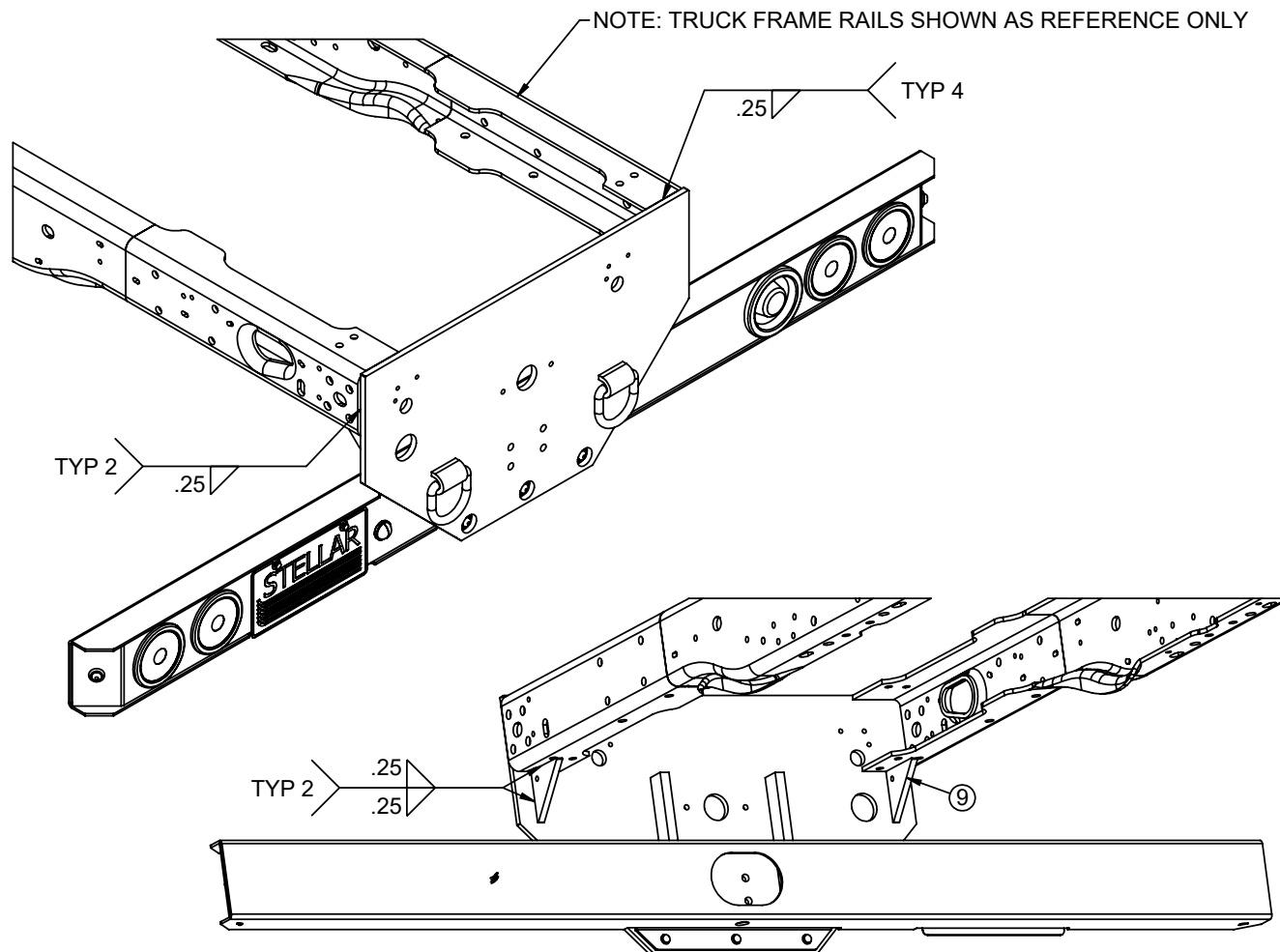

NOTE: PN 112272 IS ONLY REQUIRED WITH TRUCK FRAMES SHORTER THAN 8" IN HEIGHT.

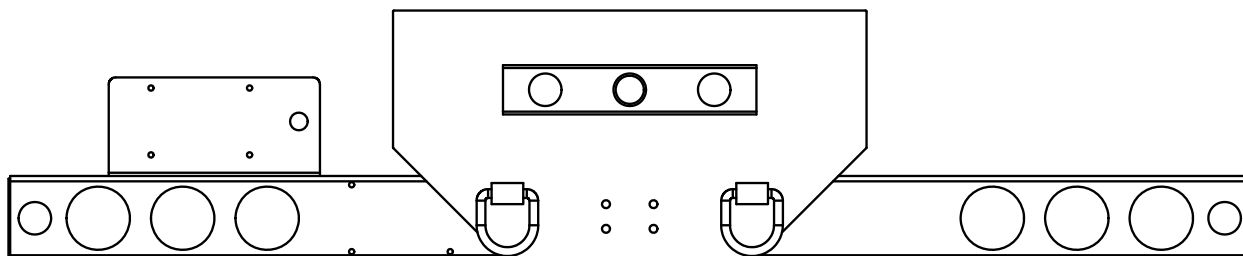

Step 4: Set the Container Carrier on the Truck

- Set the Container Carrier on top of the truck frame. See Mounting Kit below
- Container Carrier must set on a level surface. If any object (rivets, cross members, etc.) extend above the top of the truck frame, and cannot be removed, a spacer must be used.
- On the CCR model the rear of the base should mount flush to the rear of the truck frame.
- Square Container Carrier on the truck. (Note: See drawing in Step 2 of this chapter)

Step 5: Install Tie-Down Castings

- Using 5/8" bolts, washers, and nuts, secure the six (4) loose tie down castings and two (2) rear angle brackets to the mounting plates already welded to the Container Carrier base.
- Using the castings/brackets as a guide, drill six (6) 11/16" holes through the truck frame.
- Fasten the tie down castings to the truck frame using the remaining 5/8" bolts, washers, and nuts.

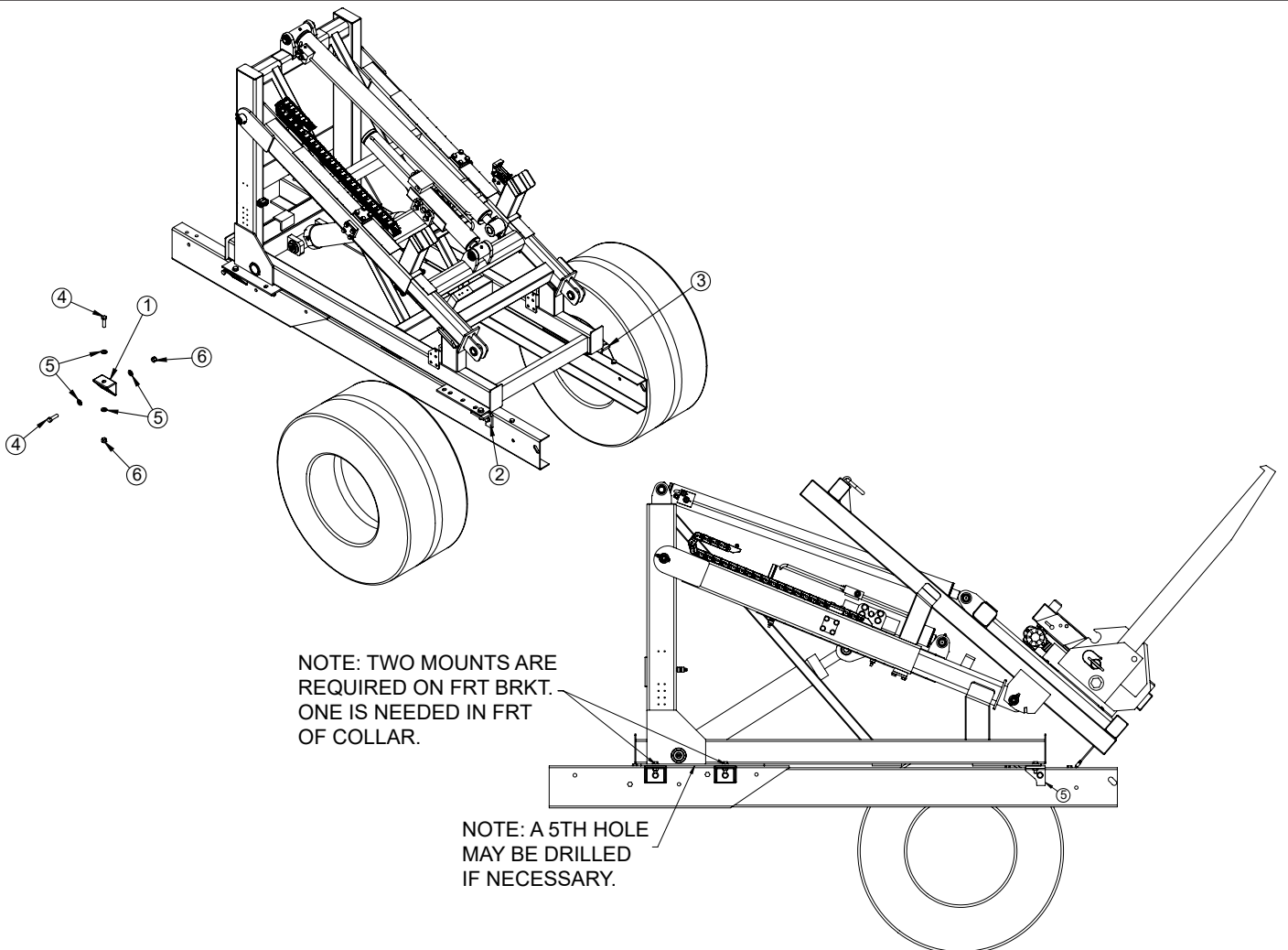

ITEM	PART	PN 52296 - DESCRIPTION	QTY
1	D0143	TIE DOWN CHANNEL	4
2	81678	ANGLE FORMED ECCR BASE MNT SS	1
3	81679	ANGLE FORMED ECCR BASE MNT CS	1
4	84053	CAP SCR 0.63-11X2.25 HHGR8	12
5	C5902	WASHER 0.63 SAE FLAT YELLOW GR8	24
6	24868	NUT 0.63-11 HHGR8 NYLOC	12

Step 6: Install the PTO and Pump

A. Install the PTO and Pump according to the manufacturer instructions.

Step 7: Install Reservoir

A. Install the reservoir:

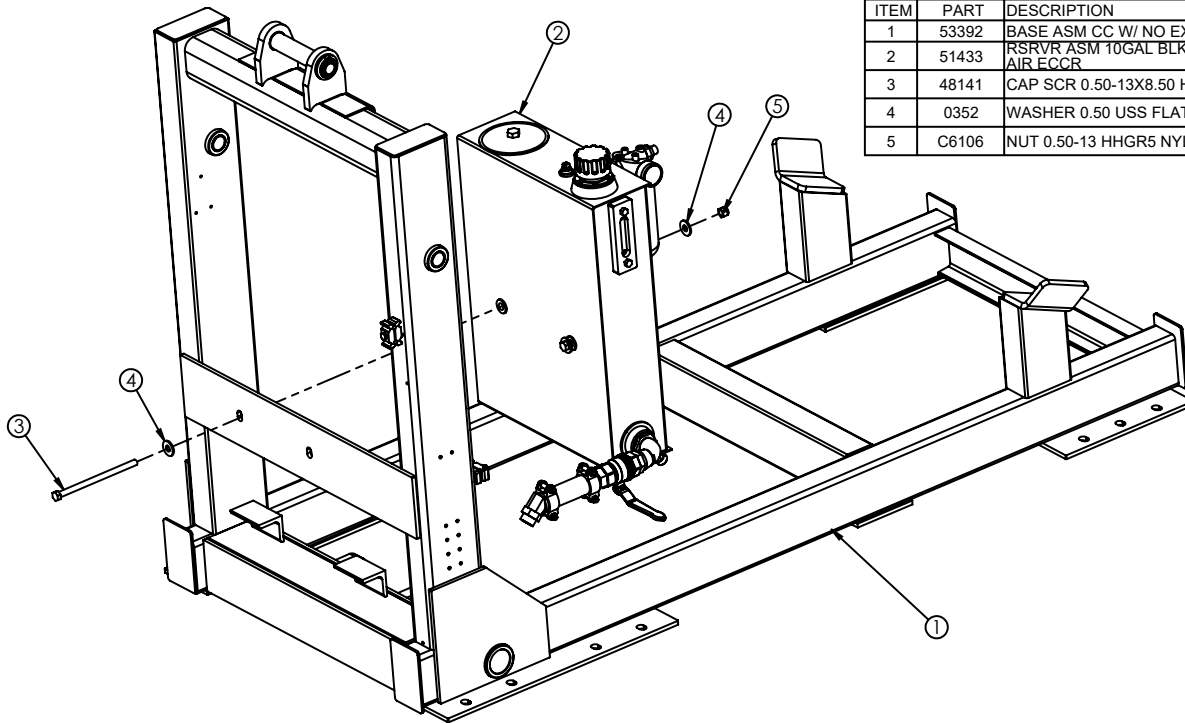

ITEM	PART	DESCRIPTION	QTY.
1	53392	BASE ASM CC W/ NO EXT	1
2	51433	RSRVR ASM 10GAL BLKHD 4-SECT VB AIR ECCR	1
3	48141	CAP SCR 0.50-13X8.50 HHGR5	1
4	0352	WASHER 0.50 USS FLAT ZINC	2
5	C6106	NUT 0.50-13 HHGR5 NYLOC	1

Step 8: Install Valve Bank

A. Install the valve bank:

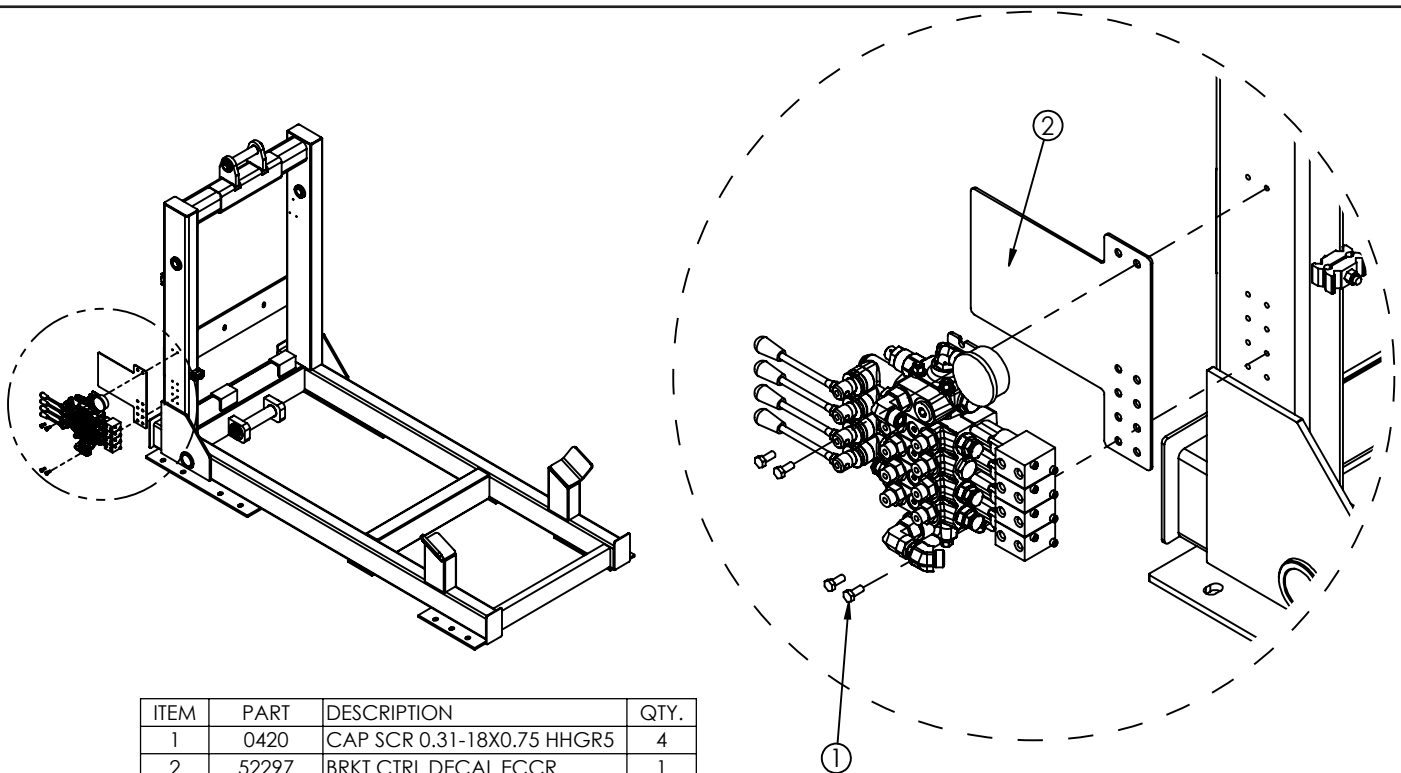

ITEM	PART	DESCRIPTION	QTY.
1	0420	CAP SCR 0.31-18X0.75 HHGR5	4
2	52297	BRKT CTRL DECAL ECCR	1

Step 9: Route Hydraulics

- A. Connect suction hose to the suction ports on the reservoir and pump. Attach with hose clamps provided.
- B. Connect pressure hose to the pressure port on the pump and the pressure port on the valve bank.

Face Seal/O-Ring Size Chart

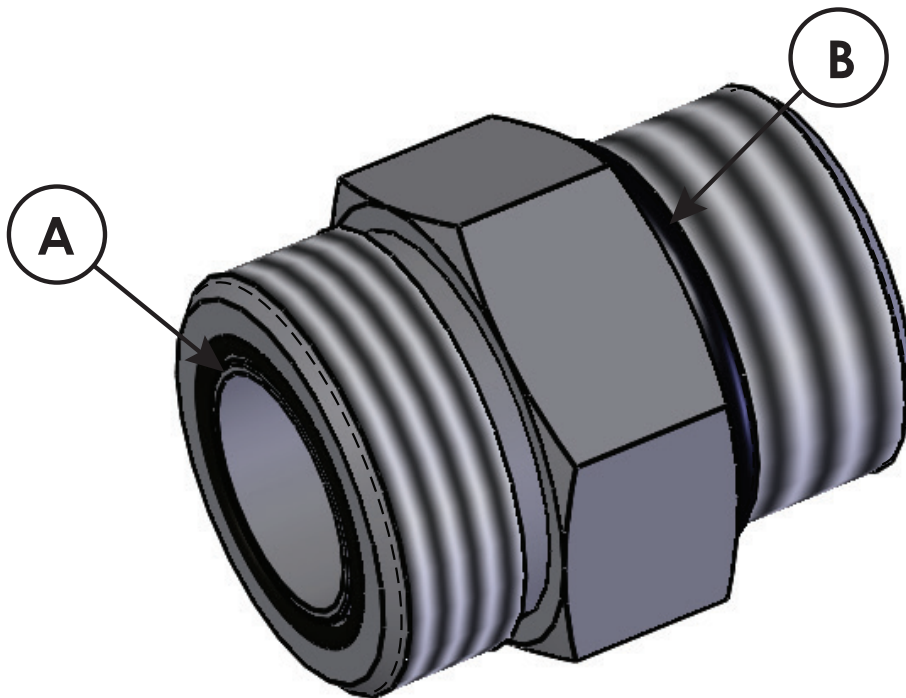

Hose Size	Fitting Size	Face Seal (A) Stellar® PN	O-ring Boss (B) Stellar® PN
1/4"	#4	C2027	D1245
3/8"	#6	C2028	D1246
1/2"	#8	C2029	D1247
5/8"	#10	32223	D1248
3/4"	#12	D1244	D1249
1"	#16		D1250

CCR Hose Kit - PN 53039

STELLAR #52553 - (471TC-J0-J9-6-6-6-27")
 QTY - 2

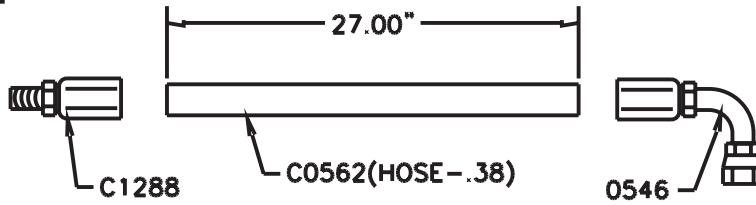

FUNCTION: TUBE ASM TO LIFT CYL

STELLAR #54484 - (471TC-J0-J9-6-6-6-32")
 QTY - 2

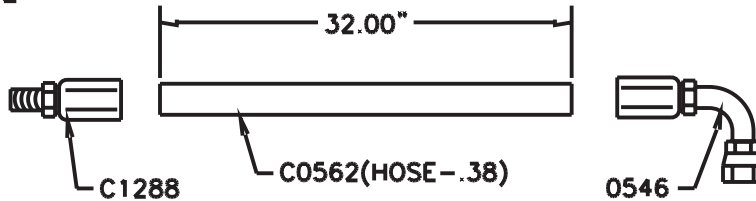

FUNCTION: TUBE ASM TO TILT CYL

STELLAR #54483 - (471TC-J0-JC-6-6-6-114")
 QTY - 2

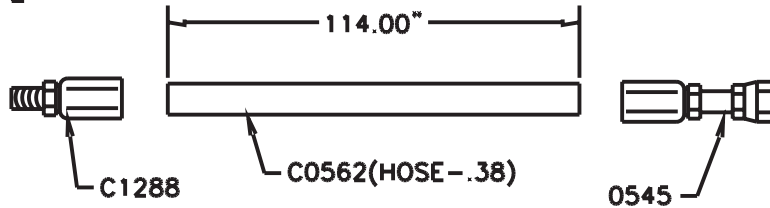

FUNCTION: TUBE ASM TO ROTATOR

Note: System Pressure is 4500 PSI

Note: See Manual for Port Tube Installation

PN 53039

ITEM	PART No.	DESCRIPTION	QTY.
1	53039	HOSE KIT CONTAINER CARRIER W/ROT HP	1
2	54483	HOSE .38 X 114.00	2ref
3	54484	HOSE .38 X 32.00	2ref
4	52553	HOSE .38 X 27.00	2ref

CCR Hose Kit (18.50IN Lower Mnt) - PN 106929

STELLAR #106930 -0.38(4500PSI)-6MFS-6FFSS 90 SHORT-120CL
QTY - 2

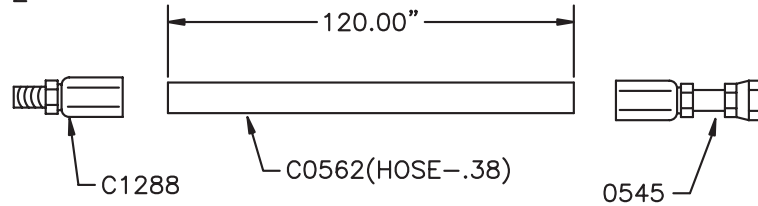

FUNCTION: TUBE ASM TO ROTATOR

STELLAR #54484-0.38(4500PSI)-6MFS-6FFSS 90 SHORT-32CL
QTY - 2

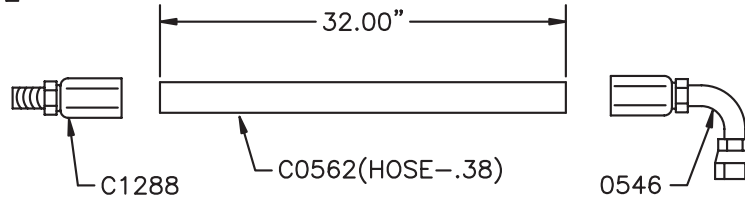

FUNCTION: TUBE ASM TO TILT CYL

STELLAR #106931-0.38(4500PSI)-6MFS-6FFSS SHORT-27CL
QTY -2

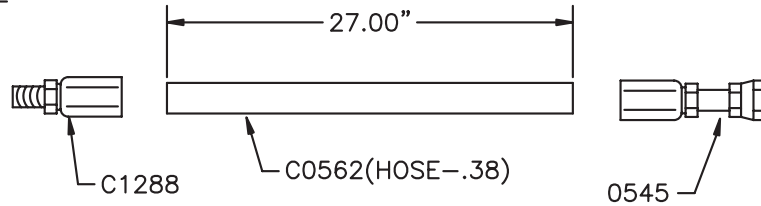

FUNCTION: TUBE ASM TO LIFT CYL

Note: System Pressure is 4500 PSI

Note: See Manual for Port Tube Installation

PN 106929

ITEM	PART No.	DESCRIPTION	QTY.
1	106929	HOSE KIT CONTAINER CARRIER W/ROT HP	1
2	106930	HOSE .38 (4500PSI)-6MFS-6FFSS 90 SHORT-120CL	2ref
3	54484	HOSE .38 (4500PSI)-6MFS-6FFSS 90 SHORT-32CL	2ref
4	106931	HOSE .38 (4500PSI)-6MFS-6FFSS SHORT-27CL	2ref

Step 10: Install In-Cab Controls

A. Pre-Assembled Air Control Tower Installation

1. Determine a suitable location which is in a comfortable location for the driver and not in the way of the transmission lever.
2. Position the lower bolt holes so that the bolts will miss any cable, wires, or structural members in or under the cab floor.
3. Mark and drill the four (4) .375" diameter holes for the 3/8" cap screws supplied for the tower.
4. Determine a location in the area between the mounting holes to run the air lines.
5. Drill a 2" to 3" diameter hole through the floor of the truck. Remove all burrs and sharp edges. Line the hole with the grommet material supplied.
6. Using the washers on the underside of the floor, attach the tower to the floor with 3/8" cap screws and lock nuts.

After the control tower has been mounted, the air lines can be routed. The air line tubing is color coded as follows:

- Blue - Tilt Cylinder Extend
- Green - Tilt Cylinder Retract
- Orange-Lift Cylinder Extend
- Yellow-Lift Cylinder Retract
- Red-PTO
- Black-Exhaust
- Silver-Supply
- Black-Rotate Clockwise
- Black-Rotate Counter-Clockwise

To remove an air line from a fitting, push the line in, hold the internal sleeve of the fitting, then pull the air line out.

1. Pass the air lines through the hole lined with grommet material in the floor.
2. Route the exhaust air line outside of the truck cab.
3. Determine a suitable route for the air lines to the control valve. Avoid sharp bends, sharp edges, and heat sources.
4. Connect Silver air line to chassis air supply.
5. Install supplied elbow fittings into air actuators.
6. Connect the air lines to the elbow fittings in the air actuators.
7. Bundle the air lines together and secure, out of the way.

Start-up Procedure

1. Charge the air system of the truck. Check all lines for leakage.
2. Operate the controllers and check for correct control valve movement.
3. After the correct connections have been made and the Stellar equipment completely installed, engage the PTO to check operation.

Install In-Cab Controls Continued...

B. Cable Control Installation

1. Remove the aluminum spring centering block from the valve spool:



2. Screw the threaded hub of the cable assembly all the way through the aluminum spring centering block as shown:



3. Thread the 1/4" jam nut onto the threaded end of the cable:



4. Screw the threaded end of the cable 3 turns into the end of the valve spool:



5. Tighten the jam nut:

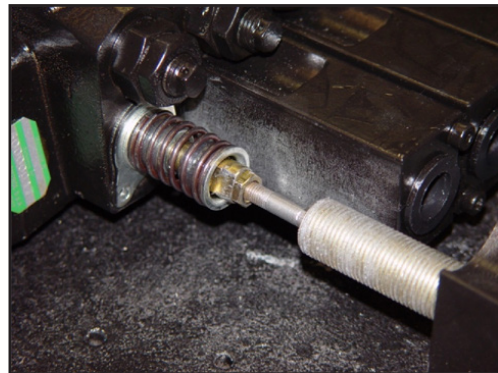

6. Rotate the outer cable assembly counter-clockwise to bring the aluminum spring centering block back over the spring:

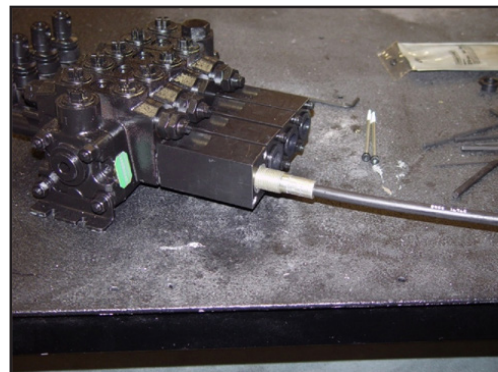

Install In-Cab Controls Continued...

7. Rotate the cable assembly counter-clockwise until approximately 1 and 1/4" of threads of the hub are showing:



8. Bolt the aluminum spring centering block back onto the valve bank:



9. Run the cable up through the hole in the cab floor and through the control tower. (Note: the cable must be connected to the controller while the controller is outside of the tower.)

10. Remove the bottom bolt from the control handle:



11. Push and hold the control handle so the

threaded receiver is visible. Simultaneously screw the threaded collet of the cable into the receiver of the control handle. If more cable slack is required, move the valve bank handle on the section that you are connecting:



12. Push the cable assembly into the control handle until the groove in the cable end is visible through the bottom hole in handle where the bolt was previously removed. Hold the cable end in place and reinstall the bolt and nut:

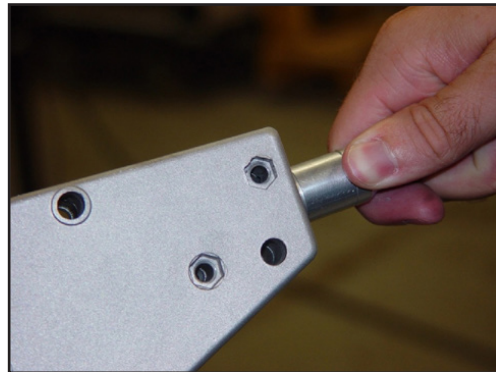

13. When complete, the spool and control handle should return to the neutral position when released. If adjustment is needed, the cable must be removed at the controller end and then rotated at the spool end to achieve the proper neutral position.

Controller Asm 3-Sect DVS10 96" 53815

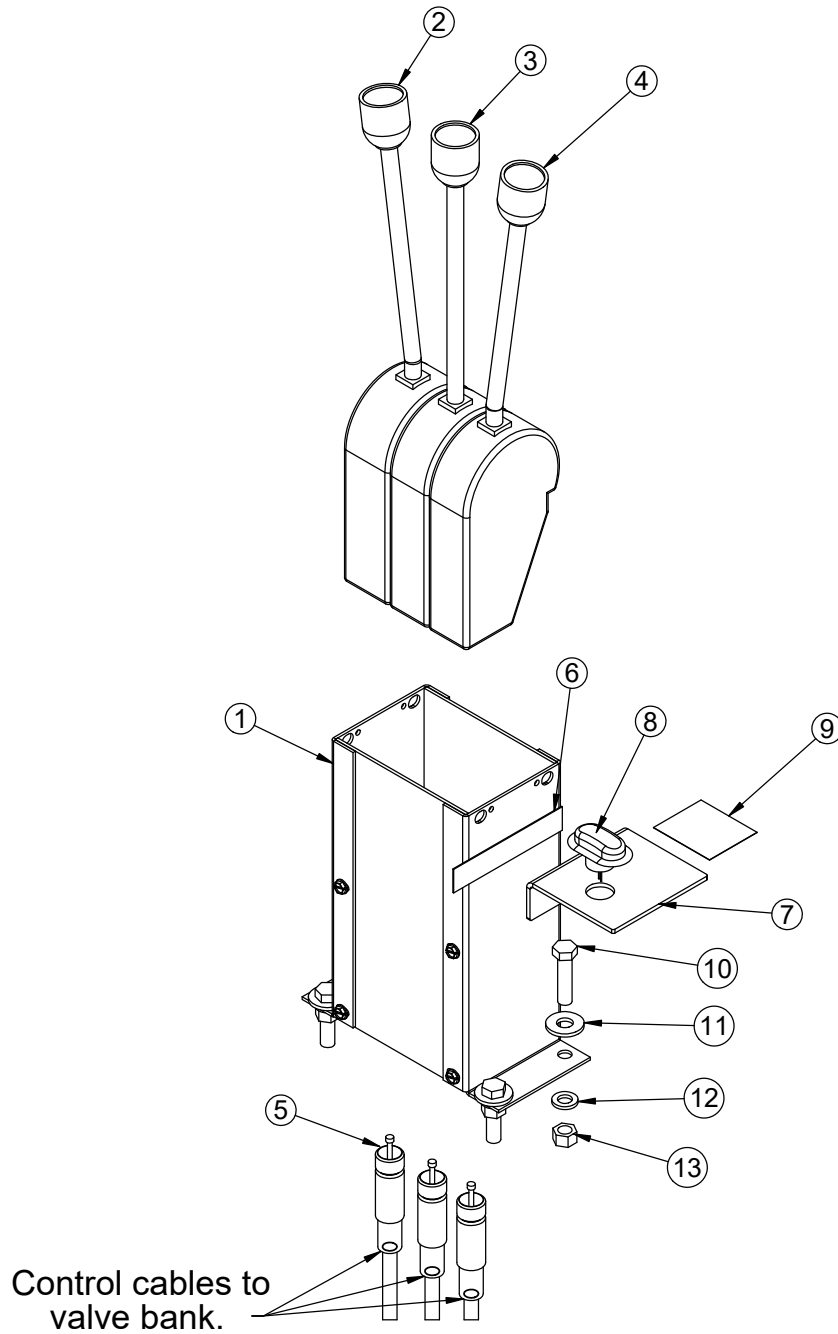

Controller Asm 3-Sect DVS10 96" 53815 Parts List

PN 53815			
ITEM	PART	DESCRIPTION	QTY
1	38351	VALVE CTRL CONSOLE 3LEVER RVC	1
2	47131	CONTROLLER LEFT BEND NO LOCK WESCON	1
3	45312	CONTROLLER STRAIGHT NO LOCK WESCON	1
4	46825	CONTROLLER RIGHT BEND NO LOCK WESCON	1
5	37471	CONTROL CABLE 96 IN WESCON	3
6	24857	TAPE DBL SIDE 45 MIL X.75WX4.00 LONG	1
7	54511	BRKT CONTROLLER DUMP UP LIGHT ECCR	1
8	45908	LIGHT CLEARANCE RED MICRO LED	1
9	57229	DECAL SICC INSIDE CONTROL 3 SECT	1
10	345	CAP SCR 0.38-16X1.50 HHGR5	4
11	346	WASHER 0.38 USS FLAT	4
12	523	WASHER 0.38 LOCK	4
13	535	NUT 0.38-16 HHGR5	4
REV. B			

NOTES:

45908 IS SHOWN FOR REFERENCE ONLY. IT IS INCLUDED IN KIT 52136.

57229 IS SHOWN FOR REFERENCE ONLY. IT IS INCLUDED IN KIT 52904.

ITEMS NOT SHOWN		
PART	DESCRIPTION	QTY
67319	CABLE KIT VALVE SECTION DVS10	3

Controller Asm 3-Sect DVS10 144" 60806

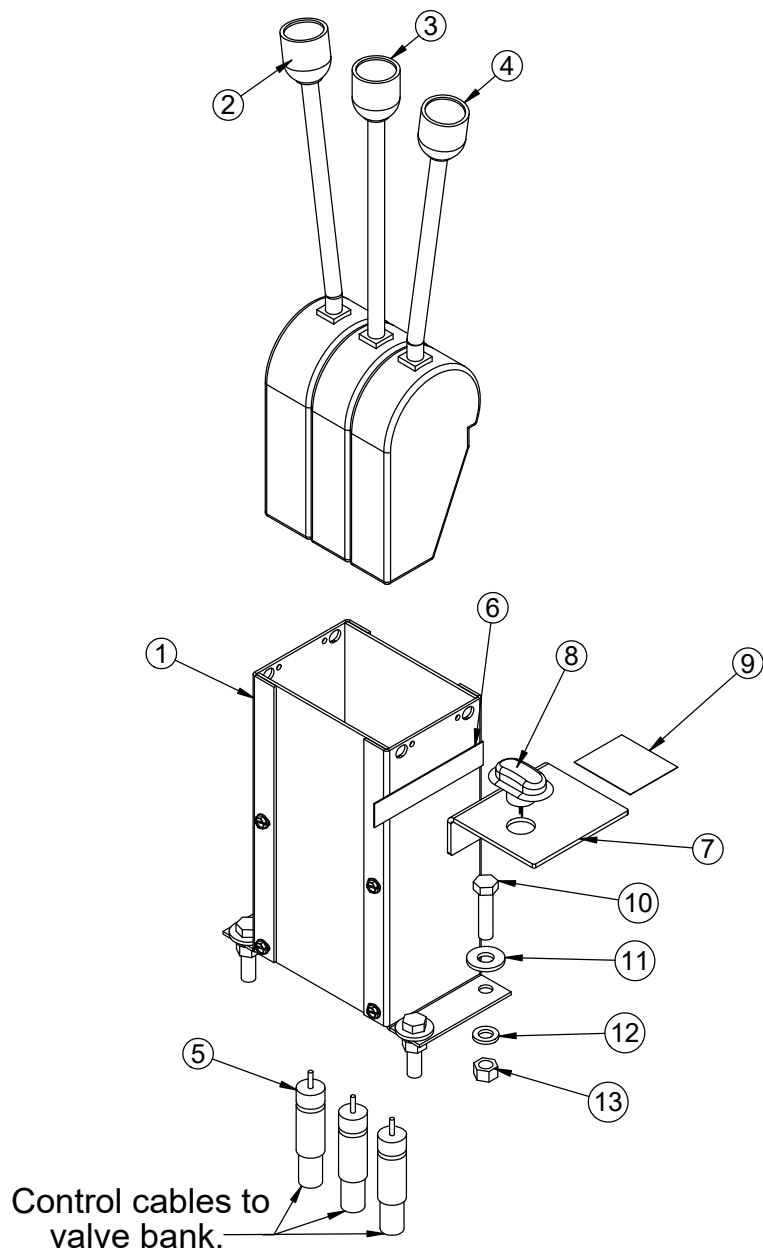

Controller Asm 3-Sect DVS10 144” 60806 Parts List

PN 60806			
ITEM	PART	DESCRIPTION	QTY
1	38351	VALVE CTRL CONSOLE 3LEVER RVC	1
2	47131	CONTROLLER LEFT BEND NO LOCK WESCON	1
3	45312	CONTROLLER STRAIGHT NO LOCK WESCON	1
4	46825	CONTROLLER RIGHT BEND NO LOCK WESCON	1
5	37472	CONTROL CABLE 144 IN WESCON	3
6	24857	TAPE DBL SIDE 45 MIL X.75WX4.00 LONG	1
7	54511	BRKT CONTROLLER DUMP UP LIGHT ECCR	1
8	45908	LIGHT CLEARANCE RED MICRO LED	1
9	57229	DECAL SICC INSIDE CONTROL 3 SECT	1
10	0345	CAP SCR 0.38-16X1.50 HHGR5	4
11	0346	WASHER 0.38 USS FLAT	4
12	0523	WASHER 0.38 LOCK	4
13	0535	NUT 0.38-16 HHGR5	4
REV. A			

NOTES:

45908 IS SHOWN FOR REFERENCE ONLY. IT IS INCLUDED IN KIT 52136.

57229 IS SHOWN FOR REFERENCE ONLY. IT IS INCLUDED IN KIT 52904.

ITEMS NOT SHOWN		
PART	DESCRIPTION	QTY
67319	CABLE KIT VALVE SECTION DVS10	3

Control Tower Asm 3-Section - 133982

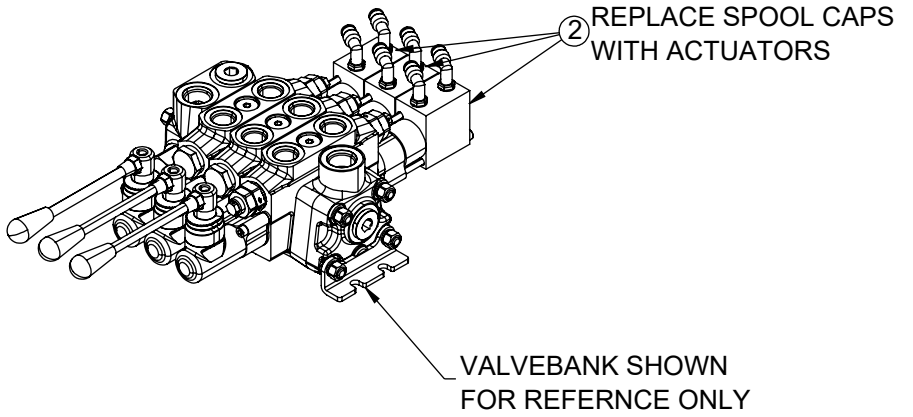
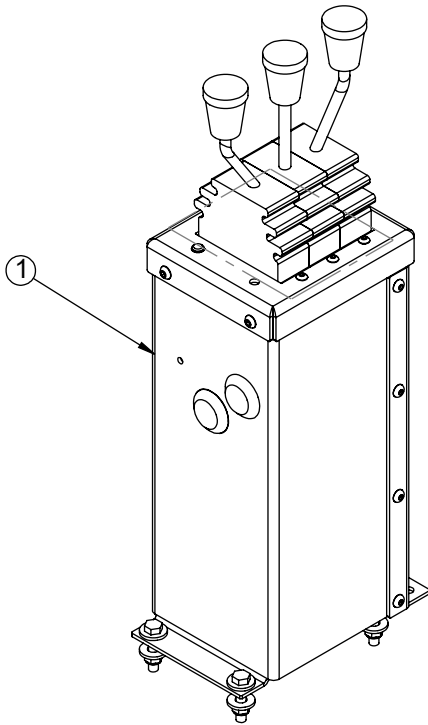

PN 133982			
ITEM	PART	DESCRIPTION	QTY
1	88651	CONTROL TOWER ASM 3-SECT CONTAINER CARRIER	1
2	64634	AIR ACTUATOR DVS10	1

Step 11: Install Hoist Up Light Kit

- A. Mount the remote switch (PN 45907) to the curb side vertical base tube using the 1/4" cap screws provided:

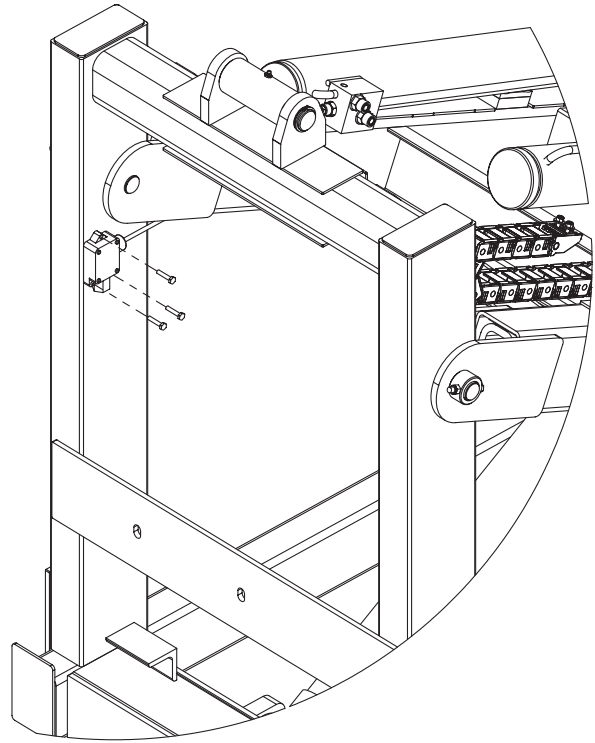

- B. For cable controller assemblies, the hoist up light will need to be installed onto the bracket:

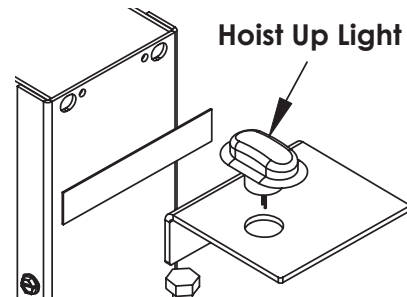

- C. Connect the female terminals of PN 45909 Pigtail to the hoist up light located on the controller assembly. Connect the other end of the pigtails as shown:

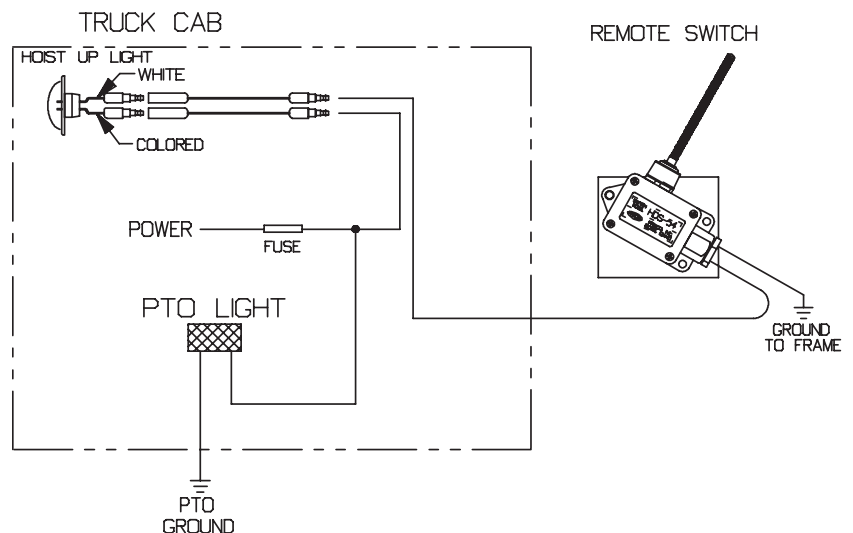

Step 12: Install bumper accessories.

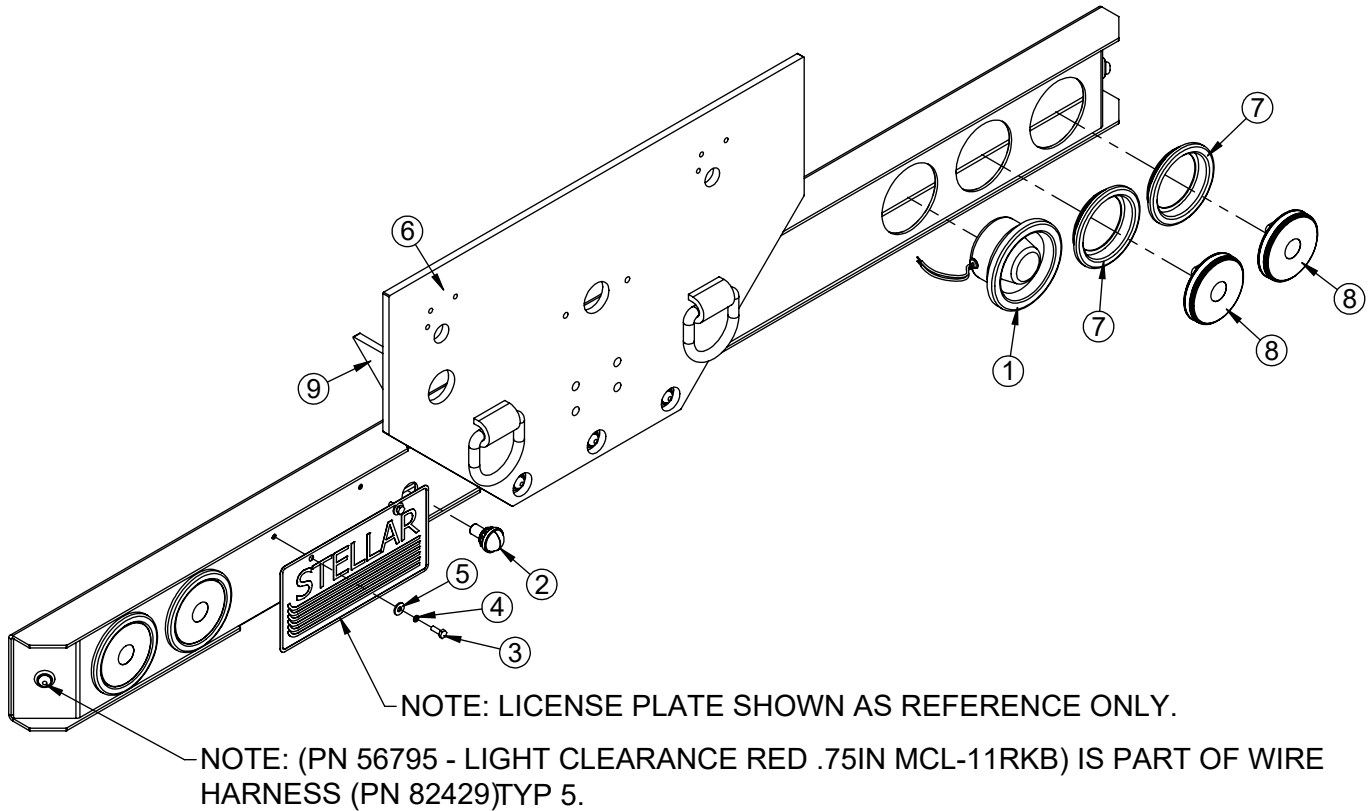

PN 89307

ITEM	PART	DESCRIPTION	QTY
1	18742	BACKUP ALARM ACORN 97 DECIBAL	1
2	2320	LICENSE PLATE LIGHT ROUND 430 W	1
3	0479	CAP SCR 0.25-20X0.75 HHGR5	2
4	0521	WASHER 0.25 LOCK	2
5	0340	WASHER 0.25 USS FLAT	2
6	81301	BUMPER FOR 16K PINTLE ECCR	1
7	82430	GROMMET 4.00 ROUND LAMP (GROTE)	4
8	82431	LIGHT STOP/TURN/TAIL/REV 4 RND GROTE LED	4
9	112272	GUSSET 0.50X4.00X4.00 W/HOLE	2

REV. E

ITEMS NOT SHOWN

PART	DESCRIPTION	QTY
82429	WIRE HARNESS FMV108 HOOK LOADER GEN2	1
85371	WIRE HARNESS FMVSS108 CHASSIS GEN2	1
0540	REFLECTOR 3.00 AMBER	2
0541	REFLECTOR 3.00 RED	2

Step 12: Install Bumper Accessories

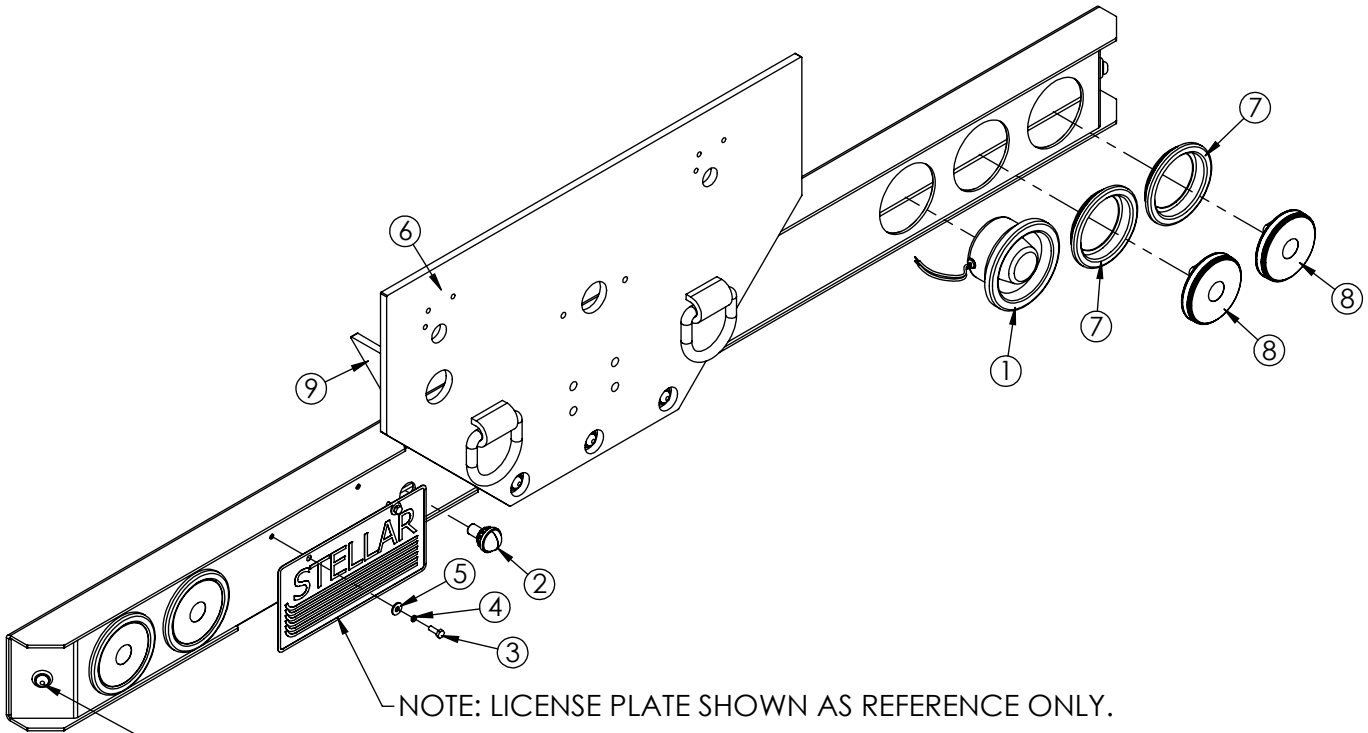

PN 81307

ITEM	PART	DESCRIPTION	QTY
1	18742	BACKUP ALARM ACORN 97 DECIBAL	1
2	2320	LICENSE PLATE LIGHT ROUND 430 W	1
3	0479	CAP SCR 0.25-20X0.75 HHGR5	2
4	0521	WASHER 0.25 LOCK	2
5	0340	WASHER 0.25 USS FLAT	2
6	81301	BUMPER FOR 30K PINTLE ECCR	1
7	82430	GROMMET 4.00 ROUND LAMP (GROTE)	4
8	82431	LIGHT STOP/TURN/TAIL/REV 4 RND GROTE LED	4
9	112272	GUSSET 0.50X4.00X4.00 W/HOLE	2

ITEMS NOT SHOWN

PART	DESCRIPTION	QTY
82429	WIRE HARNESS FMV108 HOOK LOADER GEN2	1
85371	WIRE HARNESS FMVSS108 CHASSIS GEN2	1
0540	REFLECTOR 3.00 AMBER	2
0541	REFLECTOR 3.00 RED	2

Step 13: Route Electrical

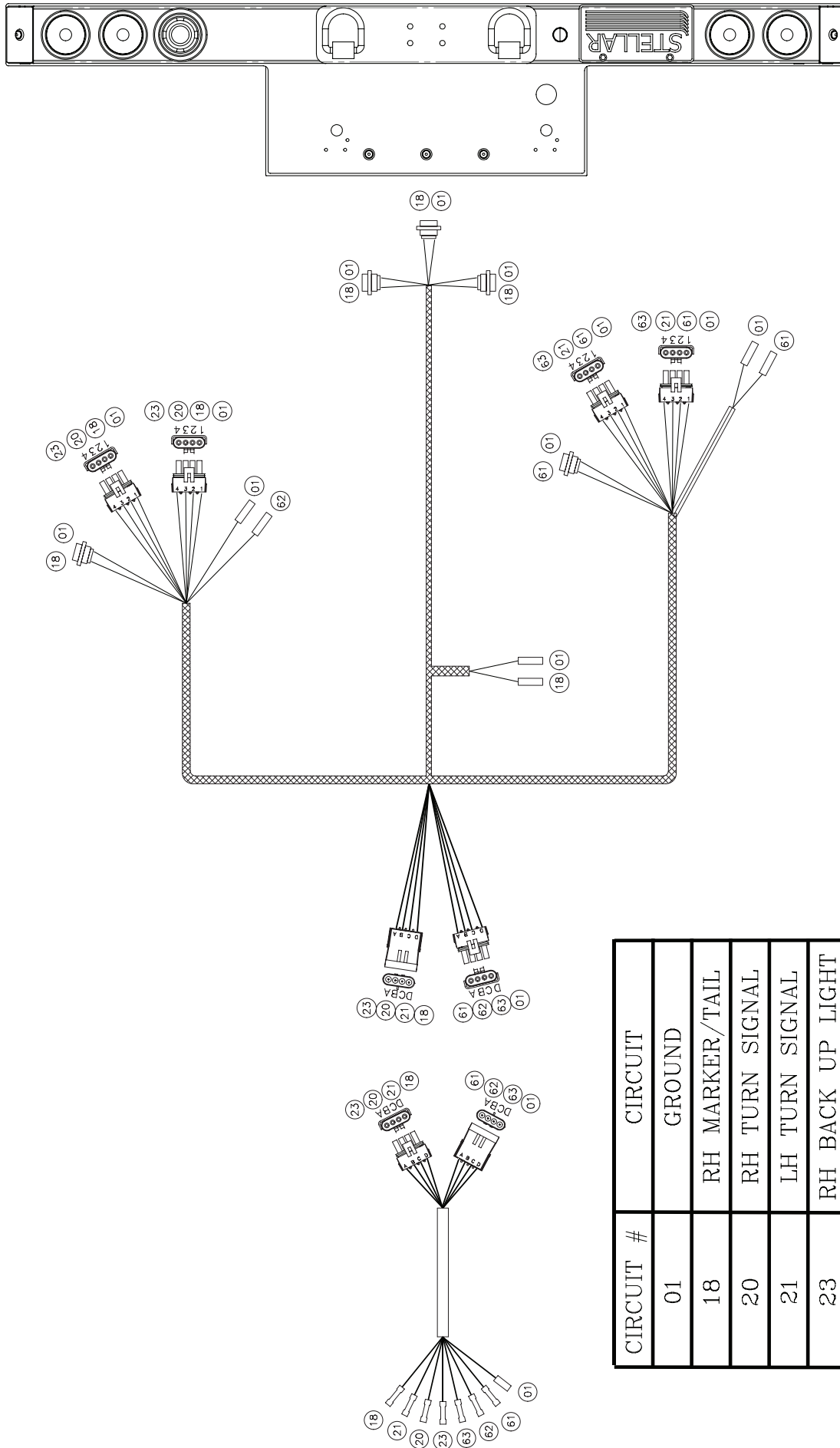

CIRCUIT #	CIRCUIT
01	GROUND
18	RH MARKER/TAIL
20	RH TURN SIGNAL
21	LH TURN SIGNAL
23	RH BACK UP LIGHT
61	LH MARKER/TAIL
62	BACK UP ALARM
63	LH BACK UP LIGHT

THIS PAGE LEFT INTENTIONALLY BLANK

Step 14: Install Fenders and Mud Flaps

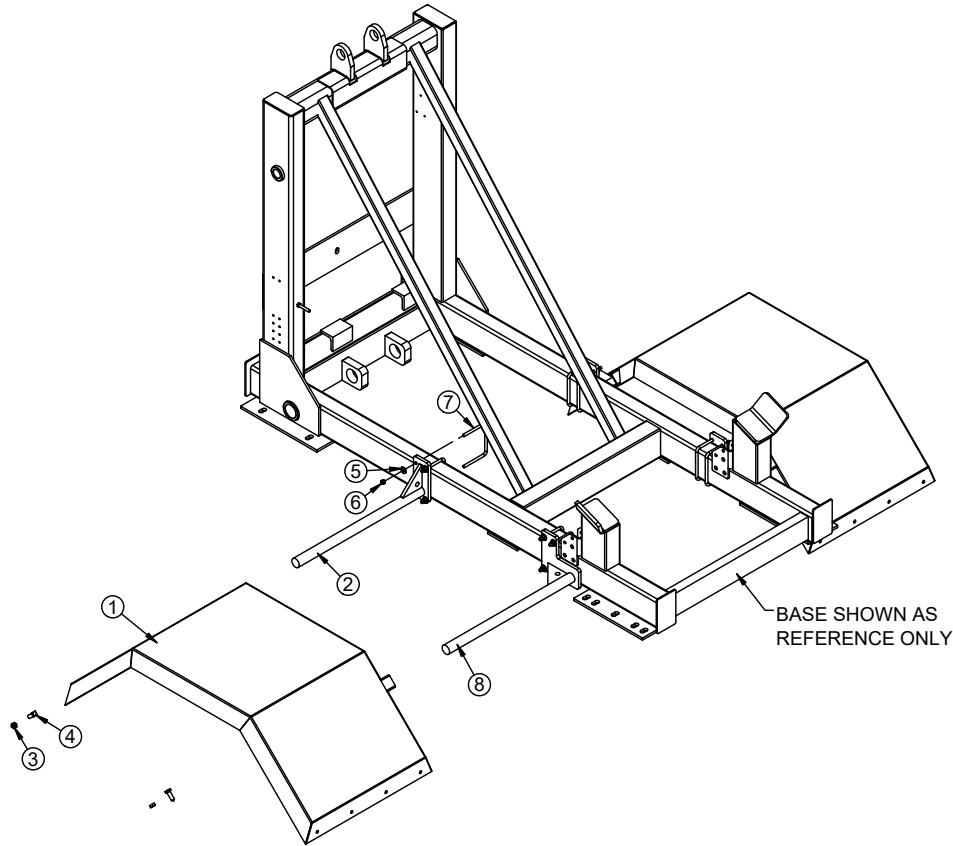

PN 46299

ITEM	PART	DESCRIPTION	QTY
1	46626	FENDER WLDMT STEEL SINGLE KPAC	2
2	46627	FENDER SUPPORT WELDMENT PC BLACK	2
3	0537	NUT 0.50-13 HH	4
4	46590	CAP SCR 0.50X1.50 SQ HD CP SS	4
5	0346	WASHER 0.38 USS FLAT	16
6	0347	NUT 0.38-16 HHGR5 NYLOC	16
7	77537	U BOLT 0.38X5.00X4.75	8
8	104586	FENDER SUPPORT WELDMENT REAR SS	1
9	104588	FENDER SUPPORT WELDMENT REAR CS	1

Step 15: Operate the Container Carrier

⚠ WARNING Stellar® Container Carrier operators must conform to the qualifications in the Operation section of this manual. Read and understand all documentation and safety signs before operating or servicing this equipment.

- Bleed the air out of the hydraulic system.
- Check the oil level and add oil if needed.
- Calibrate hoist up light.
- Be sure to check all clearances.
- Set/check relief pressure(See chart and steps on the following page).

Setting System Relief Pressure

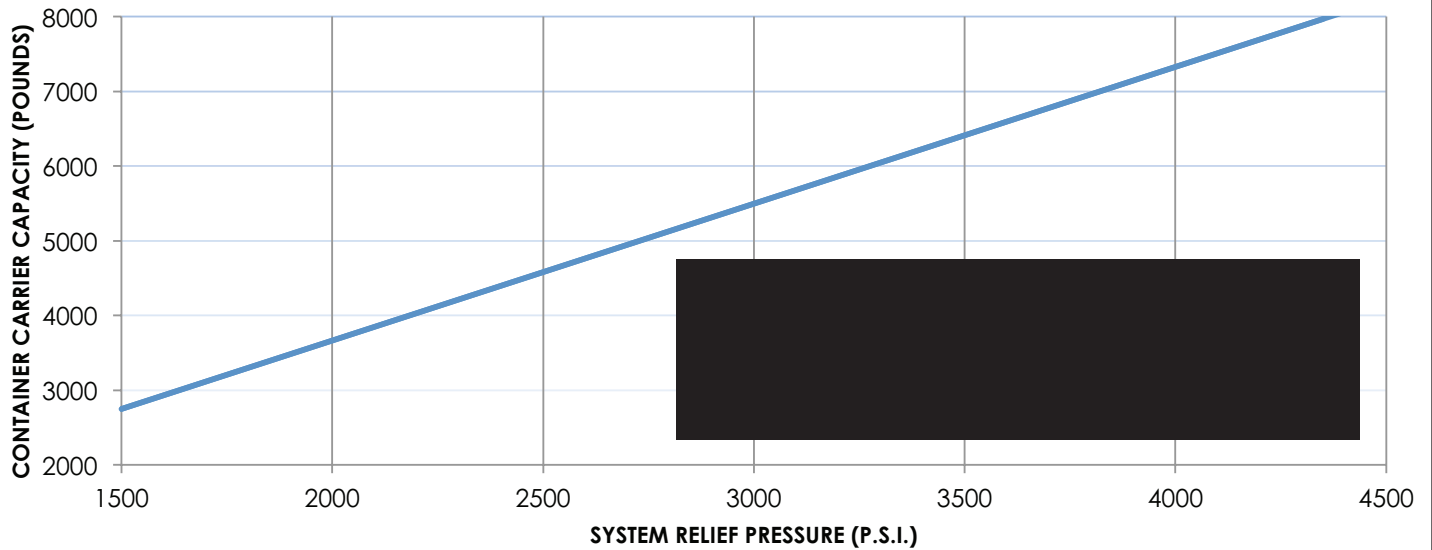

1. Engage the PTO. Run the PTO at 1200 RPM.
2. Push the control lever labeled 'lift' until the boom bottoms out. Keep pushing the lever forward until the pressure is set.
3. Release the jam nut using a 13 mm wrench.

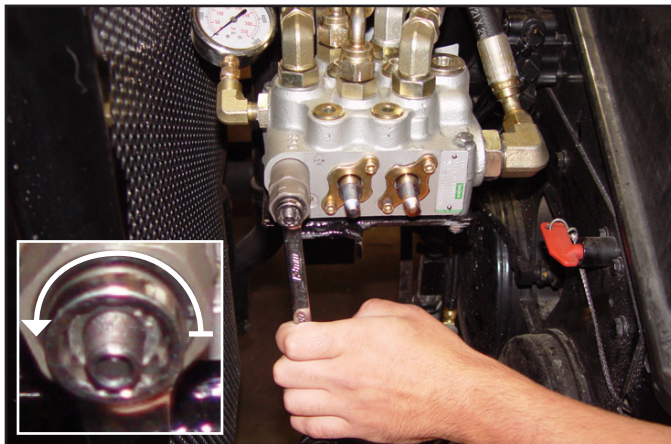

5. Once system pressure is set, tighten the jam nut to lock system pressure. Permanent thread lock should not be used:

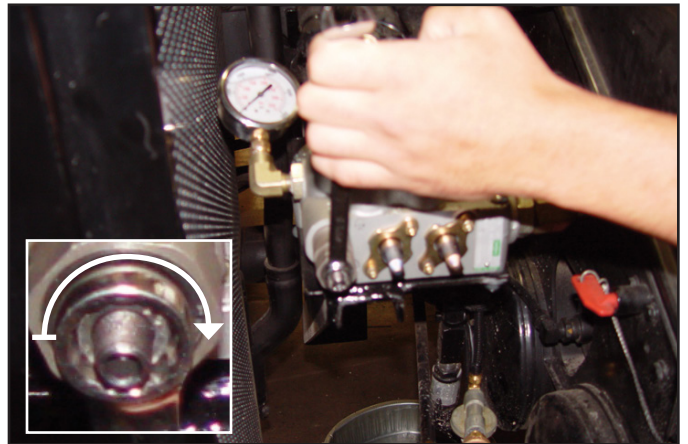

4. Adjust the system relief pressure using 4 mm allen wrench. Clockwise increases pressure, counter clockwise decreases pressure:

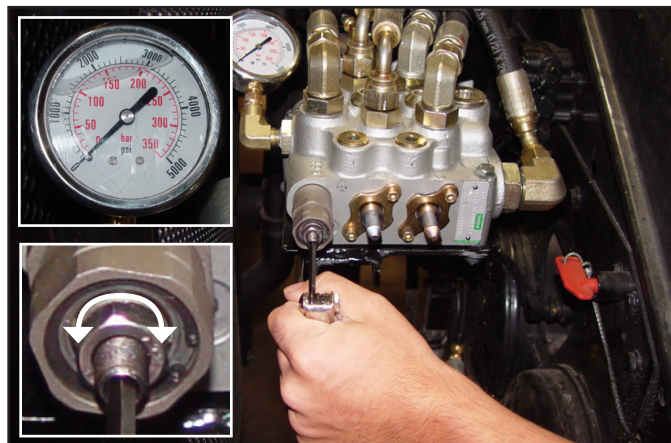

6. Release all functions and disengage the PTO. Snap tamper cap into position over the jam nut. The break away clip will be destroyed if the cap is removed:

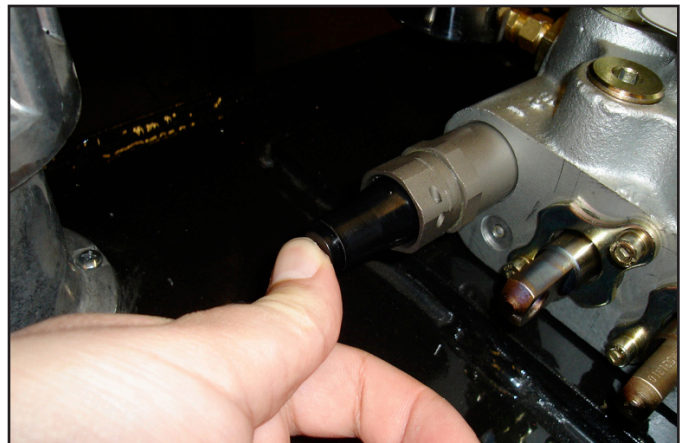

Step 16A: Apply Carrier Decals

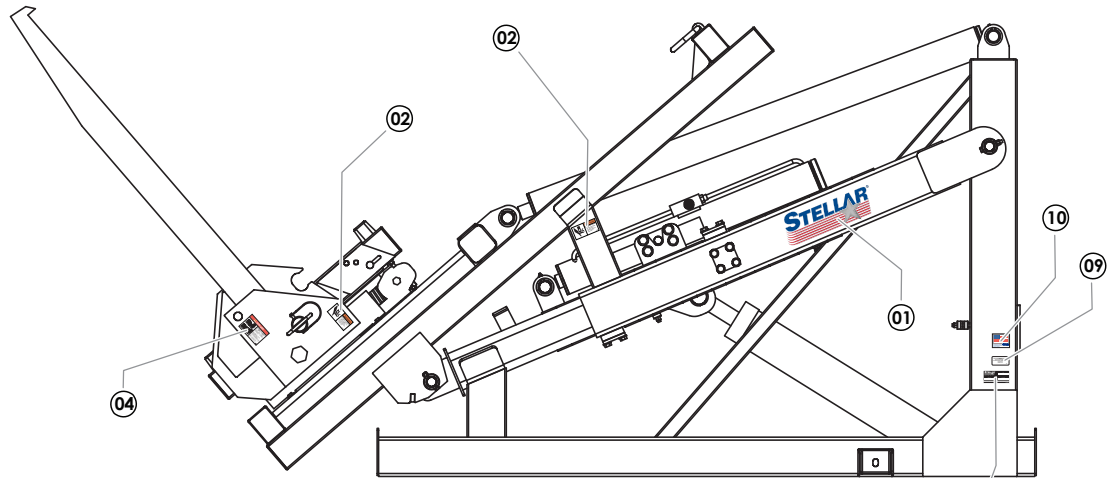

Last Revision

Rev Level: J

Date: 08/16/21

Changes: Separate chassis decals from carrier assembly decals.

SELECT APPROPRIATE DECAL AND PLACE NEAR VALVE BANK, DISCARD THE OTHER TWO

SERIAL PLATE (C5942) NOT INCLUDED WITH DECAL KIT

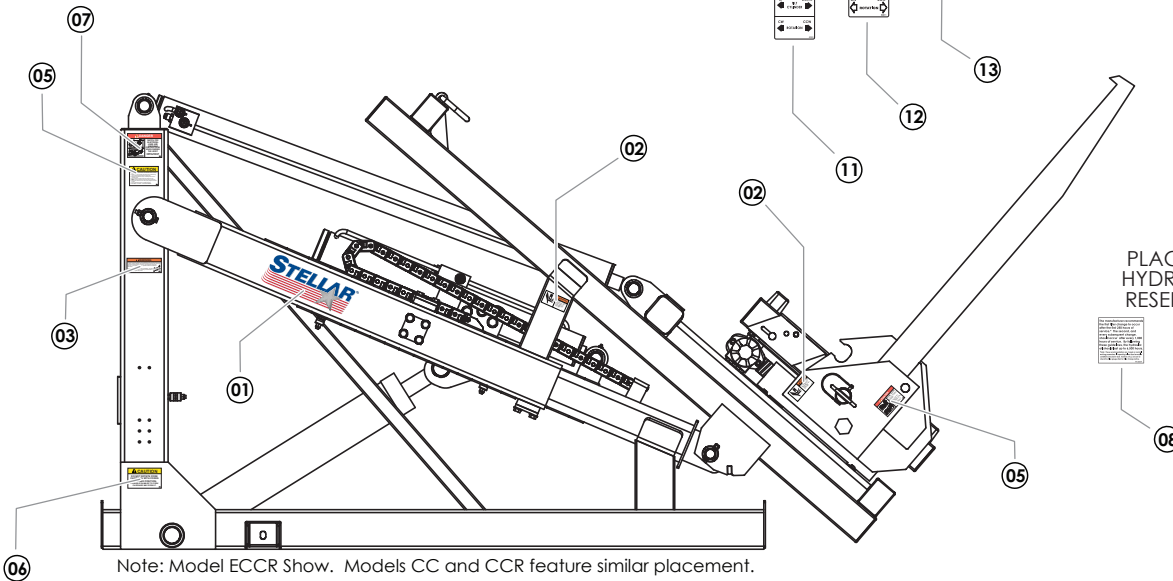
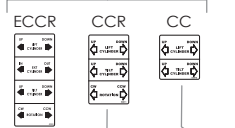

Note: Model ECCR Show. Models CC and CCR feature similar placement.

PN 52904

ITEM	PART No.	DESCRIPTION	QTY.
01	53850	DECAL STELLAR LOGO 4.00X11.50	2
02	25627	DECAL CRUSH POINT	4
03	45726	DECAL WARNING HYDRAULIC SAFETY 74-276	1
04	45971	DECAL DNGRSTAND CLEAR, KPCC 74-346	2
05	45974	DECAL CAUTION-OPERATING INSTR 74-345	1
06	45975	DECAL CAUTION-FORK CARRIAGE K74-328	1
07	45976	DECAL DNGR WATCH ELEC LINES K74-347	1
08	42971	DECAL OIL FILTER CHANGE	1
09	4214	DECAL CONTACT STELLAR	1
10	35234	DECAL STELLAR MADE IN THE USA	1
11	52903	DECAL VB CONTROL 4 SECT	1
12	53811	DECAL VB CONTROL 3 SECT	1
13	53812	DECAL VB CONTROL 2 SECT	1

Step 16B: Apply Chassis Decals

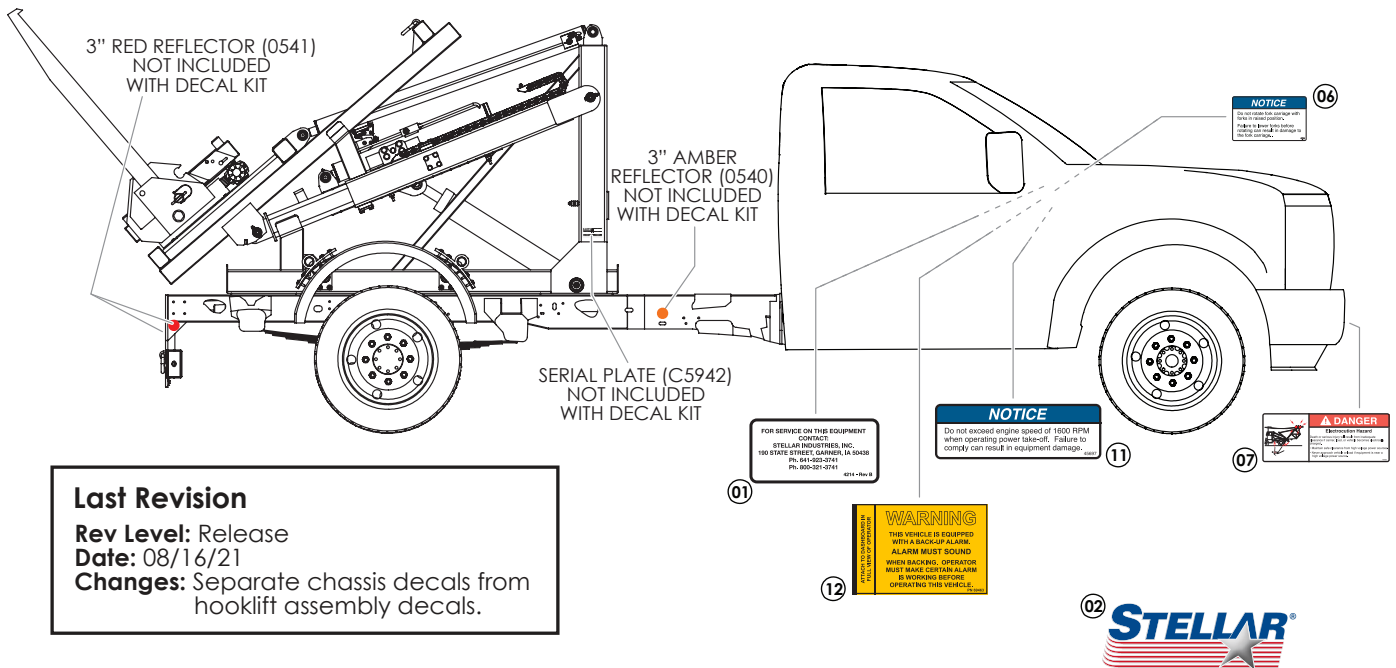

Last Revision
Rev Level: Release
Date: 08/16/21
Changes: Separate chassis decals from hooklift assembly decals.

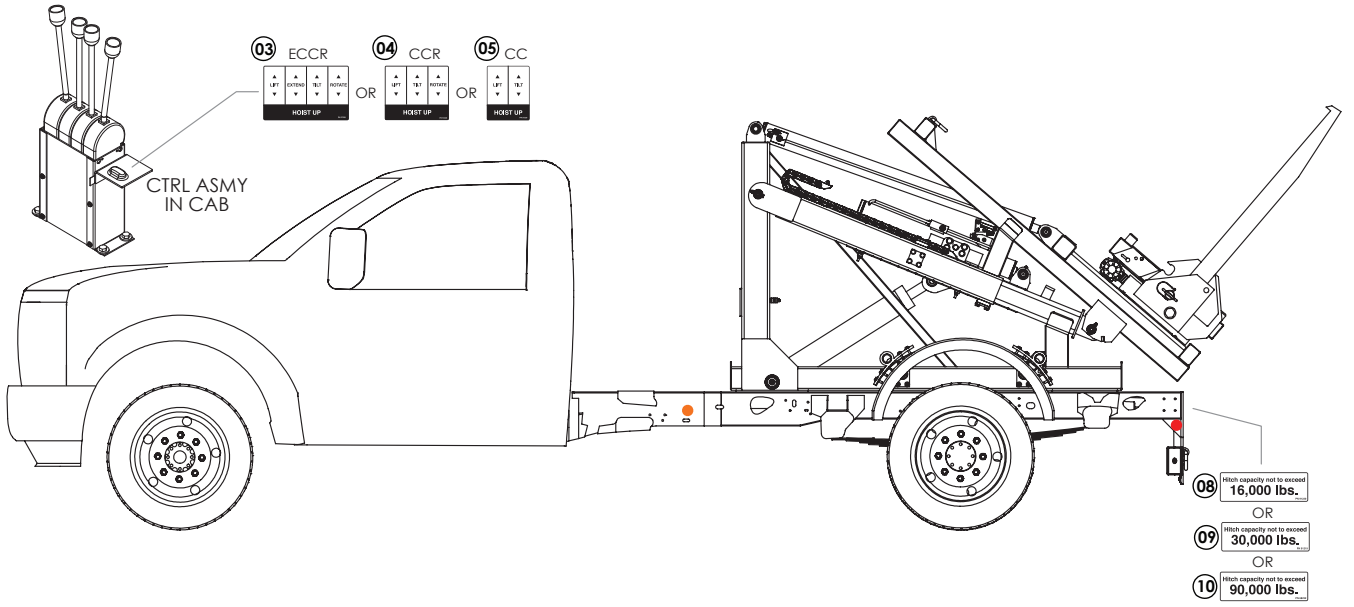

PN 121014

ITEM	PART No.	DESCRIPTION	SUGGESTED LOCATION	QTY.
01	4214	DECAL CONTACT STELLAR	IN CAB	1
02	53850	DECAL STELLAR LOGO 4.00X11.50	SHIPPED LOOSE - OPTIMAL PLACEMENT	1
03	57228	DECAL INSIDE CONTROL 4 SECT] SELECT APPROPRIATE CONTROL DECAL; PLACE NEAR CONTROLS IN CAB; DISCARD OTHERS	1
04	57229	DECAL INSIDE CONTROL 3 SECT		1
05	57230	DECAL INSIDE CONTROL 2 SECT		1
06	45975	DECAL CAUTION-FORK CARRIAGE K74-328	IN CAB	1
07	79985	DECAL DANGER ELECTROCUTION	FRONT BUMPER - STREET SIDE OR REAR BUMPER - CURB SIDE	1
08	91220	DECAL HITCH CAPACITY 16K] SELECT APPROPRIATE CAPACITY; REAR BUMPER - ABOVE PINTLE LOCATION; DISCARD OTHERS	1
09	91219	DECAL HITCH CAPACITY 30K		1
10	68222	DECAL HITCH CAPACITY 90K		1
11	45697	ENGINE SPEED PTO CAUTION	IN CAB	1
12	69463	DECAL BACK-UP ALARM VERIFY	IN CAB	1

This page left intentionally blank.

Chapter 3 - Assembly Drawings

CHAPTER CONTENTS

Base Assembly - PN 53392	34
Base Assembly - PN 53392 Part List	35
Lift Cylinder Assembly - PN 23462.....	36
Lift Cylinder Assembly - PN 23462 Parts List.....	37
Base Asm 18" Drop Forks - PN 130151	38
18" Drop Forks	38
Base Asm 18" Drop Forks - PN 130151 Parts List.....	39
Lift Cyl Asm 18" Drop Forks - PN 130152	40
Lift Cyl Asm 18" Drop Forks - PN 130152 Parts List.....	41
Tilt Cylinder Assembly - PN 53242.....	42
Tilt Cylinder Assembly - PN 53242 Parts List.....	43
Lift Frame Assembly - PN 52927	44
Lift Frame Assembly - PN 52927 Parts List	45
Lift Frame Asm 18" Drop Forks - PN 130241.....	46
Lift Frame Asm 18" Drop Forks - PN 130241 Parts List.....	47
Extendable Fork Frame Assembly - PN 57775	48
Extendable Fork Frame Assembly - PN 57775 Parts List.....	49
Adjustable Fork Frame Assembly - PN 58145	50
Adjustable Fork Frame Assembly - PN 58145 Parts List.....	51
Fork Frame Assembly - PN 51308.....	52
Fork Frame Assembly - PN 51308 Part List.....	53
Fork Frame Assembly 8" Drop Forks - PN 67322	54
Fork Frame Assembly 8" Drop Forks - PN 67322 Parts.....	55
Fork Frame Asm 18" Drop Forks - PN 79374	56
Fork Frame Asm 18" Drop Forks - PN 79374 Parts List	57
RSRVR ASM 10 Gal BLKHD 3-Sect - 134276.....	58
RSRVR ASM 10 Gal BLKHD 3-Sect - 134276 Parts	59
RSRVR Assembly VB Detail - 134276	60
RSRVR Assembly Decal Brkt Detail - 134276	61
RSRVR Assembly Port Tubes - 134276.....	62
Air Actuator DVS10 - PN 64634	63
Cable Kit DVS10 - PN 67319	63
Reservoir Assembly - PN 98545	64
Reservoir Assembly - PN 98545 Parts List	65
Fender Kit Assembly - PN 80045	66
Fender Kit Assembly - PN 80045 Parts List.....	67

Base Assembly - PN 53392

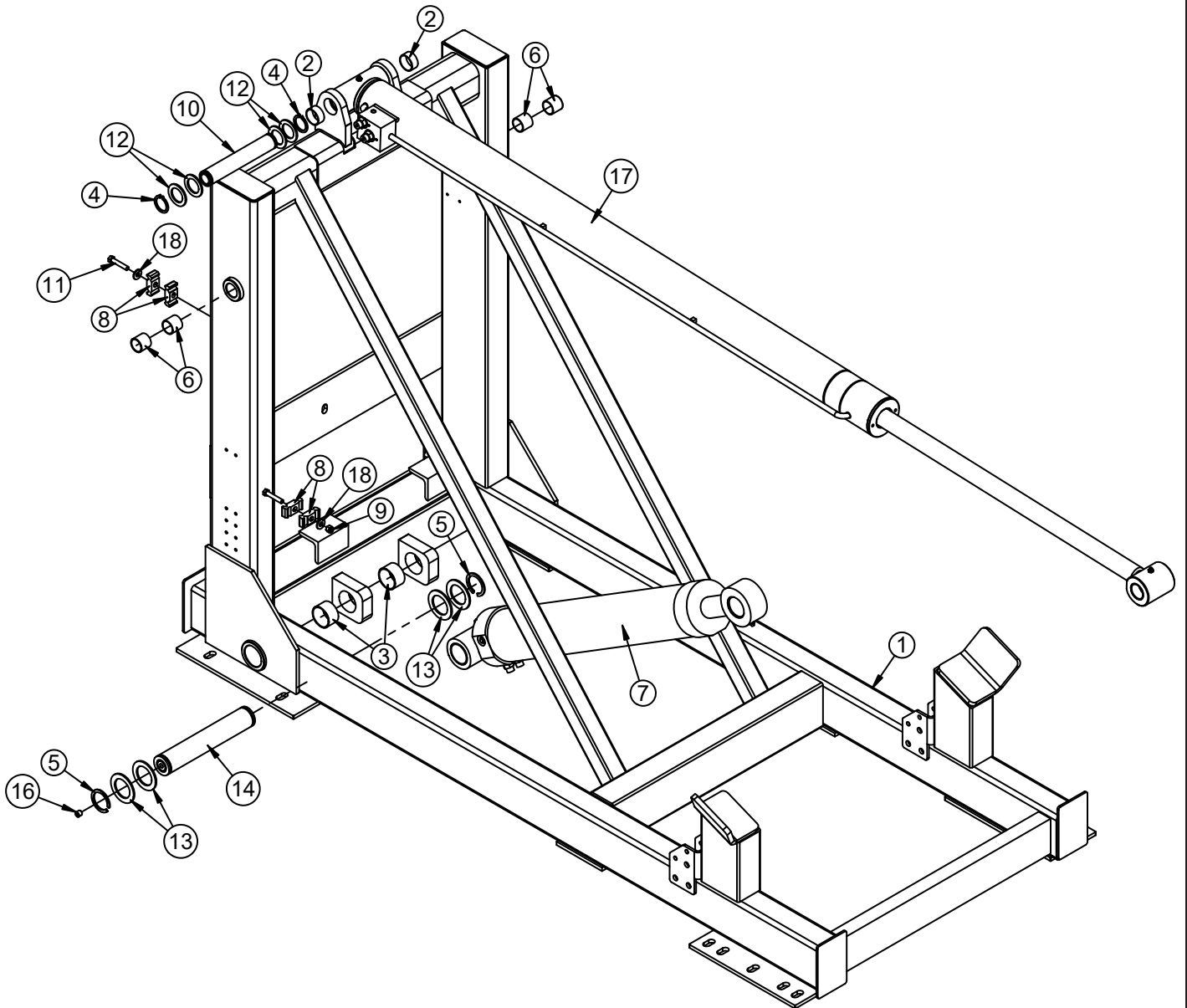

Base Assembly - PN 53392 Part List

PN 53392			
ITEM	PART	DESCRIPTION	QTY
1	51222	BASE ECCR	1
2	21810	BUSHING BPC24DXR12 1.50X.75	2
3	23699	BUSHING BPC32DXR20 2.00X1.25	2
4	0246	SNAP RING ID 7200 150	2
5	0108	SNAP RING 2.00 7200-200	2
6	0249	BUSHING BPC20DXR20 1.25X1.25	4
7	23462	CYLINDER ASM 4.00X26.50	1
8	8622	CLAMP HOSE/TUBE AG-2	6
9	0347	NUT 0.38-16 HHGR5 NYLOC	2
10	35808CR	PIN 1.50X8.75 SR ZC	1
11	0353	CAP SCR 0.38-16X2.00 HHGR5	1
12	0426	MACHY WASHER 1.50ID 10GA	4
13	0427	MACHY WASHER 2.00ID 10GA	4
14	38833CR	PIN 2.00X11.38 SR ZC	1
15	C3397	SET SCREW 0.38-16X0.38 W/ RED PATCH	1
16	58052	SET SCREW 0.50-13X0.50 W/ RED PATCH	1
17	53242	CYLINDER ASM 3.50X24.81	1
18	0346	WASHER 0.38 USS FLAT	2

Lift Cylinder Assembly - PN 23462

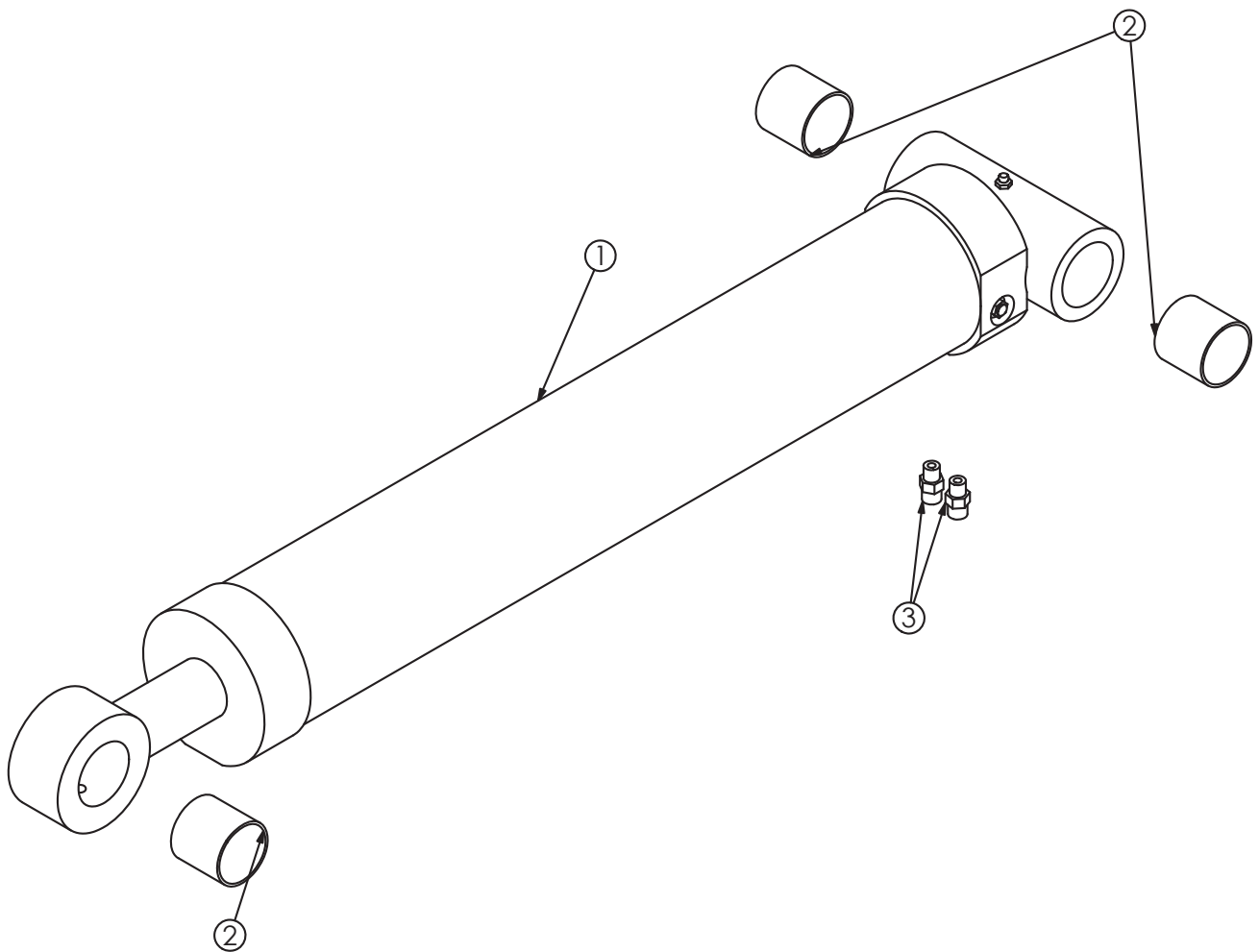

Lift Cylinder Assembly - PN 23462 Parts List

PN 23462			
ITEM	PART	DESCRIPTION	QTY
1	0822	CYLINDER 4.00X26.00	1
2	4381	BUSHING 32DXR32 2.00X2.00 GARLOCK	3
3	C1854	FTG 6-8 MFS-MORB STRAIGHT	2

NOTE:
BUSHINGS SHOWN AS REFERENCE

Base Asm 18" Drop Forks - PN 130151

18" Drop Forks

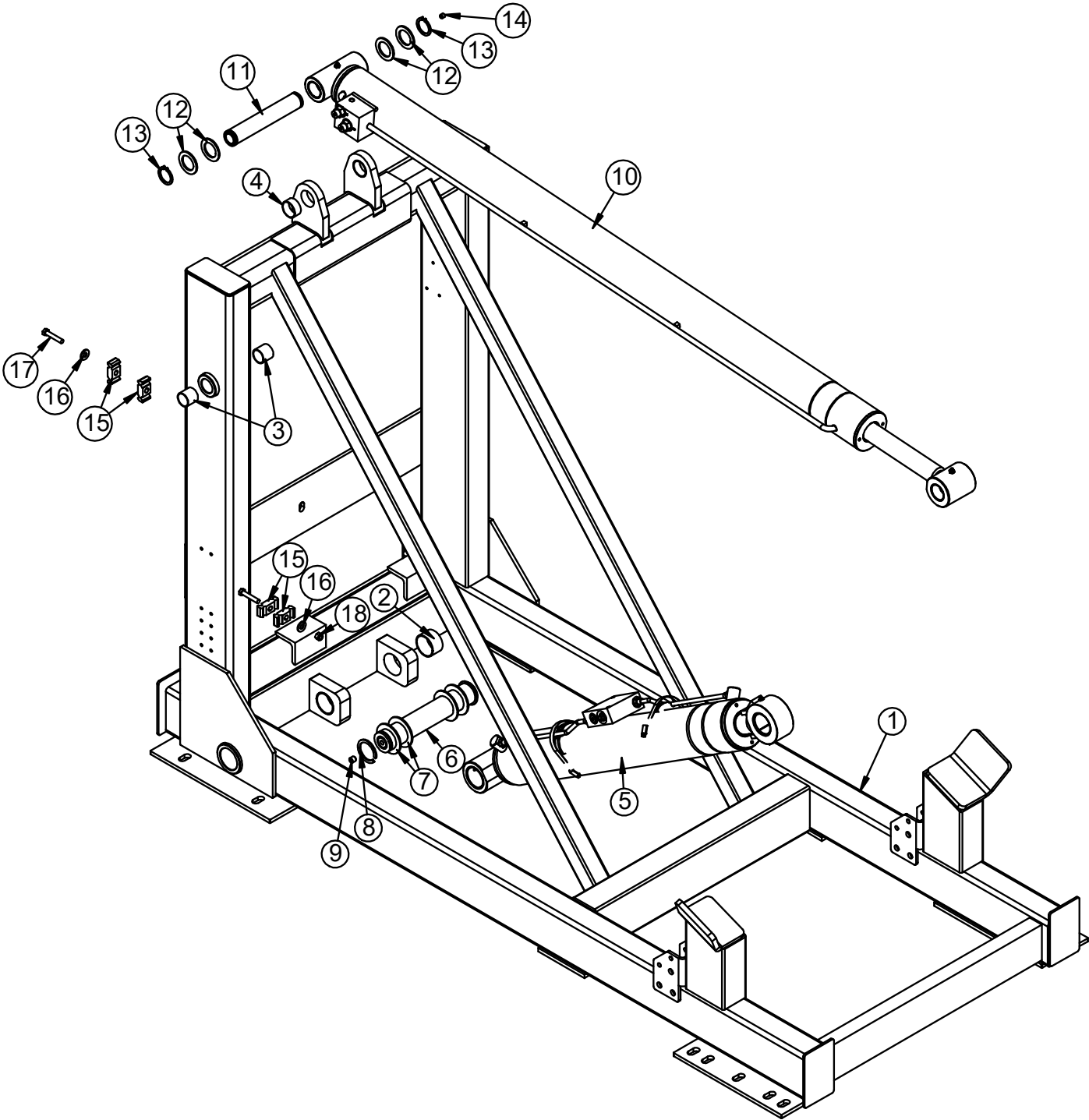

Base Asm 18” Drop Forks - PN 130151 Parts List

PN 130151 18” Drop Forks			
ITEM	PART	DESCRIPTION	QTY
1	51222	BASE ECCR	1
2	23699	BUSHING BPC32DXR20 2.00X1.25	2
3	0249	BUSHING BPC20DXR20 1.25X1.25	4
4	21810	BUSHING BPC24DXR12 1.50X.75	2
5	130152	CYLINDER ASM 4.00X30.00	1
6	38833CR	PIN 2.00X11.38 SR ZC	1
7	0427	MACHY WASHER 2.00ID 10GA	4
8	0108	SNAP RING 2.00 7200-200	2
9	58052	SET SCREW 0.50-13X0.50 W/ RED PATCH	1
10	53242	CYLINDER ASM 3.50X24.81	1
11	35808CR	PIN 1.50X8.75 SR ZC	1
12	0426	MACHY WASHER 1.50ID 10GA	4
13	0246	SNAP RING ID 7200 150	2
14	C3397	SET SCREW 0.38-16X0.38 W/ RED PATCH	1
15	8622	CLAMP HOSE/TUBE AG-2	6
16	0346	WASHER 0.38 USS FLAT	2
17	0353	CAP SCR 0.38-16X2.00 HHGR5	1
18	0347	NUT 0.38-16 HHGR5 NYLOC	2

Lift Cyl Asm 18" Drop Forks - PN 130152

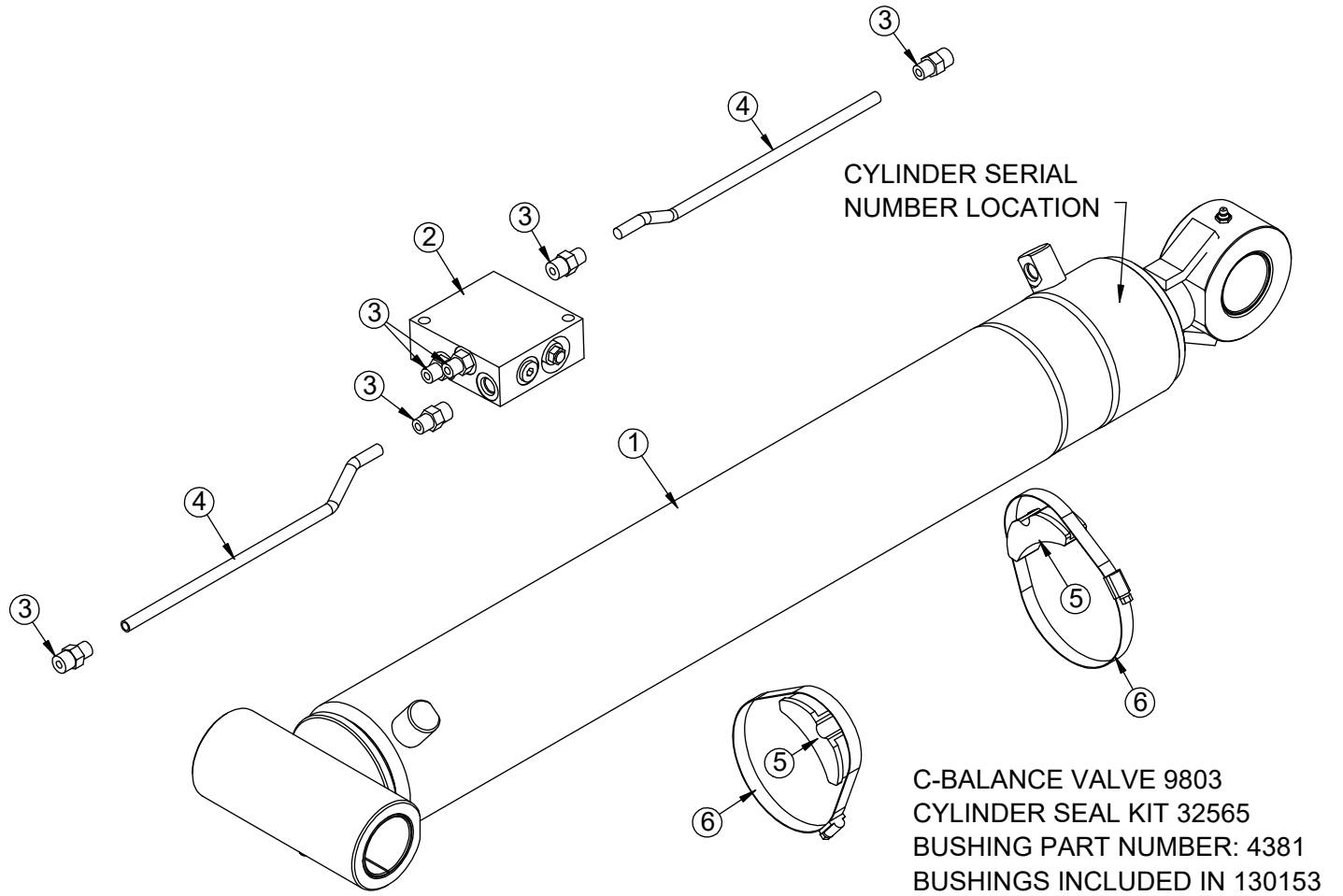

Lift Cyl Asm 18” Drop Forks - PN 130152 Parts List

PN 130152 18” DROP FORKS			
ITEM	PART	DESCRIPTION	QTY
1	130153	CYLINDER 4.00X30.00	1
2	16154	MANIFOLD DOUBLE T11A 3500 PSI	1
3	0279	FTG 6-6 MFS-MORB STRAIGHT	6
4	79380	TUBE ASM 0.38X11.89 ZC	2
5	18701	CLAMP PORT TUBE ZR518	2
6	19369	HOSE CLAMP 4.13-7.00 5416K38	2

Tilt Cylinder Assembly - PN 53242

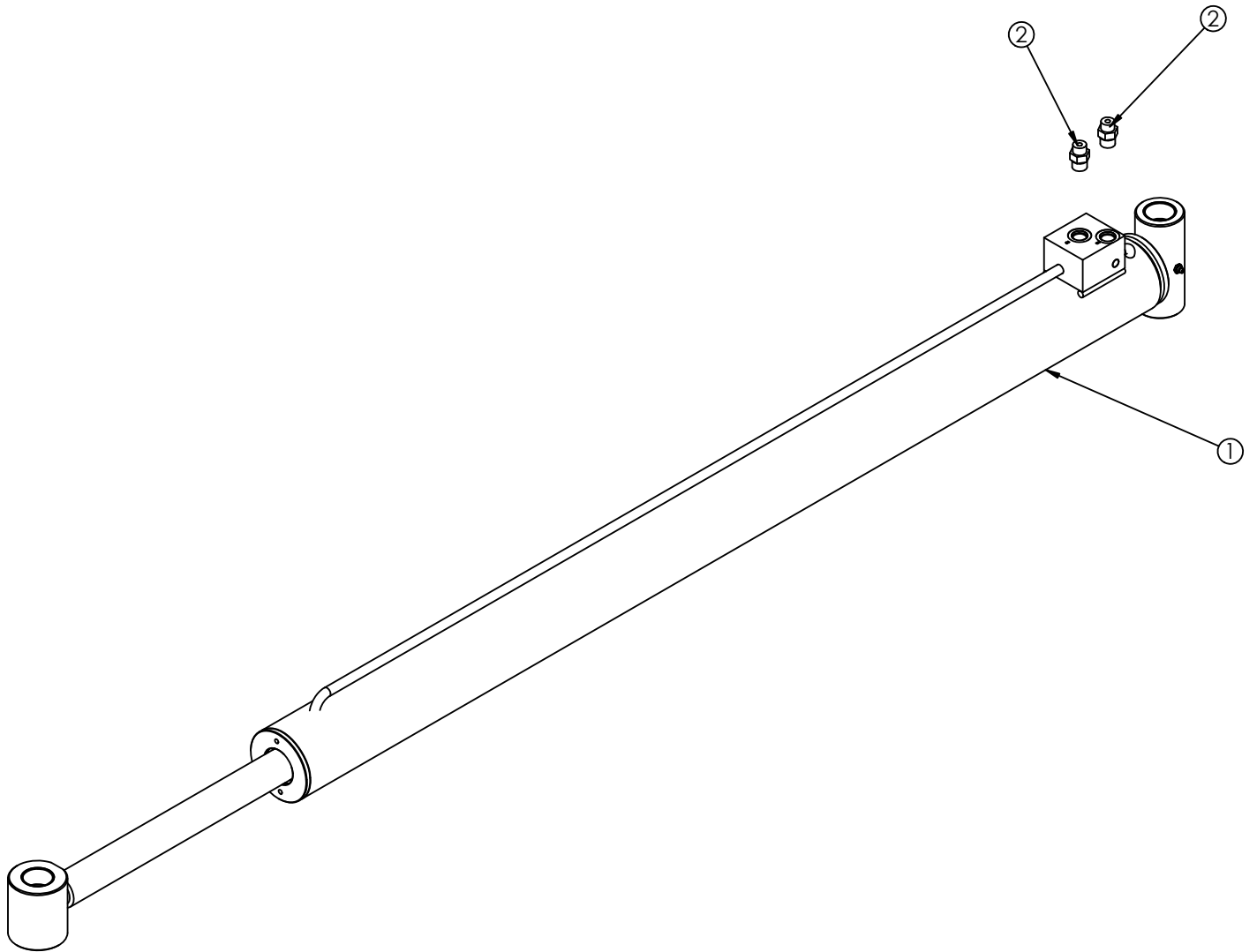

Tilt Cylinder Assembly - PN 53242 Parts List

PN 53242			
ITEM	PART	DESCRIPTION	QTY
1	53391	CYLINDER 3.50X24.81	1
2	C1854	FTG ADAPT 6-8 F-5OLO-S	2

NOTES:

THIS CYLINDER USES STELLAR SEAL KIT PN 52907

Lift Frame Assembly - PN 52927

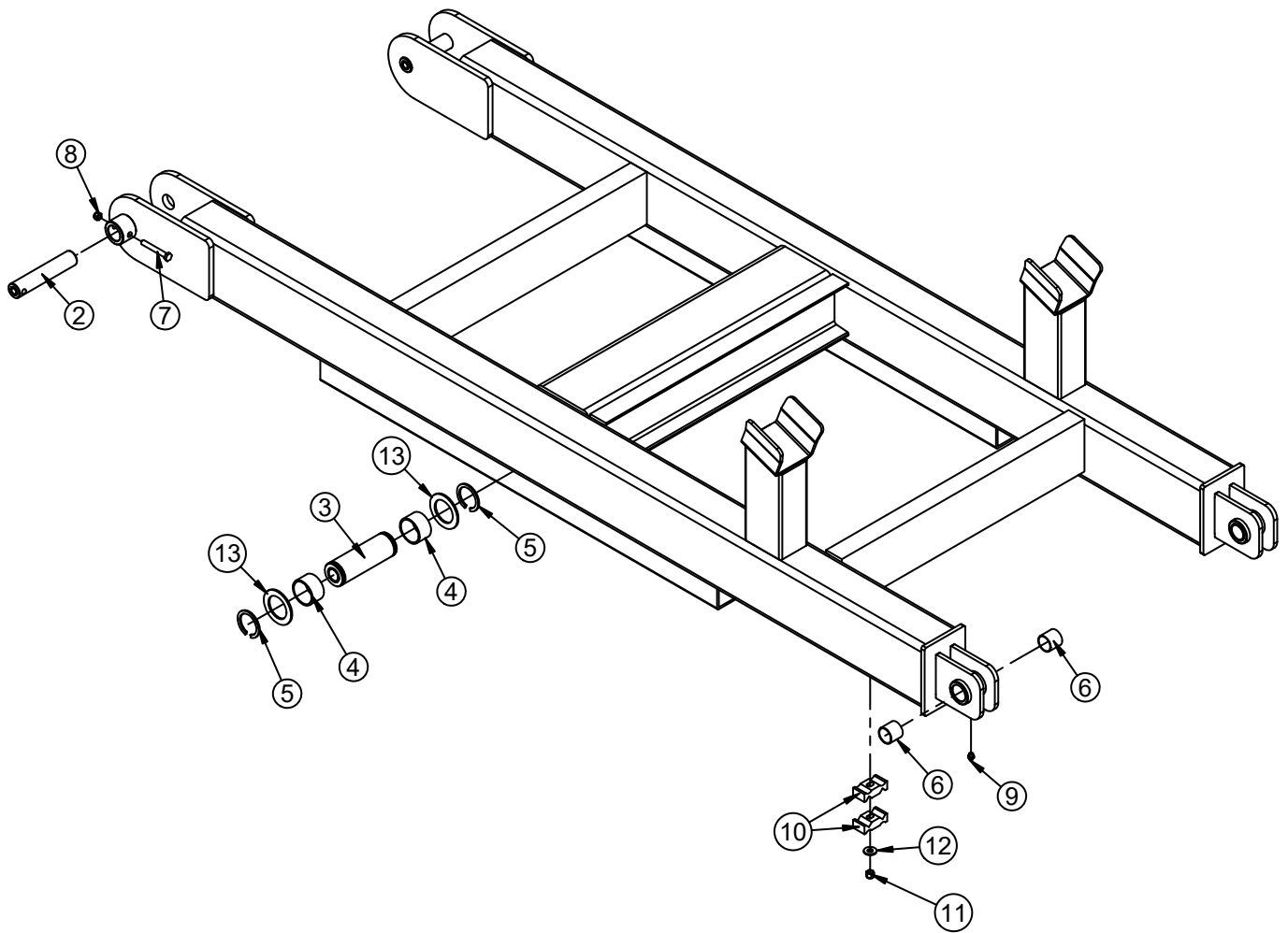

Lift Frame Assembly - PN 52927 Parts List

PN 52927			
ITEM	PART	DESCRIPTION	QTY
1	52923	LIFT FRAME CCR	1
2	51391CR	PIN 1.25X6.38 W/HOLE	2
3	51392CR	PIN 2.00X6.00 SR	1
4	23699	BUSHING 32DXR20 2.00X1.25	2
5	108	SNAP RING 2.00 7200-200	2
6	249	BUSHING BPC-2022-20 1.25X1.25	4
7	530	CAP SCR 0.38-16X2.75 HHGR5	2
8	347	NUT 0.38-16 HH NYLOC	2
9	C1592	ZERK 1/8 NPT STRAIGHT	2
10	8621	CLAMP HOSE/TUBE AG-3	2
11	347	NUT 0.38-16 HHGR5 NYLOC	1
12	346	WASHER 0.38 USS FLAT	1
13	427	MACHY WASHER 2.00ID 10GA	2

Lift Frame Asm 18" Drop Forks - PN 130241

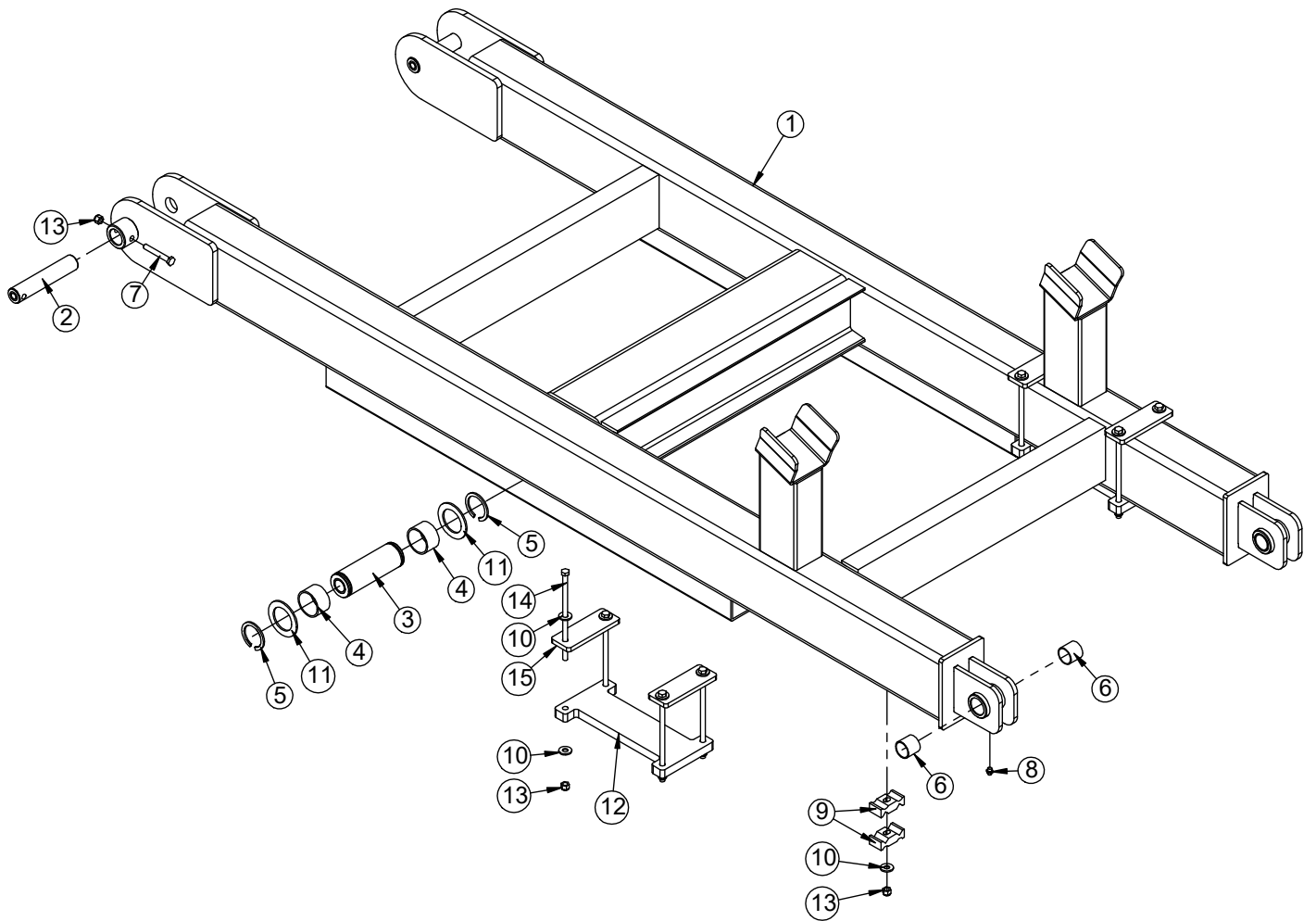

Lift Frame Asm 18” Drop Forks - PN 130241 Parts List

PN 130241 18” DROP FORKS			
ITEM	PART	DESCRIPTION	QTY
1	52923	LIFT FRAME CCR	1
2	51391CR	PIN 1.25X6.38 W/HOLE	2
3	51392CR	PIN 2.00X6.00 SR	1
4	23699	BUSHING 32DXR20 2.00X1.25	2
5	0108	SNAP RING 2.00 7200-200	2
6	0249	BUSHING BPC-2022-20 1.25X1.25	4
7	0530	CAP SCR 0.38-16X2.75 HHGR5	2
8	C1592	ZERK 1/8 NPT STRAIGHT	2
9	8621	CLAMP HOSE/TUBE AG-3	2
10	0346	WASHER 0.38 USS FLAT	17
11	0427	MACHY WASHER 2.00ID 10GA	2
12	130242	PLATE SPACER LIFT FRAME 18.50IN LOWER MNT V2	2
13	0347	NUT 0.38-16 HHGR5 NYLOC	11
14	90913	CAP SCR 0.38-16X8.00 HHGR5	8
15	130150	PLATE CLAMP SPACER CCR 18.50IN LOWER MNT V2	4

Extendable Fork Frame Assembly - PN 57775

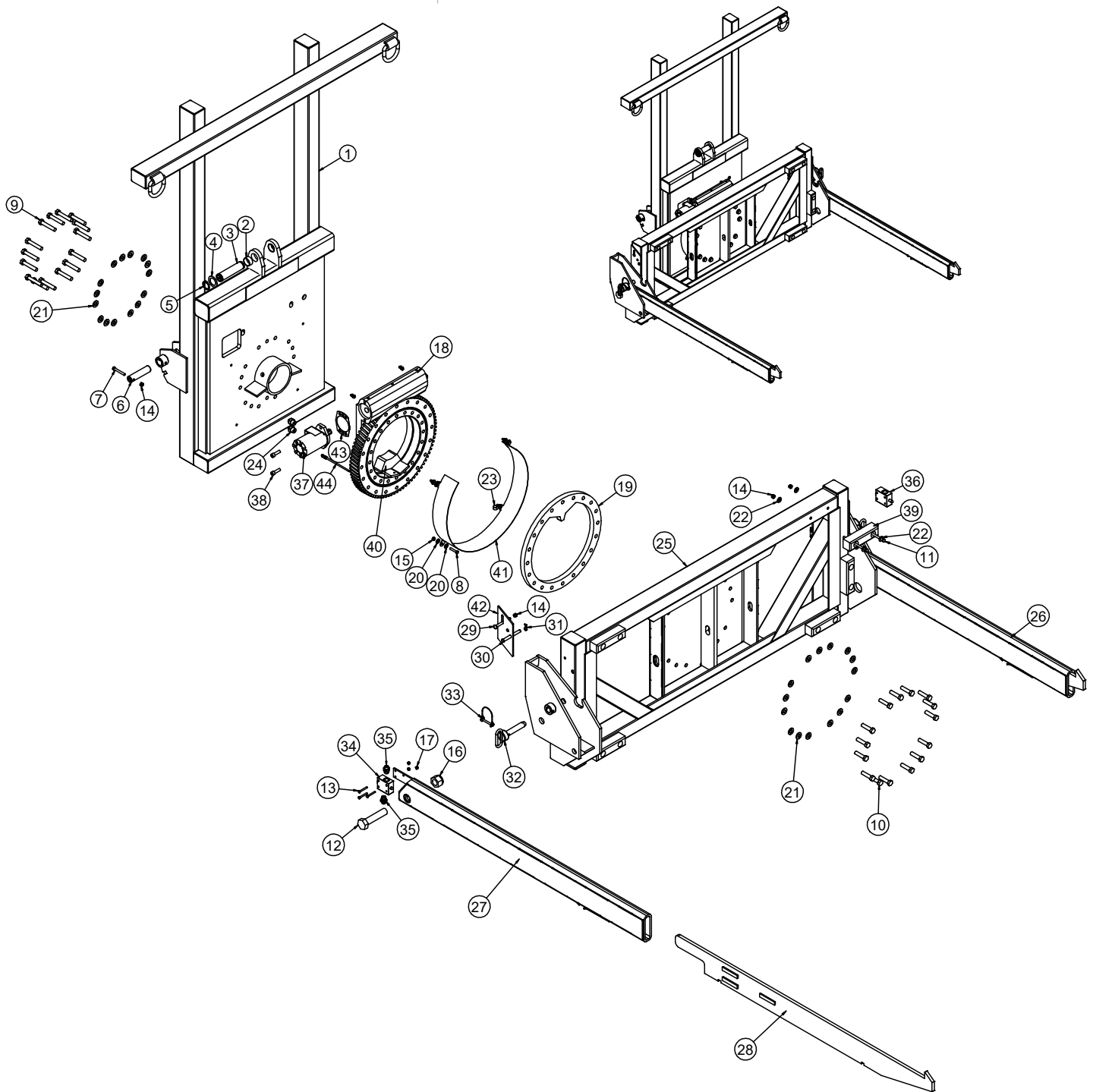

Extendable Fork Frame Assembly - PN 57775 Parts List

PN 57775			
ITEM	PART	DESCRIPTION	QTY
1	57793	FORK FRAME ECCR EXTENDABLE FORKS	1
2	21810	BUSHING BPC24DXR12 1.50X.75	2
3	51309CR	PIN 1.50X6.13 SR	1
4	0376	MACHY WASHER 1.50ID 14GA	2
5	0246	SNAP RING ID 7200 150	2
6	51311CR	PIN 1.25X5.13 W/ HOLE	2
7	0530	CAP SCR 0.38-16X2.75 HHGR5	2
8	0487	CAP SCR 0.31-18X1.75 HHGR5	4
9	D1312	CAP SCR 0.63-11X3.50 HHGR8	15
10	C1026	CAP SCR 0.63-11X2.50 HHGR8	15
11	C0936	CAP SCR 0.38-16X6.00 HHGR5	12
12	57798	CAP SCR 1.25-7X5.50 HHGR8	2
13	0481	CAP SCR 0.25-20X2.00 HHGR5	6
14	0347	NUT 0.38-16 HHGR5 NYLOC	16
15	0342	NUT 0.31-18 HHGR5 NYLOC	4
16	5223	NUT 1.25-7 HHGR5 NYLOC	2
17	0333	NUT 0.25-20 HHGR5 NYLOC	6
18	4032	BEARING SWING DRIVE 6000	1
19	55837	PLATE SPACER FORK INTEGRAL STOP TAB	1
20	0343	WASHER 0.31 USS FLAT	8
21	C5902	WASHER 0.63 SAE FLAT YELLOW GR8	30
22	0346	WASHER 0.38 USS FLAT	24
23	C0078	CLAMP 0.38 BLK VINYL	1
24	C1855	FTG 6-10 MFS-MORB STRAIGHT	2
25	53902	CARRIAGE FRAME WLDMT EXTENDABLE FORKS	1
26	54267	FORK OUTER TUBE WLDMT CS	1
27	54048	FORK OUTER TUBE WLDMT	1
28	54053	FORK INNER WLDMT EXTENDABLE FORKS	2
29	50003	BOLT CARRIAGE 0.38X4.00	2
30	45121	PIN 0.50X4.50 CLEVIS	2
31	47472	HAIR PIN CLIP 0.13X1.56	2
32	45125	PIN HITCH 1.00 FORK KPCC	2
33	45216	PIN 0.31X2.75 WIRE LOCK	2
34	53853	VALVE PLUNGER VILLA HYD NORMALLY CLOSED	1
35	57734	FTG 8-6 MBSPP-MFS STRAIGHT	4
36	56570	VALVE PLUNGER VILLA HYD NORMALLY OPEN	1
37	11458	MOTOR HYD 10 CU IN/ PNT BLK	1
38	62484	CAP SCR 12MMX40MM SH	2
39	62662	WEAR PAD 2.00X2.00X7.69	6
40	57778	STOP WLDMT SLIDE EXTENDABLE FORKS PC BLACK	1
41	50481	GUARD CONT CARRIER LZR	1
42	45079	PLATE 0.25 KPCC TRUNNION STOP PC BLACK	2
43	21151	GASKET MOTOR 008-10056-1	1
44	104018	HARDWARE KIT BASE ASM 30IN GREASE LINE	1

Adjustable Fork Frame Assembly - PN 58145

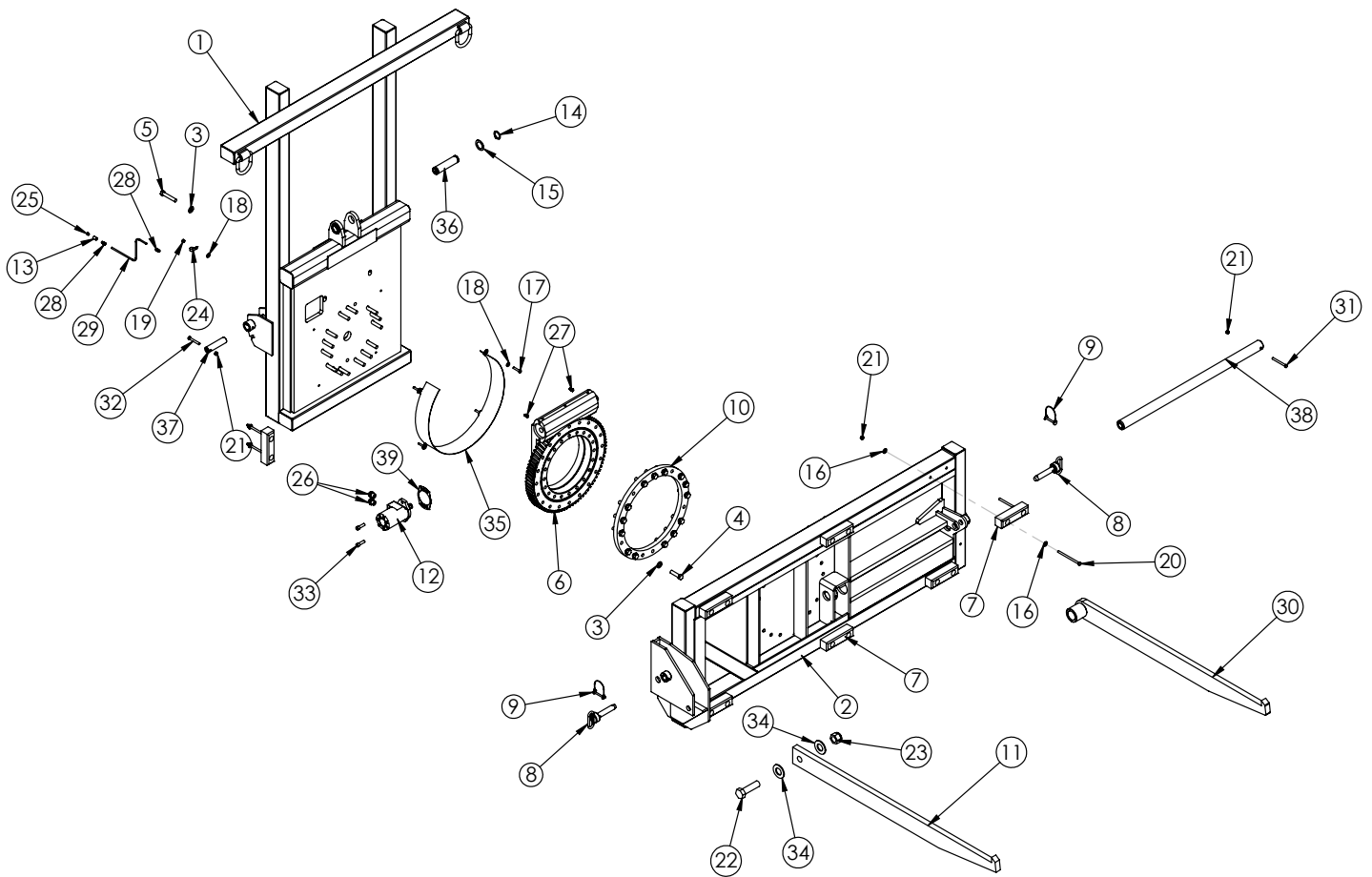

Adjustable Fork Frame Assembly - PN 58145 Parts List

PN 58145			
ITEM	PART	DESCRIPTION	QTY
1	51205	FORK FRAME ECCR	1
2	59190	CARRIAGE FRAME WLDMT ROTATOR ECCR ADJ 48-76.50	1
3	C5902	WASHER 0.63 SAE FLAT YELLOW GR8	44
4	C1026	CAP SCR 0.63-11X2.50 HHGR8	15
5	D1312	CAP SCR 0.63-11X3.50 HHGR8	15
6	4032	BEARING SWING DRIVE 6000	1
7	62662	WEAR PAD 2.00X2.00X7.69	7
8	45125	PIN HITCH 1.00 FORK KPCC	2
9	45216	PIN 0.31X2.75 WIRE LOCK	2
10	47489	PLATE SPACER FORK KPAC	1
11	51307	PLATE FORK CONTAINER CARRIER EXT	1
12	11458	MOTOR HYD 10 CU IN/ PNT BLK	1
13	0246	SNAP RING ID 7200 150	2
14	0376	MACHY WASHER 1.50ID 14GA	2
15	0346	WASHER 0.38 USS FLAT	28
16	0487	CAP SCR 0.31-18X1.75 HHGR5	4
17	0343	WASHER 0.31 USS FLAT	8
18	0342	NUT 0.31-18 HHGR5 NYLOC	4
19	C0936	CAP SCR 0.38-16X6.00 HHGR5	14
20	0347	NUT 0.38-16 HHGR5 NYLOC	17
21	45120	CAP SCR 1.25-7X4.50 HHGR8	1
22	5223	NUT 1.25-7 HHGR5 NYLOC	1
23	C0078	CLAMP 0.38 BLK VINYL	1
24	C1855	FTG 6-10 MFS-MORB STRAIGHT	2
25	C5644	ZERK 1/8 NPT 45 DEG	2
26	58147	PLATE FORK WLDMNT CONTAINER CARRIER ADJ	1
27	0532	CAP SCR 0.38-16X3.75 HHGR5	1
28	0530	CAP SCR 0.38-16X2.75 HHGR5	2
29	62484	CAP SCR 12MMX40MM SH	2
30	9180	WASHER 1.25 SAE FLAT YELLOW GR8	2
31	50481	GUARD CONT CARRIER LZR	1
32	51309CR	PIN 1.50X6.13 SR	1
33	51311CR	PIN 1.25X5.13 W/ HOLE	2
34	59191CR	PIN STOP CONTAINER CARRIER ADJ 48-76.50 ZC	1
35	21151	GASKET MOTOR 008-10056-1	1
36	104018	HARDWARE KIT BASE ASM 30IN GREASE LINE	1

Fork Frame Assembly - PN 51308

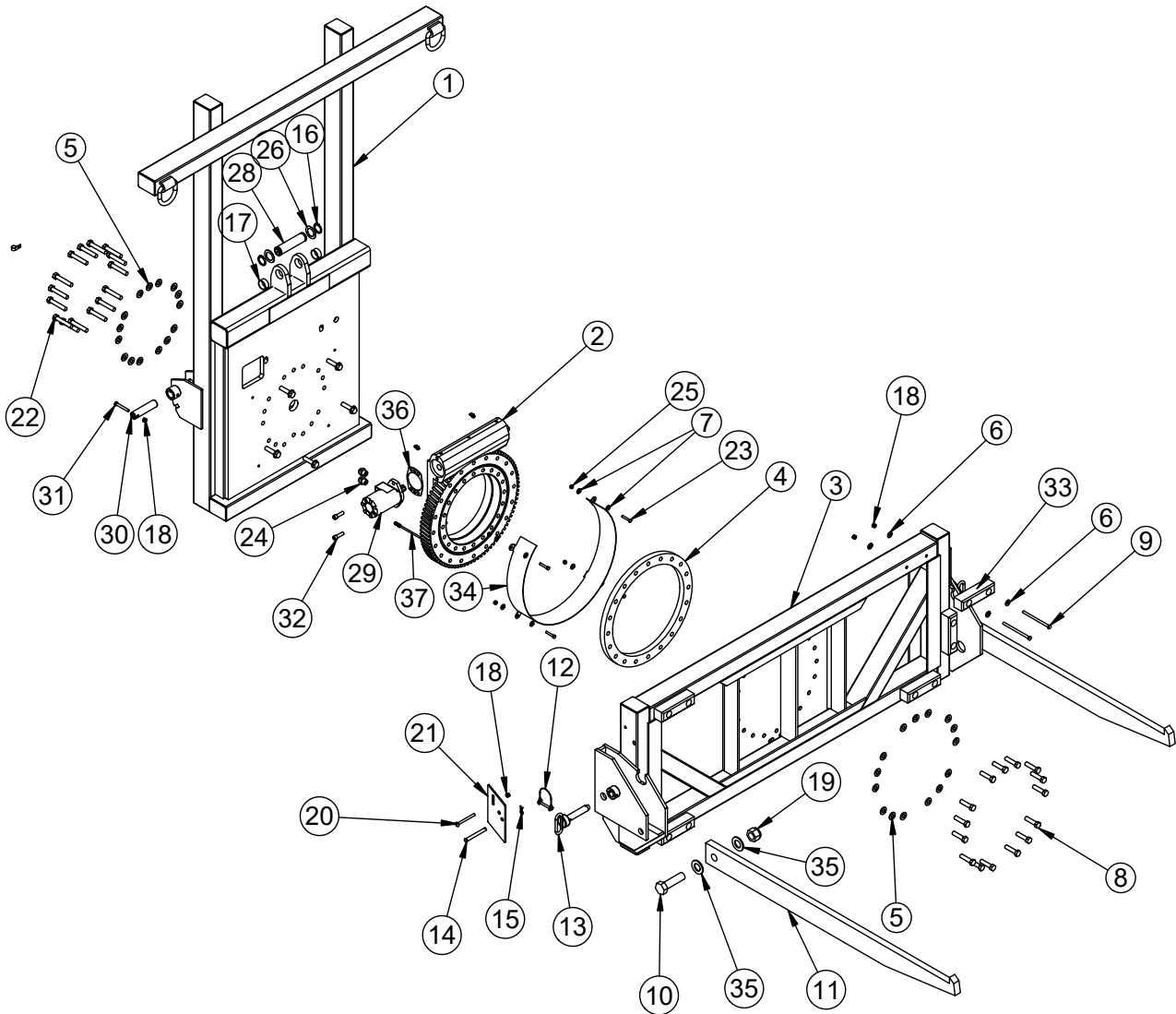

Fork Frame Assembly - PN 51308 Part List

PN 51308			
ITEM	PART	DESCRIPTION	QTY
1	51205	FORK FRAME ECCR	1
2	4032	BEARING SWING DRIVE 6000	1
3	51303	CARRIAGE FRAME WLDMT ROTATOR EXT	1
4	47489	PLATE SPACER FORK KPAC	1
5	C5902	WASHER 0.63 SAE FLAT YELLOW GR8	49
6	0346	WASHER 0.38 USS FLAT	24
7	0343	WASHER 0.31 USS FLAT	8
8	C1026	CAP SCR 0.63-11X2.50 HHGR8	20
9	C0936	CAP SCR 0.38-16X6.00 HHGR5	12
10	45120	CAP SCR 1.25-7X4.50 HHGR8	2
11	51307	PLATE FORK CONTAINER CARRIER EXT	2
12	45216	PIN 0.31X2.75 WIRE LOCK	2
13	45125	PIN HITCH 1.00 FORK KPCC	2
14	45121	PIN 0.50X4.50 CLEVIS	2
15	47472	HAIR PIN CLIP 0.13X1.56	2
16	0246	SNAP RING ID 7200 150	2
17	21810	BUSHING BPC24DXR12 1.50X.75	2
18	0347	NUT 0.38-16 HHGR5 NYLOC	16
19	5223	NUT 1.25-7 HHGR5 NYLOC	2
20	50003	BOLT CARRIAGE 0.38X4.00	2
21	45079	PLATE 0.25 KPCC TRUNNION STOP PC BLACK	2
22	D1312	CAP SCR 0.63-11X3.50 HHGR8	15
23	0487	CAP SCR 0.31-18X1.75 HHGR5	4
24	C1855	FTG 6-10 MFS-MORB STRAIGHT	2
25	0342	NUT 0.31-18 HHGR5 NYLOC	4
26	0376	MACHY WASHER 1.50ID 14GA	2
27	C0078	CLAMP 0.38 BLK VINYL	1
28	51309CR	PIN 1.50X6.13 SR	1
29	11458	MOTOR HYD 10 CU IN/ PNT BLK	1
30	51311CR	PIN 1.25X5.13 W/ HOLE	2
31	0530	CAP SCR 0.38-16X2.75 HHGR5	2
32	62484	CAP SCR 12MMX40MM SH	2
33	62662	WEAR PAD 2.00X2.00X7.69	6
34	50481	GUARD CONT CARRIER LZR	1
35	9180	WASHER 1.25 SAE FLAT YELLOW GR8	4
36	21151	GASKET MOTOR 008-10056-1	1
37	104018	HARDWARE KIT BASE ASM 30IN GREASE LINE	1

Fork Frame Assembly 8" Drop Forks - PN 67322

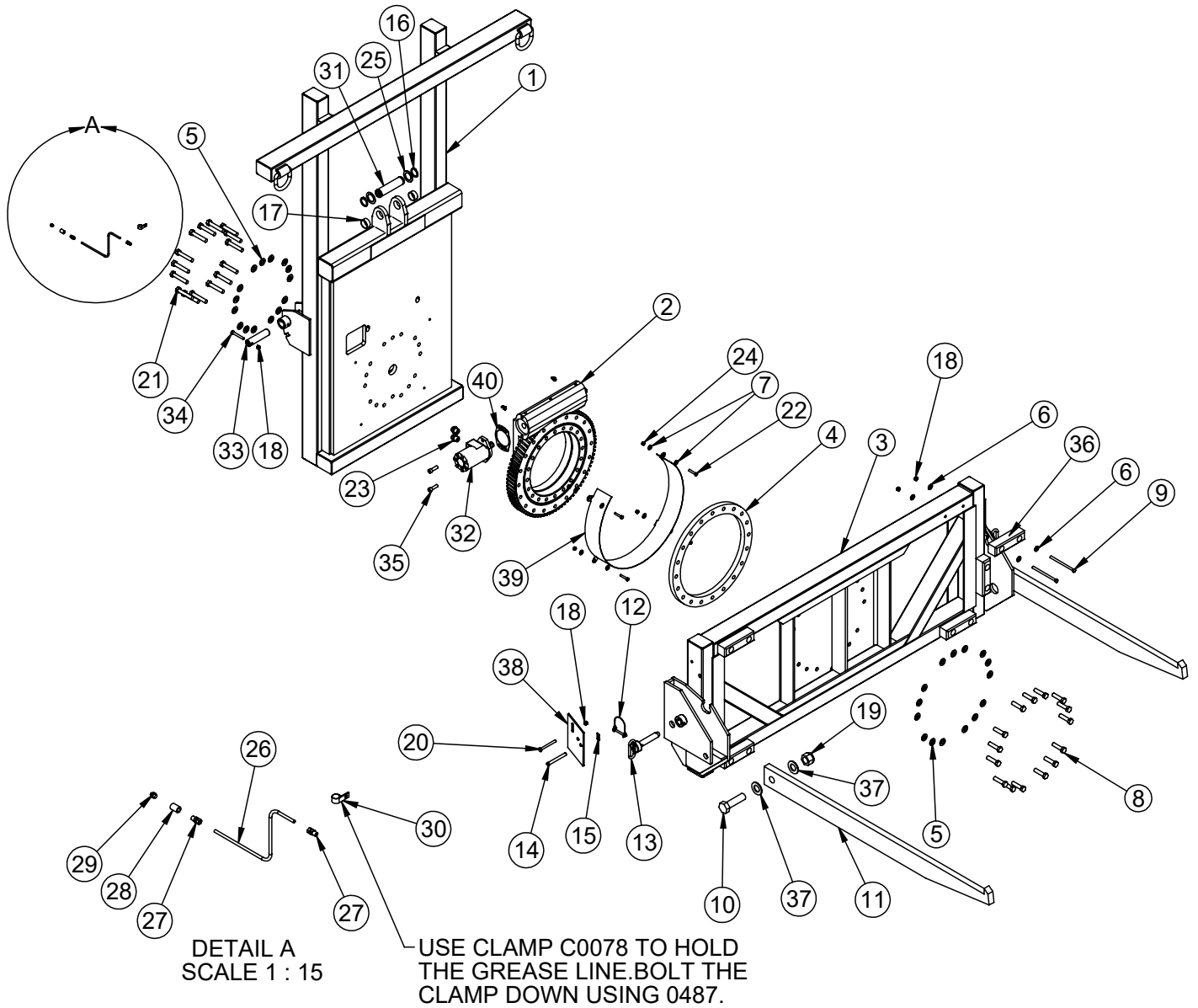

Fork Frame Assembly 8" Drop Forks - PN 67322 Parts

PN 67322			
ITEM	PART	DESCRIPTION	QTY
1	67323	FORK FRAME CCR 8IN LOWER MNT	1
2	4032	BEARING SWING DRIVE 6000	1
3	51303	CARRIAGE FRAME WLDMT ROTATOR EXT	1
4	47489	PLATE SPACER FORK KPAC	1
5	C5902	WASHER 0.63 SAE FLAT YELLOW GR8	49
6	0346	WASHER 0.38 USS FLAT	24
7	0343	WASHER 0.31 USS FLAT	8
8	C1026	CAP SCR 0.63-11X2.50 HHGR8	20
9	C0936	CAP SCR 0.38-16X6.00 HHGR5	12
10	45120	CAP SCR 1.25-7X4.50 HHGR8	2
11	51307	PLATE FORK CONTAINER CARRIER EXT	2
12	45216	PIN 0.31X2.75 WIRE LOCK	2
13	45125	PIN HITCH 1.00 FORK KPCC	2
14	45121	PIN 0.50X4.50 CLEVIS	2
15	47472	HAIR PIN CLIP 0.13X1.56	2
16	0246	SNAP RING ID 7200 150	2
17	21810	BUSHING BPC24DXR12 1.50X.75	2
18	0347	NUT 0.38-16 HHGR5 NYLOC	16
19	5223	NUT 1.25-7 HHGR5 NYLOC	2
20	50003	BOLT CARRIAGE 0.38X4.00	2
21	D1312	CAP SCR 0.63-11X3.50 HHGR8	15
22	0487	CAP SCR 0.31-18X1.75 HHGR5	4
23	C1855	FTG 6-10 MFS-MORB STRAIGHT	2
24	0342	NUT 0.31-18 HHGR5 NYLOC	4
25	0376	MACHY WASHER 1.50ID 14GA	2
26	C0078	CLAMP 0.38 BLK VINYL	1
27	51309CR	PIN 1.50X6.13 SR	1
28	11458	MOTOR HYD 10 CU IN/ PNT BLK	1
29	51311CR	PIN 1.25X5.13 W/ HOLE	2
30	0530	CAP SCR 0.38-16X2.75 HHGR5	2
31	62484	CAP SCR 12MMX40MM SH	2
32	62662	WEAR PAD 2.00X2.00X7.69	6
33	9180	WASHER 1.25 SAE FLAT YELLOW GR8	4
34	45079	PLATE 0.25 KPCC TRUNNION STOP PC BLACK	2
35	50481	GUARD CONT CARRIER LZR	1
36	21151	GASKET MOTOR 008-10056-1	1
37	104018	HARDWARE KIT BASE ASM 30IN GREASE LINE	1

Fork Frame Asm 18" Drop Forks - PN 79374

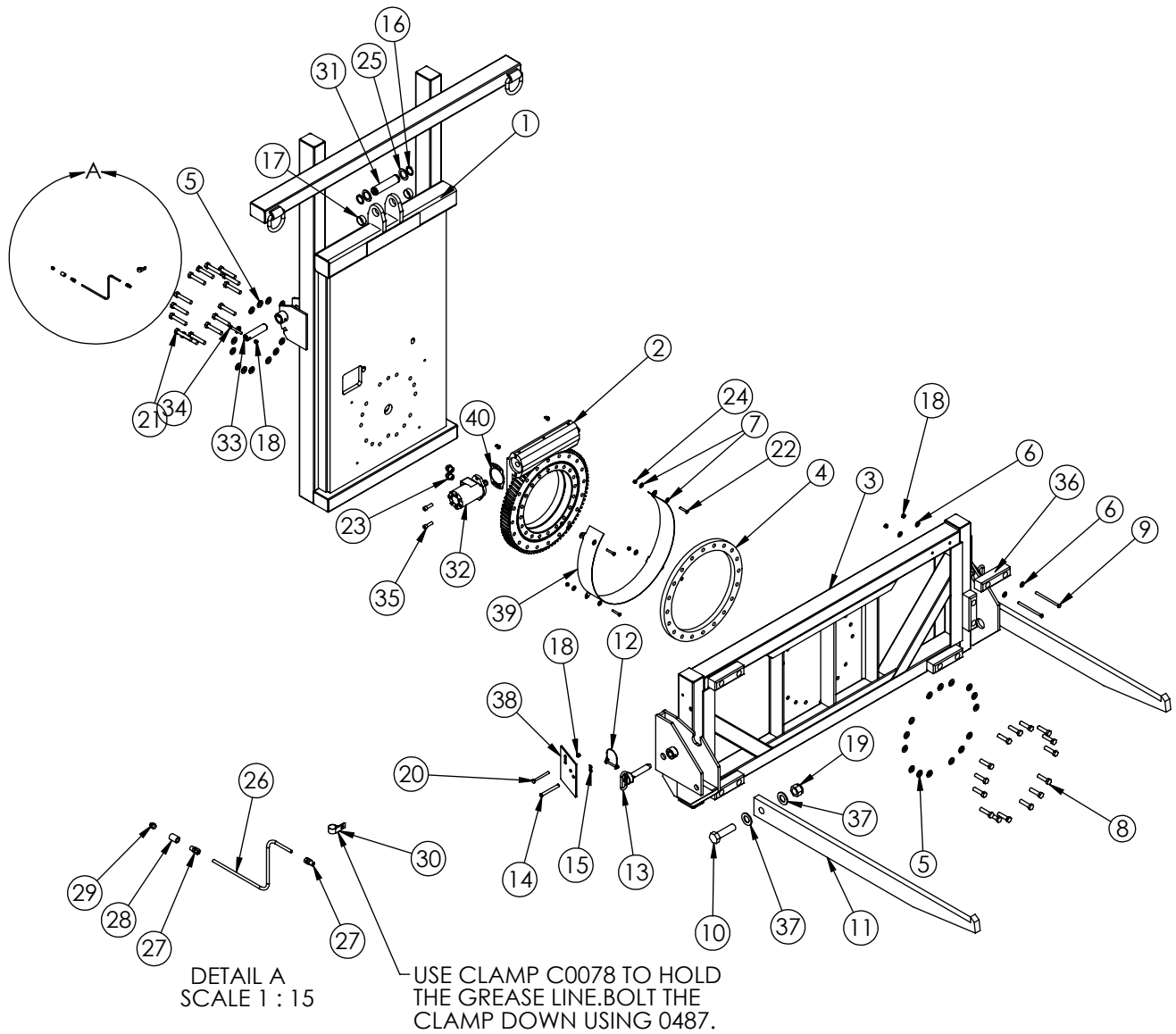

Fork Frame Asm 18" Drop Forks - PN 79374 Parts List

PN 79374			
ITEM	PART	DESCRIPTION	QTY
1	79377	FORK FRAME CCR 18.50IN LOWER MNT	1
2	4032	BEARING SWING DRIVE 6000	1
3	51303	CARRIAGE FRAME WLDMT ROTATOR EXT	1
4	47489	PLATE SPACER FORK KPAC	1
5	C5902	WASHER 0.63 SAE FLAT YELLOW GR8	49
6	0346	WASHER 0.38 USS FLAT	24
7	0343	WASHER 0.31 USS FLAT	8
8	C1026	CAP SCR 0.63-11X2.50 HHGR8	20
9	C0936	CAP SCR 0.38-16X6.00 HHGR5	12
10	45120	CAP SCR 1.25-7X4.50 HHGR8	2
11	51307	PLATE FORK CONTAINER CARRIER EXT	2
12	45216	PIN 0.31X2.75 WIRE LOCK	2
13	45125	PIN HITCH 1.00 FORK KPCC	2
14	45121	PIN 0.50X4.50 CLEVIS	2
15	47472	HAIR PIN CLIP 0.13X1.56	2
16	0246	SNAP RING ID 7200 150	2
17	21810	BUSHING BPC24DXR12 1.50X.75	2
18	0347	NUT 0.38-16 HHGR5 NYLOC	16
19	5223	NUT 1.25-7 HHGR5 NYLOC	2
20	50003	BOLT CARRIAGE 0.38X4.00	2
21	D1312	CAP SCR 0.63-11X3.50 HHGR8	15
22	0487	CAP SCR 0.31-18X1.75 HHGR5	4
23	C1855	FTG 6-10 MFS-MORB STRAIGHT	2
24	0342	NUT 0.31-18 HHGR5 NYLOC	4
25	0376	MACHY WASHER 1.50ID 14GA	2
26	C0078	CLAMP 0.38 BLK VINYL	1
27	51309CR	PIN 1.50X6.13 SR	1
28	11458	MOTOR HYD 10 CU IN/ PNT BLK	1
29	51311CR	PIN 1.25X5.13 W/ HOLE	2
30	0530	CAP SCR 0.38-16X2.75 HHGR5	2
31	62484	CAP SCR 12MMX40MM SH	2
32	62662	WEAR PAD 2.00X2.00X7.69	6
33	9180	WASHER 1.25 SAE FLAT YELLOW GR8	4
34	45079	PLATE 0.25 KPCC TRUNNION STOP PC BLACK	2
35	50481	GUARD CONT CARRIER LZR	1
36	21151	GASKET MOTOR 008-10056-1	1
37	104018	HARDWARE KIT BASE ASM 30IN GREASE LINE	1

RSRVR ASM 10 Gal BLKHD 3-Sect - 134276

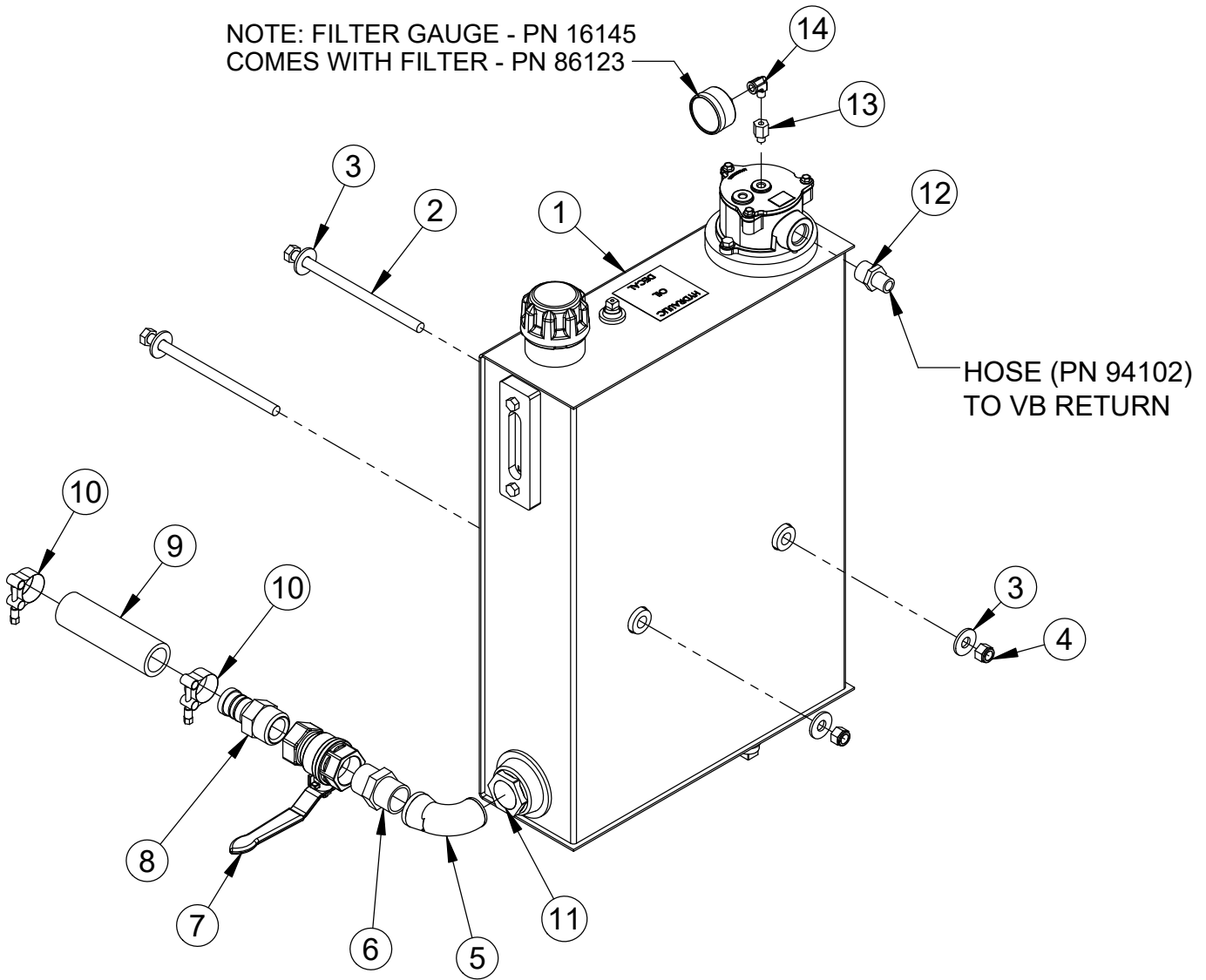

RSRVR ASM 10 Gal BLKHD 3-Sect - 134276 Parts

PN 134276			
ITEM	PART	DESCRIPTION	QTY
1	98545	RSRVR ASM 10 GAL BULKHEAD MNT W/TANK TOP FILTER	1
2	48141	CAP SCR 0.50-13X8.50 HHGR5	2
3	352	WASHER 0.50 USS FLAT	4
4	C6106	NUT 0.50-13 HHGR5 NYLOC	2
5	C4694	ST EL 1.25 90 DEG BLK	1
6	1115	FTG 20-20 MP-MP HEX NIPPLE STRAIGHT	1
7	C5511	VALVE BALL 1.25	1
8	C2282	FTG 1.25 NPT TO 1.25 BARB	1
9	17767	HOSE SUCT 1.25 10FT	1
10	C0075	HOSE CLAMP HC125	2
11	C5552	FILTER STRAINER TFS-1220-0	1
12	C1180	FTG 8-12 MFS-MORB STRAIGHT	1
13	25465	FTG 2-2 MP-FP STRAIGHT EXPANDER	1
14	C4692	FTG 2-2 MP-FP 90	1
REV. INITIAL RELEASE			

ITEMS NOT SHOWN		
PART	DESCRIPTION	QTY
1554	FTG 8-8 MFS-MORB STRAIGHT	1
31676	HOSE 0.50(4500PSI)-8FFSS SHORT-8FFSS SHORT-120CL	1
D0549	FTG 16-8 MORB-FORB STRAIGHT REDUCER	1
42971	DECAL OIL FILTER CHANGE	1
94102	HOSE 0.50(4500PSI)-8FFSS SHORT-8FFSS 90 SHORT-48CL	1

RSRVR Assembly VB Detail - 134276

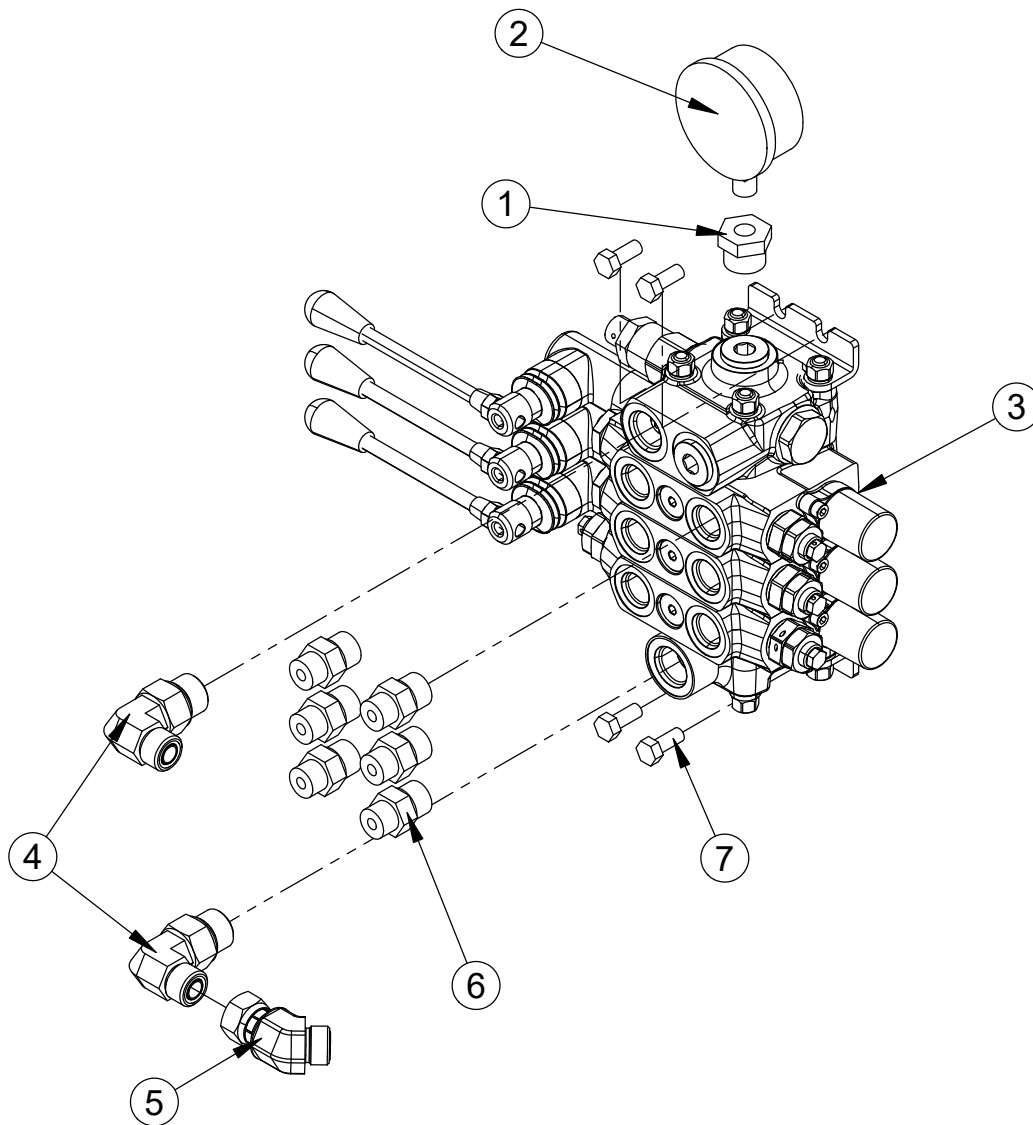

PN 134276-VB DETAIL			
ITEM	PART	DESCRIPTION	QTY
1	25630	FTG 10-4 MORB-FP STRAIGHT	1
2	10094	GAUGE OIL LF 2.5" 0-5000 BM	1
3	133980	VB 3 SECT DVS10 CAPPED SPOOLS	1
4	C3643	FTG 8-10 MFS-MAORB 90	2
5	40298	FTG 8-8 MFS-FFSS 45	1
6	C1854	FTG 6-8 MFS-MORB STRAIGHT	6
7	0420	CAP SCR 0.31-18X0.75 HHGR5	4
REV. INITIAL RELEASE			

RSRVR Assembly Decal Brkt Detail - 134276

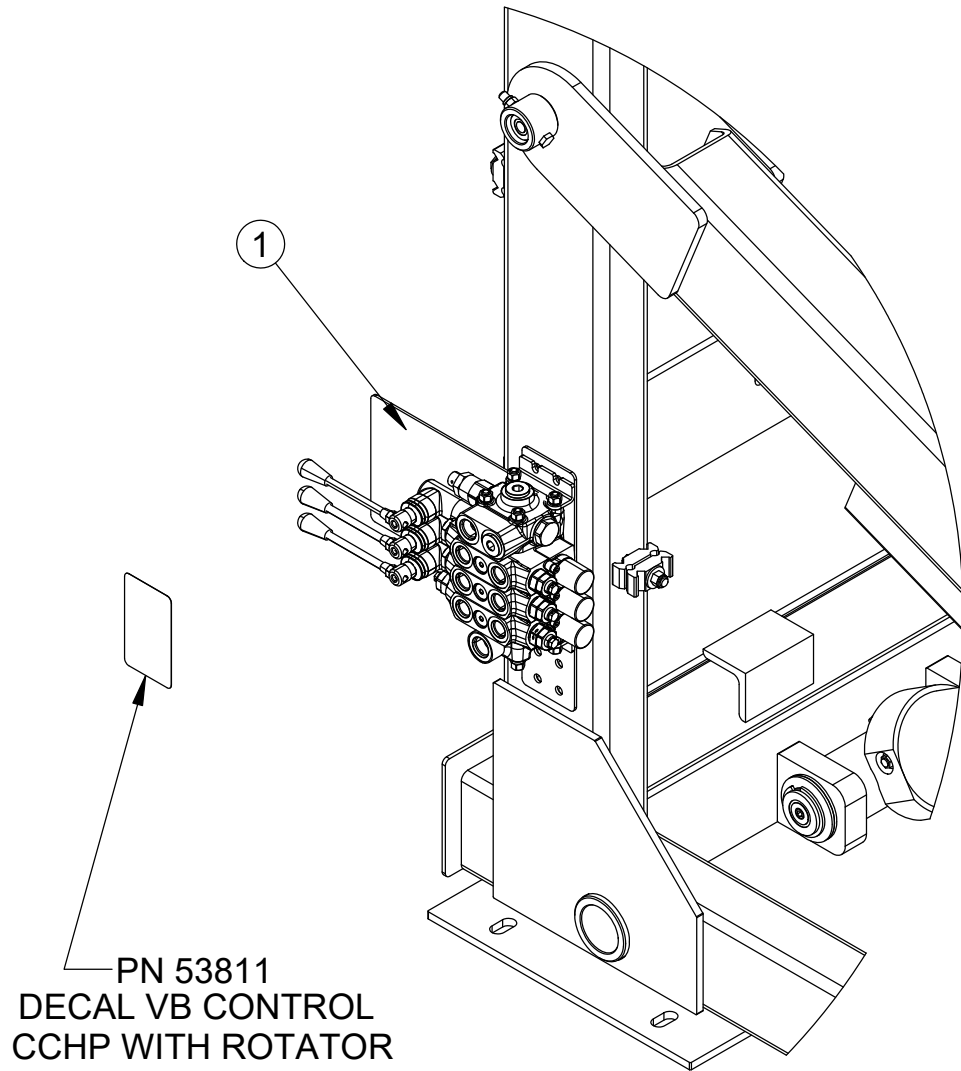

PN 134276- DECAL BRKT DETAIL			
ITEM	PART	DESCRIPTION	QTY
1	52297	BRKT CTRL DECAL ECCR	1
REV. INITIAL RELEASE			

RSRVR Assembly Port Tubes - 134276

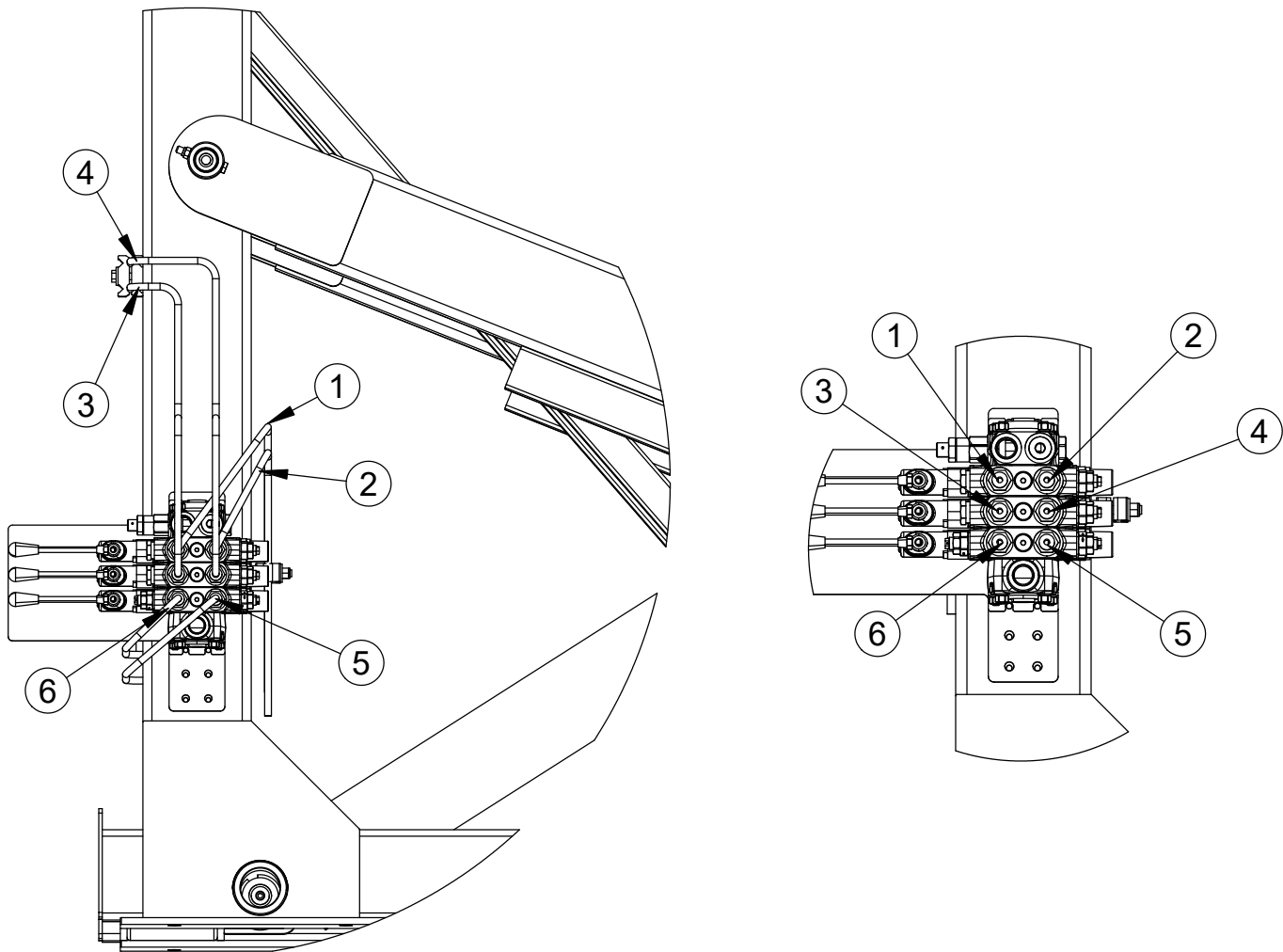

PN 134276-PORT TUBES			
ITEM	PART	DESCRIPTION	QTY
1	52124	TUBE ASM 0.38 ECCR LIFT EXTEND YZ	1
2	52125	TUBE ASM 0.38 ECCR LIFT RETRACT YZ	1
3	53703	TUBE ASM 0.38 CCHP TILT RETRACT YZ	1
4	53702	TUBE ASM 0.38 CCHP TILT EXTEND YZ	1
5	52130	TUBE ASM 0.38 ECCR ROTATION CCW YZ	1
6	52131	TUBE ASM 0.38 ECCR ROTATION CW YZ	1
REV. INITIAL RELEASE			

Air Actuator DVS10 - PN 64634

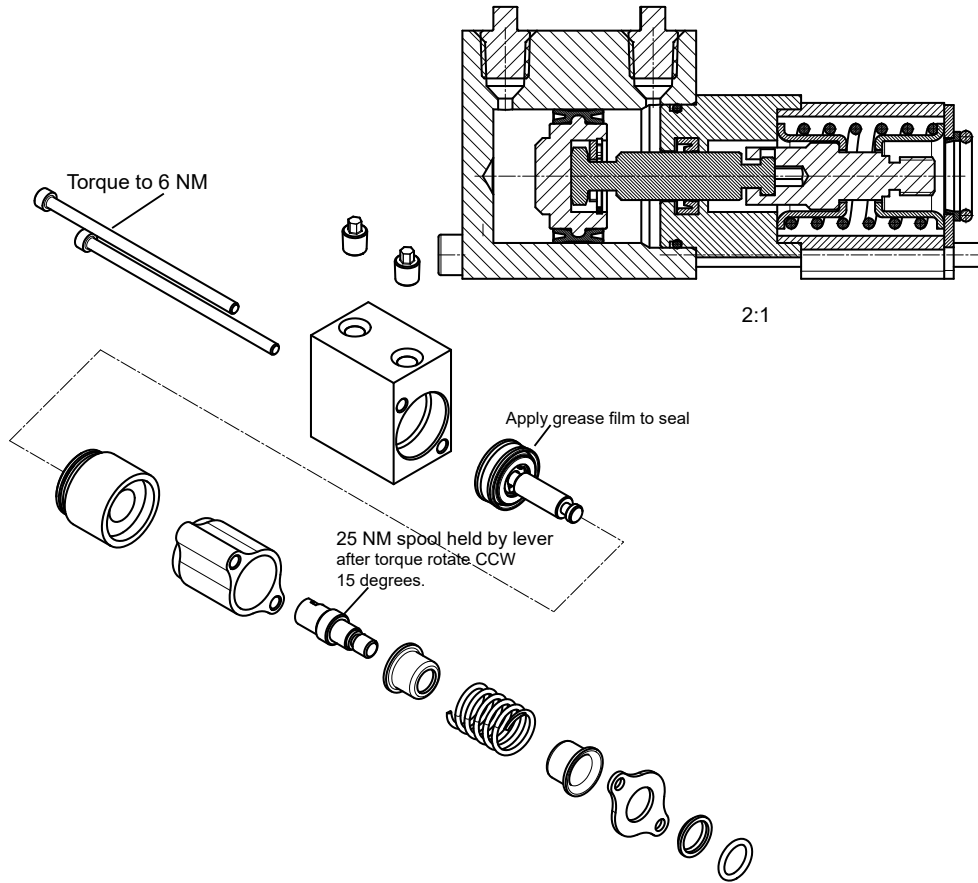

Cable Kit DVS10 - PN 67319

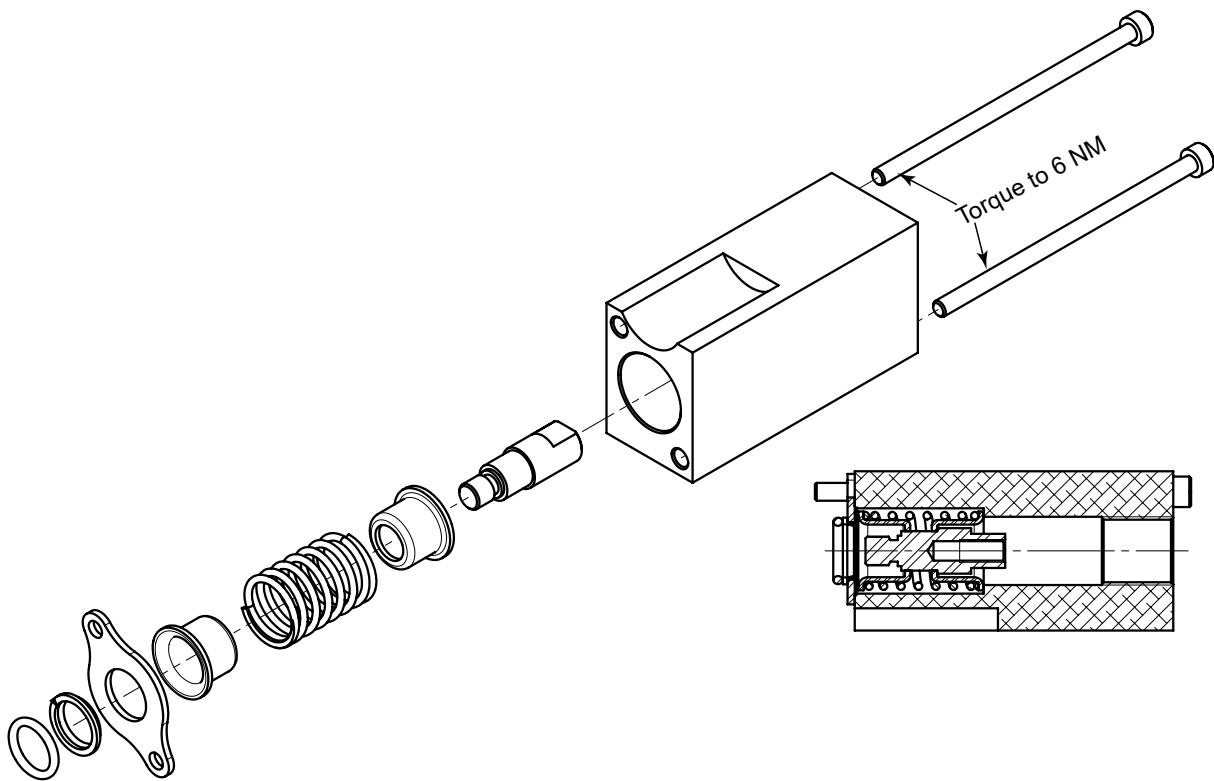

Reservoir Assembly - PN 98545

NOTE: FILTER GAUGE - PN 16145
COMES WITH FILTER - PN 86123

NOTE: REPLACEMENT OIL FILTER - PN 86124

NOTE: REPLACEMENT GASKET RG-14 - PN 98200

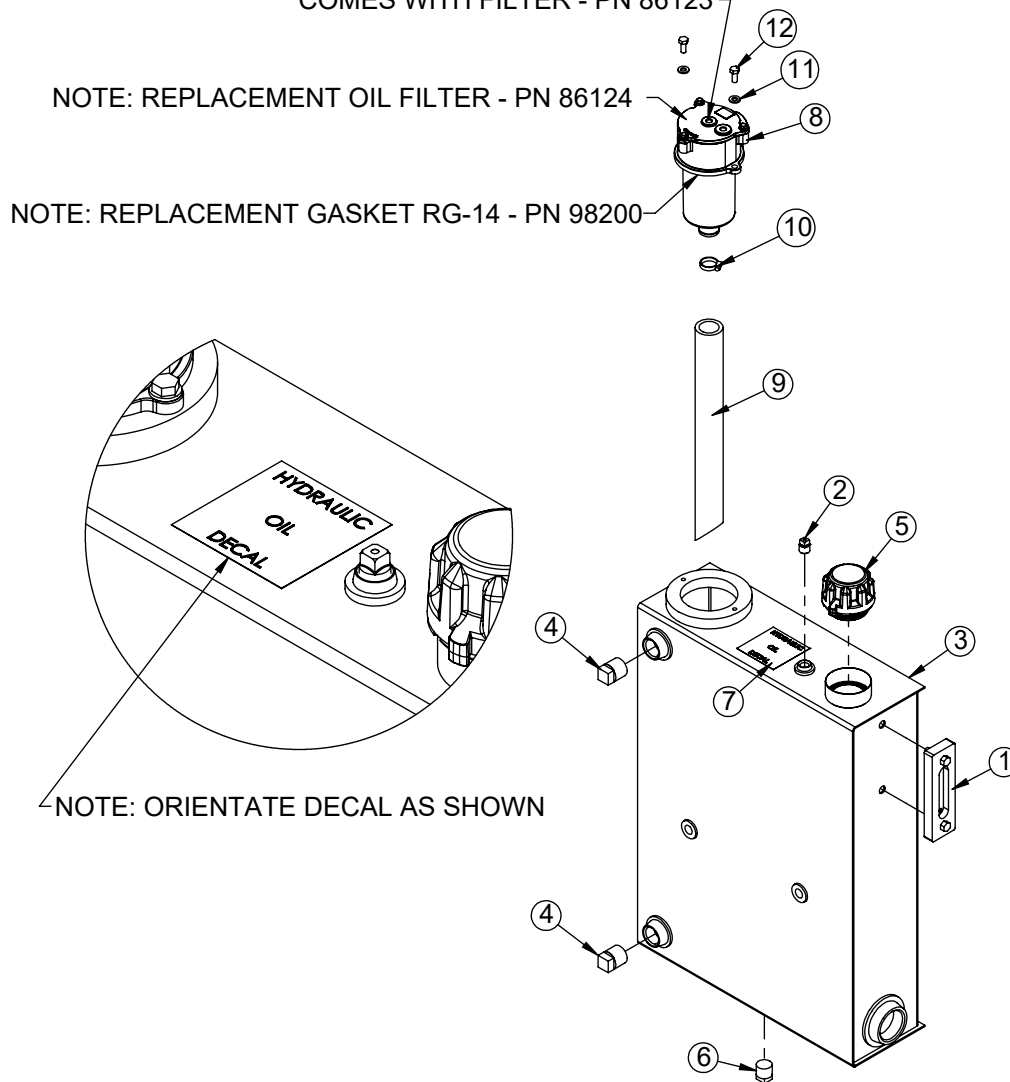

Reservoir Assembly - PN 98545 Parts List

PN 98545			
ITEM	PART	DESCRIPTION	QTY
1	15463	THERMO SIGHT GAUGE ZINGA SG-O5-A-T-N	1
2	C4841	PLUG 0.38 NPT SQ HD BLK	1
3	98546	RSRVR WLDMT HYD 10GAL 26HX19WX6D W/TANK TOP FILTER	1
4	C4842	PLUG 1.00 NPT SQ HD BLK	2
5	73278	CAP 1PSI ZINGA THREADED	1
6	C2126	PLUG 0.75 NPT SQ HD MAGNETIC	1
7	13002	DECAL HYD OIL SPECIFICATION MOBIL	1
8	86123	FILTER TANK TOP SMF 12 SAE	1
9	88321	HOSE 1.25X16.50 DOWN TUBE	1
10	C4659	HOSE CLAMP #16 SS	1
11	5591	WASHER 0.31 SAE FLAT YELLOW GR8	2
12	0420	CAP SCR 0.31-18X0.75 HHGR5	2

Fender Kit Assembly - PN 80045

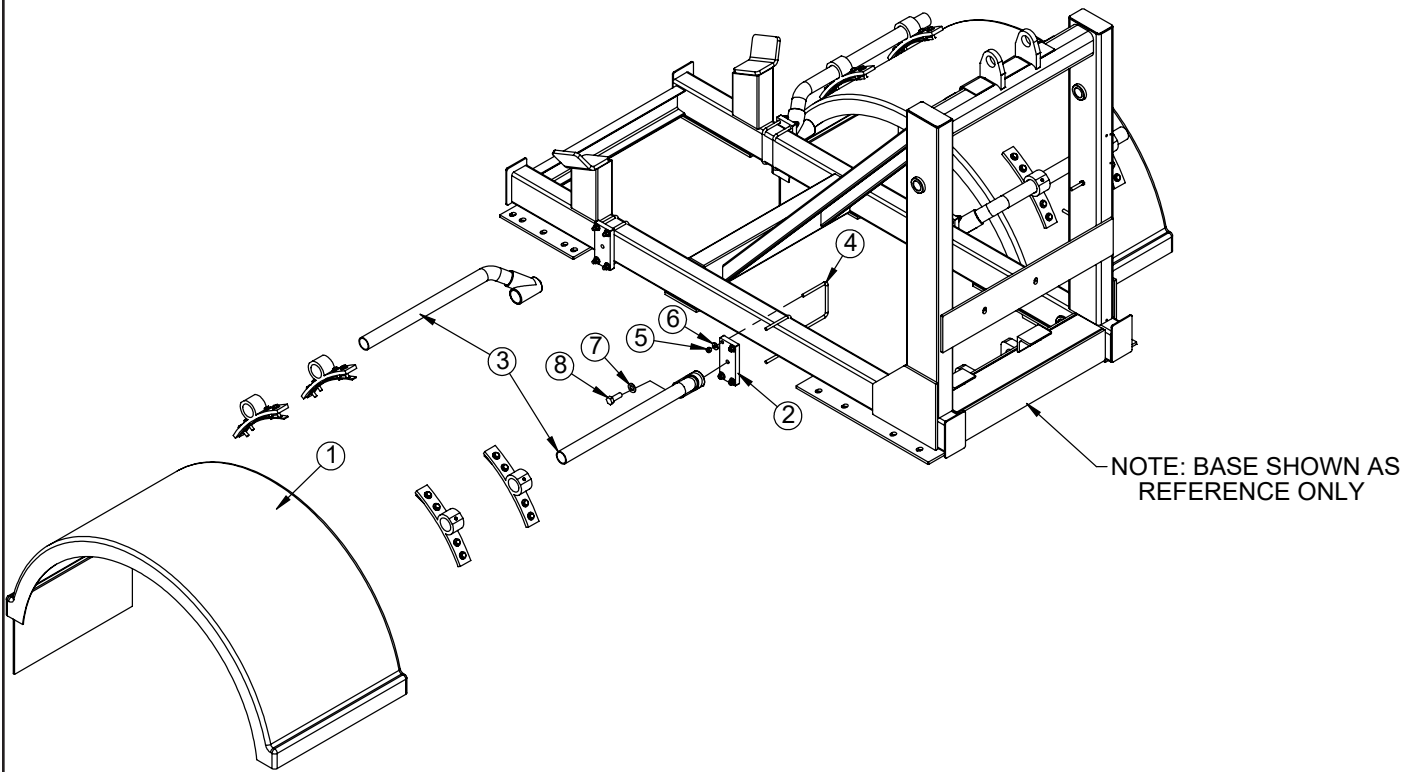

Fender Kit Assembly - PN 80045 Parts List

PN 80045			
ITEM	PART	DESCRIPTION	QTY
1	4467	FENDER SINGLE 2 TON PLASTIC	2
2	74734	FLAT 0.75X3.00X6.50 CR W/HOLES PC BLACK	4
3	5733	MTG KIT OFFSET POLY FENDER (FLEET)	2
4	77537	U BOLT 0.38X5.00X4.75	8
5	347	NUT 0.38-16 HHGR5 NYLOC	16
6	346	WASHER 0.38 USS FLAT	16
7	C5902	WASHER 0.63 SAE FLAT YELLOW GR8	4
8	11693	CAP SCR 0.63-11X1.75 HHGR8	4
9	7633	FENDER MOUNT ASM KIT	2



Subject to Change without Notification.
© 2024 Stellar Industries, Inc.